



Traffic Crash Report

Local Report Number *	Crash Severity	Hit/Skip
20173927	3 - 1 - Fatal 2 - Injury 3 - PDO	1 - Solved 2 - Unsolved

Local Information		Reporting Agency NCIC *	Reporting Agency Name *	Number of Units	Unit in error
<input type="checkbox"/> Photos Taken <input type="checkbox"/> OH-2 <input type="checkbox"/> OH-3 <input type="checkbox"/> OH-1P <input type="checkbox"/> Other	<input type="checkbox"/> PDO Under State Reportable Dollar Amount	01820	GARFIELD HEIGHTS PD	02	02 98 - Animal 99 - Unknown

County *	<input checked="" type="checkbox"/> City * <input type="checkbox"/> Village * <input type="checkbox"/> Township *	City, Village, Township *	Crash Date *	Time of Crash	Day of Week
18		GARFIELD HTS	11042017	1014	SAT

Degrees / Minutes / Seconds Latitude	Longitude	Decimal Degrees Latitude	Longitude
		41.411903	-81.616561

Roadway Division	Divided Lane Direction of Travel	Number of Thru Lanes	Road Types or Milepost ²
<input checked="" type="checkbox"/> Divided <input type="checkbox"/> Undivided	W N - Northbound S - Southbound	04	AL - Alley CR - Circle HE - Heights MP - Milepost PL - Place ST - Street WA - Way AV - Avenue CT - Court HW - Highway PK - Parkway RD - Road TE - Terrace BL - Boulevard DR - Drive LA - Lane PI - Pike SQ - Square TL - Trail

Location Route Type ¹	Location Route Number	Loc. Prefix	Location Road name	Location Road Type ²	Route Types ¹
IR	480				IR - Interstate Route (inc. turnpike) US - US Route SR - State Route

Distance From Reference	Dir From Ref	Reference Route Type ¹	Reference Route Number	Ref Prefix	Reference Name (Road, Milepost, House #)	Reference Road Type ²
	N,S,E,W			N,S,E,W	21.6	MP

Reference Point Used	Crash Location	Reference Point Used	Location of First Harmful Event
2 - Mile Post	01 - Not an intersection	01 - Not an intersection	1 - On Roadway

Road Contour	Road Conditions	Weather
1 - Straight Level	01 - Dry	2 - Cloudy

Manner of Crash Collision/Impact	Weather
7 - Not Collision Between Two Motor Vehicles In Transport	2 - Cloudy

Road Surface	Light conditions	School Bus Related
2 - Blacktop, Bituminous, Asphalt	1 - Primary	<input type="checkbox"/> School Zone Related

Work Zone Related	Type of Work Zone	Location of Crash in Work Zone
<input type="checkbox"/> Workers Present	1 - Lane Closure	1 - Before the first Work Zone Warning Sign

Narrative
 DRIVER OF UNIT #1 WAS TRAVELLING IN LANE #4 ON IR480 W/B AT MILE POST 21.6 (TRANSPORTATION BLVD). DRIVER OF UNIT #2 STATED SHE WAS DRIVING ON THE IR480 W/B ON RAMP AND RAN OUT OF ROOM TRYING TO MERGE ONTO THE FREEWAY. SHE THEN SIDESWIPE UNIT #1, WHO WAS IN LANE #4, TO AVOID GOING INTO THE UNPAVED AREA TO HER RIGHT. BOTH VEHICLES WERE ABLE TO BE DRIVEN AWAY AFTER THE CRASH.

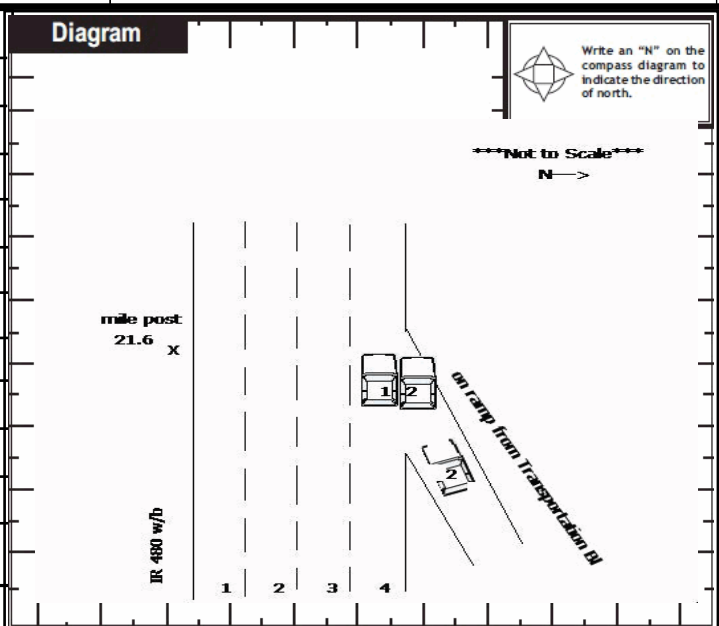

Report Taken By	Supplement (Correction or Addition to an Existing Report Sent to ODPSS)	Date Crash Reported	Time Crash Reported	Dispatch Time	Arrival Time	Time Cleared	Other Investigation Time	Total Minutes
<input checked="" type="checkbox"/> Police Agency		11042017	1014	1029	1038	1130	45	97

Officer's Name *	Officer's Badge Number	Checked By	Page of
Z. Kovetsdi	055	L10 M. Kaye	

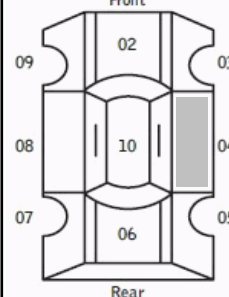
Unit Number 01	Owner Name: Last, First, Middle (<input checked="" type="checkbox"/> Same As Driver) VICTOR CHARLES L	Owner Phone Number - inc. area code (<input checked="" type="checkbox"/> Same As Driver) 440-232-7119	Damage Scale 2	Damaged Area 
Owner Address, City, State, Zip (<input checked="" type="checkbox"/> Same As Driver) 18750 EGBERT ROAD WALTON HILLS OH 44146 4236			1 - None	
LP State OH	License Plate Number GCT6490	Vehicle Identification Number 1GNET16S966102535	# Occupants 01	
Vehicle Year 2006	Vehicle Make CHEV Chevrolet	Vehicle Model TBZ Trailblazer	Vehicle Color GRY Gray	
<input checked="" type="checkbox"/> Proof of Insurance Shown	Insurance Company LIBERTY MUTUAL	Policy Number AOS-288-221490-4072	Towed By	
Carrier Name, Address, City, State, Zip			Carrier Phone - include area code	
US DOT	Vehicle Weight GVWR/GCWR <input type="checkbox"/> 1 - Less Than or Equal to 10k Lbs. <input type="checkbox"/> 2 - 10,001 to 26,000 Lbs. <input type="checkbox"/> 3 - More Than 26,000 Lbs.	Cargo Body Type 01 01 - No Cargo Body Type/Not Applicable 02 - Bus/Van(9-15 Seats, Inc Driver) 03 - Bus(16+ Seats, Inc Driver) 04 - Vehicle Towing Another Vehicle 05 - Logging 06 - Intermodal Container Chassis 07 - Cargo Van/Enclosed Box 08 - Grain, Chips, Gravel	Trafficway Description 4 1 - Two-Way, Not Divided 2 - Two-Way, Not Divided, Continuous Left Turn Lane 3 - Two-Way, Divided, Unprotected (Painted or Grass>4 Ft.) Median 4 - Two-Way, Divided, Positive Median Barrier 5 - One-Way Trafficway	
HM Placard ID No.	<input type="checkbox"/> Hazardous Material Released	Hit / Skip Unit <input type="checkbox"/>		
HM Class Number	Non-Motorist Location Prior to Impact 01 01 - Intersection - Marked Crosswalk 02 - Intersection - No Crosswalk 03 - Intersection - Other 04 - Midblock - Marked Crosswalk 05 - Travel Lane - Other Location 06 - Bicycle Lane 07 - Shoulder/Roadside 08 - Sidewalk 09 - Median/Crossing Island 10 - Driveway Access 11 - Shared-Use Path or Trail 12 - Non-Trafficway Area 99 - Other/Unknown			
Type of Use 1 1 - Personal 2 - Commercial 3 - Government <input type="checkbox"/> In Emergency Response	Unit Type 06 99 - Unknown or Hit/Skip 01 - Sub-Compact 02 - Compact 03 - Mid Size 04 - Full Size 05 - Minivan 06 - Sports Utility Vehicle 07 - Pickup 08 - Van 09 - Motorcycle 10 - Motorized Bicycle 11 - Snowmobile/ATV 12 - Other Passenger Vehicle	Passenger Vehicle (less than 9 passengers)	Med/Heavy Trucks or Combo Units>10k lbs 13 - Single Unit Truck or Van 2axle,6 tires 14 - Single Unit Truck 3+ axles 15 - Single Unit Truck/Trailer 16 - Truck/Tractor(Bobtail) 17 - Tractor/Semi-Trailer 18 - Tractor/Double 19 - Tractor/Triples 20 - Other Med/Heavy Vehicle	Bus/Van/Limo (9 or More Including Driver) 21 - Bus/Van (9-15 Seats, Inc Driver) 22 - BUS(16+ Seats, Inc Driver) Non-Motorist 23 - Animal with Rider 24 - Animal with Buggy, Wagon, Surrey 25 - Bicycle/Pedacyclist 26 - Pedestrian/Skater 27 - Other Non-Motorist
Special Function 01 01 - None 02 - Taxi 03 - Rental Truck (Over 10K Lbs) 04 - Bus - School (Public or Private) 05 - Bus - Transit 06 - Bus - Charter 07 - Bus - Shuttle 08 - Bus - Other	09 - Ambulance 10 - Fire 11 - Highway/Maintenance 12 - Military 13 - Police 14 - Public Utility 15 - Other Government 16 - Construction Equip.	17 - Farm Vehicle 18 - Farm Equipment 19 - Motorhome 20 - Golf Cart 21 - Train 22 - Other (Explain in Narrative)	Most Damaged Area 04 01 - None 02 - Center Front 03 - Right Front 04 - Right Side 05 - Right Rear 06 - Rear Center 07 - Left Rear	Action 4 1 - Non-Contact 2 - Non-Collision 3 - Striking 4 - Struck 5 - Striking/Struck 9 - Unknown
Pre-Crash Actions 01 99 - Unknown	Motorist 01 - Straight Ahead 02 - Backing 03 - Changing Lanes 04 - Overtaking/Passing 05 - Making Right Turn 06 - Making Left Turn	07 - Making U-Turn 08 - Entering Traffic Lane 09 - Leaving Traffic Lane 10 - Parked 11 - Slowing or Stopped in Traffic 12 - Driverless	13 - Negotiating a Curve 14 - Other Motorist Action	Non-Motorist 15 - Entering or Crossing Specified Location 16 - Walking, Running, Jogging, Playing, Cycling 17 - Working 18 - Pushing Vehicle 19 - Approaching or Leaving Vehicle 20 - Standing
Contributing Circumstances Primary 01 01 - None 02 - Failure to Yield 03 - Ran Red Light 04 - Ran Stop Sign 05 - Exceeded Speed Limit 06 - Unsafe Speed 07 - Improper Turn 08 - Left of Center 09 - Followed Too Closely/ACDA 10 - Improper Lane Change /Passing/Off Road	Motorist 11 - Improper Backing 12 - Improper Start From Parked Position 13 - Stopped or Parked Illegally 14 - Operating Vehicle in Negligent Manner 15 - Swerving to Avoid (Due to External Conditions) 16 - Wrong Side/Wrong Way 17 - Failure to Control 18 - Vision Obstruction 19 - Operating Defective Equipment 20 - Load Shifting/Falling/Spilling 21 - Other Improper Action	Non-Motorist 22 - None 23 - Improper Crossing 24 - Darting 25 - Lying and/or Illegally in Roadway 26 - Failure to Yield Right of Way 27 - Not Visible (Dark Clothing) 28 - Inattentive 29 - Failure to Obey Traffic Signs /Signals/Officer 30 - Wrong Side of the Road 31 - Other Non-Motorist Action	Vehicle Defects 01 01 - Turn Signals 02 - Head Lamps 03 - Tail Lamps 04 - Brakes 05 - Steering 06 - Tire Blowout 07 - Worn or Slick tires 08 - Trailer Equipment Defective 09 - Motor Trouble 10 - Disabled From Prior Accident 11 - Other Defects	
Sequence of Events 1 20 2 01 3 01 4 01 5 01 6 01 First Harmful Event 1 Most Harmful Event 1 99 - Unknown	<p>Non-Collision Events</p> 01 - Overturn/Rollover 02 - Fire/Explosion 03 - Immersion 04 - Jackknife 05 - Cargo/Equipment Loss or Shift 06 - Equipment Failure (Blown Tire, Brake Failure, etc) 07 - Separation of Units 08 - Ran Off Road Right 09 - Ran Off Road Left 10 - Cross Median 11 - Cross Center Line Opposite Direction of Travel 12 - Downhill Runaway 13 - Other Non-Collision <p>Collision With Person, Vehicle or Object Not Fixed</p> 14 - Pedestrian 15 - Pedalcycle 16 - Railway Vehicle (Train,Engine) 17 - Animal - Farm 18 - Animal - Deer 19 - Animal - Other 20 - Motor Vehicle in Transport 21 - Parked Motor Vehicle 22 - Work Zone Maintenance Equipment 23 - Struck by Falling, Shifting Cargo or Anything Set in Motion by a Motor Vehicle 24 - Other Movable Object 25 - Impact Attenuator/Crash Cushion 26 - Bridge Overhead Structure 27 - Bridge Pier or Abutment 28 - Bridge Parapet 29 - Bridge Rail 30 - Guardrail Face 31 - Guardrail End 32 - Portable Barrier 33 - Median Cable Barrier 34 - Median Guardrail Barrier 35 - Median Concrete Barrier 36 - Median Other Barrier 37 - Traffic Sign Post 38 - Overhead Sign Post 39 - Light/Luminaries Support 40 - Utility Pole 41 - Other Post, Pole or Support 42 - Culvert 43 - Curb 44 - Ditch 45 - Embankment 46 - Fence 47 - Mailbox 48 - Tree 49 - Fire Hydrant 50 - Work Zone Maintenance Equipment 51 - Wall, Building, Tunnel 52 - Other Fixed Object			
Unit Speed 55 <input checked="" type="checkbox"/> Stated <input type="checkbox"/> Estimated	Posted Speed 60	Traffic Control 12 01 - No Controls 02 - Stop Sign 03 - Yield Sign 04 - Traffic Signal 05 - Traffic Flashers 06 - School Zone 07 - Railroad Crossbucks 08 - Railroad Flashers 09 - Railroad Gates 10 - Construction Barricade 11 - Person (Flagger, Officer) 12 - Pavement Markings	Unit Direction From 3 To 4 1 - North 2 - South 3 - East 4 - West 5 - Northeast 6 - Northwest 7 - Southeast 8 - Southwest 9 - Unknown	

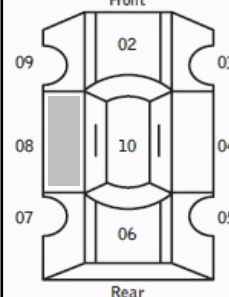
Unit Number 02	Owner Name: Last, First, Middle (<input checked="" type="checkbox"/> Same As Driver) STRAH DOLORES J	Owner Phone Number - inc. area code (<input checked="" type="checkbox"/> Same As Driver) 216-475-9599	Damage Scale 2	Damaged Area 	
Owner Address, City, State, Zip (<input checked="" type="checkbox"/> Same As Driver) 5513 CAROL JEAN BLVD GARFIELD HTS OH 44125			1 - None		
LP State OH	License Plate Number FC93BE	Vehicle Identification Number 3GSL33P78S654307	2 - Minor		
Vehicle Year 2008	Vehicle Make STRN Saturn	Vehicle Model VUE VUE	3 - Functional		
Vehicle Color SIL Alum/Silver	Proof of Insurance Shown <input checked="" type="checkbox"/>	Insurance Company ALLSTATE	4 - Disabling		
Policy Number 092329798	Towed By		9 - Unknown		
Carrier Name, Address, City, State, Zip			Carrier Phone - include area code		
US DOT	Vehicle Weight GVWR/GCWR <input type="checkbox"/> 1 - Less Than or Equal to 10k Lbs. <input type="checkbox"/> 2 - 10,001 to 26,000 Lbs. <input type="checkbox"/> 3 - More Than 26,000 Lbs.	Cargo Body Type 01	Trafficway Description 4		
HM Placard ID No.	<input type="checkbox"/> Hazardous Material Released	01 - No Cargo Body Type/Not Applicable 02 - Bus/Van(9-15 Seats, Inc.Driver) 03 - Bus(16+ Seats, Inc Driver) 04 - Vehicle Towing Another Vehicle 05 - Logging 06 - Intermodal Container Chassis 07 - Cargo Van/Enclosed Box 08 - Grain, Chips, Gravel	1 - Two-Way, Not Divided 2 - Two-Way, Not Divided, Continuous Left Turn Lane 3 - Two-Way, Divided, Unprotected (Painted or Grass>4 Ft.) Median 4 - Two-Way, Divided, Positive Median Barrier 5 - One-Way Trafficway		
HM Class Number		09 - Pole 10 - Cargo Tank 11 - Flat Bed 12 - Dump 13 - Concrete Mixer 14 - Auto Transporter 15 - Garbage/Refuse 99 - Other/Unknown	<input type="checkbox"/> Hit / Skip Unit		
Non-Motorist Location Prior to Impact 01	Type of Use 1	Unit Type 03	Bus/Van/Limo (9 or More Including Driver) 21 - Bus/Van (9-15 Seats, Inc Driver) 22 - BUS(16+ Seats, Inc Driver)		
01 - Intersection - Marked Crosswalk 02 - Intersection - No Crosswalk 03 - Intersection - Other 04 - Midblock - Marked Crosswalk 05 - Travel Lane - Other Location 06 - Bicycle Lane 07 - Shoulder/Roadside 08 - Sidewalk 09 - Median/Crossing Island 10 - Driveway Access 11 - Shared-Use Path or Trail 12 - Non-Trafficway Area 99 - Other/Unknown	1 - Personal 2 - Commercial 3 - Government <input type="checkbox"/> In Emergency Response	Passenger Vehicle (less than 9 passengers) 01 - Sub-Compact 02 - Compact 03 - Mid Size 04 - Full Size 05 - Minivan 06 - Sports Utility Vehicle 07 - Pickup 08 - Van 09 - Motorcycle 10 - Motorized Bicycle 11 - Snowmobile/ATV 12 - Other Passenger Vehicle	Med/Heavy Trucks or Combo Units>10k lbs 13 - Single Unit Truck or Van 2axle,6 tires 14 - Single Unit Truck 3+ axles 15 - Single Unit Truck/Trailer 16 - Truck/Tractor(Bobtail) 17 - Tractor/Semi-Trailer 18 - Tractor/Double 19 - Tractor/Triples 20 - Other Med/Heavy Vehicle		
Special Function 01	01 - None 02 - Taxi 03 - Rental Truck (Over 10K Lbs) 04 - Bus - School (Public or Private) 05 - Bus - Transit 06 - Bus - Charter 07 - Bus - Shuttle 08 - Bus - Other	09 - Ambulance 10 - Fire 11 - Highway/Maintenance 12 - Military 13 - Police 14 - Public Utility 15 - Other Government 16 - Construction Equip.	17 - Farm Vehicle 18 - Farm Equipment 19 - Motorhome 20 - Golf Cart 21 - Train 22 - Other (Explain in Narrative)	Most Damaged Area 08	Action 3
01 - None 02 - Center Front 03 - Right Front 04 - Right Side 05 - Right Rear 06 - Rear Center 07 - Left Rear	08 - Left Side 09 - Left Front 10 - Top and Windows 11 - Undercarriage 12 - Load/Trailer 13 - Total (All Areas) 14 - Other	99 - Unknown	1 - Non-Contact 2 - Non-Collision 3 - Striking 4 - Struck 5 - Striking/Struck 9 - Unknown		
Pre-Crash Actions 08	Motorist 01 - Straight Ahead 02 - Backing 03 - Changing Lanes 04 - Overtaking/Passing 05 - Making Right Turn 06 - Making Left Turn	07 - Making U-Turn 08 - Entering Traffic Lane 09 - Leaving Traffic Lane 10 - Parked 11 - Slowing or Stopped in Traffic 12 - Driverless	13 - Negotiating a Curve 14 - Other Motorist Action	Non-Motorist 15 - Entering or Crossing Specified Location 16 - Walking, Running, Jogging, Playing, Cycling 17 - Working 18 - Pushing Vehicle 19 - Approaching or Leaving Vehicle 20 - Standing	
21 - Other Non-Motorist Action	Contributing Circumstances		Vehicle Defects		
Primary 02	Motorist 01 - None 02 - Failure to Yield 03 - Ran Red Light 04 - Ran Stop Sign 05 - Exceeded Speed Limit 06 - Unsafe Speed 07 - Improper Turn 08 - Left of Center 09 - Followed Too Closely/ACDA 10 - Improper Lane Change /Passing/Off Road	Non-Motorist 11 - Improper Backing 12 - Improper Start From Parked Position 13 - Stopped or Parked Illegally 14 - Operating Vehicle in Negligent Manner 15 - Swerving to Avoid (Due to External Conditions) 16 - Wrong Side/Wrong Way 17 - Failure to Control 18 - Vision Obstruction 19 - Operating Defective Equipment 20 - Load Shifting/Falling/Spilling 21 - Other Improper Action	Non-Motorist 22 - None 23 - Improper Crossing 24 - Darting 25 - Lying and/or Illegally in Roadway 26 - Failure to Yield Right of Way 27 - Not Visible (Dark Clothing) 28 - Inattentive 29 - Failure to Obey Traffic Signs /Signals/Officer 30 - Wrong Side of the Road 31 - Other Non-Motorist Action	01 - Turn Signals 02 - Head Lamps 03 - Tail Lamps 04 - Brakes 05 - Steering 06 - Tire Blowout 07 - Worn or Slick tires 08 - Trailer Equipment Defective 09 - Motor Trouble 10 - Disabled From Prior Accident 11 - Other Defects	
Secondary 99	Sequence of Events		Collision With Person, Vehicle or Object Not Fixed		
1 20	2 00	3 00	4 00	5 00	
6 00	First Harmful Event 1		Most Harmful Event 1		
99 - Unknown		Collision With Fixed Object			
14 - Pedestrian 15 - Pedalcycle 16 - Railway Vehicle (Train,Engine) 17 - Animal - Farm 18 - Animal - Deer 19 - Animal - Other 20 - Motor Vehicle in Transport		21 - Parked Motor Vehicle 22 - Work Zone Maintenance Equipment 23 - Struck by Falling, Shifting Cargo or Anything Set in Motion by a Motor Vehicle 24 - Other Movable Object			
25 - Impact Attenuator/Crash Cushion 26 - Bridge Overhead Structure 27 - Bridge Pier or Abutment 28 - Bridge Parapet 29 - Bridge Rail 30 - Guardrail Face 31 - Guardrail End 32 - Portable Barrier		33 - Median Cable Barrier 34 - Median Guardrail Barrier 35 - Median Concrete Barrier 36 - Median Other Barrier 37 - Traffic Sign Post 38 - Overhead Sign Post 39 - Light/Luminaries Support 40 - Utility Pole			
41 - Other Post, Pole or Support 42 - Culvert 43 - Curb 44 - Ditch 45 - Embankment 46 - Fence 47 - Mailbox		48 - Tree 49 - Fire Hydrant 50 - Work Zone Maintenance Equipment 51 - Wall, Building, Tunnel 52 - Other Fixed Object			
Unit Speed 50	Posted Speed 60	Traffic Control 12	Unit Direction From 3 To 4		
<input checked="" type="checkbox"/> Stated <input type="checkbox"/> Estimated		01 - No Controls 02 - Stop Sign 03 - Yield Sign 04 - Traffic Signal 05 - Traffic Flashers 06 - School Zone	1 - North 2 - South 3 - East 4 - West		
		07 - Railroad Crossbucks 08 - Railroad Flashers 09 - Railroad Gates 10 - Construction Barricade 11 - Person (Flagger, Officer) 12 - Pavement Markings	5 - Northeast 6 - Northwest 7 - Southeast 8 - Southwest		
		13 - Crosswalk Lines 14 - Walk/Don't Walk 15 - Other 16 - Not Reported	9 - Unknown		



Motorist / Non-Motorist / Occupant

Local Report Number *

2 | 0 | 1 | 7 | 3 | 9 | 2 | 7 | | | | | | | |

Motorist/Non-Motorist

Unit Number 0 2	Name: Last, First, Middle STRAH DOLORES J	Date of Birth 0 9 2 8 1 9 4 1	Age 76	Gender F - Female M - Male							
Address, City, State, Zip 5513 CAROL JEAN BLVD GARFIELD HTS OH 44125			Contact Phone - include area code 216-475-9599								
Injuries 1	Injured Taken By <input type="checkbox"/>	EMS Agency	Medical Facility Injured Taken To	Safety Equipment Used 0 4	DOT Compliant Motorcycle Helmet <input type="checkbox"/>	Seating Position 0 1	Air Bag Usage 1	Ejection 1	Trapped 1		
OL State OH	Operator License Number RP552902	OL Class 4	No Valid OL <input type="checkbox"/>	M/C End <input type="checkbox"/>	Condition 1	Alcohol/Drug Suspected 1	Alcohol Test Status 1	Alcohol Test Type 1	Alcohol Test Value	Drug Test Status 1	Drug Test Type 1
Offense Charged (Local Code) 331.22	Offense Description FTY TO THRU TRAFFIC		Citation Number G20174577		Hands-Free Device Used <input type="checkbox"/>	Driver Distracted By 1					

Motorist/Non-Motorist

Unit Number 0 1	Name: Last, First, Middle VICTOR CHARLES L	Date of Birth 0 1 1 6 1 9 4 9	Age 68	Gender M - Male F - Female							
Address, City, State, Zip 18750 EGBERT ROAD WALTON HILLS OH 44146 4236			Contact Phone - include area code 440-232-7119								
Injuries 1	Injured Taken By <input type="checkbox"/>	EMS Agency	Medical Facility Injured Taken To	Safety Equipment Used 0 4	DOT Compliant Motorcycle Helmet <input type="checkbox"/>	Seating Position 0 1	Air Bag Usage 1	Ejection 1	Trapped 1		
OL State OH	Operator License Number RL333825	OL Class 4	No Valid OL <input type="checkbox"/>	M/C End <input type="checkbox"/>	Condition 1	Alcohol/Drug Suspected 1	Alcohol Test Status 1	Alcohol Test Type 1	Alcohol Test Value	Drug Test Status 1	Drug Test Type 1
Offense Charged (Local Code) <input type="checkbox"/>	Offense Description		Citation Number		Hands-Free Device Used <input type="checkbox"/>	Driver Distracted By 1					

Injuries 1 - No Injury/None Reported 2 - Possible 3 - Non-Incapacitating 4 - Incapacitating 5 - Fatal	Injured Taken By 1 - Not Transported / Treated at Scene 2 - EMS 3 - Police 4 - Other 9 - Unknown	Safety Equipment Used Motorist 01 - None Used - Vehicle Occupant 02 - Shoulder Belt Only Used 03 - Lap Belt Only Used 04 - Shoulder Belt and Lap Belt Used Non-Motorist 05 - Child Restraint System-Forward Facing 06 - Child Restraint System-Rear Facing 07 - Booster Seat 08 - Helmet Used	99 - Unknown Safety Equipment	Non-Motorist 09 - None Used 10 - Helmet Used 11 - Protective Pads Used (Elbows, Knees, Etc) 12 - Reflective Clothing 13 - Lighting 14 - Other
---	--	--	-------------------------------	--

Seating Position 01 - Front - Left Side (Motorcycle Driver) 02 - Front - Middle 03 - Front - Right Side 04 - Second - Left Side (Motorcycle Passenger) 05 - Second - Middle 06 - Second - Right Side 07 - Third - Left Side (Motorcycle Side Car) 08 - Third - Middle 09 - Third - Right Side 10 - Sleeper Section of Cab (Truck) 11 - Passenger in Other Enclosed Cargo Area (Non-Trailing Unit Such as a Bus, Pick-up with Cab) 12 - Passenger in Unenclosed Cargo Area 13 - Trailing Unit 14 - Riding on Vehicle Exterior (Non-Trailing Unit) 15 - Non-Motorist 16 - Other 99 - Unknown	Air Bag Usage 1 - Not Deployed 2 - Deployed Front 3 - Deployed Side 4 - Deployed Both Front/Side 5 - Not Applicable 9 - Deployment Unknown
--	---

Ejection 1 - Not Ejected 2 - Totally Ejected 3 - Partially Ejected 4 - Not Applicable	Trapped 1 - Not Trapped 2 - Extricated by Mechanical Means 3 - Extricated by Non-Mechanical Means	Operator License Class 1 - Class A 2 - Class B 3 - Class C 4 - Regular Class (Ohio is "D") 5 - MC/Moped Only	Condition 1 - Apparently Normal 2 - Physical Impairment 3 - Emotional (Depressed, Angry, Disturbed) 4 - Illness 5 - Fell Asleep, Fainted, Fatigued 6 - Under The Influence of Medications, Drugs, Alcohol 7 - Other	Alcohol/Drug Suspected 1 - None 2 - Yes - Alcohol Suspected 3 - Yes - HBD Not Impaired 4 - Yes - Drugs Suspected 5 - Yes - Alcohol and Drugs Suspected
--	---	--	---	--

Alcohol Test Status 1 - None Given 2 - Test Refused 3 - Test Given, Contaminated Sample/Unusable 4 - Test Given, Results Known 5 - Test Given, Results Unknown	Alcohol Test Type 1 - None 2 - Blood 3 - Urine 4 - Breath 5 - Other	Drug Test Status 1 - None Given 2 - Test Refused 3 - Test Given, Contaminated Sample/Unusable 4 - Test Given, Results Known 5 - Test Given, Results Unknown	Drug Test Type 1 - None 2 - Blood 3 - Urine 4 - Other	Driver Distracted By 1 - No Distraction Reported 2 - Phone 3 - Texting/E-mailing 4 - Electronic Communication Device 5 - Other Electronic Device (Navigation Device, Radio, DVD) 6 - Other Inside the Vehicle 7 - External Distraction
--	---	---	--	--

Occupant

Unit Number 	Name: Last, First, Middle	Date of Birth 	Age	Gender F - Female M - Male
Address, City, State, Zip			Contact Phone - include area code	

Injuries <input type="checkbox"/>	Injured Taken By <input type="checkbox"/>	EMS Agency	Medical Facility Injured Taken To	Safety Equipment Used <input type="checkbox"/>	DOT Compliant Motorcycle Helmet <input type="checkbox"/>	Seating Position <input type="checkbox"/>	Air Bag Usage <input type="checkbox"/>	Ejection <input type="checkbox"/>	Trapped <input type="checkbox"/>
--------------------------------------	--	------------	-----------------------------------	---	---	--	---	--------------------------------------	-------------------------------------

Occupant

Unit Number 	Name: Last, First, Middle	Date of Birth 	Age	Gender F - Female M - Male
Address, City, State, Zip			Contact Phone - include area code	

Injuries <input type="checkbox"/>	Injured Taken By <input type="checkbox"/>	EMS Agency	Medical Facility Injured Taken To	Safety Equipment Used <input type="checkbox"/>	DOT Compliant Motorcycle Helmet <input type="checkbox"/>	Seating Position <input type="checkbox"/>	Air Bag Usage <input type="checkbox"/>	Ejection <input type="checkbox"/>	Trapped <input type="checkbox"/>
--------------------------------------	--	------------	-----------------------------------	---	---	--	---	--------------------------------------	-------------------------------------