



Traffic Crash Report

Local Report Number *	Crash Severity	Hit/Skip
20182399	3 - 1 - Fatal 2 - Injury 3 - PDO	1 - Solved 2 - Unsolved

Local Information		Reporting Agency NCIC *	Reporting Agency Name *	Number of Units	Unit in error
<input type="checkbox"/> Photos Taken <input type="checkbox"/> OH-2 <input type="checkbox"/> OH-3	<input type="checkbox"/> PDO Under State Reportable Dollar Amount	01820	GARFIELD HEIGHTS	02	01 98 - Animal 99 - Unknown

County *	<input checked="" type="checkbox"/> City * <input type="checkbox"/> Village * <input type="checkbox"/> Township *	City, Village, Township *	Crash Date *	Time of Crash	Day of Week
18		GARFIELD HTS	07072018	0908	SAT

Degrees / Minutes / Seconds Latitude	Longitude	Decimal Degrees Latitude	Longitude
		41.411956	-81.615274

Roadway Division	Divided Lane Direction of Travel	Number of Thru Lanes	Road Types or Milepost ²
<input checked="" type="checkbox"/> Divided <input type="checkbox"/> Undivided	W N - Northbound S - Southbound	04	AL - Alley CR - Circle HE - Heights MP - Milepost PL - Place ST - Street WA - Way AV - Avenue CT - Court HW - Highway PK - Parkway RD - Road TE - Terrace BL - Boulevard DR - Drive LA - Lane PI - Pike SQ - Square TL - Trail

Location Route Type ¹	Location Route Number	Loc. Prefix	Location Road name	Location Road Type ²	Route Types ¹
IR	480				IR - Interstate Route (inc. turnpike) US - US Route SR - State Route CR - Numbered County Route TR - Numbered Township Route

Distance From Reference	Dir From Ref	Reference Route Type ¹	Reference Route Number	Ref Prefix	Reference Name (Road, Milepost, House #)	Reference Road Type ²
	N,S,E,W			N,S,E,W	21.8	MP

Reference Point Used	Crash Location	Reference Point Used	Location of First Harmful Event
2 - Mile Post	01	01 - Not an intersection 02 - Four-way Intersection 03 - T-Intersection 04 - Y-Intersection 05 - Traffic Circle/Roundabout	1 - On Roadway 2 - On Shoulder 3 - In Median 4 - On Roadside 5 - On Gore 6 - Outside Trafficway 9 - Unknown

Road Contour	Road Conditions	01 - Dry 02 - Wet 03 - Snow 04 - Ice	05 - Sand, Mud, Dirt, Oil, gravel 06 - Water (Standing, Moving) 07 - Slush 08 - Debris*	09 - Rut, Holes, Bumps, Uneven Pavement* 10 - Other 99 - Unknown
1 - Straight Level 2 - Straight Grade 3 - Curve Level	01			* Secondary Condition Only

Manner of Crash Collision/Impact	Weather
2 - Rear-End 3 - Head-On 4 - Rear-to-Rear	1 - Clear 2 - Cloudy 3 - Fog, Smog, Smoke 4 - Rain 5 - Sleet, Hail 6 - Snow 7 - Severe Crosswinds 8 - Blowing Sand, Soil, Dirt, Snow 9 - Other/Unknown

Road Surface	Light conditions	School Bus Related
1 - Concrete 2 - Blacktop, Bituminous, Asphalt 3 - Brick/Block 4 - Slag, Gravel, Stone 5 - Dirt 6 - Other	1 - Daylight 2 - Dawn 3 - Dusk 4 - Dark - Lighted Roadway 5 - Dark - Roadway Not Lighted 6 - Dark - Unknown Roadway Lighting 7 - Glare* 8 - Other 9 - Unknown	<input type="checkbox"/> School Zone Related <input type="checkbox"/> Yes, School Bus Directly Involved <input type="checkbox"/> Yes, School Bus Indirectly Involved

Work Zone Related	Type of Work Zone	Location of Crash in Work Zone
<input type="checkbox"/> Workers Present <input type="checkbox"/> Law Enforcement Present (Officer/Vehicle) <input type="checkbox"/> Law Enforcement Present (Vehicle Only)	1 - Lane Closure 2 - Lane Shift/Crossover 3 - Work on Shoulder or Median 4 - Intermittent or Moving Work 5 - Other	1 - Before the first Work Zone Warning Sign 2 - Advance Warning Area 3 - Transition Area 4 - Activity Area 5 - Termination Area

Narrative

UNIT 2 TRAVELLING W/B ON 480 AT MILE POST 21/8

STOPPED IN TRAFFIC WHEN UNIT 1 FAILED TO STOP AND

STRUCK UNIT 2 FROM BEHIND

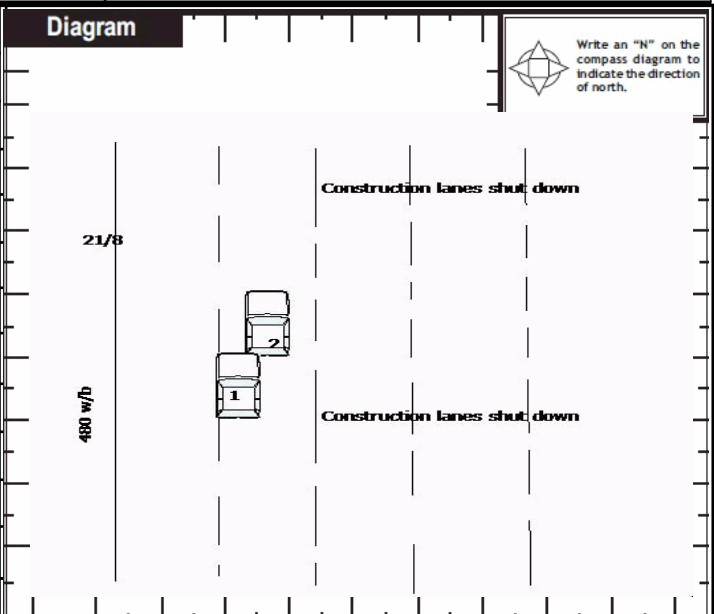

Report Taken By	Supplement (Correction or Addition to an Existing Report Sent to ODPs)	Date Crash Reported	Time Crash Reported	Dispatch Time	Arrival Time	Time Cleared	Other Investigation Time	Total Minutes
<input checked="" type="checkbox"/> Police Agency <input type="checkbox"/> Motorist		07072018	0908	0910	0929	1000	0	31
Officer's Name *	Officer's Badge Number	Checked By	Page of					
M. Krejci	053	L09 T. Murphy						



Unit

Local Report Number *

2 0 1 8 2 3 9 9

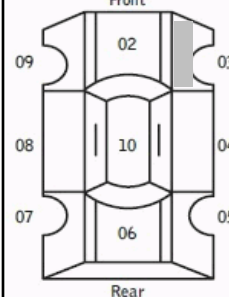
Unit Number 01		Owner Name: Last, First, Middle (<input checked="" type="checkbox"/> Same As Driver) ZEDWICK CRAIG A		Owner Phone Number - inc. area code (<input checked="" type="checkbox"/> Same As Driver) 331-422-9086		Damage Scale 4		Damaged Area 			
Owner Address, City, State, Zip (<input checked="" type="checkbox"/> Same As Driver) 2032 CHAD CT MONTGOMERY IL 60538											
LP State IL		License Plate Number E741138		Vehicle Identification Number 5TDYK3DC2CS199072				# Occupants 06			
Vehicle Year 2012		Vehicle Make TOYT Toyota		Vehicle Model SNA Sienna		Vehicle Color GRY Gray					
<input checked="" type="checkbox"/> Proof of Insurance Shown		Insurance Company NATIONWIDE		Policy Number 9112J047258		Towed By					
Carrier Name, Address, City, State, Zip								Carrier Phone - include area code			
US DOT		Vehicle Weight GVWR/GCWR <input type="checkbox"/> 1 - Less Than or Equal to 10k Lbs. <input type="checkbox"/> 2 - 10,001 to 26,000 Lbs. <input type="checkbox"/> 3 - More Than 26,000 Lbs.		Cargo Body Type 01 01 - No Cargo Body Type/Not Applicable 02 - Bus/Van(9-15 Seats, Inc.Driver) 03 - Bus(16+ Seats, Inc Driver) 04 - Vehicle Towing Another Vehicle 05 - Logging 06 - Intermodal Container Chassis 07 - Cargo Van/Enclosed Box 08 - Grain, Chips, Gravel		09 - Pole 10 - Cargo Tank 11 - Flat Bed 12 - Dump 13 - Concrete Mixer 14 - Auto Transporter 15 - Garbage/Refuse 99 - Other/Unknown		Trafficway Description 3 1 - Two-Way, Not Divided 2 - Two-Way, Not Divided, Continuous Left Turn Lane 3 - Two-Way, Divided, Unprotected (Painted or Grass>4 Ft.) Median 4 - Two-Way, Divided, Positive Median Barrier 5 - One-Way Trafficway <input type="checkbox"/> Hit / Skip Unit			
HM Placard ID No.		<input type="checkbox"/> Hazardous Material Released		HM Class Number		<input type="checkbox"/> Has HM Placard					
Non-Motorist Location Prior to Impact 01 - Intersection - Marked Crosswalk 02 - Intersection - No Crosswalk 03 - Intersection - Other 04 - Midblock - Marked Crosswalk 05 - Travel Lane - Other Location 06 - Bicycle Lane 07 - Shoulder/Roadside 08 - Sidewalk 09 - Median/Crossing Island 10 - Driveway Access 11 - Shared-Use Path or Trail 12 - Non-Trafficway Area 99 - Other/Unknown			Type of Use 1 1 - Personal 2 - Commercial 3 - Government <input type="checkbox"/> In Emergency Response		Unit Type 05 99 - Unknown or Hit/Skip 01 - Sub-Compact 02 - Compact 03 - Mid Size 04 - Full Size 05 - Minivan 06 - Sports Utility Vehicle 07 - Pickup 08 - Van 09 - Motorcycle 10 - Motorized Bicycle 11 - Snowmobile/ATV 12 - Other Passenger Vehicle		Passenger Vehicle (less than 9 passengers) Med/Heavy Trucks or Combo Units>10k lbs Bus/Van/Limo (9 or More Including Driver)		21 - Bus/Van (9-15 Seats, Inc Driver) 22 - Bus(16+ Seats, Inc Driver) 23 - Animal with Rider 24 - Animal with Buggy, Wagon, Surrey 25 - Bicycle/Pedacyclist 26 - Pedestrian/Skater 27 - Other Non-Motorist		
Special Function 01 01 - None 02 - Taxi 03 - Rental Truck (Over 10K Lbs) 04 - Bus - School (Public or Private) 05 - Bus - Transit 06 - Bus - Charter 07 - Bus - Shuttle 08 - Bus - Other			09 - Ambulance 10 - Fire 11 - Highway/Maintenance 12 - Military 13 - Police 14 - Public Utility 15 - Other Government 16 - Construction Equip.		17 - Farm Vehicle 18 - Farm Equipment 19 - Motorhome 20 - Golf Cart 21 - Train 22 - Other (Explain in Narrative)		Most Damaged Area 03 01 - None 02 - Center Front 03 - Right Front 04 - Right Side 05 - Right Rear 06 - Rear Center 07 - Left Rear 08 - Left Side 09 - Left Front 10 - Top and Windows 11 - Undercarriage 12 - Load/Trailer 13 - Total (All Areas) 14 - Other		Action 3 1 - Non-Contact 2 - Non-Collision 3 - Striking 4 - Struck 5 - Striking/Struck 9 - Unknown		
Pre-Crash Actions 01 01 - Straight Ahead 02 - Backing 03 - Changing Lanes 99 - Unknown 04 - Overtaking/Passing 05 - Making Right Turn 06 - Making Left Turn			Motorist 07 - Making U-Turn 08 - Entering Traffic Lane 09 - Leaving Traffic Lane 10 - Parked 11 - Slowing or Stopped in Traffic 12 - Driverless		13 - Negotiating a Curve 14 - Other Motorist Action		Non-Motorist 15 - Entering or Crossing Specified Location 16 - Walking, Running, Jogging, Playing, Cycling 17 - Working 18 - Pushing Vehicle 19 - Approaching or Leaving Vehicle 20 - Standing		21 - Other Non-Motorist Action		
Contributing Circumstances Primary 09 01 - None 02 - Failure to Yield 03 - Ran Red Light 04 - Ran Stop Sign Secondary <input type="checkbox"/> 05 - Exceeded Speed Limit 06 - Unsafe Speed 07 - Improper Turn 08 - Left of Center 99 - Unknown 09 - Followed Too Closely/ACDA 10 - Improper Lane Change /Passing/Off Road			Motorist 11 - Improper Backing 12 - Improper Start From Parked Position 13 - Stopped or Parked Illegally 14 - Operating Vehicle in Negligent Manner 15 - Swerving to Avoid (Due to External Conditions) 16 - Wrong Side/Wrong Way 17 - Failure to Control 18 - Vision Obstruction 19 - Operating Defective Equipment 20 - Load Shifting/Falling/Spilling 21 - Other Improper Action		Non-Motorist 22 - None 23 - Improper Crossing 24 - Darting 25 - Lying and/or Illegally in Roadway 26 - Failure to Yield Right of Way 27 - Not Visible (Dark Clothing) 28 - Inattentive 29 - Failure to Obey Traffic Signs /Signals/Officer 30 - Wrong Side of the Road 31 - Other Non-Motorist Action		Vehicle Defects <input type="checkbox"/> 01 - Turn Signals 02 - Head Lamps 03 - Tail Lamps 04 - Brakes 05 - Steering 06 - Tire Blowout 07 - Worn or Slick tires 08 - Trailer Equipment Defective 09 - Motor Trouble 10 - Disabled From Prior Accident 11 - Other Defects				
Sequence of Events 1 20 2 <input type="checkbox"/> 3 <input type="checkbox"/> 4 <input type="checkbox"/> 5 <input type="checkbox"/> 6 <input type="checkbox"/> First Harmful Event 1 Most Harmful Event 1 99 - Unknown			Non-Collision Events 01 - Overturn/Rollover 02 - Fire/Explosion 03 - Immersion 04 - Jackknife 05 - Cargo/Equipment Loss or Shift		06 - Equipment Failure (Blown Tire, Brake Failure, etc) 07 - Separation of Units 08 - Ran Off Road Right 09 - Ran Off Road Left		10 - Cross Median 11 - Cross Center Line Opposite Direction of Travel 12 - Downhill Runaway 13 - Other Non-Collision				
Collision with Person, Vehicle or Object Not Fixed 14 - Pedestrian 15 - Pedalcycle 16 - Railway Vehicle (Train,Engine) 17 - Animal - Farm 18 - Animal - Deer 19 - Animal - Other 20 - Motor Vehicle in Transport			Collision With Fixed Object 21 - Parked Motor Vehicle 22 - Work Zone Maintenance Equipment 23 - Struck by Falling, Shifting Cargo or Anything Set in Motion by a Motor Vehicle 24 - Other Movable Object		25 - Impact Attenuator/Crash Cushion 26 - Bridge Overhead Structure 27 - Bridge Pier or Abutment 28 - Bridge Parapet 29 - Bridge Rail 30 - Guardrail Face 31 - Guardrail End 32 - Portable Barrier		33 - Median Cable Barrier 34 - Median Guardrail Barrier 35 - Median Concrete Barrier 36 - Median Other Barrier 37 - Traffic Sign Post 38 - Overhead Sign Post 39 - Light/Luminaries Support 40 - Utility Pole		41 - Other Post, Pole or Support 42 - Culvert 43 - Curb 44 - Ditch 45 - Embankment 46 - Fence 47 Mailbox		
Unit Speed 60		Posted Speed 60		Traffic Control 01 01 - No Controls 02 - Stop Sign 03 - Yield Sign 04 - Traffic Signal 05 - Traffic Flashers 06 - School Zone		07 - Railroad Crossbucks 08 - Railroad Flashers 09 - Railroad Gates 10 - Construction Barricade 11 - Person (Flagger, Officer) 12 - Pavement Markings		Unit Direction From 3 To 4 1 - North 2 - South 3 - East 4 - West		5 - Northeast 6 - Northwest 7 - Southeast 8 - Southwest 9 - Unknown	



Unit

Local Report Number *

2 0 1 8 2 3 9 9

Unit Number 02		Owner Name: Last, First, Middle (<input checked="" type="checkbox"/> Same As Driver) LYDIC ASHLEY N		Owner Phone Number - inc. area code (<input checked="" type="checkbox"/> Same As Driver) 330-770-3594		Damage Scale 4	Damaged Area 		
Owner Address, City, State, Zip (<input checked="" type="checkbox"/> Same As Driver) 38838 LONGS CROSSING RD LEETONIA OH 44431 9788									
LP State OH		License Plate Number HHS2924		Vehicle Identification Number 2GKFLWEK6F6157020		# Occupants 02			
Vehicle Year 2015		Vehicle Make GMC GMC		Vehicle Model TRN Terrain		Vehicle Color BLK Black			
<input type="checkbox"/> Proof of Insurance Shown		Insurance Company erie		Policy Number		Towed By			
Carrier Name, Address, City, State, Zip						Carrier Phone - include area code			
US DOT		Vehicle Weight GVWR/GCWR <input type="checkbox"/> 1 - Less Than or Equal to 10k Lbs. <input type="checkbox"/> 2 - 10,001 to 26,000 Lbs. <input type="checkbox"/> 3 - More Than 26,000 Lbs.		Cargo Body Type 01 01 - No Cargo Body Type/Not Applicable 02 - Bus/Van(9-15 Seats, Inc.Driver) 03 - Bus(16+ Seats, Inc Driver) 04 - Vehicle Towing Another Vehicle 05 - Logging 06 - Intermodal Container Chassis 07 - Cargo Van/Enclosed Box 08 - Grain, Chips, Gravel		Traficway Description 3 1 - Two-Way, Not Divided 2 - Two-Way, Not Divided, Continuous Left Turn Lane 3 - Two-Way, Divided, Unprotected (Painted or Grass>4 Ft.) Median 4 - Two-Way, Divided, Positive Median Barrier 5 - One-Way Traficway <input type="checkbox"/> Hit / Skip Unit			
HM Placard ID No.		<input type="checkbox"/> Hazardous Material Released		09 - Pole 10 - Cargo Tank 11 - Flat Bed 12 - Dump 13 - Concrete Mixer 14 - Auto Transporter 15 - Garbage/Refuse 99 - Other/Unknown					
HM Class Number									
Non-Motorist Location Prior to Impact 01 - Intersection - Marked Crosswalk 02 - Intersection - No Crosswalk 03 - Intersection - Other 04 - Midblock - Marked Crosswalk 05 - Travel Lane - Other Location 06 - Bicycle Lane 07 - Shoulder/Roadside 08 - Sidewalk 09 - Median/Crossing Island 10 - Driveway Access 11 - Shared-Use Path or Trail 12 - Non-Traficway Area 99 - Other/Unknown		Type of Use 1 1 - Personal 2 - Commercial 3 - Government <input type="checkbox"/> In Emergency Response		Unit Type 06 01 - Sub-Compact 02 - Compact 03 - Mid Size 04 - Full Size 05 - Minivan 06 - Sports Utility Vehicle 07 - Pickup 08 - Van 09 - Motorcycle 10 - Motorized Bicycle 11 - Snowmobile/ATV 12 - Other Passenger Vehicle		Passenger Vehicle (less than 9 passengers) Med/Heavy Trucks or Combo Units>10k lbs Bus/Van/Limo (9 or More Including Driver) 21 - Bus/Van (9-15 Seats, Inc Driver) 22 - Bus(16+ Seats, Inc Driver) Non-Motorist 23 - Animal with Rider 24 - Animal with Buggy, Wagon, Surrey 25 - Bicycle/Pedacyclist 26 - Pedestrian/Skater 27 - Other Non-Motorist			
Special Function 01 01 - None 02 - Taxi 03 - Rental Truck (Over 10K Lbs) 04 - Bus - School (Public or Private) 05 - Bus - Transit 06 - Bus - Charter 07 - Bus - Shuttle 08 - Bus - Other		09 - Ambulance 10 - Fire 11 - Highway/Maintenance 12 - Military 13 - Police 14 - Public Utility 15 - Other Government 16 - Construction Equip.		17 - Farm Vehicle 18 - Farm Equipment 19 - Motorhome 20 - Golf Cart 21 - Train 22 - Other (Explain in Narrative)		Most Damaged Area 07 01 - None 02 - Center Front 03 - Right Front 04 - Right Side 05 - Right Rear 06 - Rear Center 07 - Left Rear 08 - Left Side 09 - Left Front 10 - Top and Windows 11 - Undercarriage 12 - Load/Trailer 13 - Total (All Areas) 14 - Other		Action 4 1 - Non-Contact 2 - Non-Collision 3 - Striking 4 - Struck 5 - Striking/Struck 9 - Unknown	
Pre-Crash Actions 11 01 - Straight Ahead 02 - Backing 03 - Changing Lanes 99 - Unknown 04 - Overtaking/Passing 05 - Making Right Turn 06 - Making Left Turn		Motorist 07 - Making U-Turn 08 - Entering Traffic Lane 09 - Leaving Traffic Lane 10 - Parked 11 - Slowing or Stopped in Traffic 12 - Driverless		13 - Negotiating a Curve 14 - Other Motorist Action		Non-Motorist 15 - Entering or Crossing Specified Location 16 - Walking, Running, Jogging, Playing, Cycling 17 - Working 18 - Pushing Vehicle 19 - Approaching or Leaving Vehicle 20 - Standing		21 - Other Non-Motorist Action	
Contributing Circumstances Primary 01 01 - None 02 - Failure to Yield 03 - Ran Red Light 04 - Ran Stop Sign Secondary <input type="checkbox"/> 05 - Exceeded Speed Limit 06 - Unsafe Speed 07 - Improper Turn 08 - Left of Center 99 - Unknown 09 - Followed Too Closely/ACDA 10 - Improper Lane Change /Passing/Off Road		Motorist 11 - Improper Backing 12 - Improper Start From Parked Position 13 - Stopped or Parked Illegally 14 - Operating Vehicle in Negligent Manner 15 - Swerving to Avoid (Due to External Conditions) 16 - Wrong Side/Wrong Way 17 - Failure to Control 18 - Vision Obstruction 19 - Operating Defective Equipment 20 - Load Shifting/Falling/Spilling 21 - Other Improper Action		Non-Motorist 22 - None 23 - Improper Crossing 24 - Darting 25 - Lying and/or Illegally in Roadway 26 - Failure to Yield Right of Way 27 - Not Visible (Dark Clothing) 28 - Inattentive 29 - Failure to Obey Traffic Signs /Signals/Officer 30 - Wrong Side of the Road 31 - Other Non-Motorist Action		Vehicle Defects <input type="checkbox"/> 01 - Turn Signals 02 - Head Lamps 03 - Tail Lamps 04 - Brakes 05 - Steering 06 - Tire Blowout 07 - Worn or Slick tires 08 - Trailer Equipment Defective 09 - Motor Trouble 10 - Disabled From Prior Accident 11 - Other Defects			
Sequence of Events 1 20 2 <input type="checkbox"/> 3 <input type="checkbox"/> 4 <input type="checkbox"/> 5 <input type="checkbox"/> 6 <input type="checkbox"/> First Harmful Event 1 Most Harmful Event 1 99 - Unknown		Non-Collision Events 01 - Overturn/Rollover 02 - Fire/Explosion 03 - Immersion 04 - Jackknife 05 - Cargo/Equipment Loss or Shift		06 - Equipment Failure (Blown Tire, Brake Failure, etc) 07 - Separation of Units 08 - Ran Off Road Right 09 - Ran Off Road Left		10 - Cross Median 11 - Cross Center Line Opposite Direction of Travel 12 - Downhill Runaway 13 - Other Non-Collision			
Collision With Person, Vehicle or Object Not Fixed 14 - Pedestrian 15 - Pedalcycle 16 - Railway Vehicle (Train,Engine) 17 - Animal - Farm 18 - Animal - Deer 19 - Animal - Other 20 - Motor Vehicle in Transport		Collision With Fixed Object 21 - Parked Motor Vehicle 22 - Work Zone Maintenance Equipment 23 - Struck by Falling, Shifting Cargo or Anything Set in Motion by a Motor Vehicle 24 - Other Movable Object		25 - Impact Attenuator/Crash Cushion 26 - Bridge Overhead Structure 27 - Bridge Pier or Abutment 28 - Bridge Parapet 29 - Bridge Rail 30 - Guardrail Face 31 - Guardrail End 32 - Portable Barrier		33 - Median Cable Barrier 34 - Median Guardrail Barrier 35 - Median Concrete Barrier 36 - Median Other Barrier 37 - Traffic Sign Post 38 - Overhead Sign Post 39 - Light/Luminaries Support 40 - Utility Pole			
41 - Other Post, Pole or Support 42 - Culvert 43 - Curb 44 - Ditch 45 - Embankment 46 - Fence 47 Mailbox		48 - Tree 49 - Fire Hydrant 50 - Work Zone Maintenance Equipment 51 - Wall, Building, Tunnel 52 - Other Fixed Object		Unit Speed <input type="checkbox"/> Stated <input type="checkbox"/> Estimated 60		Posted Speed 60			
Traffic Control 01 01 - No Controls 02 - Stop Sign 03 - Yield Sign 04 - Traffic Signal 05 - Traffic Flashers 06 - School Zone		07 - Railroad Crossbucks 08 - Railroad Flashers 09 - Railroad Gates 10 - Construction Barricade 11 - Person (Flagger, Officer) 12 - Pavement Markings		13 - Crosswalk Lines 14 - Walk/Don't Walk 15 - Other 16 - Not Reported		Unit Direction From 3 To 4 1 - North 2 - South 3 - East 4 - West 5 - Northeast 6 - Northwest 7 - Southeast 8 - Southwest 9 - Unknown			



Motorist / Non-Motorist / Occupant

Local Report Number *

2 | 0 | 1 | 8 | 2 | 3 | 9 | 9 | | | | | | | |

Motorist/Non-Motorist

Motorist/Non-Motorist

Occupant

Occupant

Unit Number 0 2	Name: Last, First, Middle LYDIC ASHLEY N	Date of Birth 0 5 2 6 1 9 9 3	Age 25	Gender F - Female M - Male
----------------------	---	--	-----------	----------------------------------

Address, City, State, Zip 38838 LONGS CROSSING RD LEETONIA OH 44431 9788	Contact Phone - include area code 330-770-3594
---	---

Injuries 1	Injured Taken By	EMS Agency	Medical Facility Injured Taken To	Safety Equipment Used 0 4	DOT Compliant Motorcycle Helmet	Seating Position 0 1	Air Bag Usage 1	Ejection 1	Trapped 1
---------------	------------------	------------	-----------------------------------	--------------------------------	---------------------------------	---------------------------	--------------------	---------------	--------------

OL State OH	Operator License Number TR869127	OL Class 4	No Valid OL	M/C End	Condition 1	Alcohol/Drug Suspected 1	Alcohol Test Status 1	Alcohol Test Type 1	Alcohol Test Value	Drug Test Status 1	Drug Test Type 1
----------------	-------------------------------------	---------------	-------------	---------	----------------	-----------------------------	--------------------------	------------------------	--------------------	-----------------------	---------------------

Offense Charged (Local Code)	Offense Description	Citation Number	Hands-Free Device Used	Driver Distracted By 1
------------------------------	---------------------	-----------------	------------------------	---------------------------

Unit Number 0 1	Name: Last, First, Middle ZEDWICK CRAIG A	Date of Birth 1 1 2 1 1 9 7 4	Age 43	Gender M - Male F - Female
----------------------	--	--	-----------	----------------------------------

Address, City, State, Zip 2032 CHAD CT MONTGOMERY IL 60538	Contact Phone - include area code 331-422-9086
---	---

Injuries 1	Injured Taken By	EMS Agency	Medical Facility Injured Taken To	Safety Equipment Used 0 4	DOT Compliant Motorcycle Helmet	Seating Position 0 1	Air Bag Usage 1	Ejection 1	Trapped 1
---------------	------------------	------------	-----------------------------------	--------------------------------	---------------------------------	---------------------------	--------------------	---------------	--------------

OL State IL	Operator License Number Z32010174331	OL Class 4	No Valid OL	M/C End	Condition 1	Alcohol/Drug Suspected 1	Alcohol Test Status 1	Alcohol Test Type 1	Alcohol Test Value	Drug Test Status 1	Drug Test Type 1
----------------	---	---------------	-------------	---------	----------------	-----------------------------	--------------------------	------------------------	--------------------	-----------------------	---------------------

Offense Charged (Local Code) 333.03	Offense Description assured clear dist	Citation Number G20183403	Hands-Free Device Used	Driver Distracted By 1
--	---	------------------------------	------------------------	---------------------------

Injuries 1 - No Injury/None Reported 2 - Possible 3 - Non-Incapacitating 4 - Incapacitating 5 - Fatal	Injured Taken By 1 - Not Transported / Treated at Scene 2 - EMS 3 - Police 4 - Other 9 - Unknown	Safety Equipment Used Motorist 01 - None Used - Vehicle Occupant 02 - Shoulder Belt Only Used 03 - Lap Belt Only Used 04 - Shoulder Belt and Lap Belt Used Non-Motorist 05 - Child Restraint System-Forward Facing 06 - Child Restraint System-Rear Facing 07 - Booster Seat 08 - Helmet Used 99 - Unknown Safety Equipment	Non-Motorist 09 - None Used 10 - Helmet Used 11 - Protective Pads Used (Elbows, Knees, Etc) 12 - Reflective Clothing 13 - Lighting 14 - Other
---	--	---	--

Seating Position 01 - Front - Left Side (Motorcycle Driver) 02 - Front - Middle 03 - Front - Right Side 04 - Second - Left Side (Motorcycle Passenger) 05 - Second - Middle 06 - Second - Right Side 07 - Third - Left Side (Motorcycle Side Car) 08 - Third - Middle 09 - Third - Right Side 10 - Sleeper Section of Cab (Truck) 11 - Passenger in Other Enclosed Cargo Area (Non-Trailing Unit Such as a Bus, Pick-up with Cab) 12 - Passenger in Unenclosed Cargo Area 13 - Trailing Unit 14 - Riding on Vehicle Exterior (Non-Trailing Unit) 15 - Non-Motorist 16 - Other 99 - Unknown	Air Bag Usage 1 - Not Deployed 2 - Deployed Front 3 - Deployed Side 4 - Deployed Both Front/Side 5 - Not Applicable 9 - Deployment Unknown
--	---

Ejection 1 - Not Ejected 2 - Totally Ejected 3 - Partially Ejected 4 - Not Applicable	Trapped 1 - Not Trapped 2 - Extricated by Mechanical Means 3 - Extricated by Non-Mechanical Means	Operator License Class 1 - Class A 2 - Class B 3 - Class C 4 - Regular Class (Ohio is "D") 5 - MC/Moped Only	Condition 1 - Apparently Normal 2 - Physical Impairment 3 - Emotional (Depressed, Angry, Disturbed) 4 - Illness 5 - Fell Asleep, Fainted, Fatigued 6 - Under The Influence of Medications, Drugs, Alcohol 7 - Other	Alcohol/Drug Suspected 1 - None 2 - Yes - Alcohol Suspected 3 - Yes - HBD Not Impaired 4 - Yes - Drugs Suspected 5 - Yes - Alcohol and Drugs Suspected
--	---	--	---	--

Alcohol Test Status 1 - None Given 2 - Test Refused 3 - Test Given, Contaminated Sample/Unusable 4 - Test Given, Results Known 5 - Test Given, Results Unknown	Alcohol Test Type 1 - None 2 - Blood 3 - Urine 4 - Breath 5 - Other	Drug Test Status 1 - None Given 2 - Test Refused 3 - Test Given, Contaminated Sample/Unusable 4 - Test Given, Results Known 5 - Test Given, Results Unknown	Drug Test Type 1 - None 2 - Blood 3 - Urine 4 - Other	Driver Distracted By 1 - No Distraction Reported 2 - Phone 3 - Texting/E-mailing 4 - Electronic Communication Device 5 - Other Electronic Device (Navigation Device, Radio, DVD) 6 - Other Inside the Vehicle 7 - External Distraction
--	---	---	--	--

Unit Number 0 2	Name: Last, First, Middle SLATER JACK	Date of Birth 0 4 1 5 1 9 9 6	Age 22	Gender M - Male F - Female
----------------------	--	--	-----------	----------------------------------

Address, City, State, Zip 343 METZ RD E COLUMBIANA OH 44408	Contact Phone - include area code 330-277-6742
--	---

Injuries 1	Injured Taken By	EMS Agency	Medical Facility Injured Taken To	Safety Equipment Used 0 4	DOT Compliant Motorcycle Helmet	Seating Position 0 1	Air Bag Usage 1	Ejection 1	Trapped 1
---------------	------------------	------------	-----------------------------------	--------------------------------	---------------------------------	---------------------------	--------------------	---------------	--------------

Unit Number 0 1	Name: Last, First, Middle ZEDWICK NANCY	Date of Birth 1 1 2 1 1 9 7 4	Age 43	Gender F - Female M - Male
----------------------	--	--	-----------	----------------------------------

Address, City, State, Zip 2032 CHAD CT MONTGOMERY IL 60538	Contact Phone - include area code 331-422-9086
---	---

Injuries 1	Injured Taken By	EMS Agency	Medical Facility Injured Taken To	Safety Equipment Used 0 4	DOT Compliant Motorcycle Helmet	Seating Position 0 3	Air Bag Usage 1	Ejection 1	Trapped 1
---------------	------------------	------------	-----------------------------------	--------------------------------	---------------------------------	---------------------------	--------------------	---------------	--------------



Occupant / Witness Addendum

Local Report Number *

2 | 0 | 1 | 8 | 2 | 3 | 9 | 9 | | | | |

Occupant	Unit Number 0 1	Name: Last, First, Middle ZEDWICK AMANDA	Date of Birth 0 3 1 7 2 0 0 0	Age 18	Gender F F - Female M - Male						
	Address, City, State, Zip 2032 CHAD CT MONTGOMERY IL 60538			Contact Phone - include area code 331-422-9086							
	Injuries 1	Injured Taken By	EMS Agency	Medical Facility Injured Taken To	Safety Equipment Used 0 4	DOT Compliant Motorcycle Helmet <input type="checkbox"/>	Seating Position 0 4	Air Bag Usage 1	Ejection 1	Trapped 1	
Occupant	Unit Number 0 1	Name: Last, First, Middle ZEDWICK ALICIA	Date of Birth 0 7 2 4 2 0 0 6	Age 11	Gender F F - Female M - Male						
	Address, City, State, Zip 2032 CHAD CT MONTGOMERY IL 60538			Contact Phone - include area code 331-422-9086							
	Injuries 1	Injured Taken By	EMS Agency	Medical Facility Injured Taken To	Safety Equipment Used 0 4	DOT Compliant Motorcycle Helmet <input type="checkbox"/>	Seating Position 0 6	Air Bag Usage 1	Ejection 1	Trapped 1	
Occupant	Unit Number 0 1	Name: Last, First, Middle ZEDWICK AARON	Date of Birth 0 1 2 4 2 0 0 4	Age 14	Gender M F - Female M - Male						
	Address, City, State, Zip 2302 CHAD CT MONTGOMERY IL 60538			Contact Phone - include area code 331-422-9086							
	Injuries 1	Injured Taken By	EMS Agency	Medical Facility Injured Taken To	Safety Equipment Used 0 4	DOT Compliant Motorcycle Helmet <input type="checkbox"/>	Seating Position 0 8	Air Bag Usage 1	Ejection 1	Trapped 1	
Occupant	Unit Number 0 1	Name: Last, First, Middle ZEDWICK ANNE	Date of Birth 1 2 0 1 2 0 0 0	Age 17	Gender F F - Female M - Male						
	Address, City, State, Zip 2032 CHAD CT MONTGOMERY IL 60538			Contact Phone - include area code 331-422-9086							
	Injuries 1	Injured Taken By	EMS Agency	Medical Facility Injured Taken To	Safety Equipment Used 0 4	DOT Compliant Motorcycle Helmet <input type="checkbox"/>	Seating Position 0 7	Air Bag Usage 1	Ejection 1	Trapped 1	
Occupant	Unit Number 	Name: Last, First, Middle	Date of Birth 	Age	Gender F - Female M - Male						
	Address, City, State, Zip			Contact Phone - include area code							
	Injuries 	Injured Taken By	EMS Agency	Medical Facility Injured Taken To	Safety Equipment Used 	DOT Compliant Motorcycle Helmet <input type="checkbox"/>	Seating Position 	Air Bag Usage 	Ejection 	Trapped 	
Occupant	Unit Number 	Name: Last, First, Middle	Date of Birth 	Age	Gender F - Female M - Male						
	Address, City, State, Zip			Contact Phone - include area code							
	Injuries 	Injured Taken By	EMS Agency	Medical Facility Injured Taken To	Safety Equipment Used 	DOT Compliant Motorcycle Helmet <input type="checkbox"/>	Seating Position 	Air Bag Usage 	Ejection 	Trapped 	
Injuries		Injured Taken By		Safety Equipment Used		99 - Unknown Safety Equipment					
1 - No Injury/None Reported 2 - Possible 3 - Non-Incapacitating 4 - Incapacitating 5 - Fatal		1 - Not Transported / Treated at Scene 2 - EMS 3 - Police 4 - Other 9 - Unknown		Motorist 01 - None Used - Vehicle Occupant 02 - Shoulder Belt Only Used 03 - Lap Belt Only Used 04 - Shoulder Belt and Lap Belt Used		Non-Motorist 05 - Child Restraint System-Forward Facing 06 - Child Restraint System-Rear Facing 07 - Booster Seat 08 - Helmet Used		09 - None Used 10 - Helmet Used 11 - Protective Pads Used (Elbows, Knees, Etc)		12 - Reflective Clothing 13 - Lighting 14 - Other	
Seating Position				Air Bag Usage		Ejection		Trapped			
01 - Front - Left Side (Motorcycle Driver) 02 - Front - Middle 03 - Front - Right Side 04 - Second - Left Side (Motorcycle Passenger) 05 - Second - Middle 06 - Second - Right Side 07 - Third - Left Side (Motorcycle Side Car) 08 - Third - Middle 09 - Third - Right Side 10 - Sleeper Section of Cab (Truck)				11 - Passenger in Other Enclosed Cargo Area (Non-Trailing Unit Such as a Bus, Pick-up with Cab) 12 - Passenger in Unenclosed Cargo Area 13 - Trailing Unit 14 - Riding on Vehicle Exterior (Non-Trailing Unit) 15 - Non-Motorist 16 - Other 99 - Unknown		1 - Not Deployed 2 - Deployed Front 3 - Deployed Side 4 - Deployed Both Front/Side 5 - Not Applicable 9 - Deployment Unknown		1 - Not Ejected 2 - Totally Ejected 3 - Partially Ejected 4 - Not Applicable		1 - Not Trapped 2 - Extricated by Mechanical Means 3 - Extricated by Non-Mechanical Means	
Page of											