



Traffic Crash Report

Local Report Number *	Crash Severity	Hit/Skip
2 0 1 8 2 6 9 1	3 1 - Fatal 2 - Injury 3 - PDO	1 - Solved 2 - Unsolved

Local Information		Reporting Agency NCIC *	Reporting Agency Name *	Number of Units	Unit in error
<input type="checkbox"/> Photos Taken <input type="checkbox"/> OH-2 <input type="checkbox"/> OH-1P <input type="checkbox"/> OH-3 <input type="checkbox"/> Other	<input type="checkbox"/> PDO Under State Reportable Dollar Amount	<input type="checkbox"/> Private Property	0 1 8 2 0	GARFIELD HEIGHTS	0 2 98 - Animal 99 - Unknown

County *	<input checked="" type="checkbox"/> City * <input type="checkbox"/> Village * <input type="checkbox"/> Township *	City, Village, Township *	Crash Date *	Time of Crash	Day of Week
1 8		GARFIELD HTS	0 7 2 7 2 0 1 8	0 9 2 2	F R I

Degrees / Minutes / Seconds Latitude	Longitude	Decimal Degrees Latitude	Longitude
° ' . "	- ° ' . "	.	- .

Roadway Division	Divided Lane Direction of Travel	Number of Thru Lanes	Road Types or Milepost ²
<input checked="" type="checkbox"/> Divided <input type="checkbox"/> Undivided	W N - Northbound S - Southbound	0 4	AL - Alley CR - Circle HE - Heights MP - Milepost PL - Place ST - Street WA - Way AV - Avenue CT - Court HW - Highway PK - Parkway RD - Road TE - Terrace BL - Boulevard DR - Drive LA - Lane PI - Pike SQ - Square TL - Trail

Location Route 1	Location Route Number	Loc. Prefix	Location Road name	Location Road Type 2	Route Types ¹
I R	4 8 0	N, S, E, W		H W	IR - Interstate Route (inc. turnpike) US - US Route SR - State Route CR - Numbered County Route TR - Numbered Township Route

Distance From Reference	Dir From Ref	Reference Route Type 1	Reference Route Number	Ref Prefix	Reference Name (Road, Milepost, House #)	Reference Road Type 2
<input type="checkbox"/> Miles <input type="checkbox"/> Feet <input type="checkbox"/> Yards	N, S, E, W			N, S, E, W	21.06	M P

Reference Point Used	Crash Location	Reference Point	Reference Name	Intersection Related	Location of First Harmful Event
2 1 - Intersection 2 - Mile Post 3 - House Number	0 1	01 - Not an intersection 02 - Four-way Intersection 03 - T-Intersection 04 - Y-Intersection 05 - Traffic Circle/Roundabout	06 - Five-point, or more 07 - On Ramp 08 - Off Ramp 09 - Crossover 10 - Driveway/Alley Access	<input type="checkbox"/>	1 1 - On Roadway 2 - On Shoulder 3 - In Median 4 - On Roadside 5 - On Gore 6 - Outside Trafficway 9 - Unknown

Road Contour	Road Conditions	01 - Dry 02 - Wet 03 - Snow 04 - Ice	05 - Sand, Mud, Dirt, Oil, gravel 06 - Water (Standing, Moving) 07 - Slush 08 - Debris*	09 - Rut, Holes, Bumps, Uneven Pavement* 10 - Other 99 - Unknown
1 1 - Straight Level 2 - Straight Grade 3 - Curve Level 4 - Curve Grade 9 - Unknown	0 1			* Secondary Condition Only

Manner of Crash Collision/Impact	Weather
2 1 - Not Collision Between Two Motor Vehicles In Transport 2 - Rear-End 3 - Head-On 4 - Rear-to-Rear 5 - Backing 6 - Angle 7 - Sideswipe, Same Direction 8 - Sideswipe, Opposite Direction 9 - Unknown	1 1 - Clear 2 - Cloudy 3 - Fog, Smog, Smoke 4 - Rain 5 - Sleet, Hail 6 - Snow 7 - Severe Crosswinds 8 - Blowing Sand, Soil, Dirt, Snow 9 - Other/Unknown

Road Surface	Light conditions	School Bus Related
2 1 - Concrete 2 - Blacktop, Bituminous, Asphalt 3 - Brick/Block 4 - Slag, Gravel, Stone 5 - Dirt 6 - Other	1 Primary Secondary 1 - Daylight 2 - Dawn 3 - Dusk 4 - Dark - Lighted Roadway 5 - Dark - Roadway Not Lighted 6 - Dark - Unknown Roadway Lighting 7 - Glare* 8 - Other 9 - Unknown	<input type="checkbox"/> School Zone Related <input type="checkbox"/> Yes, School Bus Directly Involved <input type="checkbox"/> Yes, School Bus Indirectly Involved

Work Zone Related	Type of Work Zone	Location of Crash in Work Zone
<input checked="" type="checkbox"/> Work Zone Related <input type="checkbox"/> Workers Present <input type="checkbox"/> Law Enforcement Present (Officer/Vehicle) <input type="checkbox"/> Law Enforcement Present (Vehicle Only)	5 1 - Lane Closure 2 - Lane Shift/Crossover 3 - Work on Shoulder or Median 4 - Intermittent or Moving Work 5 - Other	3 1 - Before the first Work Zone Warning Sign 2 - Advance Warning Area 3 - Transition Area 4 - Activity Area 5 - Termination Area

Narrative

UNIT # 1 WAS STOPPED IN TRAFFIC ON IR 480 W/B AT MP # 21/6 WHEN UNIT # 2 STRUCK UNIT # 1 IN THE REAR. UNIT # 2 WAS TOWING A CAMPER AT THE TIME OF THE CRASH. DRIVER OF UNIT # 2 STATES THAT UNIT # 2 DID NOT STOP IN TIME DUE TO THE EXTRA WEIGHT FROM THE CAMPER. CAMPER REGISTRATION SVP1744

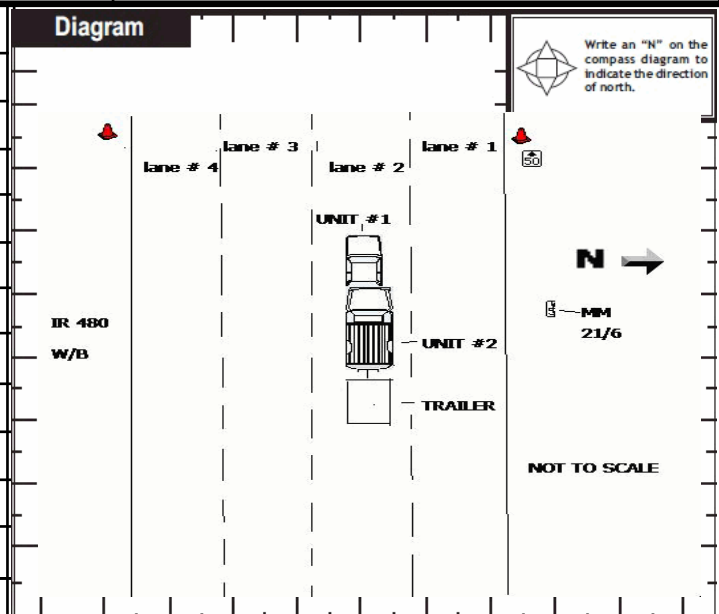

Report Taken By	Supplement (Correction or Addition to an Existing Report Sent to ODPS)	Date Crash Reported	Time Crash Reported	Dispatch Time	Arrival Time	Time Cleared	Other Investigation Time	Total Minutes
<input checked="" type="checkbox"/> Police Agency <input type="checkbox"/> Motorist	<input type="checkbox"/>	0 7 2 7 2 0 1 8	0 9 2 2	0 9 2 4	0 9 2 4	1 0 0 0	3 0	6 6

Officer's Name *	Officer's Badge Number	Checked By	Page of
P. Dickens	011	L12 D. Merchant	



Unit

Local Report Number *

2 0 1 8 2 6 9 1

Unit Number 02		Owner Name: Last, First, Middle (<input type="checkbox"/> Same As Driver) MCGINNIS STEVEN		Owner Phone Number - inc. area code (<input type="checkbox"/> Same As Driver) 740-354-3168		Damage Scale 2		Damaged Area 	
Owner Address, City, State, Zip (<input type="checkbox"/> Same As Driver) 1707 HUTCHINS PORTSMOUTH OH 45662						1 - None 2 - Minor 3 - Functional 4 - Disabling 9 - Unknown			
LP State OH		License Plate Number EMC665		Vehicle Identification Number 1FTPW14V99FA33601		# Occupants 04			
Vehicle Year 2009		Vehicle Make FORD Ford		Vehicle Model F15 F150 Series		Vehicle Color BLU Blue			
<input type="checkbox"/> Proof of Insurance Shown		Insurance Company NATIONWIDE		Policy Number		Towed By			
Carrier Name, Address, City, State, Zip						Carrier Phone - include area code			
US DOT		Vehicle Weight GVWR/GCWR <input type="checkbox"/> 1 - Less Than or Equal to 10k Lbs. <input type="checkbox"/> 2 - 10,001 to 26,000 Lbs. <input type="checkbox"/> 3 - More Than 26,000 Lbs.		Cargo Body Type 01 01 - No Cargo Body Type/Not Applicable 02 - Bus/Van(9-15 Seats, Inc.Driver) 03 - Bus(16+ Seats, Inc Driver) 04 - Vehicle Towing Another Vehicle 05 - Logging 06 - Intermodal Container Chassis 07 - Cargo Van/Enclosed Box 08 - Grain, Chips, Gravel		09 - Pole 10 - Cargo Tank 11 - Flat Bed 12 - Dump 13 - Concrete Mixer 14 - Auto Transporter 15 - Garbage/Refuse 99 - Other/Unknown		Trafficway Description 3 1 - Two-Way, Not Divided 2 - Two-Way, Not Divided, Continuous Left Turn Lane 3 - Two-Way, Divided, Unprotected (Painted or Grass>4 Ft.) Median 4 - Two-Way, Divided, Positive Median Barrier 5 - One-Way Trafficway <input type="checkbox"/> Hit / Skip Unit	
HM Placard ID No.		<input type="checkbox"/> Hazardous Material Released							
HM Class Number									
Non-Motorist Location Prior to Impact 01 - Intersection - Marked Crosswalk 02 - Intersection - No Crosswalk 03 - Intersection - Other 04 - Midblock - Marked Crosswalk 05 - Travel Lane - Other Location 06 - Bicycle Lane 07 - Shoulder/Roadside 08 - Sidewalk 09 - Median/Crossing Island 10 - Driveway Access 11 - Shared-Use Path or Trail 12 - Non-Trafficway Area 99 - Other/Unknown		Type of Use 1 1 - Personal 2 - Commercial 3 - Government <input type="checkbox"/> In Emergency Response		Unit Type 07 99 - Unknown or Hit/Skip 01 - Sub-Compact 02 - Compact 03 - Mid Size 04 - Full Size 05 - Minivan 06 - Sports Utility Vehicle 07 - Pickup 08 - Van 09 - Motorcycle 10 - Motorized Bicycle 11 - Snowmobile/ATV 12 - Other Passenger Vehicle		Passenger Vehicle (less than 9 passengers) Med/Heavy Trucks or Combo Units>10k lbs 21 - Bus/Van/Limo (9 or More Including Driver) 22 - BUS(16+ Seats, Inc Driver) 23 - Animal with Rider 24 - Animal with Buggy, Wagon, Surrey 25 - Bicycle/Pedacyclist 26 - Pedestrian/Skater 27 - Other Non-Motorist		<input type="checkbox"/> Has HM Placard 13 - Single Unit Truck or Van 2axle, 6 tires 14 - Single Unit Truck 3+ axles 15 - Single Unit Truck/Trailer 16 - Truck/Tractor(Bobtail) 17 - Tractor/Semi-Trailer 18 - Tractor/Double 19 - Tractor/Triples 20 - Other Med/Heavy Vehicle	
Special Function 22 01 - None 02 - Taxi 03 - Rental Truck (Over 10K Lbs) 04 - Bus - School (Public or Private) 05 - Bus - Transit 06 - Bus - Charter 07 - Bus - Shuttle 08 - Bus - Other		09 - Ambulance 10 - Fire 11 - Highway/Maintenance 12 - Military 13 - Police 14 - Public Utility 15 - Other Government 16 - Construction Equip.		17 - Farm Vehicle 18 - Farm Equipment 19 - Motorhome 20 - Golf Cart 21 - Train 22 - Other (Explain in Narrative)		Most Damaged Area 02 01 - None 02 - Center Front 03 - Right Front 04 - Right Side 05 - Right Rear 06 - Rear Center 07 - Left Rear 08 - Left Side 09 - Left Front 10 - Top and Windows 11 - Undercarriage 12 - Load/Trailer 13 - Total (All Areas) 14 - Other		Action 3 1 - Non-Contact 2 - Non-Collision 3 - Striking 4 - Struck 5 - Striking/Struck 9 - Unknown	
Pre-Crash Actions 01 01 - Straight Ahead 02 - Backing 03 - Changing Lanes 99 - Unknown 04 - Overtaking/Passing 05 - Making Right Turn 06 - Making Left Turn		Motorist 07 - Making U-Turn 08 - Entering Traffic Lane 09 - Leaving Traffic Lane 10 - Parked 11 - Slowing or Stopped in Traffic 12 - Driverless		13 - Negotiating a Curve 14 - Other Motorist Action		Non-Motorist 15 - Entering or Crossing Specified Location 16 - Walking, Running, Jogging, Playing, Cycling 17 - Working 18 - Pushing Vehicle 19 - Approaching or Leaving Vehicle 20 - Standing		21 - Other Non-Motorist Action	
Contributing Circumstances Primary 09 01 - None 02 - Failure to Yield 03 - Ran Red Light 04 - Ran Stop Sign Secondary <input type="checkbox"/> 05 - Exceeded Speed Limit 06 - Unsafe Speed 07 - Improper Turn 08 - Left of Center 99 - Unknown 09 - Followed Too Closely/ACDA 10 - Improper Lane Change /Passing/Off Road		Motorist 11 - Improper Backing 12 - Improper Start From Parked Position 13 - Stopped or Parked Illegally 14 - Operating Vehicle in Negligent Manner 15 - Swerving to Avoid (Due to External Conditions) 16 - Wrong Side/Wrong Way 17 - Failure to Control 18 - Vision Obstruction 19 - Operating Defective Equipment 20 - Load Shifting/Falling/Spilling 21 - Other Improper Action		Non-Motorist 22 - None 23 - Improper Crossing 24 - Darting 25 - Lying and/or Illegally in Roadway 26 - Failure to Yield Right of Way 27 - Not Visible (Dark Clothing) 28 - Inattentive 29 - Failure to Obey Traffic Signs /Signals/Officer 30 - Wrong Side of the Road 31 - Other Non-Motorist Action		Vehicle Defects <input type="checkbox"/> 01 - Turn Signals 02 - Head Lamps 03 - Tail Lamps 04 - Brakes 05 - Steering 06 - Tire Blowout 07 - Worn or Slick tires 08 - Trailer Equipment Defective 09 - Motor Trouble 10 - Disabled From Prior Accident 11 - Other Defects			
Sequence of Events 1 20 2 <input type="checkbox"/> 3 <input type="checkbox"/> 4 <input type="checkbox"/> 5 <input type="checkbox"/> 6 <input type="checkbox"/> First Harmful Event 1 Most Harmful Event 1 99 - Unknown		Non-Collision Events 01 - Overturn/Rollover 02 - Fire/Explosion 03 - Immersion 04 - Jackknife 05 - Cargo/Equipment Loss or Shift		06 - Equipment Failure (Blown Tire, Brake Failure, etc) 07 - Separation of Units 08 - Ran Off Road Right 09 - Ran Off Road Left		10 - Cross Median 11 - Cross Center Line Opposite Direction of Travel 12 - Downhill Runaway 13 - Other Non-Collision			
Collision with Person, Vehicle or Object Not Fixed 14 - Pedestrian 15 - Pedalcycle 16 - Railway Vehicle (Train,Engine) 17 - Animal - Farm 18 - Animal - Deer 19 - Animal - Other 20 - Motor Vehicle in Transport		Collision With Fixed Object 21 - Parked Motor Vehicle 22 - Work Zone Maintenance Equipment 23 - Struck by Falling, Shifting Cargo or Anything Set in Motion by a Motor Vehicle 24 - Other Movable Object		25 - Impact Attenuator/Crash Cushion 26 - Bridge Overhead Structure 27 - Bridge Pier or Abutment 28 - Bridge Parapet 29 - Bridge Rail 30 - Guardrail Face 31 - Guardrail End 32 - Portable Barrier		33 - Median Cable Barrier 34 - Median Guardrail Barrier 35 - Median Concrete Barrier 36 - Median Other Barrier 37 - Traffic Sign Post 38 - Overhead Sign Post 39 - Light/Luminaries Support 40 - Utility Pole		41 - Other Post, Pole or Support 42 - Culvert 43 - Curb 44 - Ditch 45 - Embankment 46 - Fence 47 Mailbox	
Unit Speed 25 <input type="checkbox"/> Stated <input checked="" type="checkbox"/> Estimated		Posted Speed 50		Traffic Control 12 01 - No Controls 02 - Stop Sign 03 - Yield Sign 04 - Traffic Signal 05 - Traffic Flashers 06 - School Zone		07 - Railroad Crossbucks 08 - Railroad Flashers 09 - Railroad Gates 10 - Construction Barricade 11 - Person (Flagger, Officer) 12 - Pavement Markings		Unit Direction From 3 To 4 1 - North 2 - South 3 - East 4 - West 5 - Northeast 6 - Northwest 7 - Southeast 8 - Southwest 9 - Unknown	



Unit

Local Report Number *

2 0 1 8 2 6 9 1

Unit Number 01		Owner Name: Last, First, Middle (<input type="checkbox"/> Same As Driver) TRISKA LAURA M		Owner Phone Number - inc. area code (<input type="checkbox"/> Same As Driver) 216-581-4949		Damage Scale 2		Damaged Area 		
Owner Address, City, State, Zip (<input type="checkbox"/> Same As Driver) 5592 E 139 GARF HTS OH 44125										
LP State OH		License Plate Number CJP 6116		Vehicle Identification Number 1GKKNXLS9JZ103015			# Occupants 01			
Vehicle Year 2018		Vehicle Make GMC GMC		Vehicle Model ACA Acadia		Vehicle Color BLK Black				
<input checked="" type="checkbox"/> Proof of Insurance Shown		Insurance Company ALLSTATE		Policy Number 992538969		Towed By				
Carrier Name, Address, City, State, Zip								Carrier Phone - include area code		
US DOT		Vehicle Weight GVWR/GCWR <input type="checkbox"/> 1 - Less Than or Equal to 10k Lbs. <input type="checkbox"/> 2 - 10,001 to 26,000 Lbs. <input type="checkbox"/> 3 - More Than 26,000 Lbs.		Cargo Body Type 01 01 - No Cargo Body Type/Not Applicable 02 - Bus/Van(9-15 Seats, Inc.Driver) 03 - Bus(16+ Seats, Inc Driver) 04 - Vehicle Towing Another Vehicle 05 - Logging 06 - Intermodal Container Chassis 07 - Cargo Van/Enclosed Box 08 - Grain, Chips, Gravel			09 - Pole 10 - Cargo Tank 11 - Flat Bed 12 - Dump 13 - Concrete Mixer 14 - Auto Transporter 15 - Garbage/Refuse 99 - Other/Unknown		Trafficway Description 3 1 - Two-Way, Not Divided 2 - Two-Way, Not Divided, Continuous Left Turn Lane 3 - Two-Way, Divided, Unprotected (Painted or Grass>4 Ft.) Median 4 - Two-Way, Divided, Positive Median Barrier 5 - One-Way Trafficway <input type="checkbox"/> Hit / Skip Unit	
HM Placard ID No.		<input type="checkbox"/> Hazardous Material Released		HM Class Number			<input type="checkbox"/> Has HM Placard			
Non-Motorist Location Prior to Impact 01 - Intersection - Marked Crosswalk 02 - Intersection - No Crosswalk 03 - Intersection - Other 04 - Midblock - Marked Crosswalk 05 - Travel Lane - Other Location 06 - Bicycle Lane 07 - Shoulder/Roadside 08 - Sidewalk 09 - Median/Crossing Island 10 - Driveway Access 11 - Shared-Use Path or Trail 12 - Non-Trafficway Area 99 - Other/Unknown			Type of Use 1 1 - Personal 2 - Commercial 3 - Government <input type="checkbox"/> In Emergency Response		Unit Type 06 99 - Unknown or Hit/Skip 01 - Sub-Compact 02 - Compact 03 - Mid Size 04 - Full Size 05 - Minivan 06 - Sports Utility Vehicle 07 - Pickup 08 - Van 09 - Motorcycle 10 - Motorized Bicycle 11 - Snowmobile/ATV 12 - Other Passenger Vehicle		Passenger Vehicle (less than 9 passengers) Med/Heavy Trucks or Combo Units>10k lbs 21 - Bus/Van/Limo (9 or More Including Driver) 22 - BUS(16+ Seats, Inc Driver) 23 - Animal with Rider 24 - Animal with Buggy, Wagon, Surrey 25 - Bicycle/Pedacyclist 26 - Pedestrian/Skater 27 - Other Non-Motorist			
Special Function 01 01 - None 02 - Taxi 03 - Rental Truck (Over 10K Lbs) 04 - Bus - School (Public or Private) 05 - Bus - Transit 06 - Bus - Charter 07 - Bus - Shuttle 08 - Bus - Other			09 - Ambulance 10 - Fire 11 - Highway/Maintenance 12 - Military 13 - Police 14 - Public Utility 15 - Other Government 16 - Construction Equip.		17 - Farm Vehicle 18 - Farm Equipment 19 - Motorhome 20 - Golf Cart 21 - Train 22 - Other (Explain in Narrative)		Most Damaged Area 06 01 - None 02 - Center Front 03 - Right Front 04 - Right Side 05 - Right Rear 06 - Rear Center 07 - Left Rear 08 - Left Side 09 - Left Front 10 - Top and Windows 11 - Undercarriage 12 - Load/Trailer 13 - Total (All Areas) 14 - Other		Action 4 1 - Non-Contact 2 - Non-Collision 3 - Striking 4 - Struck 5 - Striking/Struck 9 - Unknown	
Pre-Crash Actions 11 01 - Straight Ahead 02 - Backing 03 - Changing Lanes 99 - Unknown 04 - Overtaking/Passing 05 - Making Right Turn 06 - Making Left Turn			Motorist 07 - Making U-Turn 08 - Entering Traffic Lane 09 - Leaving Traffic Lane 10 - Parked 11 - Slowing or Stopped in Traffic 12 - Driverless		13 - Negotiating a Curve 14 - Other Motorist Action		Non-Motorist 15 - Entering or Crossing Specified Location 16 - Walking, Running, Jogging, Playing, Cycling 17 - Working 18 - Pushing Vehicle 19 - Approaching or Leaving Vehicle 20 - Standing		21 - Other Non-Motorist Action	
Contributing Circumstances Primary 01 01 - None 02 - Failure to Yield 03 - Ran Red Light 04 - Ran Stop Sign Secondary <input type="checkbox"/> 05 - Exceeded Speed Limit 06 - Unsafe Speed 07 - Improper Turn 08 - Left of Center 99 - Unknown 09 - Followed Too Closely/ACDA 10 - Improper Lane Change /Passing/Off Road			Motorist 11 - Improper Backing 12 - Improper Start From Parked Position 13 - Stopped or Parked Illegally 14 - Operating Vehicle in Negligent Manner 15 - Swerving to Avoid (Due to External Conditions) 16 - Wrong Side/Wrong Way 17 - Failure to Control 18 - Vision Obstruction 19 - Operating Defective Equipment 20 - Load Shifting/Falling/Spilling 21 - Other Improper Action		Non-Motorist 22 - None 23 - Improper Crossing 24 - Darting 25 - Lying and/or Illegally in Roadway 26 - Failure to Yield Right of Way 27 - Not Visible (Dark Clothing) 28 - Inattentive 29 - Failure to Obey Traffic Signs /Signals/Officer 30 - Wrong Side of the Road 31 - Other Non-Motorist Action		Vehicle Defects <input type="checkbox"/> 01 - Turn Signals 02 - Head Lamps 03 - Tail Lamps 04 - Brakes 05 - Steering 06 - Tire Blowout 07 - Worn or Slick tires 08 - Trailer Equipment Defective 09 - Motor Trouble 10 - Disabled From Prior Accident 11 - Other Defects			
Sequence of Events 1 20 2 <input type="checkbox"/> 3 <input type="checkbox"/> 4 <input type="checkbox"/> 5 <input type="checkbox"/> 6 <input type="checkbox"/> First Harmful Event 1 Most Harmful Event 1 99 - Unknown			Non-Collision Events 01 - Overturn/Rollover 02 - Fire/Explosion 03 - Immersion 04 - Jackknife 05 - Cargo/Equipment Loss or Shift		06 - Equipment Failure (Blown Tire, Brake Failure, etc) 07 - Separation of Units 08 - Ran Off Road Right 09 - Ran Off Road Left		10 - Cross Median 11 - Cross Center Line Opposite Direction of Travel 12 - Downhill Runaway 13 - Other Non-Collision			
Collision with Person, Vehicle or Object Not Fixed 14 - Pedestrian 15 - Pedalcycle 16 - Railway Vehicle (Train,Engine) 17 - Animal - Farm 18 - Animal - Deer 19 - Animal - Other 20 - Motor Vehicle in Transport			Collision With Fixed Object 21 - Parked Motor Vehicle 22 - Work Zone Maintenance Equipment 23 - Struck by Falling, Shifting Cargo or Anything Set in Motion by a Motor Vehicle 24 - Other Movable Object		25 - Impact Attenuator/Crash Cushion 26 - Bridge Overhead Structure 27 - Bridge Pier or Abutment 28 - Bridge Parapet 29 - Bridge Rail 30 - Guardrail Face 31 - Guardrail End 32 - Portable Barrier		33 - Median Cable Barrier 34 - Median Guardrail Barrier 35 - Median Concrete Barrier 36 - Median Other Barrier 37 - Traffic Sign Post 38 - Overhead Sign Post 39 - Light/Luminaries Support 40 - Utility Pole		41 - Other Post, Pole or Support 42 - Culvert 43 - Curb 44 - Ditch 45 - Embankment 46 - Fence 47 Mailbox	
Unit Speed 00		Posted Speed 50		Traffic Control 12 01 - No Controls 02 - Stop Sign 03 - Yield Sign 04 - Traffic Signal 05 - Traffic Flashers 06 - School Zone			07 - Railroad Crossbucks 08 - Railroad Flashers 09 - Railroad Gates 10 - Construction Barricade 11 - Person (Flagger, Officer) 12 - Pavement Markings		13 - Crosswalk Lines 14 - Walk/Don't Walk 15 - Other 16 - Not Reported	
<input checked="" type="checkbox"/> Stated <input type="checkbox"/> Estimated		Unit Direction From 3 To 4 1 - North 2 - South 3 - East 4 - West		5 - Northeast 6 - Northwest 7 - Southeast 8 - Southwest		9 - Unknown		Page of		



Motorist / Non-Motorist / Occupant

Local Report Number *

2 | 0 | 1 | 8 | 2 | 6 | 9 | 1 | | | | | | | | | |

Motorist/Non-Motorist

Motorist/Non-Motorist

Occupant

Occupant

Unit Number 0 1	Name: Last, First, Middle TRISKA ASHLEY	Date of Birth 0 2 2 7 1 9 9 1	Age 27	Gender F - Female M - Male
----------------------	--	--	-----------	----------------------------------

Address, City, State, Zip 5592 E139 GARFIELD HTS OH 44125	Contact Phone - include area code 216-581-4949
--	---

Injuries 1	Injured Taken By	EMS Agency	Medical Facility Injured Taken To	Safety Equipment Used 0 4	DOT Compliant Motorcycle Helmet	Seating Position 0 1	Air Bag Usage 1	Ejection 1	Trapped 1
---------------	------------------	------------	-----------------------------------	--------------------------------	---------------------------------	---------------------------	--------------------	---------------	--------------

OL State OH	Operator License Number TG268624	OL Class 4	No Valid OL	M/C End	Condition 1	Alcohol/Drug Suspected 1	Alcohol Test Status 1	Alcohol Test Type 1	Alcohol Test Value	Drug Test Status 1	Drug Test Type 1
----------------	-------------------------------------	---------------	-------------	---------	----------------	-----------------------------	--------------------------	------------------------	--------------------	-----------------------	---------------------

Offense Charged (Local Code)	Offense Description	Citation Number	Hands-Free Device Used	Driver Distracted By 1
------------------------------	---------------------	-----------------	------------------------	---------------------------

Unit Number 0 2	Name: Last, First, Middle MCGINNIS CHRISTOPHER	Date of Birth 1 1 0 7 1 9 7 8	Age 39	Gender M - Male
----------------------	---	--	-----------	--------------------

Address, City, State, Zip 60 GREENFIELD DR MILFORD CENTER OH 43045	Contact Phone - include area code 740-821-3711
---	---

Injuries 1	Injured Taken By	EMS Agency	Medical Facility Injured Taken To	Safety Equipment Used 0 4	DOT Compliant Motorcycle Helmet	Seating Position 0 1	Air Bag Usage 1	Ejection 1	Trapped 1
---------------	------------------	------------	-----------------------------------	--------------------------------	---------------------------------	---------------------------	--------------------	---------------	--------------

OL State OH	Operator License Number RG232819	OL Class 4	No Valid OL	M/C End	Condition 1	Alcohol/Drug Suspected 1	Alcohol Test Status 1	Alcohol Test Type 1	Alcohol Test Value	Drug Test Status 1	Drug Test Type 1
----------------	-------------------------------------	---------------	-------------	---------	----------------	-----------------------------	--------------------------	------------------------	--------------------	-----------------------	---------------------

Offense Charged (Local Code)	Offense Description	Citation Number	Hands-Free Device Used	Driver Distracted By 1
------------------------------	---------------------	-----------------	------------------------	---------------------------

Injuries 1 - No Injury/None Reported 2 - Possible 3 - Non-Incapacitating 4 - Incapacitating 5 - Fatal	Injured Taken By 1 - Not Transported / Treated at Scene 2 - EMS 3 - Police 4 - Other 9 - Unknown	Safety Equipment Used Motorist 01 - None Used - Vehicle Occupant 02 - Shoulder Belt Only Used 03 - Lap Belt Only Used 04 - Shoulder Belt and Lap Belt Used Non-Motorist 05 - Child Restraint System-Forward Facing 06 - Child Restraint System-Rear Facing 07 - Booster Seat 08 - Helmet Used 09 - Unknown Safety Equipment Non-Motorist 09 - None Used 10 - Helmet Used 11 - Protective Pads Used (Elbows, Knees, Etc) 12 - Reflective Clothing 13 - Lighting 14 - Other
---	--	---

Seating Position 01 - Front - Left Side (Motorcycle Driver) 02 - Front - Middle 03 - Front - Right Side 04 - Second - Left Side (Motorcycle Passenger) 05 - Second - Middle 06 - Second - Right Side 07 - Third - Left Side (Motorcycle Side Car) 08 - Third - Middle 09 - Third - Right Side 10 - Sleeper Section of Cab (Truck) 11 - Passenger in Other Enclosed Cargo Area (Non-Trailing Unit Such as a Bus, Pick-up with Cab) 12 - Passenger in Unenclosed Cargo Area 13 - Trailing Unit 14 - Riding on Vehicle Exterior (Non-Trailing Unit) 15 - Non-Motorist 16 - Other 99 - Unknown	Air Bag Usage 1 - Not Deployed 2 - Deployed Front 3 - Deployed Side 4 - Deployed Both Front/Side 5 - Not Applicable 9 - Deployment Unknown
--	---

Ejection 1 - Not Ejected 2 - Totally Ejected 3 - Partially Ejected 4 - Not Applicable	Trapped 1 - Not Trapped 2 - Extricated by Mechanical Means 3 - Extricated by Non-Mechanical Means	Operator License Class 1 - Class A 2 - Class B 3 - Class C 4 - Regular Class (Ohio is "D") 5 - MC/Moped Only	Condition 1 - Apparently Normal 2 - Physical Impairment 3 - Emotional (Depressed, Angry, Disturbed) 4 - Illness 5 - Fell Asleep, Fainted, Fatigued 6 - Under The Influence of Medications, Drugs, Alcohol 7 - Other	Alcohol/Drug Suspected 1 - None 2 - Yes - Alcohol Suspected 3 - Yes - HBD Not Impaired 4 - Yes - Drugs Suspected 5 - Yes - Alcohol and Drugs Suspected
--	---	--	---	--

Alcohol Test Status 1 - None Given 2 - Test Refused 3 - Test Given, Contaminated Sample/Unusable 4 - Test Given, Results Known 5 - Test Given, Results Unknown	Alcohol Test Type 1 - None 2 - Blood 3 - Urine 4 - Breath 5 - Other	Drug Test Status 1 - None Given 2 - Test Refused 3 - Test Given, Contaminated Sample/Unusable 4 - Test Given, Results Known 5 - Test Given, Results Unknown	Drug Test Type 1 - None 2 - Blood 3 - Urine 4 - Other	Driver Distracted By 1 - No Distraction Reported 2 - Phone 3 - Texting/E-mailing 4 - Electronic Communication Device 5 - Other Electronic Device (Navigation Device, Radio, DVD) 6 - Other Inside the Vehicle 7 - External Distraction
--	---	---	--	--

Unit Number 0 2	Name: Last, First, Middle MCGINNIS JAMIE	Date of Birth 0 3 2 1 1 9 8 1	Age 37	Gender F - Female M - Male
----------------------	---	--	-----------	----------------------------------

Address, City, State, Zip 60 GREENFIELD DR MILFORD CENTER OH 43045	Contact Phone - include area code
---	-----------------------------------

Injuries 1	Injured Taken By	EMS Agency	Medical Facility Injured Taken To	Safety Equipment Used 0 4	DOT Compliant Motorcycle Helmet	Seating Position 0 3	Air Bag Usage 1	Ejection 1	Trapped 1
---------------	------------------	------------	-----------------------------------	--------------------------------	---------------------------------	---------------------------	--------------------	---------------	--------------

Unit Number 0 2	Name: Last, First, Middle MCGINNIS BRYCEN	Date of Birth 0 4 2 1 2 0 1 3	Age 5	Gender M - Male
----------------------	--	--	----------	--------------------

Address, City, State, Zip 60 GREENFIELD DR MILFORD CENTER OH 43045	Contact Phone - include area code
---	-----------------------------------

Injuries 1	Injured Taken By	EMS Agency	Medical Facility Injured Taken To	Safety Equipment Used 0 4	DOT Compliant Motorcycle Helmet	Seating Position 0 4	Air Bag Usage 1	Ejection 1	Trapped 1
---------------	------------------	------------	-----------------------------------	--------------------------------	---------------------------------	---------------------------	--------------------	---------------	--------------



Occupant / Witness Addendum

Local Report Number *

2 | 0 | 1 | 8 | 2 | 6 | 9 | 1 | | | | |

Occupant	Unit Number 0 2	Name: Last, First, Middle MCGINNIS ORIN	Date of Birth 0 5 2 8 2 0 1 1	Age 7	Gender M F - Female M - Male						
	Address, City, State, Zip 60 GREENFIELD DR. MILFORD CENTER OH 43045				Contact Phone - include area code						
	Injuries 1	Injured Taken By	EMS Agency	Medical Facility Injured Taken To	Safety Equipment Used 0 4	DOT Compliant Motorcycle Helmet <input type="checkbox"/>	Seating Position 0 4	Air Bag Usage 1	Ejection 1	Trapped 1	
Occupant	Unit Number	Name: Last, First, Middle	Date of Birth	Age	Gender F - Female M - Male						
	Address, City, State, Zip				Contact Phone - include area code						
	Injuries	Injured Taken By	EMS Agency	Medical Facility Injured Taken To	Safety Equipment Used	DOT Compliant Motorcycle Helmet <input type="checkbox"/>	Seating Position	Air Bag Usage	Ejection	Trapped	
Occupant	Unit Number	Name: Last, First, Middle	Date of Birth	Age	Gender F - Female M - Male						
	Address, City, State, Zip				Contact Phone - include area code						
	Injuries	Injured Taken By	EMS Agency	Medical Facility Injured Taken To	Safety Equipment Used	DOT Compliant Motorcycle Helmet <input type="checkbox"/>	Seating Position	Air Bag Usage	Ejection	Trapped	
Occupant	Unit Number	Name: Last, First, Middle	Date of Birth	Age	Gender F - Female M - Male						
	Address, City, State, Zip				Contact Phone - include area code						
	Injuries	Injured Taken By	EMS Agency	Medical Facility Injured Taken To	Safety Equipment Used	DOT Compliant Motorcycle Helmet <input type="checkbox"/>	Seating Position	Air Bag Usage	Ejection	Trapped	
Occupant	Unit Number	Name: Last, First, Middle	Date of Birth	Age	Gender F - Female M - Male						
	Address, City, State, Zip				Contact Phone - include area code						
	Injuries	Injured Taken By	EMS Agency	Medical Facility Injured Taken To	Safety Equipment Used	DOT Compliant Motorcycle Helmet <input type="checkbox"/>	Seating Position	Air Bag Usage	Ejection	Trapped	
Occupant	Unit Number	Name: Last, First, Middle	Date of Birth	Age	Gender F - Female M - Male						
	Address, City, State, Zip				Contact Phone - include area code						
	Injuries	Injured Taken By	EMS Agency	Medical Facility Injured Taken To	Safety Equipment Used	DOT Compliant Motorcycle Helmet <input type="checkbox"/>	Seating Position	Air Bag Usage	Ejection	Trapped	
Injuries		Injured Taken By		Safety Equipment Used		99 - Unknown Safety Equipment					
1 - No Injury/None Reported 2 - Possible 3 - Non-Incapacitating 4 - Incapacitating 5 - Fatal		1 - Not Transported / Treated at Scene 2 - EMS 3 - Police 4 - Other 9 - Unknown		Motorist 01 - None Used - Vehicle Occupant 02 - Shoulder Belt Only Used 03 - Lap Belt Only Used 04 - Shoulder Belt and Lap Belt Used		Non-Motorist 05 - Child Restraint System-Forward Facing 06 - Child Restraint System-Rear Facing 07 - Booster Seat 08 - Helmet Used		09 - None Used 10 - Helmet Used 11 - Protective Pads Used (Elbows, Knees, Etc)		12 - Reflective Clothing 13 - Lighting 14 - Other	
Seating Position					Air Bag Usage		Ejection		Trapped		
01 - Front - Left Side (Motorcycle Driver) 02 - Front - Middle 03 - Front - Right Side 04 - Second - Left Side (Motorcycle Passenger) 05 - Second - Middle 06 - Second - Right Side 07 - Third - Left Side (Motorcycle Side Car) 08 - Third - Middle 09 - Third - Right Side 10 - Sleeper Section of Cab (Truck)					11 - Passenger in Other Enclosed Cargo Area (Non-Trailing Unit Such as a Bus, Pick-up with Cab) 12 - Passenger in Unenclosed Cargo Area 13 - Trailing Unit 14 - Riding on Vehicle Exterior (Non-Trailing Unit) 15 - Non-Motorist 16 - Other 99 - Unknown		1 - Not Deployed 2 - Deployed Front 3 - Deployed Side 4 - Deployed Both Front/Side 5 - Not Applicable 9 - Deployment Unknown		1 - Not Ejected 2 - Totally Ejected 3 - Partially Ejected 4 - Not Applicable		1 - Not Trapped 2 - Extricated by Mechanical Means 3 - Extricated by Non-Mechanical Means
Page of											