



# Traffic Crash Report

Local Report Number *	Crash Severity	Hit/Skip
20182746	3 1 - Fatal 2 - Injury 3 - PDO	1 - Solved 2 - Unsolved

Local Information <b>ROCKSIDE TAVERN</b>		Reporting Agency NCIC *	Reporting Agency Name *	Number of Units	Unit in error
<input type="checkbox"/> Photos Taken <input type="checkbox"/> OH-2 <input type="checkbox"/> OH-3 <input type="checkbox"/> OH-1P <input type="checkbox"/> Other	<input type="checkbox"/> PDO Under State Reportable Dollar Amount	01820	GARFIELD HEIGHTS	01	01 98 - Animal 99 - Unknown

County *	<input checked="" type="checkbox"/> City * <input type="checkbox"/> Village * <input type="checkbox"/> Township *	City, Village, Township *	Crash Date *	Time of Crash	Day of Week
18		GARFIELD HTS	07312018	1331	TUE

Degrees / Minutes / Seconds Latitude	Longitude	Decimal Degrees Latitude	Longitude
		41.401459	-81.592268

Roadway Division	Divided Lane Direction of Travel	Number of Thru Lanes	Road Types or Milepost <sup>2</sup>
<input checked="" type="checkbox"/> Divided <input type="checkbox"/> Undivided	W N - Northbound S - Southbound	04	AL - Alley CR - Circle HE - Heights MP - Milepost PL - Place ST - Street WA - Way AV - Avenue CT - Court HW - Highway PK - Parkway RD - Road TE - Terrace BL - Boulevard DR - Drive LA - Lane PI - Pike SQ - Square TL - Trail

Location Route Type <sup>1</sup>	Location Route Number	Loc. Prefix	Location Road name	Location Road Type <sup>2</sup>	Route Types <sup>1</sup>
		N.S. E,W	ROCKSIDE	RD	IR - Interstate Route (inc. turnpike) US - US Route SR - State Route CR - Numbered County Route TR - Numbered Township Route

Distance From Reference	Dir From Ref	Reference Route Type <sup>1</sup>	Reference Route Number	Ref Prefix	Reference Name (Road, Milepost, House #)	Reference Road Type <sup>2</sup>
	N.S. E,W			N.S. E,W	12929	

Reference Point Used	Crash Location	Reference Point Used	Location of First Harmful Event
3 1 - Intersection 2 - Mile Post 3 - House Number	01 01 - Not an intersection 02 - Four-way Intersection 03 - T-Intersection 04 - Y-Intersection 05 - Traffic Circle/Roundabout	06 - Five-point, or more 07 - On Ramp 08 - Off Ramp 09 - Crossover 10 - Driveway/Alley Access	6 1 - On Roadway 2 - On Shoulder 3 - In Median 4 - On Roadside 5 - On Gore 6 - Outside Trafficway 9 - Unknown

Road Contour	Road Conditions	01 - Dry 02 - Wet 03 - Snow 04 - Ice	05 - Sand, Mud, Dirt, Oil, gravel 06 - Water (Standing, Moving) 07 - Slush 08 - Debris*	09 - Rut, Holes, Bumps, Uneven Pavement* 10 - Other 99 - Unknown
1 1 - Straight Level 2 - Straight Grade 3 - Curve Level	02 Primary Secondary			* Secondary Condition Only

Manner of Crash Collision/Impact	Weather
1 1 - Not Collision Between Two Motor Vehicles In Transport 2 - Rear-End 3 - Head-On 4 - Rear-to-Rear 5 - Backing 6 - Angle 7 - Sideswipe, Same Direction 8 - Sideswipe, Opposite Direction 9 - Unknown	4 1 - Clear 2 - Cloudy 3 - Fog, Smog, Smoke 4 - Rain 5 - Sleet, Hail 6 - Snow 7 - Severe Crosswinds 8 - Blowing Sand, Soil, Dirt, Snow 9 - Other/Unknown

Road Surface	Light conditions	School Bus Related
2 1 - Concrete 2 - Blacktop, Bituminous, Asphalt 3 - Brick/Block 4 - Slag, Gravel, Stone 5 - Dirt 6 - Other	1 Primary Secondary 1 - Daylight 2 - Dawn 3 - Dusk 4 - Dark - Lighted Roadway 5 - Dark - Roadway Not Lighted 6 - Dark - Unknown Roadway Lighting 7 - Glare* 8 - Other 9 - Unknown	<input type="checkbox"/> School Zone Related <input type="checkbox"/> Yes, School Bus Directly Involved <input type="checkbox"/> Yes, School Bus Indirectly Involved

Work Zone Related	Type of Work Zone	Location of Crash in Work Zone
<input type="checkbox"/> Work Zone Related <input type="checkbox"/> Workers Present <input type="checkbox"/> Law Enforcement Present (Officer/Vehicle) <input type="checkbox"/> Law Enforcement Present (Vehicle Only)	<input type="checkbox"/> 1 - Lane Closure <input type="checkbox"/> 2 - Lane Shift/Crossover <input type="checkbox"/> 3 - Work on Shoulder or Median <input type="checkbox"/> 4 - Intermittent or Moving Work <input type="checkbox"/> 5 - Other	<input type="checkbox"/> 1 - Before the first Work Zone Warning Sign <input type="checkbox"/> 2 - Advance Warning Area <input type="checkbox"/> 3 - Transition Area <input type="checkbox"/> 4 - Activity Area <input type="checkbox"/> 5 - Termination Area

**Narrative**

UNIT 1 WAS TRAVELING W/B IN THE LEFT LANE OF ROCKSIDE RD. APPROACHING 12929. WHILE UNIT 1 WAS TRAVELING AT A STATED SPEED OF 30 MPH THE RIGHT REAR WHEEL ON THE SECOND AXLE OF THE TRAILER BROKE FREE AND TRAVELED W/B OFF OF THE RIGHT SIDE OF THE ROADWAY WHERE IT STRUCK THE BUILDING AT 12929 ROCKSIDE. DAMAGE WAS SUSTAINED TO AN AIR CONDITIONING UNIT ATTACHED THE THE EAST SIDE OF THE BUILDING.

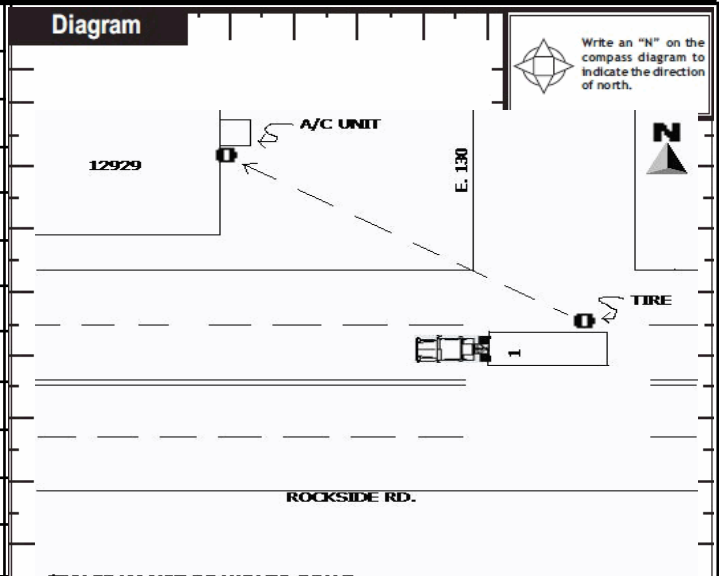

Report Taken By	Supplement (Correction or Addition to an Existing Report Sent to ODPSS)	Date Crash Reported	Time Crash Reported	Dispatch Time	Arrival Time	Time Cleared	Other Investigation Time	Total Minutes
<input checked="" type="checkbox"/> Police Agency <input type="checkbox"/> Motorist	<input type="checkbox"/>	07312018	1331	1401	1402	1430	120	148
Officer's Name *	Officer's Badge Number	Checked By	Page of					
T. Baon	040	L12 D. Merchant						



Unit

Local Report Number \*

2 0 1 8 2 7 4 6

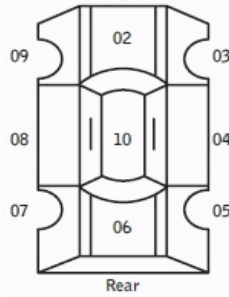
Unit Number <b>01</b>	Owner Name: Last, First, Middle <b>ARL</b> <input type="checkbox"/> Same As Driver	Owner Phone Number - inc. area code <b>800-245-4722</b> <input type="checkbox"/> Same As Driver	Damage Scale <b>1</b>	Damaged Area 
Owner Address, City, State, Zip <b>1155 STOOPS FERRY RD MOON TOWNSHIP PA 15108</b> <input type="checkbox"/> Same As Driver				
LP State <b>IN</b>	License Plate Number <b>1144713</b>	Vehicle Identification Number <b>1FUJAPAV55DU25324</b>	# Occupants <b>01</b>	
Vehicle Year <b>2005</b>	Vehicle Make <b>FRHT Freightliner</b>	Vehicle Model <b>C6T Conventional 6x2 Truck-tracto</b>	Vehicle Color <b>GRY Gray</b>	
<input type="checkbox"/> Proof of Insurance Shown	Insurance Company <b>ONE BEACON INS. CO</b>	Policy Number <b>L18A8400</b>	Towed By	
Carrier Name, Address, City, State, Zip <b>ARL 1155 STOOPS FERRY RD MOON TOWNSHIP PA 15108</b>			Carrier Phone - include area code <b>800-245-4722</b>	
US DOT	Vehicle Weight GVWR/GCWR <b>3</b> 1 - Less Than or Equal to 10k Lbs. 2 - 10,001 to 26,000 Lbs. 3 - More Than 26,000 Lbs.	Cargo Body Type <b>08</b> 01 - No Cargo Body Type/Not Applicable 02 - Bus/Van(9-15 Seats, Inc.Driver) 03 - Bus(16+ Seats, Inc Driver) 04 - Vehicle Towing Another Vehicle 05 - Logging 06 - Intermodal Container Chassis 07 - Cargo Van/Enclosed Box 08 - Grain, Chips, Gravel	09 - Pole 10 - Cargo Tank 11 - Flat Bed 12 - Dump 13 - Concrete Mixer 14 - Auto Transporter 15 - Garbage/Refuse 99 - Other/Unknown	Trafficway Description <b>3</b> 1 - Two-Way, Not Divided 2 - Two-Way, Not Divided, Continuous Left Turn Lane 3 - Two-Way, Divided, Unprotected (Painted or Grass>4 Ft.) Median 4 - Two-Way, Divided, Positive Median Barrier 5 - One-Way Trafficway
HM Placard ID No.	<input type="checkbox"/> Hazardous Material Released	<input type="checkbox"/> Hit / Skip Unit		
HM Class Number	<input type="checkbox"/> Has HM Placard			
Non-Motorist Location Prior to Impact <b>07</b> 01 - Intersection - Marked Crosswalk 02 - Intersection - No Crosswalk 03 - Intersection - Other 04 - Midblock - Marked Crosswalk 05 - Travel Lane - Other Location 06 - Bicycle Lane 07 - Shoulder/Roadside 08 - Sidewalk 09 - Median/Crossing Island 10 - Driveway Access 11 - Shared-Use Path or Trail 12 - Non-Trafficway Area 99 - Other/Unknown	Type of Use <b>2</b> 1 - Personal 2 - Commercial 3 - Government <input type="checkbox"/> In Emergency Response	Unit Type <b>17</b> 99 - Unknown or Hit/Skip 01 - Sub-Compact 02 - Compact 03 - Mid Size 04 - Full Size 05 - Minivan 06 - Sports Utility Vehicle 07 - Pickup 08 - Van 09 - Motorcycle 10 - Motorized Bicycle 11 - Snowmobile/ATV 12 - Other Passenger Vehicle	Passenger Vehicle (less than 9 passengers) Med/Heavy Trucks or Combo Units>10k lbs 21 - Bus/Van(9-15 Seats, Inc Driver) 22 - Bus(16+ Seats, Inc Driver) Non-Motorist 23 - Animal with Rider 24 - Animal with Buggy, Wagon, Surrey 25 - Bicycle/Pedacyclist 26 - Pedestrian/Skater 27 - Other Non-Motorist	
Special Function <b>01</b> 01 - None 02 - Taxi 03 - Rental Truck (Over 10K Lbs) 04 - Bus - School (Public or Private) 05 - Bus - Transit 06 - Bus - Charter 07 - Bus - Shuttle 08 - Bus - Other	09 - Ambulance 10 - Fire 11 - Highway/Maintenance 12 - Military 13 - Police 14 - Public Utility 15 - Other Government 16 - Construction Equip.	17 - Farm Vehicle 18 - Farm Equipment 19 - Motorhome 20 - Golf Cart 21 - Train 22 - Other (Explain in Narrative)	Most Damaged Area <b>01</b> 01 - None 02 - Center Front 03 - Right Front 04 - Right Side 05 - Right Rear 06 - Rear Center 07 - Left Rear 08 - Left Side 09 - Left Front 10 - Top and Windows 11 - Undercarriage 12 - Load/Trailer 13 - Total (All Areas) 14 - Other	Action <b>4</b> 1 - Non-Contact 2 - Non-Collision 3 - Striking 4 - Struck 5 - Striking/Struck 9 - Unknown
Pre-Crash Actions <b>01</b> 01 - Straight Ahead 02 - Backing 03 - Changing Lanes 04 - Overtaking/Passing 05 - Making Right Turn 06 - Making Left Turn 99 - Unknown	Motorist 07 - Making U-Turn 08 - Entering Traffic Lane 09 - Leaving Traffic Lane 10 - Parked 11 - Slowing or Stopped in Traffic 12 - Driverless	13 - Negotiating a Curve 14 - Other Motorist Action	Non-Motorist 15 - Entering or Crossing Specified Location 16 - Walking, Running, Jogging, Playing, Cycling 17 - Working 18 - Pushing Vehicle 19 - Approaching or Leaving Vehicle 20 - Standing	21 - Other Non-Motorist Action
Contributing Circumstances Primary <b>19</b> 01 - None 02 - Failure to Yield 03 - Ran Red Light 04 - Ran Stop Sign 05 - Exceeded Speed Limit 06 - Unsafe Speed 07 - Improper Turn 08 - Left of Center 09 - Followed Too Closely/ACDA 10 - Improper Lane Change /Passing/Off Road 99 - Unknown	Motorist 11 - Improper Backing 12 - Improper Start From Parked Position 13 - Stopped or Parked Illegally 14 - Operating Vehicle in Negligent Manner 15 - Swerving to Avoid (Due to External Conditions) 16 - Wrong Side/Wrong Way 17 - Failure to Control 18 - Vision Obstruction 19 - Operating Defective Equipment 20 - Load Shifting/Falling/Spilling 21 - Other Improper Action	Non-Motorist 22 - None 23 - Improper Crossing 24 - Darting 25 - Lying and/or Illegally in Roadway 26 - Failure to Yield Right of Way 27 - Not Visible (Dark Clothing) 28 - Inattentive 29 - Failure to Obey Traffic Signs /Signals/Officer 30 - Wrong Side of the Road 31 - Other Non-Motorist Action	Vehicle Defects <b>08</b> 01 - Turn Signals 02 - Head Lamps 03 - Tail Lamps 04 - Brakes 05 - Steering 06 - Tire Blowout 07 - Worn or Slick tires 08 - Trailer Equipment Defective 09 - Motor Trouble 10 - Disabled From Prior Accident 11 - Other Defects	
Sequence of Events 1 <b>06</b> 2 3 4 5 6 First Harmful Event <b>1</b> Most Harmful Event <b>1</b> 99 - Unknown	<b>Non-Collision Events</b> 01 - Overturn/Rollover 02 - Fire/Explosion 03 - Immersion 04 - Jackknife 05 - Cargo/Equipment Loss or Shift	06 - Equipment Failure (Blown Tire, Brake Failure, etc) 07 - Separation of Units 08 - Ran Off Road Right 09 - Ran Off Road Left 10 - Cross Median 11 - Cross Center Line Opposite Direction of Travel 12 - Downhill Runaway 13 - Other Non-Collision	<b>Collision With Person, Vehicle or Object Not Fixed</b> 14 - Pedestrian 15 - Pedalcycle 16 - Railway Vehicle (Train,Engine) 17 - Animal - Farm 18 - Animal - Deer 19 - Animal - Other 20 - Motor Vehicle in Transport	<b>Collision With Fixed Object</b> 25 - Impact Attenuator/Crash Cushion 26 - Bridge Overhead Structure 27 - Bridge Pier or Abutment 28 - Bridge Parapet 29 - Bridge Rail 30 - Guardrail Face 31 - Guardrail End 32 - Portable Barrier 33 - Median Cable Barrier 34 - Median Guardrail Barrier 35 - Median Concrete Barrier 36 - Median Other Barrier 37 - Traffic Sign Post 38 - Overhead Sign Post 39 - Light/Luminaries Support 40 - Utility Pole 41 - Other Post, Pole or Support 42 - Culvert 43 - Curb 44 - Ditch 45 - Embankment 46 - Fence 47 Mailbox 48 - Tree 49 - Fire Hydrant 50 - Work Zone Maintenance Equipment 51 - Wall, Building, Tunnel 52 - Other Fixed Object
Unit Speed <b>30</b> <input checked="" type="checkbox"/> Stated <input type="checkbox"/> Estimated	Posted Speed <b>35</b>	Traffic Control <b>12</b> 01 - No Controls 02 - Stop Sign 03 - Yield Sign 04 - Traffic Signal 05 - Traffic Flashers 06 - School Zone 07 - Railroad Crossbucks 08 - Railroad Flashers 09 - Railroad Gates 10 - Construction Barricade 11 - Person (Flagger, Officer) 12 - Pavement Markings	13 - Crosswalk Lines 14 - Walk/Don't Walk 15 - Other 16 - Not Reported	Unit Direction From <b>3</b> To <b>4</b> 1 - North 2 - South 3 - East 4 - West 5 - Northeast 6 - Northwest 7 - Southeast 8 - Southwest 9 - Unknown



# Motorist / Non-Motorist / Occupant

Local Report Number \*

2 | 0 | 1 | 8 | 2 | 7 | 4 | 6 | | | | | | | |

Motorist/Non-Motorist

Motorist/Non-Motorist

Occupant

Occupant

Unit Number 01	Name: Last, First, Middle NAGELSKI STANLEY C	Date of Birth 07021951	Age 67	Gender M F - Female M - Male
-------------------	---	---------------------------	-----------	---------------------------------------

Address, City, State, Zip 6249 YORKTOWN DR PARMA OH 44134 4063	Contact Phone - include area code 440-725-8648
---	---

Injuries 1	Injured Taken By	EMS Agency	Medical Facility Injured Taken To	Safety Equipment Used 04	DOT Compliant Motorcycle Helmet	Seating Position 01	Air Bag Usage 5	Ejection 1	Trapped 1
---------------	------------------	------------	-----------------------------------	-----------------------------	---------------------------------	------------------------	--------------------	---------------	--------------

OL State OH	Operator License Number RJ781546	OL Class 1	No Valid OL	M/C End	Condition 1	Alcohol/Drug Suspected 1	Alcohol Test Status 1	Alcohol Test Type 1	Alcohol Test Value	Drug Test Status 1	Drug Test Type 1
----------------	-------------------------------------	---------------	-------------	---------	----------------	-----------------------------	--------------------------	------------------------	--------------------	-----------------------	---------------------

Offense Charged (Local Code)	Offense Description	Citation Number	Hands-Free Device Used	Driver Distracted By 1
------------------------------	---------------------	-----------------	------------------------	---------------------------

Unit Number	Name: Last, First, Middle	Date of Birth	Age	Gender F - Female M - Male
-------------	---------------------------	---------------	-----	----------------------------------

Address, City, State, Zip	Contact Phone - include area code
---------------------------	-----------------------------------

Injuries	Injured Taken By	EMS Agency	Medical Facility Injured Taken To	Safety Equipment Used	DOT Compliant Motorcycle Helmet	Seating Position	Air Bag Usage	Ejection	Trapped
----------	------------------	------------	-----------------------------------	-----------------------	---------------------------------	------------------	---------------	----------	---------

OL State	Operator License Number	OL Class	No Valid OL	M/C End	Condition	Alcohol/Drug Suspected	Alcohol Test Status	Alcohol Test Type	Alcohol Test Value	Drug Test Status	Drug Test Type
----------	-------------------------	----------	-------------	---------	-----------	------------------------	---------------------	-------------------	--------------------	------------------	----------------

Offense Charged (Local Code)	Offense Description	Citation Number	Hands-Free Device Used	Driver Distracted By
------------------------------	---------------------	-----------------	------------------------	----------------------

<b>Injuries</b> 1 - No Injury/None Reported 2 - Possible 3 - Non-Incapacitating 4 - Incapacitating 5 - Fatal	<b>Injured Taken By</b> 1 - Not Transported / Treated at Scene 2 - EMS 3 - Police 4 - Other 9 - Unknown	<b>Safety Equipment Used</b> <b>Motorist</b> 01 - None Used - Vehicle Occupant 02 - Shoulder Belt Only Used 03 - Lap Belt Only Used 04 - Shoulder Belt and Lap Belt Used <b>Non-Motorist</b> 05 - Child Restraint System-Forward Facing 06 - Child Restraint System-Rear Facing 07 - Booster Seat 08 - Helmet Used <b>99 - Unknown Safety Equipment</b>	<b>Non-Motorist</b> 09 - None Used 10 - Helmet Used 11 - Protective Pads Used (Elbows, Knees, Etc) 12 - Reflective Clothing 13 - Lighting 14 - Other
---	--	--	--

<b>Seating Position</b> 01 - Front - Left Side (Motorcycle Driver) 02 - Front - Middle 03 - Front - Right Side 04 - Second - Left Side (Motorcycle Passenger) 05 - Second - Middle 06 - Second - Right Side 07 - Third - Left Side (Motorcycle Side Car) 08 - Third - Middle 09 - Third - Right Side 10 - Sleeper Section of Cab (Truck) 11 - Passenger in Other Enclosed Cargo Area (Non-Trailing Unit Such as a Bus, Pick-up with Cab) 12 - Passenger in Unenclosed Cargo Area 13 - Trailing Unit 14 - Riding on Vehicle Exterior (Non-Trailing Unit) 15 - Non-Motorist 16 - Other 99 - Unknown	<b>Air Bag Usage</b> 1 - Not Deployed 2 - Deployed Front 3 - Deployed Side 4 - Deployed Both Front/Side 5 - Not Applicable 9 - Deployment Unknown
--	---

<b>Ejection</b> 1 - Not Ejected 2 - Totally Ejected 3 - Partially Ejected 4 - Not Applicable	<b>Trapped</b> 1 - Not Trapped 2 - Extricated by Mechanical Means 3 - Extricated by Non-Mechanical Means	<b>Operator License Class</b> 1 - Class A 2 - Class B 3 - Class C 4 - Regular Class (Ohio is "D") 5 - MC/Moped <u>Only</u>	<b>Condition</b> 1 - Apparently Normal 2 - Physical Impairment 3 - Emotional (Depressed, Angry, Disturbed) 4 - Illness 5 - Fell Asleep, Fainted, Fatigued 6 - Under The Influence of Medications, Drugs, Alcohol 7 - Other	<b>Alcohol/Drug Suspected</b> 1 - None 2 - Yes - Alcohol Suspected 3 - Yes - HBD Not Impaired 4 - Yes - Drugs Suspected 5 - Yes - Alcohol and Drugs Suspected
--	---	---	---	--

<b>Alcohol Test Status</b> 1 - None Given 2 - Test Refused 3 - Test Given, Contaminated Sample/Unusable 4 - Test Given, Results Known 5 - Test Given, Results Unknown	<b>Alcohol Test Type</b> 1 - None 2 - Blood 3 - Urine 4 - Breath 5 - Other	<b>Drug Test Status</b> 1 - None Given 2 - Test Refused 3 - Test Given, Contaminated Sample/Unusable 4 - Test Given, Results Known 5 - Test Given, Results Unknown	<b>Drug Test Type</b> 1 - None 2 - Blood 3 - Urine 4 - Other	<b>Driver Distracted By</b> 1 - No Distraction Reported 2 - Phone 3 - Texting/E-mailing 4 - Electronic Communication Device 5 - Other Electronic Device (Navigation Device, Radio, DVD) 6 - Other Inside the Vehicle 7 - External Distraction
--	---	---	--	--

Unit Number	Name: Last, First, Middle	Date of Birth	Age	Gender F - Female M - Male
-------------	---------------------------	---------------	-----	----------------------------------

Address, City, State, Zip	Contact Phone - include area code
---------------------------	-----------------------------------

Injuries	Injured Taken By	EMS Agency	Medical Facility Injured Taken To	Safety Equipment Used	DOT Compliant Motorcycle Helmet	Seating Position	Air Bag Usage	Ejection	Trapped
----------	------------------	------------	-----------------------------------	-----------------------	---------------------------------	------------------	---------------	----------	---------

Unit Number	Name: Last, First, Middle	Date of Birth	Age	Gender F - Female M - Male
-------------	---------------------------	---------------	-----	----------------------------------

Address, City, State, Zip	Contact Phone - include area code
---------------------------	-----------------------------------

Injuries	Injured Taken By	EMS Agency	Medical Facility Injured Taken To	Safety Equipment Used	DOT Compliant Motorcycle Helmet	Seating Position	Air Bag Usage	Ejection	Trapped
----------	------------------	------------	-----------------------------------	-----------------------	---------------------------------	------------------	---------------	----------	---------