



Traffic Crash Report

Local Report Number *	Crash Severity	Hit/Skip
20182785	3 - 1 - Fatal 2 - Injury 3 - PDO	1 - Solved 2 - Unsolved

Local Information		Reporting Agency NCIC *	Reporting Agency Name *	Number of Units	Unit in error
<input type="checkbox"/> Photos Taken <input type="checkbox"/> OH-2 <input type="checkbox"/> OH-3 <input type="checkbox"/> OH-1P <input type="checkbox"/> Other	<input type="checkbox"/> PDO Under State Reportable Dollar Amount	01820	GARFIELD HEIGHTS	01	01 98 - Animal 99 - Unknown

County *	<input checked="" type="checkbox"/> City * <input type="checkbox"/> Village * <input type="checkbox"/> Township *	City, Village, Township *	Crash Date *	Time of Crash	Day of Week
18		GARFIELD HTS	08022018	1921	THU

Degrees / Minutes / Seconds Latitude	Longitude	Decimal Degrees Latitude	Longitude
		41.411374	-81.615553

Roadway Division	Divided Lane Direction of Travel	Number of Thru Lanes	Road Types or Milepost ²
<input type="checkbox"/> Divided <input checked="" type="checkbox"/> Undivided	E N - Northbound S - Southbound	04	AL - Alley CR - Circle HE - Heights MP - Milepost PL - Place ST - Street WA - Way AV - Avenue CT - Court HW - Highway PK - Parkway RD - Road TE - Terrace BL - Boulevard DR - Drive LA - Lane PI - Pike SQ - Square TL - Trail

Location Route 1	Location Route Number	Loc. Prefix	Location Road name	Location Road Type 2	Route Types ¹
IR	480				IR - Interstate Route (inc. turnpike) US - US Route SR - State Route CR - Numbered County Route TR - Numbered Township Route

Distance From Reference	Dir From Ref	Reference Route Type 1	Reference Route Number	Ref Prefix	Reference Name (Road, Milepost, House #)	Reference Road Type 2
150	W N.S. E, W				21.8	MP

Reference Point Used	Crash Location	Reference Point	Reference Name	Intersection Related	Location of First Harmful Event
2 - Mile Post	01	01 - Not an intersection 02 - Four-way Intersection 03 - T-Intersection 04 - Y-Intersection 05 - Traffic Circle/Roundabout	06 - Five-point, or more 07 - On Ramp 08 - Off Ramp 09 - Crossover 10 - Driveway/Alley Access	11 - Railway Grade Crossing 12 - Shared-Use Paths or Trails 99 - Unknown	1 - On Roadway 2 - On Shoulder 3 - In Median 4 - On Roadside 5 - On Gore 6 - Outside Trafficway 9 - Unknown

Road Contour	Road Conditions	01 - Dry 02 - Wet 03 - Snow 04 - Ice	05 - Sand, Mud, Dirt, Oil, gravel 06 - Water (Standing, Moving) 07 - Slush 08 - Debris*	09 - Rut, Holes, Bumps, Uneven Pavement* 10 - Other 99 - Unknown
1 - Straight Level 2 - Straight Grade 3 - Curve Level 4 - Curve Grade 9 - Unknown	01			* Secondary Condition Only

Manner of Crash Collision/Impact	Weather
9 - 1 - Not Collision Between Two Motor Vehicles In Transport 2 - Rear-End 3 - Head-On 4 - Rear-to-Rear 5 - Backing 6 - Angle 7 - Sideswipe, Same Direction 8 - Sideswipe, Opposite Direction 9 - Unknown	1 - Clear 2 - Cloudy 3 - Fog, Smog, Smoke 4 - Rain 5 - Sleet, Hail 6 - Snow 7 - Severe Crosswinds 8 - Blowing Sand, Soil, Dirt, Snow 9 - Other/Unknown

Road Surface	Light conditions	School Bus Related
2 - 1 - Concrete 2 - Blacktop, Bituminous, Asphalt 3 - Brick/Block 4 - Slag, Gravel, Stone 5 - Dirt 6 - Other	3 - Primary Secondary 1 - Daylight 2 - Dawn 3 - Dusk 4 - Dark - Lighted Roadway 5 - Dark - Roadway Not Lighted 6 - Dark - Unknown Roadway Lighting 7 - Glare* 8 - Other 9 - Unknown	<input type="checkbox"/> School Zone Related <input type="checkbox"/> Yes, School Bus Directly Involved <input type="checkbox"/> Yes, School Bus Indirectly Involved

Work Zone Related	Type of Work Zone	Location of Crash in Work Zone
<input type="checkbox"/> Workers Present <input type="checkbox"/> Law Enforcement Present (Officer/Vehicle) <input type="checkbox"/> Law Enforcement Present (Vehicle Only)	1 - Lane Closure 2 - Lane Shift/Crossover 3 - Work on Shoulder or Median 4 - Intermittent or Moving Work 5 - Other	1 - Before the first Work Zone Warning Sign 2 - Advance Warning Area 3 - Transition Area 4 - Activity Area 5 - Termination Area

Narrative

UNIT #1 WAS GETTING ON I480 EAST FROM TRANSPORTATION AND AS HE WAS GETTING ON THE DRIVER OF UNIT#1 STRUCK THE CONCRETE BARRIER ON THE SOUTH SIDE OF I480 JUST BEFORE MILEPOST 21/8. UNIT #1 HAD DAMAGE TO THE RIGHT REAR TIRE. THE CONCRETE BARRIER IS OWNED BY WALSH CONSTRUCTION

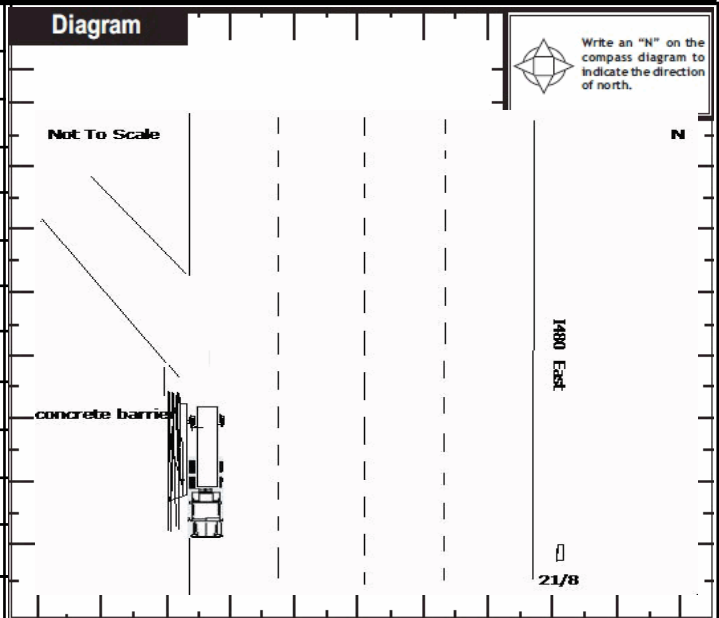

Report Taken By	Supplement (Correction or Addition to an Existing Report Sent to ODPS)	Date Crash Reported	Time Crash Reported	Dispatch Time	Arrival Time	Time Cleared	Other Investigation Time	Total Minutes
<input checked="" type="checkbox"/> Police Agency <input type="checkbox"/> Motorist		08022018	1921	1921	1921	1931	60	70
Officer's Name *	Officer's Badge Number	Checked By	Page of					
J. Holiday	028	L12 D. Merchant						



Unit

Local Report Number *

20182785

Unit Number 011	Owner Name: Last, First, Middle ENGLAND C.R. <input type="checkbox"/> Same As Driver	Owner Phone Number - inc. area code 800-453-8826 <input type="checkbox"/> Same As Driver	Damage Scale 2	Damaged Area 	
Owner Address, City, State, Zip 4701 W. 2100 ST SALT LAKE CITY UT 84128 <input type="checkbox"/> Same As Driver			1 - None		
LP State 1N	License Plate Number 2344471	Vehicle Identification Number 3AKJGLDR4HSGP5385	2 - Minor		
Vehicle Year 2017	Vehicle Make FRHT Freightliner	Vehicle Model TK Truck	3 - Functional		
Vehicle Color RED Red	Insurance Company CR ENGLAND		4 - Disabling		
<input checked="" type="checkbox"/> Proof of Insurance Shown	Policy Number MC124679	Towed By	9 - Unknown		
Carrier Name, Address, City, State, Zip CR ENGLAND 4701 W. 2100 ST SALT LAKE CITY UT 84128			Carrier Phone - include area code 800-453-8826		
US DOT 028406	Vehicle Weight GVWR/GCWR 2 1 - Less Than or Equal to 10k Lbs. 2 - 10,001 to 26,000 Lbs. 3 - More Than 26,000 Lbs.	Cargo Body Type 01 01 - No Cargo Body Type/Not Applicable 02 - Bus/Van(9-15 Seats, Inc.Driver) 03 - Bus(16+ Seats, Inc Driver) 04 - Vehicle Towing Another Vehicle 05 - Logging 06 - Intermodal Container Chassis 07 - Cargo Van/Enclosed Box 08 - Grain, Chips, Gravel	Trafficway Description 1 1 - Two-Way, Not Divided 2 - Two-Way, Not Divided, Continuous Left Turn Lane 3 - Two-Way, Divided, Unprotected (Painted or Grass>4 Ft.) Median 4 - Two-Way, Divided, Positive Median Barrier 5 - One-Way Trafficway		
HM Placard ID No.	<input type="checkbox"/> Hazardous Material Released	09 - Pole 10 - Cargo Tank 11 - Flat Bed 12 - Dump 13 - Concrete Mixer 14 - Auto Transporter 15 - Garbage/Refuse 99 - Other/Unknown	<input type="checkbox"/> Hit / Skip Unit		
HM Class Number	Non-Motorist Location Prior to Impact 01 01 - Intersection - Marked Crosswalk 02 - Intersection - No Crosswalk 03 - Intersection - Other 04 - Midblock - Marked Crosswalk 05 - Travel Lane - Other Location 06 - Bicycle Lane 07 - Shoulder/Roadside 08 - Sidewalk 09 - Median/Crossing Island 10 - Driveway Access 11 - Shared-Use Path or Trail 12 - Non-Trafficway Area 99 - Other/Unknown	Type of Use 2 1 - Personal 2 - Commercial 3 - Government <input type="checkbox"/> In Emergency Response	Unit Type 17 01 - Sub-Compact 02 - Compact 03 - Mid Size 04 - Full Size 05 - Minivan 06 - Sports Utility Vehicle 07 - Pickup 08 - Van 09 - Motorcycle 10 - Motorized Bicycle 11 - Snowmobile/ATV 12 - Other Passenger Vehicle	Passenger Vehicle (less than 9 passengers) Med/Heavy Trucks or Combo Units>10k lbs Bus/Van/Limo (9 or More Including Driver)	
Special Function 01 01 - None 02 - Taxi 03 - Rental Truck (Over 10K Lbs) 04 - Bus - School (Public or Private) 05 - Bus - Transit 06 - Bus - Charter 07 - Bus - Shuttle 08 - Bus - Other	09 - Ambulance 10 - Fire 11 - Highway/Maintenance 12 - Military 13 - Police 14 - Public Utility 15 - Other Government 16 - Construction Equip.	17 - Farm Vehicle 18 - Farm Equipment 19 - Motorhome 20 - Golf Cart 21 - Train 22 - Other (Explain in Narrative)	Most Damaged Area 05 01 - None 02 - Center Front 03 - Right Front 04 - Right Side 05 - Right Rear 06 - Rear Center 07 - Left Rear	08 - Left Side 09 - Left Front 10 - Top and Windows 11 - Undercarriage 12 - Load/Trailer 13 - Total (All Areas) 14 - Other	
Pre-Crash Actions 01 01 - Straight Ahead 02 - Backing 03 - Changing Lanes 99 - Unknown 04 - Overtaking/Passing 05 - Making Right Turn 06 - Making Left Turn	Motorist 07 - Making U-Turn 08 - Entering Traffic Lane 09 - Leaving Traffic Lane 10 - Parked 11 - Slowing or Stopped in Traffic 12 - Driverless	13 - Negotiating a Curve 14 - Other Motorist Action	Non-Motorist 15 - Entering or Crossing Specified Location 16 - Walking, Running, Jogging, Playing, Cycling 17 - Working 18 - Pushing Vehicle 19 - Approaching or Leaving Vehicle 20 - Standing	Action 5 1 - Non-Contact 2 - Non-Collision 3 - Striking 4 - Struck 5 - Striking/Struck 9 - Unknown	
Contributing Circumstances Primary 17 01 - None 02 - Failure to Yield 03 - Ran Red Light 04 - Ran Stop Sign Secondary 01 05 - Exceeded Speed Limit 06 - Unsafe Speed 07 - Improper Turn 08 - Left of Center 99 - Unknown 09 - Followed Too Closely/ACDA 10 - Improper Lane Change /Passing/Off Road	Motorist 11 - Improper Backing 12 - Improper Start From Parked Position 13 - Stopped or Parked Illegally 14 - Operating Vehicle in Negligent Manner 15 - Swerving to Avoid (Due to External Conditions) 16 - Wrong Side/Wrong Way 17 - Failure to Control 18 - Vision Obstruction 19 - Operating Defective Equipment 20 - Load Shifting/Falling/Spilling 21 - Other Improper Action	Non-Motorist 22 - None 23 - Improper Crossing 24 - Darting 25 - Lying and/or Illegally in Roadway 26 - Failure to Yield Right of Way 27 - Not Visible (Dark Clothing) 28 - Inattentive 29 - Failure to Obey Traffic Signs /Signals/Officer 30 - Wrong Side of the Road 31 - Other Non-Motorist Action	Vehicle Defects 01 01 - Turn Signals 02 - Head Lamps 03 - Tail Lamps 04 - Brakes 05 - Steering 06 - Tire Blowout 07 - Worn or Slick tires 08 - Trailer Equipment Defective 09 - Motor Trouble 10 - Disabled From Prior Accident 11 - Other Defects		
Sequence of Events 1 52 2 01 3 01 4 01 5 01 6 01 First Harmful Event 1 Most Harmful Event 1 99 - Unknown	Non-Collision Events 01 - Overturn/Rollover 02 - Fire/Explosion 03 - Immersion 04 - Jackknife 05 - Cargo/Equipment Loss or Shift 06 - Equipment Failure (Blown Tire, Brake Failure, etc) 07 - Separation of Units 08 - Ran Off Road Right 09 - Ran Off Road Left 10 - Cross Median 11 - Cross Center Line Opposite Direction of Travel 12 - Downhill Runaway 13 - Other Non-Collision			Collision With Person, Vehicle or Object Not Fixed 14 - Pedestrian 15 - Pedalcycle 16 - Railway Vehicle (Train,Engine) 17 - Animal - Farm 18 - Animal - Deer 19 - Animal - Other 20 - Motor Vehicle in Transport 21 - Parked Motor Vehicle 22 - Work Zone Maintenance Equipment 23 - Struck by Falling, Shifting Cargo or Anything Set in Motion by a Motor Vehicle 24 - Other Movable Object Collision With Fixed Object 25 - Impact Attenuator/Crash Cushion 26 - Bridge Overhead Structure 27 - Bridge Pier or Abutment 28 - Bridge Parapet 29 - Bridge Rail 30 - Guardrail Face 31 - Guardrail End 32 - Portable Barrier 33 - Median Cable Barrier 34 - Median Guardrail Barrier 35 - Median Concrete Barrier 36 - Median Other Barrier 37 - Traffic Sign Post 38 - Overhead Sign Post 39 - Light/Luminaries Support 40 - Utility Pole 41 - Other Post, Pole or Support 42 - Culvert 43 - Curb 44 - Ditch 45 - Embankment 46 - Fence 47 Mailbox 48 - Tree 49 - Fire Hydrant 50 - Work Zone Maintenance Equipment 51 - Wall, Building, Tunnel 52 - Other Fixed Object	
Unit Speed 40 <input type="checkbox"/> Stated <input checked="" type="checkbox"/> Estimated	Posted Speed 60	Traffic Control 01 01 - No Controls 02 - Stop Sign 03 - Yield Sign 04 - Traffic Signal 05 - Traffic Flashers 06 - School Zone 07 - Railroad Crossbucks 08 - Railroad Flashers 09 - Railroad Gates 10 - Construction Barricade 11 - Person (Flagger, Officer) 12 - Pavement Markings 13 - Crosswalk Lines 14 - Walk/Don't Walk 15 - Other 16 - Not Reported	Unit Direction From 4 To 3 1 - North 2 - South 3 - East 4 - West 5 - Northeast 6 - Northwest 7 - Southeast 8 - Southwest 9 - Unknown	Page of	



Motorist / Non-Motorist / Occupant

Local Report Number *

2 | 0 | 1 | 8 | 2 | 7 | 8 | 5 | | | | | | | |

Motorist/Non-Motorist

Motorist/Non-Motorist

Occupant

Occupant

Unit Number 01	Name: Last, First, Middle BACHELOR MILES KI	Date of Birth 08171971	Age 46	Gender M F - Female M - Male
-------------------	--	---------------------------	-----------	---------------------------------------

Address, City, State, Zip 255 MCGREGOR AVE CINCINNATI OH 45219 2952		Contact Phone - include area code
--	--	-----------------------------------

Injuries 1	Injured Taken By 1	EMS Agency	Medical Facility Injured Taken To	Safety Equipment Used 04	DOT Compliant Motorcycle Helmet <input type="checkbox"/>	Seating Position 01	Air Bag Usage 1	Ejection 1	Trapped 1
---------------	-----------------------	------------	-----------------------------------	-----------------------------	---	------------------------	--------------------	---------------	--------------

OL State OH	Operator License Number RR580363	OL Class 1	No Valid OL <input type="checkbox"/>	M/C End <input type="checkbox"/>	Condition 1	Alcohol/Drug Suspected 1	Alcohol Test Status 1	Alcohol Test Type 1	Alcohol Test Value	Drug Test Status 1	Drug Test Type 1
----------------	-------------------------------------	---------------	---	-------------------------------------	----------------	-----------------------------	--------------------------	------------------------	--------------------	-----------------------	---------------------

Offense Charged (Local Code) 331.34A	Offense Description FAILURE TO CONTROL	Citation Number G20183823	Hands-Free Device Used <input type="checkbox"/>	Driver Distracted By 1
---	---	------------------------------	--	---------------------------

Unit Number	Name: Last, First, Middle	Date of Birth	Age	Gender F - Female M - Male
-------------	---------------------------	---------------	-----	----------------------------------

Address, City, State, Zip		Contact Phone - include area code
---------------------------	--	-----------------------------------

Injuries	Injured Taken By	EMS Agency	Medical Facility Injured Taken To	Safety Equipment Used	DOT Compliant Motorcycle Helmet <input type="checkbox"/>	Seating Position	Air Bag Usage	Ejection	Trapped
----------	------------------	------------	-----------------------------------	-----------------------	---	------------------	---------------	----------	---------

OL State	Operator License Number	OL Class	No Valid OL <input type="checkbox"/>	M/C End <input type="checkbox"/>	Condition	Alcohol/Drug Suspected	Alcohol Test Status	Alcohol Test Type	Alcohol Test Value	Drug Test Status	Drug Test Type
----------	-------------------------	----------	---	-------------------------------------	-----------	------------------------	---------------------	-------------------	--------------------	------------------	----------------

Offense Charged (Local Code)	Offense Description	Citation Number	Hands-Free Device Used <input type="checkbox"/>	Driver Distracted By
------------------------------	---------------------	-----------------	--	----------------------

Injuries 1 - No Injury/None Reported 2 - Possible 3 - Non-Incapacitating 4 - Incapacitating 5 - Fatal	Injured Taken By 1 - Not Transported / Treated at Scene 2 - EMS 3 - Police 4 - Other 9 - Unknown	Safety Equipment Used Motorist 01 - None Used - Vehicle Occupant 02 - Shoulder Belt Only Used 03 - Lap Belt Only Used 04 - Shoulder Belt and Lap Belt Used Non-Motorist 05 - Child Restraint System-Forward Facing 06 - Child Restraint System-Rear Facing 07 - Booster Seat 08 - Helmet Used 99 - Unknown Safety Equipment	Non-Motorist 09 - None Used 10 - Helmet Used 11 - Protective Pads Used (Elbows, Knees, Etc) 12 - Reflective Clothing 13 - Lighting 14 - Other
---	--	--	--

Seating Position 01 - Front - Left Side (Motorcycle Driver) 02 - Front - Middle 03 - Front - Right Side 04 - Second - Left Side (Motorcycle Passenger) 05 - Second - Middle 06 - Second - Right Side 07 - Third - Left Side (Motorcycle Side Car) 08 - Third - Middle 09 - Third - Right Side 10 - Sleeper Section of Cab (Truck) 11 - Passenger in Other Enclosed Cargo Area (Non-Trailing Unit Such as a Bus, Pick-up with Cab) 12 - Passenger in Unenclosed Cargo Area 13 - Trailing Unit 14 - Riding on Vehicle Exterior (Non-Trailing Unit) 15 - Non-Motorist 16 - Other 99 - Unknown	Air Bag Usage 1 - Not Deployed 2 - Deployed Front 3 - Deployed Side 4 - Deployed Both Front/Side 5 - Not Applicable 9 - Deployment Unknown
--	---

Ejection 1 - Not Ejected 2 - Totally Ejected 3 - Partially Ejected 4 - Not Applicable	Trapped 1 - Not Trapped 2 - Extricated by Mechanical Means 3 - Extricated by Non-Mechanical Means	Operator License Class 1 - Class A 2 - Class B 3 - Class C 4 - Regular Class (Ohio is "D") 5 - MC/Moped Only	Condition 1 - Apparently Normal 2 - Physical Impairment 3 - Emotional (Depressed, Angry, Disturbed) 4 - Illness 5 - Fell Asleep, Fainted, Fatigued 6 - Under The Influence of Medications, Drugs, Alcohol 7 - Other	Alcohol/Drug Suspected 1 - None 2 - Yes - Alcohol Suspected 3 - Yes - HBD Not Impaired 4 - Yes - Drugs Suspected 5 - Yes - Alcohol and Drugs Suspected
--	---	--	---	--

Alcohol Test Status 1 - None Given 2 - Test Refused 3 - Test Given, Contaminated Sample/Unusable 4 - Test Given, Results Known 5 - Test Given, Results Unknown	Alcohol Test Type 1 - None 2 - Blood 3 - Urine 4 - Breath 5 - Other	Drug Test Status 1 - None Given 2 - Test Refused 3 - Test Given, Contaminated Sample/Unusable 4 - Test Given, Results Known 5 - Test Given, Results Unknown	Drug Test Type 1 - None 2 - Blood 3 - Urine 4 - Other	Driver Distracted By 1 - No Distraction Reported 2 - Phone 3 - Texting/E-mailing 4 - Electronic Communication Device 5 - Other Electronic Device (Navigation Device, Radio, DVD) 6 - Other Inside the Vehicle 7 - External Distraction
--	---	---	--	--

Unit Number 01	Name: Last, First, Middle NIEVES JUAN R/	Date of Birth 07131965	Age 53	Gender M F - Female M - Male
-------------------	---	---------------------------	-----------	---------------------------------------

Address, City, State, Zip 11181 DORCHESTER ST. 126 SOUTHGATE MI 48195		Contact Phone - include area code
--	--	-----------------------------------

Injuries 1	Injured Taken By 1	EMS Agency	Medical Facility Injured Taken To	Safety Equipment Used 04	DOT Compliant Motorcycle Helmet <input type="checkbox"/>	Seating Position 04	Air Bag Usage 1	Ejection 1	Trapped 1
---------------	-----------------------	------------	-----------------------------------	-----------------------------	---	------------------------	--------------------	---------------	--------------

Unit Number	Name: Last, First, Middle	Date of Birth	Age	Gender F - Female M - Male
-------------	---------------------------	---------------	-----	----------------------------------

Address, City, State, Zip		Contact Phone - include area code
---------------------------	--	-----------------------------------

Injuries	Injured Taken By	EMS Agency	Medical Facility Injured Taken To	Safety Equipment Used	DOT Compliant Motorcycle Helmet <input type="checkbox"/>	Seating Position	Air Bag Usage	Ejection	Trapped
----------	------------------	------------	-----------------------------------	-----------------------	---	------------------	---------------	----------	---------