



Traffic Crash Report

Local Report Number *	Crash Severity	Hit/Skip
2 0 1 8 4 1 4 4	2 1 - Fatal 2 - Injury 3 - PDO	1 - Solved 2 - Unsolved

Local Information TURNEY ROCKSIDE		Reporting Agency NCIC *	Reporting Agency Name *	Number of Units	Unit in error
<input type="checkbox"/> Photos Taken <input type="checkbox"/> OH-2 <input type="checkbox"/> OH-3 <input type="checkbox"/> OH-1P <input type="checkbox"/> Other	<input type="checkbox"/> PDO Under State Reportable Dollar Amount	<input type="checkbox"/> Private Property	0 1 8 2 0	GARFIELD HEIGHTS	0 2
County *	<input checked="" type="checkbox"/> City * <input type="checkbox"/> Village * <input type="checkbox"/> Township *	City, Village, Township *	Crash Date *	Time of Crash	Day of Week
1 8	<input checked="" type="checkbox"/> City * <input type="checkbox"/> Village * <input type="checkbox"/> Township *	GARFIELD HTS	1 1 1 0 2 0 1 8	1 3 3 7	S A T

Degrees / Minutes / Seconds Latitude	Longitude	Decimal Degrees Latitude	Longitude
		4 1 . 4 0 1 0 0 2	- 8 1 . 5 9 4 5 8 5

Roadway Division	Divided Lane Direction of Travel	Number of Thru Lanes	Road Types or Milepost ²
<input checked="" type="checkbox"/> Divided <input type="checkbox"/> Undivided	N - Northbound S - Southbound	0 2	AL - Alley CR - Circle HE - Heights MP - Milepost PL - Place ST - Street WA - Way AV - Avenue CT - Court HW - Highway PK - Parkway RD - Road TE - Terrace BL - Boulevard DR - Drive LA - Lane PI - Pike SQ - Square TL - Trail

Location Route Type ¹	Location Route Number	Loc. Prefix	Location Road name	Location Road Type ²	Route Types ¹
		N.S. E,W	TURNEY	RD	IR - Interstate Route (inc. turnpike) US - US Route SR - State Route CR - Numbered County Route TR - Numbered Township Route

Distance From Reference	Dir From Ref	Reference Route Type	Reference Route Number	Ref Prefix	Reference Name (Road, Milepost, House #)	Reference Road Type
15	N S, E, W			N.S. E,W	ROCKSIDE	RD

Reference Point Used	Crash Location	Reference Point Used	Location of First Harmful Event
1 - Intersection 2 - Mile Post 3 - House Number	0 2	01 - Not an intersection 02 - Four-way Intersection 03 - T-Intersection 04 - Y-Intersection 05 - Traffic Circle/Roundabout	1 - On Roadway 2 - On Shoulder 3 - In Median 4 - On Roadside 5 - On Gore 6 - Outside Trafficway 9 - Unknown

Road Contour	Road Conditions	Weather
1 - Straight Level 2 - Straight Grade 3 - Curve Level 4 - Curve Grade 9 - Unknown	0 1	2 - Cloudy 3 - Fog, Smog, Smoke

Manner of Crash Collision/Impact	Weather
3 - Two Motor Vehicles In Transport	2 - Cloudy 3 - Fog, Smog, Smoke

Road Surface	Light conditions	School Bus Related
2 - Asphalt	1 - Daylight	<input type="checkbox"/> School Zone Related <input type="checkbox"/> Yes, School Bus Directly Involved <input type="checkbox"/> Yes, School Bus Indirectly Involved

Work Zone Related	Type of Work Zone	Location of Crash in Work Zone
<input type="checkbox"/> Workers Present <input type="checkbox"/> Law Enforcement Present (Officer/Vehicle) <input type="checkbox"/> Law Enforcement Present (Vehicle Only)	1 - Lane Closure 2 - Lane Shift/Crossover 3 - Work on Shoulder or Median 4 - Intermittent or Moving Work 5 - Other	1 - Before the first Work Zone Warning Sign 2 - Advance Warning Area 3 - Transition Area 4 - Activity Area 5 - Termination Area

Narrative

DRIVER OF UNIT #1 STATED SHE WAS TRAVELING NORTH ON TURNEY RD NEAR ROCKSIDE RD. DRIVER OF UNIT #1 STATED SHE WAS UNAWARE OF HER PRE-CRASH ACTIONS AND ONLY REMEMBERS TRAVELING NORTH ON TURNEY.

DRIVER OF UNIT #2 STATED SHE WAS STATIONARY AT THE RED TRAFFIC CONTROL DEVICE, SOUTHBOUND ON TURNEY RD AT ROCKSIDE RD. DRIVER OF UNIT #2 STATED SHE OBSERVED UNIT #1 TRAVELING NORTH ON TURNEY RD, COMING THROUGH THE INTERSECTION, GO LEFT OF CENTER AND STRIKE UNIT #2 HEAD ON. DRIVER OF UNIT #

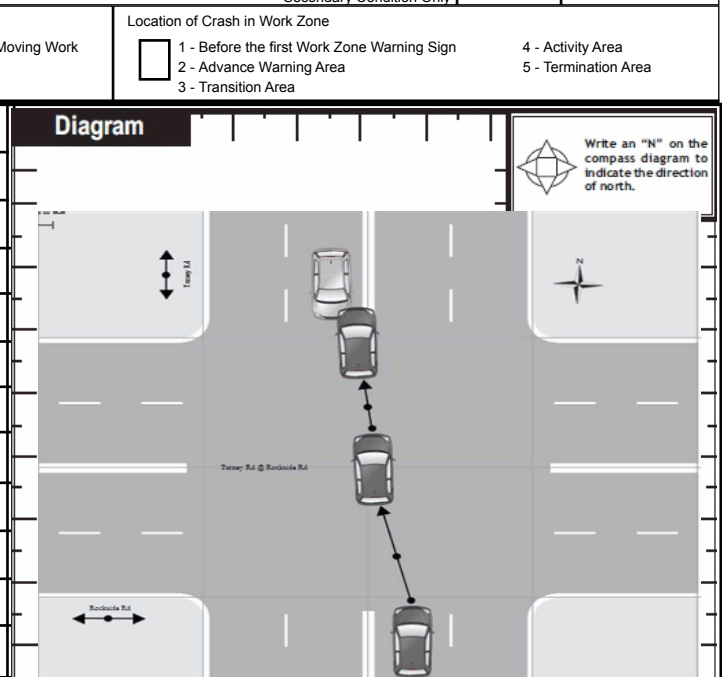

Report Taken By	Supplement (Correction or Addition to an Existing Report Sent to ODPSS)
<input checked="" type="checkbox"/> Police Agency <input type="checkbox"/> Motorist	<input type="checkbox"/>

Date Crash Reported	Time Crash Reported	Dispatch Time	Arrival Time	Time Cleared	Other Investigation Time	Total Minutes
1 1 1 0 2 0 1 8	1 3 3 7	1 3 3 7	1 3 4 0	1 4 2 0	3 0	7 0

Officer's Name *	Officer's Badge Number	Checked By	Page of
R. Pitts	023	L09 T. Murphy	



Unit

Local Report Number *

2 0 1 8 4 1 4 4

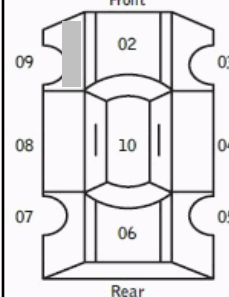
Unit Number 01		Owner Name: Last, First, Middle (<input checked="" type="checkbox"/> Same As Driver) VASQUEZ WILMA		Owner Phone Number - inc. area code (<input checked="" type="checkbox"/> Same As Driver) 216-903-7587		Damage Scale 3	Damaged Area 
Owner Address, City, State, Zip (<input type="checkbox"/> Same As Driver) 156 GOULD AVE BEDFORD OH 44146 2646							
LP State OH		License Plate Number H049778		Vehicle Identification Number 3N1AB7AP1HY233215		# Occupants 01	
Vehicle Year 2017		Vehicle Make NISSAN Nissan		Vehicle Model SEN Sentra		Vehicle Color GRY Gray	
<input checked="" type="checkbox"/> Proof of Insurance Shown		Insurance Company FOUNDERS INS		Policy Number ITOH197501		Towed By A&H TOWING	
Carrier Name, Address, City, State, Zip						Carrier Phone - include area code	
US DOT		Vehicle Weight GVWR/GCWR 1 1 - Less Than or Equal to 10k Lbs. 2 - 10,001 to 26,000 Lbs. 3 - More Than 26,000 Lbs.		Cargo Body Type 01 01 - No Cargo Body Type/Not Applicable 02 - Bus/Van(9-15 Seats, Inc.Driver) 03 - Bus(16+ Seats, Inc Driver) 04 - Vehicle Towing Another Vehicle 05 - Logging 06 - Intermodal Container Chassis 07 - Cargo Van/Enclosed Box 08 - Grain, Chips, Gravel		Traficway Description 3 1 - Two-Way, Not Divided 2 - Two-Way, Not Divided, Continuous Left Turn Lane 3 - Two-Way, Divided, Unprotected (Painted or Grass>4 Ft.) Median 4 - Two-Way, Divided, Positive Median Barrier 5 - One-Way Trafficway	
HM Placard ID No.		<input type="checkbox"/> Hazardous Material Released		09 - Pole 10 - Cargo Tank 11 - Flat Bed 12 - Dump 13 - Concrete Mixer 14 - Auto Transporter 15 - Garbage/Refuse 99 - Other/Unknown		<input type="checkbox"/> Hit / Skip Unit	
HM Class Number		Type of Use 1 1 - Personal 2 - Commercial 3 - Government <input type="checkbox"/> In Emergency Response		Unit Type 03 01 - Sub-Compact 02 - Compact 03 - Mid Size 04 - Full Size 05 - Minivan 06 - Sports Utility Vehicle 07 - Pickup 08 - Van 09 - Motorcycle 10 - Motorized Bicycle 11 - Snowmobile/ATV 12 - Other Passenger Vehicle		Med/Heavy Trucks or Combo Units>10k lbs 13 - Single Unit Truck or Van 2axle,6 tires 14 - Single Unit Truck 3+ axles 15 - Single Unit Truck/Trailer 16 - Truck/Tractor(Bobtail) 17 - Tractor/Semi-Trailer 18 - Tractor/Double 19 - Tractor/Triples 20 - Other Med/Heavy Vehicle	
Non-Motorist Location Prior to Impact 02 01 - Intersection - Marked Crosswalk 02 - Intersection - No Crosswalk 03 - Intersection - Other 04 - Midblock - Marked Crosswalk 05 - Travel Lane - Other Location 06 - Bicycle Lane 07 - Shoulder/Roadside 08 - Sidewalk 09 - Median/Crossing Island 10 - Driveway Access 11 - Shared-Use Path or Trail 12 - Non-Trafficway Area 99 - Other/Unknown		Bus/Van/Limo (9 or More Including Driver) 21 - Bus/Van (9-15 Seats, Inc Driver) 22 - BUS(16+ Seats, Inc Driver) Non-Motorist 23 - Animal with Rider 24 - Animal with Buggy, Wagon, Surrey 25 - Bicycle/Pedacyclist 26 - Pedestrian/Skater 27 - Other Non-Motorist		<input type="checkbox"/> Has HM Placard			
Special Function 01 01 - None 02 - Taxi 03 - Rental Truck (Over 10K Lbs) 04 - Bus - School (Public or Private) 05 - Bus - Transit 06 - Bus - Charter 07 - Bus - Shuttle 08 - Bus - Other		09 - Ambulance 10 - Fire 11 - Highway/Maintenance 12 - Military 13 - Police 14 - Public Utility 15 - Other Government 16 - Construction Equip.		17 - Farm Vehicle 18 - Farm Equipment 19 - Motorhome 20 - Golf Cart 21 - Train 22 - Other (Explain in Narrative)		Most Damaged Area 09 01 - None 02 - Center Front 03 - Right Front 04 - Right Side 05 - Right Rear 06 - Rear Center 07 - Left Rear 08 - Left Side 09 - Left Front 10 - Top and Windows 11 - Undercarriage 12 - Load/Trailer 13 - Total (All Areas) 14 - Other	
Pre-Crash Actions 01 01 - Straight Ahead 02 - Backing 03 - Changing Lanes 99 - Unknown 04 - Overtaking/Passing 05 - Making Right Turn 06 - Making Left Turn		Motorist 07 - Making U-Turn 08 - Entering Traffic Lane 09 - Leaving Traffic Lane 10 - Parked 11 - Slowing or Stopped in Traffic 12 - Driverless		13 - Negotiating a Curve 14 - Other Motorist Action		Non-Motorist 15 - Entering or Crossing Specified Location 16 - Walking, Running, Jogging, Playing, Cycling 17 - Working 18 - Pushing Vehicle 19 - Approaching or Leaving Vehicle 20 - Standing 21 - Other Non-Motorist Action	
Contributing Circumstances Primary 08 01 - None 02 - Failure to Yield 03 - Ran Red Light 04 - Ran Stop Sign Secondary 08 05 - Exceeded Speed Limit 06 - Unsafe Speed 07 - Improper Turn 08 - Left of Center 99 - Unknown 09 - Followed Too Closely/ACDA 10 - Improper Lane Change /Passing/Off Road		Motorist 11 - Improper Backing 12 - Improper Start From Parked Position 13 - Stopped or Parked Illegally 14 - Operating Vehicle in Negligent Manner 15 - Swerving to Avoid (Due to External Conditions) 16 - Wrong Side/Wrong Way 17 - Failure to Control 18 - Vision Obstruction 19 - Operating Defective Equipment 20 - Load Shifting/Falling/Spilling 21 - Other Improper Action		Non-Motorist 22 - None 23 - Improper Crossing 24 - Darting 25 - Lying and/or Illegally in Roadway 26 - Failure to Yield Right of Way 27 - Not Visible (Dark Clothing) 28 - Inattentive 29 - Failure to Obey Traffic Signs /Signals/Officer 30 - Wrong Side of the Road 31 - Other Non-Motorist Action		Vehicle Defects 08 01 - Turn Signals 02 - Head Lamps 03 - Tail Lamps 04 - Brakes 05 - Steering 06 - Tire Blowout 07 - Worn or Slick tires 08 - Trailer Equipment Defective 09 - Motor Trouble 10 - Disabled From Prior Accident 11 - Other Defects	
Sequence of Events 1 20 2 00 3 00 4 00 5 00 6 00 First Harmful Event 1 Most Harmful Event 1 99 - Unknown		Non-Collision Events 01 - Overturn/Rollover 02 - Fire/Explosion 03 - Immersion 04 - Jackknife 05 - Cargo/Equipment Loss or Shift		06 - Equipment Failure (Blown Tire, Brake Failure, etc) 07 - Separation of Units 08 - Ran Off Road Right 09 - Ran Off Road Left		10 - Cross Median 11 - Cross Center Line Opposite Direction of Travel 12 - Downhill Runaway 13 - Other Non-Collision	
Collision with Person, Vehicle or Object Not Fixed 14 - Pedestrian 15 - Pedalcycle 16 - Railway Vehicle (Train,Engine) 17 - Animal - Farm 18 - Animal - Deer 19 - Animal - Other 20 - Motor Vehicle in Transport		Collision With Fixed Object 21 - Parked Motor Vehicle 22 - Work Zone Maintenance Equipment 23 - Struck by Falling, Shifting Cargo or Anything Set in Motion by a Motor Vehicle 24 - Other Movable Object		25 - Impact Attenuator/Crash Cushion 26 - Bridge Overhead Structure 27 - Bridge Pier or Abutment 28 - Bridge Parapet 29 - Bridge Rail 30 - Guardrail Face 31 - Guardrail End 32 - Portable Barrier		33 - Median Cable Barrier 34 - Median Guardrail Barrier 35 - Median Concrete Barrier 36 - Median Other Barrier 37 - Traffic Sign Post 38 - Overhead Sign Post 39 - Light/Luminaries Support 40 - Utility Pole	
41 - Other Post, Pole or Support 42 - Culvert 43 - Curb 44 - Ditch 45 - Embankment 46 - Fence 47 Mailbox		48 - Tree 49 - Fire Hydrant 50 - Work Zone Maintenance Equipment 51 - Wall, Building, Tunnel 52 - Other Fixed Object		Unit Speed 25 Posted Speed 25		Traffic Control 12 01 - No Controls 02 - Stop Sign 03 - Yield Sign 04 - Traffic Signal 05 - Traffic Flashers 06 - School Zone	
<input checked="" type="checkbox"/> Stated <input type="checkbox"/> Estimated		07 - Railroad Crossbucks 08 - Railroad Flashers 09 - Railroad Gates 10 - Construction Barricade 11 - Person (Flagger, Officer) 12 - Pavement Markings		13 - Crosswalk Lines 14 - Walk/Don't Walk 15 - Other 16 - Not Reported		Unit Direction From 2 To 1 1 - North 2 - South 3 - East 4 - West 5 - Northeast 6 - Northwest 7 - Southeast 8 - Southwest 9 - Unknown	



Unit

Local Report Number *

2 0 1 8 4 1 4 4

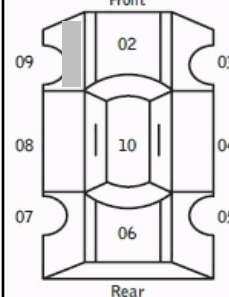
Unit Number 0 2		Owner Name: Last, First, Middle (<input checked="" type="checkbox"/> Same As Driver) RUSSO PATRICIA A		Owner Phone Number - inc. area code (<input checked="" type="checkbox"/> Same As Driver)		Damage Scale 3	Damaged Area 
Owner Address, City, State, Zip (<input checked="" type="checkbox"/> Same As Driver) 4009 HENRITZE AVE CLEVELAND OH 44109							
LP State OH		License Plate Number EJT6527		Vehicle Identification Number 1G1AK58F687289644		# Occupants 0 2	
Vehicle Year 2 0 0 8		Vehicle Make CHEV Chevrolet		Vehicle Model CBT Cobalt		Vehicle Color SIL Alum/Silver	
<input checked="" type="checkbox"/> Proof of Insurance Shown		Insurance Company STATE FARM		Policy Number 6512765B1135M		Towed By	
Carrier Name, Address, City, State, Zip							Carrier Phone - include area code
US DOT		Vehicle Weight GVWR/GCWR 1 1 - Less Than or Equal to 10k Lbs. 2 - 10,001 to 26,000 Lbs. 3 - More Than 26,000 Lbs.		Cargo Body Type 0 1 01 - No Cargo Body Type/Not Applicable 02 - Bus/Van(9-15 Seats, Inc.Driver) 03 - Bus(16+ Seats, Inc Driver) 04 - Vehicle Towing Another Vehicle 05 - Logging 06 - Intermodal Container Chassis 07 - Cargo Van/Enclosed Box 08 - Grain, Chips, Gravel		Traficway Description 3 1 - Two-Way, Not Divided 2 - Two-Way, Not Divided, Continuous Left Turn Lane 3 - Two-Way, Divided, Unprotected (Painted or Grass>4 Ft.) Median 4 - Two-Way, Divided, Positive Median Barrier 5 - One-Way Traficway	
HM Placard ID No.		<input type="checkbox"/> Hazardous Material Released		09 - Pole 10 - Cargo Tank 11 - Flat Bed 12 - Dump 13 - Concrete Mixer 14 - Auto Transporter 15 - Garbage/Refuse 99 - Other/Unknown		<input type="checkbox"/> Hit / Skip Unit	
HM Class Number		Type of Use 1 1 - Personal 2 - Commercial 3 - Government <input type="checkbox"/> In Emergency Response		Unit Type 0 2 01 - Sub-Compact 02 - Compact 03 - Mid Size 04 - Full Size 05 - Minivan 06 - Sports Utility Vehicle 07 - Pickup 08 - Van 09 - Motorcycle 10 - Motorized Bicycle 11 - Snowmobile/ATV 12 - Other Passenger Vehicle		Med/Heavy Trucks or Combo Units>10k lbs 13 - Single Unit Truck or Van 2axle,6 tires 14 - Single Unit Truck 3+ axles 15 - Single Unit Truck/Trailer 16 - Truck/Tractor(Bobtail) 17 - Tractor/Semi-Trailer 18 - Tractor/Double 19 - Tractor/Triples 20 - Other Med/Heavy Vehicle	
Non-Motorist Location Prior to Impact 0 0 01 - Intersection - Marked Crosswalk 02 - Intersection - No Crosswalk 03 - Intersection - Other 04 - Midblock - Marked Crosswalk 05 - Travel Lane - Other Location 06 - Bicycle Lane 07 - Shoulder/Roadside 08 - Sidewalk 09 - Median/Crossing Island 10 - Driveway Access 11 - Shared-Use Path or Trail 12 - Non-Trafficway Area 99 - Other/Unknown		Bus/Van/Limo (9 or More Including Driver) 21 - Bus/Van (9-15 Seats, Inc Driver) 22 - BUS(16+ Seats, Inc Driver) Non-Motorist 23 - Animal with Rider 24 - Animal with Buggy, Wagon, Surrey 25 - Bicycle/Pedacyclist 26 - Pedestrian/Skater 27 - Other Non-Motorist		<input type="checkbox"/> Has HM Placard			
Special Function 0 1 01 - None 02 - Taxi 03 - Rental Truck (Over 10K Lbs) 04 - Bus - School (Public or Private) 05 - Bus - Transit 06 - Bus - Charter 07 - Bus - Shuttle 08 - Bus - Other		09 - Ambulance 10 - Fire 11 - Highway/Maintenance 12 - Military 13 - Police 14 - Public Utility 15 - Other Government 16 - Construction Equip.		17 - Farm Vehicle 18 - Farm Equipment 19 - Motorhome 20 - Golf Cart 21 - Train 22 - Other (Explain in Narrative)		Most Damaged Area 0 9 01 - None 02 - Center Front 03 - Right Front 04 - Right Side 05 - Right Rear 06 - Rear Center 07 - Left Rear 08 - Left Side 09 - Left Front 10 - Top and Windows 11 - Undercarriage 12 - Load/Trailer 13 - Total (All Areas) 14 - Other 99 - Unknown	
Pre-Crash Actions 1 1 01 - Straight Ahead 02 - Backing 03 - Changing Lanes 99 - Unknown		Motorist 01 - Straight Ahead 02 - Backing 03 - Changing Lanes 04 - Overtaking/Passing 05 - Making Right Turn 06 - Making Left Turn 07 - Making U-Turn 08 - Entering Traffic Lane 09 - Leaving Traffic Lane 10 - Parked 11 - Slowing or Stopped in Traffic 12 - Driverless		13 - Negotiating a Curve 14 - Other Motorist Action		Non-Motorist 15 - Entering or Crossing Specified Location 16 - Walking, Running, Jogging, Playing, Cycling 17 - Working 18 - Pushing Vehicle 19 - Approaching or Leaving Vehicle 20 - Standing 21 - Other Non-Motorist Action	
Contributing Circumstances Primary 0 1 01 - None 02 - Failure to Yield 03 - Ran Red Light 04 - Ran Stop Sign Secondary 0 0 05 - Exceeded Speed Limit 06 - Unsafe Speed 07 - Improper Turn 08 - Left of Center 99 - Unknown		Motorist 01 - None 02 - Failure to Yield 03 - Ran Red Light 04 - Ran Stop Sign 05 - Exceeded Speed Limit 06 - Unsafe Speed 07 - Improper Turn 08 - Left of Center 09 - Followed Too Closely/ACDA 10 - Improper Lane Change /Passing/Off Road 11 - Improper Backing 12 - Improper Start From Parked Position 13 - Stopped or Parked Illegally 14 - Operating Vehicle in Negligent Manner 15 - Swerving to Avoid (Due to External Conditions) 16 - Wrong Side/Wrong Way 17 - Failure to Control 18 - Vision Obstruction 19 - Operating Defective Equipment 20 - Load Shifting/Falling/Spilling 21 - Other Improper Action		Non-Motorist 22 - None 23 - Improper Crossing 24 - Darting 25 - Lying and/or Illegally in Roadway 26 - Failure to Yield Right of Way 27 - Not Visible (Dark Clothing) 28 - Inattentive 29 - Failure to Obey Traffic Signs /Signals/Officer 30 - Wrong Side of the Road 31 - Other Non-Motorist Action		Vehicle Defects 0 0 01 - Turn Signals 02 - Head Lamps 03 - Tail Lamps 04 - Brakes 05 - Steering 06 - Tire Blowout 07 - Worn or Slick tires 08 - Trailer Equipment Defective 09 - Motor Trouble 10 - Disabled From Prior Accident 11 - Other Defects	
Sequence of Events 1 2 0 2 0 0 3 0 0 4 0 0 5 0 0 6 0 0 First Harmful Event 1 Most Harmful Event 1 99 - Unknown		Non-Collision Events 01 - Overturn/Rollover 02 - Fire/Explosion 03 - Immersion 04 - Jackknife 05 - Cargo/Equipment Loss or Shift		06 - Equipment Failure (Blown Tire, Brake Failure, etc) 07 - Separation of Units 08 - Ran Off Road Right 09 - Ran Off Road Left		10 - Cross Median 11 - Cross Center Line Opposite Direction of Travel 12 - Downhill Runaway 13 - Other Non-Collision	
Collision with Person, Vehicle or Object Not Fixed 14 - Pedestrian 15 - Pedalcycle 16 - Railway Vehicle (Train,Engine) 17 - Animal - Farm 18 - Animal - Deer 19 - Animal - Other 20 - Motor Vehicle in Transport		Collision With Fixed Object 21 - Parked Motor Vehicle 22 - Work Zone Maintenance Equipment 23 - Struck by Falling, Shifting Cargo or Anything Set in Motion by a Motor Vehicle 24 - Other Movable Object 25 - Impact Attenuator/Crash Cushion 26 - Bridge Overhead Structure 27 - Bridge Pier or Abutment 28 - Bridge Parapet 29 - Bridge Rail 30 - Guardrail Face 31 - Guardrail End 32 - Portable Barrier		33 - Median Cable Barrier 34 - Median Guardrail Barrier 35 - Median Concrete Barrier 36 - Median Other Barrier 37 - Traffic Sign Post 38 - Overhead Sign Post 39 - Light/Luminaries Support 40 - Utility Pole		41 - Other Post, Pole or Support 42 - Culvert 43 - Curb 44 - Ditch 45 - Embankment 46 - Fence 47 Mailbox 48 - Tree 49 - Fire Hydrant 50 - Work Zone Maintenance Equipment 51 - Wall, Building, Tunnel 52 - Other Fixed Object	
Unit Speed 0 0 <input checked="" type="checkbox"/> Stated <input type="checkbox"/> Estimated		Posted Speed 2 5		Traffic Control 0 4 01 - No Controls 02 - Stop Sign 03 - Yield Sign 04 - Traffic Signal 05 - Traffic Flashers 06 - School Zone 07 - Railroad Crossbucks 08 - Railroad Flashers 09 - Railroad Gates 10 - Construction Barricade 11 - Person (Flagger, Officer) 12 - Pavement Markings		Unit Direction From 1 To 2 1 - North 2 - South 3 - East 4 - West 5 - Northeast 6 - Northwest 7 - Southeast 8 - Southwest 9 - Unknown	



Motorist / Non-Motorist / Occupant

Local Report Number *

2 | 0 | 1 | 8 | 4 | 1 | 4 | 4 | | | | | | | | | |

Motorist/Non-Motorist

Motorist/Non-Motorist

Occupant

Occupant

Unit Number 01	Name: Last, First, Middle VASQUEZ WILMA	Date of Birth 08231967	Age 51	Gender F - Female M - Male
-------------------	--	---------------------------	-----------	----------------------------------

Address, City, State, Zip 156 GOULD AVE BEDFORD OH 44146 2646	Contact Phone - include area code 216-903-7587
--	---

Injuries 2	Injured Taken By 1	EMS Agency	Medical Facility Injured Taken To	Safety Equipment Used 04	DOT Compliant Motorcycle Helmet <input type="checkbox"/>	Seating Position 01	Air Bag Usage 1	Ejection 1	Trapped 1
---------------	-----------------------	------------	-----------------------------------	-----------------------------	---	------------------------	--------------------	---------------	--------------

OL State OH	Operator License Number UF336084	OL Class 4	No Valid OL <input type="checkbox"/>	M/C End <input type="checkbox"/>	Condition 5	Alcohol/Drug Suspected 1	Alcohol Test Status 1	Alcohol Test Type 1	Alcohol Test Value	Drug Test Status 1	Drug Test Type 1
----------------	-------------------------------------	---------------	---	-------------------------------------	----------------	-----------------------------	--------------------------	------------------------	--------------------	-----------------------	---------------------

Offense Charged (Local Code) 331.08	Offense Description MARKED LANES	Citation Number G20185349	Hands-Free Device Used <input type="checkbox"/>	Driver Distracted By 1
--	-------------------------------------	------------------------------	--	---------------------------

Unit Number 02	Name: Last, First, Middle RUSSO PATRICIA A	Date of Birth 07241968	Age 50	Gender F - Female M - Male
-------------------	---	---------------------------	-----------	----------------------------------

Address, City, State, Zip 4009 HENRITZE AVE CLEVELAND OH 44109	Contact Phone - include area code
---	-----------------------------------

Injuries 1	Injured Taken By	EMS Agency	Medical Facility Injured Taken To	Safety Equipment Used 04	DOT Compliant Motorcycle Helmet <input type="checkbox"/>	Seating Position 01	Air Bag Usage 1	Ejection 1	Trapped 1
---------------	------------------	------------	-----------------------------------	-----------------------------	---	------------------------	--------------------	---------------	--------------

OL State OH	Operator License Number RH502318	OL Class 4	No Valid OL <input type="checkbox"/>	M/C End <input type="checkbox"/>	Condition 1	Alcohol/Drug Suspected 1	Alcohol Test Status 1	Alcohol Test Type 1	Alcohol Test Value	Drug Test Status 1	Drug Test Type 1
----------------	-------------------------------------	---------------	---	-------------------------------------	----------------	-----------------------------	--------------------------	------------------------	--------------------	-----------------------	---------------------

Offense Charged (Local Code)	Offense Description	Citation Number	Hands-Free Device Used <input type="checkbox"/>	Driver Distracted By 1
------------------------------	---------------------	-----------------	--	---------------------------

Injuries 1 - No Injury/None Reported 2 - Possible 3 - Non-Incapacitating 4 - Incapacitating 5 - Fatal	Injured Taken By 1 - Not Transported / Treated at Scene 2 - EMS 3 - Police 4 - Other 9 - Unknown	Safety Equipment Used Motorist 01 - None Used - Vehicle Occupant 02 - Shoulder Belt Only Used 03 - Lap Belt Only Used 04 - Shoulder Belt and Lap Belt Used 99 - Unknown Safety Equipment Non-Motorist 05 - Child Restraint System-Forward Facing 06 - Child Restraint System-Rear Facing 07 - Booster Seat 08 - Helmet Used 09 - None Used 10 - Helmet Used 11 - Protective Pads Used (Elbows, Knees, Etc) 12 - Reflective Clothing 13 - Lighting 14 - Other
---	--	---

Seating Position 01 - Front - Left Side (Motorcycle Driver) 02 - Front - Middle 03 - Front - Right Side 04 - Second - Left Side (Motorcycle Passenger) 05 - Second - Middle 06 - Second - Right Side 07 - Third - Left Side (Motorcycle Side Car) 08 - Third - Middle 09 - Third - Right Side 10 - Sleeper Section of Cab (Truck) 11 - Passenger in Other Enclosed Cargo Area (Non-Trailing Unit Such as a Bus, Pick-up with Cab) 12 - Passenger in Unenclosed Cargo Area 13 - Trailing Unit 14 - Riding on Vehicle Exterior (Non-Trailing Unit) 15 - Non-Motorist 16 - Other 99 - Unknown	Air Bag Usage 1 - Not Deployed 2 - Deployed Front 3 - Deployed Side 4 - Deployed Both Front/Side 5 - Not Applicable 9 - Deployment Unknown
--	---

Ejection 1 - Not Ejected 2 - Totally Ejected 3 - Partially Ejected 4 - Not Applicable	Trapped 1 - Not Trapped 2 - Extricated by Mechanical Means 3 - Extricated by Non-Mechanical Means	Operator License Class 1 - Class A 2 - Class B 3 - Class C 4 - Regular Class (Ohio is "D") 5 - MC/Moped Only	Condition 1 - Apparently Normal 2 - Physical Impairment 3 - Emotional (Depressed, Angry, Disturbed) 4 - Illness 5 - Fell Asleep, Fainted, Fatigued 6 - Under The Influence of Medications, Drugs, Alcohol 7 - Other	Alcohol/Drug Suspected 1 - None 2 - Yes - Alcohol Suspected 3 - Yes - HBD Not Impaired 4 - Yes - Drugs Suspected 5 - Yes - Alcohol and Drugs Suspected
--	---	--	---	--

Alcohol Test Status 1 - None Given 2 - Test Refused 3 - Test Given, Contaminated Sample/Unusable 4 - Test Given, Results Known 5 - Test Given, Results Unknown	Alcohol Test Type 1 - None 2 - Blood 3 - Urine 4 - Breath 5 - Other	Drug Test Status 1 - None Given 2 - Test Refused 3 - Test Given, Contaminated Sample/Unusable 4 - Test Given, Results Known 5 - Test Given, Results Unknown	Drug Test Type 1 - None 2 - Blood 3 - Urine 4 - Other	Driver Distracted By 1 - No Distraction Reported 2 - Phone 3 - Texting/E-mailing 4 - Electronic Communication Device 5 - Other Electronic Device (Navigation Device, Radio, DVD) 6 - Other Inside the Vehicle 7 - External Distraction
--	---	---	--	--

Unit Number 02	Name: Last, First, Middle RUSSO ANITA J	Date of Birth 111091960	Age 58	Gender F - Female M - Male
-------------------	--	----------------------------	-----------	----------------------------------

Address, City, State, Zip 4009 HENRITZE CLEVELAND OH 44109	Contact Phone - include area code
---	-----------------------------------

Injuries 1	Injured Taken By	EMS Agency	Medical Facility Injured Taken To	Safety Equipment Used 04	DOT Compliant Motorcycle Helmet <input type="checkbox"/>	Seating Position 03	Air Bag Usage 1	Ejection 1	Trapped 1
---------------	------------------	------------	-----------------------------------	-----------------------------	---	------------------------	--------------------	---------------	--------------

Unit Number	Name: Last, First, Middle	Date of Birth	Age	Gender F - Female M - Male
-------------	---------------------------	---------------	-----	----------------------------------

Address, City, State, Zip	Contact Phone - include area code
---------------------------	-----------------------------------

Injuries	Injured Taken By	EMS Agency	Medical Facility Injured Taken To	Safety Equipment Used	DOT Compliant Motorcycle Helmet <input type="checkbox"/>	Seating Position	Air Bag Usage	Ejection	Trapped
----------	------------------	------------	-----------------------------------	-----------------------	---	------------------	---------------	----------	---------