

# TRAFFIC CRASH REPORT

\*DENOTES MANDATORY FIELD FOR SUPPLEMENT REPORT

LOCAL REPORT NUMBER \*

2 | 0 | 1 | 9 | 2 | 6 | 0 | 5 |

PHOTOS TAKEN     OH-2     OH-3  
 SECONDARY CRASH     OH-1P     OTHER  
 Private Property

LOCAL INFORMATION  
 REPORTING AGENCY NAME \*  
**GARFIELD HEIGHTS**    NCIC \*  
 0 | 1 | 8 | 2 | 0 |

HIT/SKIP  
 1 - Solved    NUMBER OF UNITS  
 2 - Unsolved    0 | 2 |    UNIT IN ERROR  
 98 - ANIMAL    0 | 2 |    99 - UNKNOWN

COUNTY \*    LOCALITY \*  
 1 | 8 |    1 |    1 - CITY \*  
 2 - VILLAGE \*  
 3 - TOWNSHIP \*

LOCATION: CITY, VILLAGE, TOWNSHIP \*  
**GARFIELD HTS**

CRASH DATE/TIME \*  
 0 | 7 | 2 | 8 | 2 | 0 | 1 | 9 | 1 | 3 | 2 | 3 |

CRASH SEVERITY  
 5 | 1 - FATAL  
 2 - SERIOUS INJURY SUSPECTED  
 3 - MINOR INJURY SUSPECTED  
 4 - INJURY POSSIBLE  
 5 - PROPERTY DAMAGE ONLY

ROUTE TYPE    ROUTE NUMBER    PREFIX  
 1 - NORTH  
 2 - SOUTH  
 3 - EAST  
 4 - WEST

LOCATION ROAD NAME  
**TURNEY**

ROAD TYPE    LATITUDE DECIMAL DEGREES  
 R | D |    4 | 1 | . | 4 | 1 | 2 | 6 | 9 | 7 |

ROUTE TYPE    ROUTE NUMBER    PREFIX  
 1 - NORTH  
 2 - SOUTH  
 3 - EAST  
 4 - WEST

REFERENCE ROAD NAME (ROAD, MILEPOST, HOUSE #)  
**WILLIARD**

ROAD TYPE    LONGITUDE DECIMAL DEGREES  
 A | V |    8 | 1 | . | 6 | 0 | 2 | 9 | 5 | 1 |

REFERENCE POINT  
 1 - INTERSECTION  
 2 - MILE POST  
 3 - HOUSE #  
 1 |

DIRECTION  
 1 - NORTH  
 2 - SOUTH  
 3 - EAST  
 4 - WEST  
 2 |

INTERSECTION RELATED  
 WITHIN INTERSECTION OR ON APPROACH  
 WITHIN INTERCHANGE AREA    NUMBER OF APPROACHES

DISTANCE FROM REFERENCE    DISTANCE UNIT OF MEASURE  
 1 | 7 |    2 |    1 - Miles  
 2 - Feet  
 3 - Yards

ROUTE TYPE    ROAD TYPE  
 IR - INTERSTATE ROUTE (TP)  
 US - FEDERAL US ROUTE  
 SR - STATE ROUTE  
 CR - NUMBERED COUNTY ROUTE  
 TR - NUMBERED TOWNSHIP ROUTE  
 AL - ALLEY  
 AV - AVENUE  
 BL - BOULEVARD  
 CR - CIRCLE  
 CT - COURT  
 DR - DRIVE  
 HE - HEIGHTS  
 HW - HIGHWAY  
 LA - LANE  
 MP - MILEPOST  
 OV - OVAL  
 PK - PARKWAY  
 PI - PIKE  
 PL - PLACE  
 RD - ROAD  
 SQ - SQUARE  
 ST - STREET  
 TE - TERRACE  
 TL - TRAIL  
 WA - WAY

ROADWAY  
 ROADWAY DIVIDED

LOCATION OF FIRST HARMFUL EVENT  
 0 | 1 |    1 - ON ROADWAY  
 2 - ON SHOULDER  
 3 - IN MEDIAN  
 4 - ON ROADSIDE  
 5 - ON GORE  
 6 - OUTSIDE TRAFFICWAY  
 7 - ON RAMP  
 8 - OFF RAMP  
 9 - CROSSOVER  
 10 - DRIVEWAY / ALLEY ACCESS  
 11 - RAILWAY GRADE CROSSING  
 12 - SHARED USE PATHS OR TRAILS  
 13 - BIKE LANE  
 14 - TOLL BOOTH  
 99 - OTHER / UNKNOWN

MANNER OF CRASH COLLISION/IMPACT  
 2 |    1 - NOT COLLISION BETWEEN TWO MOTOR VEHICLES IN TRANSPORT  
 2 - REAR-END  
 3 - HEAD-ON  
 4 - REAR-TO-REAR  
 5 - BACKING  
 6 - ANGLE  
 7 - SIDESWIPE, SAME DIRECTION  
 8 - SIDESWIPE, OPPOSITE DIRECTION  
 9 - OTHER / UNKNOWN

DIRECTION OF TRAVEL  
 1 - NORTH  
 2 - SOUTH  
 3 - EAST  
 4 - WEST

MEDIAN TYPE  
 1 - DIVIDED FLUSH MEDIAN (<4 FEET)  
 2 - DIVIDED FLUSH MEDIAN (≥4 FEET)  
 3 - DIVIDED, DEPRESSION MEDIAN (ANY TYPE)  
 4 - DIVIDED, RAISED MEDIAN (ANY TYPE)  
 9 - OTHER / UNKNOWN

WORK ZONE RELATED  
 WORKERS PRESENT  
 LAW ENFORCEMENT PRESENT  
 ACTIVE SCHOOL ZONE

WORK ZONE TYPE  
 1 - LANE CLOSURE  
 2 - LANE SHIFT/CROSSOVER  
 3 - WORK ON SHOULDER OR MEDIAN  
 4 - INTERMITTENT OR MOVING WORK  
 5 - OTHER

LOCATION OF CRASH IN WORK ZONE  
 1 - BEFORE THE 1ST WORK ZONE WARNING SIGN  
 2 - ADVANCE WARNING AREA  
 3 - TRANSITION AREA  
 4 - ACTIVITY AREA  
 5 - TERMINATION AREA

CONTOUR  
 1 |    1 - STRAIGHT LEVEL  
 2 - STRAIGHT GRADE  
 3 - CURVE LEVEL  
 4 - CURVE GRADE  
 9 - OTHER / UNKNOWN

CONDITIONS  
 1 |    1 - DRY  
 2 - WET  
 3 - SNOW  
 4 - ICE  
 5 - SAND, MUD, DIRT, OIL, GRAVEL  
 6 - WATER (STANDING, MOVING)  
 7 - SLUSH  
 9 - OTHER/UNKNOWN

SURFACE  
 2 |    1 - CONCRETE  
 2 - BLACKTOP, BITUMINOUS, ASPHALT  
 3 - BRICK/BLOCK  
 4 - SLAG, GRAVEL, STONE  
 5 - DIRT  
 9 - OTHER / UNKNOWN

LIGHT CONDITION  
 1 |    1 - DAYLIGHT  
 2 - DAWN/DUSK  
 3 - DARK - LIGHTED ROADWAY  
 4 - DARK - ROADWAY NOT LIGHTED  
 5 - DARK - UNKNOWN ROADWAY LIGHTING  
 9 - OTHER / UNKNOWN

WEATHER  
 1 |    1 - CLEAR  
 2 - CLOUDY  
 3 - FOG, SMOG, SMOKE  
 4 - RAIN  
 5 - SLEET, HAIL  
 6 - SNOW  
 7 - SEVERE CROSSWINDS  
 8 - BLOWING SAND, SOIL, DIRT, SNOW  
 9 - FREEZING RAIN OR FREEZING DRIZZLE  
 99 - OTHER / UNKNOWN

CRASH REPORTED DATE/TIME    DISPATCH DATE/TIME    ARRIVAL DATE/TIME    SCENE CLEARED DATE/TIME  
 0 | 7 | 2 | 8 | 2 | 0 | 1 | 9 | 1 | 3 | 2 | 3 |    0 | 7 | 2 | 8 | 2 | 0 | 1 | 9 | 1 | 3 | 2 | 3 |    0 | 7 | 2 | 8 | 2 | 0 | 1 | 9 | 1 | 3 | 2 | 3 |    0 | 7 | 2 | 8 | 2 | 0 | 1 | 9 | 1 | 3 | 4 | 0 |

NARRATIVE  
**UNIT 1 WAS STOPPED IN TRAFFIC TURNEY NORTH CURB LANE. UNIT 2 WAS TRAVELING DIRECTLY BEHIND UNIT 1 IN SAME LANE AND STRUCK UNIT 1 FROM BEHIND.**

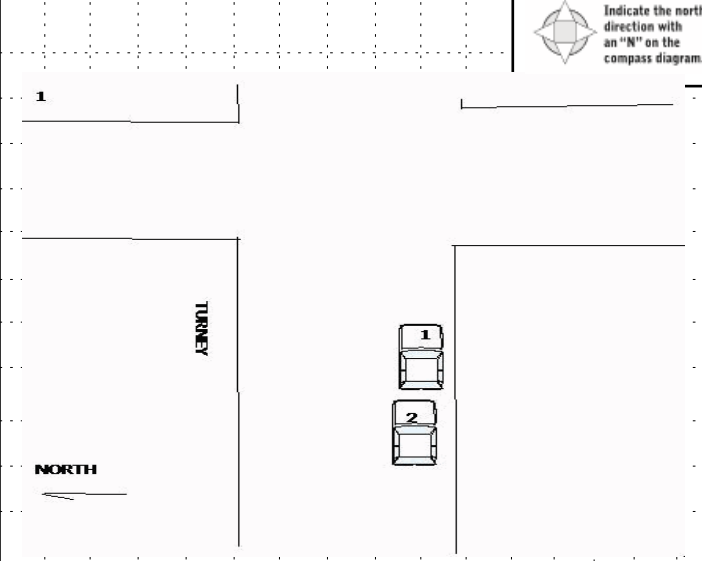

TOTAL TIME ROADWAY CLOSED    OTHER INVESTIGATION TIME  
 0 |    1 | 0 |

TOTAL MINUTES  
 2 | 7 |

OFFICER'S NAME \*  
**D. Dupont**  
 OFFICER'S BADGE NUMBER\*  
 0 | 5 | 0 |

CHECKED BY OFFICER'S NAME\*  
**M. Kaye**  
 CHECKED BY OFFICER'S BADGE NUMBER\*  
 L | 1 | 0 |

REPORT TAKEN BY  
 POLICE AGENCY  
 MOTORIST  
 SUPPLEMENT (CORRECTION IN ADDITION)

2 0 1 9 2 6 0 5

UNIT # 0 2 OWNER NAME: LAST, FIRST, MIDDLE (  Same As Driver )  
**JOHNSON WILLIAM**

OWNER PHONE: INCLUDE AREA CODE (  Same As Driver )  
**2 1 6 6 4 1 0 8 7 1**

OWNER ADDRESS: STREET, CITY, STATE, ZIP (  Same As Driver )  
**4809 ROCKWOOD GARF HTS OH 44125**

COMMERCIAL CARRIER: NAME, ADDRESS, CITY, STATE, ZIP  
 COMMERCIAL CARRIER PHONE: INCLUDE AREA CODE

**DAMAGE**

**DAMAGE SCALE**

2 1 - NONE  
 2 - MINOR DAMAGE 3 - FUNCTIONAL DAMAGE  
 4 - DISABLING DAMAGE  
 9 - UNKNOWN

LP STATE O H LICENSE PLATE # 691XVA VEHICLE IDENTIFICATION # 5 F P Y K 1 F 5 5 C B 4 5 4 1 8 2 VEHICLE YEAR 2 0 1 2 VEHICLE MAKE Honda

INSURANCE VERIFIED  INSURANCE COMPANY GEICO INSURANCE POLICY # 4534597986 VEHICLE COLOR RED VEHICLE MODEL Ridgeline

TYPE OF USE:  COMMERCIAL  GOVERNMENT  IN EMERGENCY RESPONSE

INTERLOCK DEVICE EQUIPPED  HIT/SKIP UNIT  # OCCUPANTS 0 1 US DOT # \_\_\_\_\_ TOWED BY: COMPANY NAME \_\_\_\_\_

HAZARDOUS MATERIAL:  MATERIAL RELEASED CLASS # \_\_\_\_\_ PLACARD ID # \_\_\_\_\_  
 PLACARD

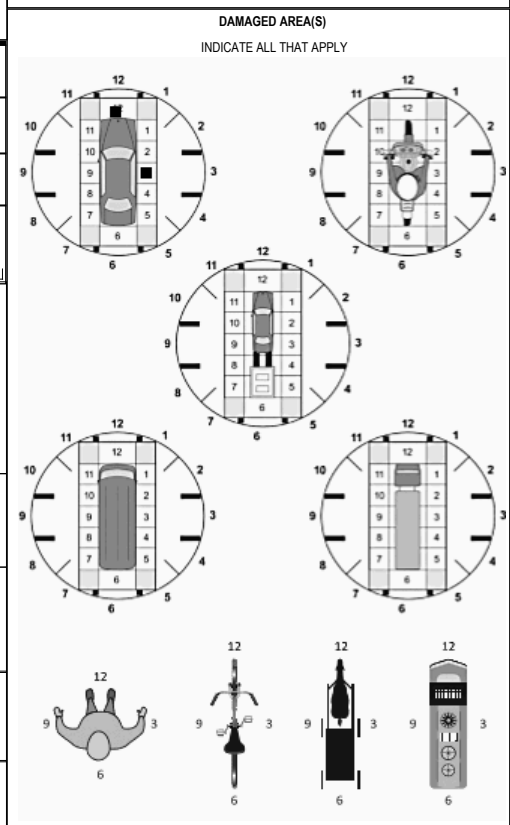

UNIT TYPE 0 1

1 - PASSENGER CAR 7 - MOTORCYCLE 2-WHEELED 12 - GOLF CART 18 - LIMO (LIVERY VEHICLE) 23 - PEDESTRIAN/SKATER  
 2 - PASSENGER VAN (MINIVAN) 8 - MOTORCYCLE 3-WHEELED 13 - SNOWMOBILE 19 - BUS (16+ PASSENGERS) 24 - WHEELCHAIR (ANY TYPE)  
 3 - SPORT UTILITY VEHICLE 9 - AUTOCYCLE 14 - SINGLE UNIT TRUCK 20 - OTHER VEHICLE 25 - OTHER NON-MOTORIST  
 4 - PICK UP 10 - MOPED OR MOTORIZED BICYCLE 15 - SEMI-TRACTOR 21 - HEAVY EQUIPMENT 26 - BICYCLE  
 5 - CARGO VAN 11 - ALL TERRAIN VEHICLE (ATV / UTV) 16 - FARM EQUIPMENT 22 - ANIMAL WITH RIDER OR ANIMAL-DRAWN VEHICLE 27 - TRAIN  
 6 - VAN (9-15 SEATS) 17 - MOTORHOME 99 - UNKNOWN OR HIT/SKIP

# of TRAILING UNITS \_\_\_\_\_

WAS VEHICLE OPERATING IN AUTONOMOUS MODE WHEN CRASH OCCURRED? 0

1 - YES 2 - NO 9 - OTHER / UNKNOWN

AUTONOMOUS MODE LEVEL: 0 - NO AUTOMATION 1 - DRIVER ASSISTANCE 2 - PARTIAL AUTOMATION 3 - CONDITIONAL AUTOMATION 4 - HIGH AUTOMATION 5 - FULL AUTOMATION 9 - UNKNOWN

SPECIAL FUNCTION 0 1

1 - NONE 6 - BUS - CHARTER/TOUR 11 - FIRE 16 - FARM 21 - MAIL CARRIER  
 2 - TAXI 7 - BUS - INTERCITY 12 - MILITARY 17 - MOWING 22 - OTHER / UNKNOWN  
 3 - ELECTRONIC RIDE SHARING 8 - BUS - SHUTTLE 13 - POLICE 18 - SNOW REMOVAL N  
 4 - SCHOOL TRANSPORT 9 - BUS - OTHER 14 - PUBLIC UTILITY 19 - TOWING  
 5 - BUS-TRANSIT/COMMUTER 10 - AMBULANCE 15 - CONSTRUCTION EQUIPMENT 20 - SAFETY SERVICE PATROL

CARGO BODY TYPE 0 1

1 - NO CARGO BODY TYPE / NOT APPLICABLE 3 - VEHICLE TOWING ANOTHER MOTOR VEHICLE 5 - INTERMODAL CONTAINER CHASSIS 8 - POLE 12 - CONCRETE MIXER  
 2 - BUS 4 - LOGGING 6 - CARGO VAN/ENCLOSED BOX 7 - GRAIN/CHIPS/GRAVEL 9 - CARGO TANK 10 - FLAT BED 11 - DUMP 13 - AUTO TRANSPORTER  
 14 - GARBAGE/REFUSE 15 - DUMP 16 - FARM 17 - MOWING 18 - SNOW REMOVAL 19 - TOWING 20 - SAFETY SERVICE PATROL 21 - MAIL CARRIER 22 - OTHER / UNKNOWN

VEHICLE DEFECTS

1 - TURN SIGNALS 4 - BRAKES 7 - WORN OR SLICK TIRES 9 - MOTOR TROUBLE 99 - OTHER / UNKNOWN  
 2 - HEAD LAMPS 5 - STEERING 8 - TRAILER EQUIPMENT DEFECTIVE 10 - DISABLED FROM PRIOR ACCIDENT  
 3 - TAIL LAMPS 6 - TIRE BLOWOUT

NON-MOTORIST LOCATION AT IMPACT

1 - INTERSECTION - MARKED CROSSWALK 3 - INTERSECTION - OTHER 6 - BICYCLE LANE 9 - MEDIAN/CROSSING ISLAND 12 - FIRST RESPONDER AT INCIDENT SCENE  
 2 - INTERSECTION - UNMARKED 4 - MIDLICK - MARKED CROSSWALK 7 - SHOULDER/ROADSIDE 8 - SIDEWALK 10 - DRIVEWAY ACCESS 11 - SHARED USE PATHS OR TRAILS 14 - GARBAGE/REFUSE 15 - DUMP 16 - FARM 17 - MOWING 18 - SNOW REMOVAL 19 - TOWING 20 - SAFETY SERVICE PATROL 21 - MAIL CARRIER 22 - OTHER / UNKNOWN

ACTION 0 1 PRE-CRASH ACTION

1 - NON-CONTACT 2 - NON-COLLISION 3 - STRIKING 4 - STRUCK 5 - BOTH STRIKING & STRUCK 9 - OTHER / UNKNOWN

1 - STRAIGHT AHEAD 2 - BACKING 3 - CHANGING LANES 4 - OVERTAKING/PASSING 5 - MAKING RIGHT TURN 6 - MAKING LEFT TURN 7 - MAKING U-TURN 8 - ENTERING TRAFFIC LANE 9 - LEAVING TRAFFIC LANE 10 - PARKED 11 - SLOWING OR STOPPED IN TRAFFIC 12 - DRIVERLESS 13 - NEGOTIATING A CURVE 14 - ENTERING OR CROSSING SPECIFIED LOCATION 15 - WALKING, RUNNING, JOGGING, PLAYING 16 - WORKING 17 - PUSHING VEHICLE 18 - APPROACHING OR LEAVING VEHICLE 19 - STANDING 20 - OTHER NON-MOTORIST 21 - STANDING OUTSIDE DISABLED VEHICLE 99 - OTHER / UNKNOWN

- NO DAMAGE [0]  - UNDERCARRIAGE [14]  
 - TOP [13]  - ALL AREAS [15]  
 - UNIT NOT AT SCENE [16]

CONTRIBUTING CIRCUMSTANCES 0 7

1 - NONE 7 - LEFT OF CENTER 13 - IMPROPER START FROM A PARKED POSITION 17 - VISION OBSTRUCTION 21 - LYING IN ROADWAY 22 - NOT DISCERNABLE  
 2 - FAILURE TO YIELD 8 - FOLLOWING TOO CLOSE/ACDA 14 - STOPPED OR PARKED ILLEGALLY 18 - OPERATING DEFECTIVE EQUIPMENT 23 - OPENING DOOR INTO ROADWAY  
 3 - RAN RED LIGHT 9 - IMPROPER LANE CHANGING 15 - SWERVING TO AVOID 19 - LOAD SHIFTING/ FALLING/SPILLING 99 - OTHER IMPROPER ACTION  
 4 - RAN STOP SIGN 10 - IMPROPER PASSING 11 - DROVE OFF ROAD 12 - IMPROPER BACKING 16 - WRONG WAY 20 - IMPROPER CROSSING  
 5 - UNSAFE SPEED 6 - IMPROPER TURN

**INITIAL POINT OF CONTACT**

1 2 0 - NO DAMAGE 14 - UNDERCARRIAGE  
 1-12 - REFER TO UNIT DIAGRAM 15 - VEHICLE NOT AT SCENE 99 - UNKNOWN

SEQUENCE OF EVENTS

EVENTS

1 2 0 1 - OVERTURN/ROLLOVER 6 - EQUIPMENT FAILURE 11 - CROSS CENTERLINE - OPPOSITE DIRECTION OF TRAVEL 16 - RAILWAY VEHICLE 22 - WORK ZONE MAINTENANCE EQUIPMENT  
 2 - FIRE/EXPLOSION 7 - SEPARATION OF UNITS 17 - ANIMAL - FARM 18 - ANIMAL - DEER 19 - ANIMAL - OTHER 20 - MOTOR VEHICLE IN TRANSPORT 21 - PARKED MOTOR VEHICLE 24 - OTHER MOVABLE  
 3 - IMMERSION 8 - RAN OFF ROAD RIGHT 9 - RAN OFF ROAD LEFT 10 - CROSS MEDIAN 12 - DOWNHILL RUNAWAY 13 - OTHER NON-COLLISION 14 - PEDESTRIAN 15 - PEDALCYCLE

**TRAFFIC**

TRAFFICWAY FLOW 2 1 - ONE-WAY 2 - TWO-WAY

TRAFFIC CONTROL 6 1 - ROUNDABOUT 4 - STOP SIGN 2 - SIGNAL 5 - YIELD SIGN 3 - FLASHER 6 - NO CONTROL

**COLLISION WITH FIXED OBJECT - STRUCK**

25 - IMPACT ATTENUATOR / CRASH CUSHION 31 - GUARDRAIL END 37 - TRAFFIC SIGN POST 43 - CURB 50 - WORKZONE MAINTENANCE EQUIPMENT  
 26 - BRIDGE OVERHEAD STRUCTURE 32 - PORTABLE BARRIER 38 - OVERHEAD SIGN POST 44 - DITCH 51 - WALL  
 27 - BRIDGE PIER OR ABUTMENT 33 - MEDIAN CABLE BARRIER 39 - LIGHT/LUMINARIES SUPPORT 45 - EMBANKMENT 52 - BUILDING  
 28 - BRIDGE PARAPET 34 - MEDIAN GUARDRAIL BARRIER 40 - UTILITY POLE 46 - FENCE 53 - TUNNEL  
 29 - BRIDGE RAIL 35 - MEDIAN CONCRETE BARRIER 41 - OTHER POST, POLE OR SUPPORT 47 - MAILBOX 48 - TREE 54 - OTHER FIXED OBJECT  
 30 - GUARDRAIL FACE 36 - MEDIAN OTHER BARRIER 42 - CULVERT 49 - FIRE HYDRANT 99 - OTHER / UNKNOWN

FIRST HARMFUL EVENT 1 MOST HARMFUL EVENT 1

# of THROUGH LANES ON ROAD 4

RAIL GRADE CROSSING 1 1 - NOT INVOLVED 2 - INVOLVED - ACTIVE CROSSING 3 - INVOLVED - PASSIVE CROSSING

**UNIT / NON-MOTORIST DIRECTION**

FROM 2 TO 1

1 - NORTH 5 - NORTHEAST 2 - SOUTH 6 - NORTHWEST 3 - EAST 7 - SOUTHEAST 4 - WEST 8 - SOUTHWEST

UNIT SPEED 1 2

POSTED SPEED 2 5

DETECTED SPEED 1 1 - STATED/ESTIMATED SPEED 2 - CALCULATED / EDR 3 - UNDETERMINED

2 0 1 9 2 6 0 5

**UNIT #** 0 1 **OWNER NAME: LAST, FIRST, MIDDLE** WILLIAMS MICHELE (  Same As Driver ) **OWNER PHONE: INCLUDE AREA CODE** (  Same As Driver )

**OWNER ADDRESS: STREET, CITY, STATE, ZIP** (  Same As Driver )  
 15312 MAPLE PARK DR MAPLE HTS OH 44137

**COMMERCIAL CARRIER: NAME, ADDRESS, CITY, STATE, ZIP** **COMMERCIAL CARRIER PHONE: INCLUDE AREA CODE**

**DAMAGE**

**DAMAGE SCALE**

2 1 - NONE  
 2 - MINOR DAMAGE  
 3 - FUNCTIONAL DAMAGE  
 4 - DISABLING DAMAGE  
 9 - UNKNOWN

**LP STATE** OH **LICENSE PLATE #** GOR3019 **VEHICLE IDENTIFICATION #** 1FMCU0GXX01FUC5181844 **VEHICLE YEAR** 2015 **VEHICLE MAKE** Ford

**INSURANCE VERIFIED**  **INSURANCE COMPANY** PROGRESSIVE **INSURANCE POLICY #** 918360150 **VEHICLE COLOR** BLK **VEHICLE MODEL** Escape

COMMERCIAL  GOVERNMENT  IN EMERGENCY RESPONSE **US DOT #** **TOWED BY: COMPANY NAME**

INTERLOCK DEVICE EQUIPPED  HIT/SKIP UNIT **# OCCUPANTS** 0 1 **VEHICLE WEIGHT GVWR/GCWR** 1 - ≤10K LBS.  
 2 - 10,001 - 26K LBS.  
 3 - >26K LBS. **HAZARDOUS MATERIAL**  MATERIAL RELEASED  PLACARD **CLASS #** **PLACARD ID #**



**UNIT TYPE** 0 3

1 - PASSENGER CAR 7 - MOTORCYCLE 2-WHEELED 12 - GOLF CART 18 - LIMO (LIVERY VEHICLE) 23 - PEDESTRIAN/SKATER  
 2 - PASSENGER VAN (MINIVAN) 8 - MOTORCYCLE 3-WHEELED 13 - SNOWMOBILE 19 - BUS (16+ PASSENGERS) 24 - WHEELCHAIR (ANY TYPE)  
 3 - SPORT UTILITY VEHICLE 9 - AUTOCYCLE 14 - SINGLE UNIT TRUCK 20 - OTHER VEHICLE 25 - OTHER NON-MOTORIST  
 4 - PICK UP 10 - MOPED OR MOTORIZED BICYCLE 15 - SEMI-TRACTOR 21 - HEAVY EQUIPMENT 26 - BICYCLE  
 5 - CARGO VAN 11 - ALL TERRAIN VEHICLE (ATV / UTV) 16 - FARM EQUIPMENT 22 - ANIMAL WITH RIDER OR ANIMAL-DRAWN VEHICLE 27 - TRAIN  
 6 - VAN (9-15 SEATS) 17 - MOTORHOME 99 - UNKNOWN OR HIT/SKIP

**# of TRAILING UNITS**

**WAS VEHICLE OPERATING IN AUTONOMOUS MODE WHEN CRASH OCCURRED?** 2 1 - YES 2 - NO 9 - OTHER / UNKNOWN **AUTONOMOUS MODE LEVEL** 0 0 - NO AUTOMATION 1 - DRIVER ASSISTANCE 2 - PARTIAL AUTOMATION 3 - CONDITIONAL AUTOMATION 4 - HIGH AUTOMATION 5 - FULL AUTOMATION 9 - UNKNOWN

**SPECIAL FUNCTION** 0 1

1 - NONE 6 - BUS - CHARTER/TOUR 11 - FIRE 16 - FARM 21 - MAIL CARRIER  
 2 - TAXI 7 - BUS - INTERCITY 12 - MILITARY 17 - MOWING 22 - OTHER / UNKNOWN  
 3 - ELECTRONIC RIDE SHARING 8 - BUS - SHUTTLE 13 - POLICE 18 - SNOW REMOVAL N  
 4 - SCHOOL TRANSPORT 9 - BUS - OTHER 14 - PUBLIC UTILITY 19 - TOWING  
 5 - BUS-TRANSIT/COMMUTER 10 - AMBULANCE 15 - CONSTRUCTION EQUIPMENT 20 - SAFETY SERVICE PATROL

**CARGO BODY TYPE** 0 1

1 - NO CARGO BODY TYPE / NOT APPLICABLE 3 - VEHICLE TOWING ANOTHER MOTOR VEHICLE 5 - INTERMODAL CONTAINER CHASSIS 8 - POLE 12 - CONCRETE MIXER  
 2 - BUS 4 - LOGGING 6 - CARGO VAN/ENCLOSED BOX 9 - CARGO TANK 13 - AUTO TRANSPORTER  
 7 - GRAIN/CHIPS/GRAVEL 10 - FLAT BED 11 - DUMP 14 - GARBAGE/REFUSE 15 - OTHER / UNKNOWN

**VEHICLE DEFECTS**

1 - TURN SIGNALS 4 - BRAKES 7 - WORN OR SLICK TIRES 9 - MOTOR TROUBLE 99 - OTHER / UNKNOWN  
 2 - HEAD LAMPS 5 - STEERING 8 - TRAILER EQUIPMENT DEFECTIVE 10 - DISABLED FROM PRIOR ACCIDENT  
 3 - TAIL LAMPS 6 - TIRE BLOWOUT

**NON-MOTORIST LOCATION AT IMPACT** 0 1

1 - INTERSECTION - MARKED CROSSWALK 3 - INTERSECTION - OTHER 6 - BICYCLE LANE 9 - MEDIAN/CROSSING ISLAND 12 - FIRST RESPONDER AT INCIDENT SCENE  
 2 - INTERSECTION - UNMARKED 4 - MIDBLOCK - MARKED CROSSWALK 7 - SHOULDER/ROADSIDE 10 - DRIVEWAY ACCESS 14 - GARBAGE/REFUSE 15 - OTHER / UNKNOWN  
 5 - TRAVEL LANE-OTHER LOCATION 8 - SIDEWALK 11 - SHARED USE PATHS OR TRAILS 19 - OTHER / UNKNOWN

**ACTION** 0 1

1 - NON-COLLISION 2 - NON-COLLISION 3 - STRIKING 4 - STRUCK 5 - BOTH STRIKING & STRUCK 9 - OTHER / UNKNOWN  
 1 - STRAIGHT AHEAD 2 - BACKING 3 - CHANGING LANES 4 - OVERTAKING/PASSING 5 - MAKING RIGHT TURN 6 - MAKING LEFT TURN  
 7 - MAKING U-TURN 8 - ENTERING TRAFFIC LANE 9 - LEAVING TRAFFIC LANE 10 - PARKED 11 - SLOWING OR STOPPED IN TRAFFIC 12 - DRIVERLESS  
 13 - NEGOTIATING A CURVE 14 - ENTERING OR CROSSING SPECIFIED LOCATION 15 - WALKING, RUNNING, JOGGING, PLAYING 16 - WORKING 17 - PUSHING VEHICLE  
 18 - APPROACHING OR LEAVING VEHICLE 19 - STANDING 20 - OTHER NON-MOTORIST 21 - STANDING OUTSIDE DISABLED VEHICLE 99 - OTHER / UNKNOWN

**INITIAL POINT OF CONTACT**

0 6 0 - NO DAMAGE 14 - UNDERCARRIAGE  
 1-12 - REFER TO UNIT DIAGRAM 15 - VEHICLE NOT AT SCENE 99 - UNKNOWN

**CONTRIBUTING CIRCUMSTANCES** 0 1

1 - NONE 7 - LEFT OF CENTER 13 - IMPROPER START FROM A PARKED POSITION 17 - VISION OBSTRUCTION 21 - LYING IN ROADWAY  
 2 - FAILURE TO YIELD 8 - FOLLOWING TOO CLOSE/ACDA 14 - STOPPED OR PARKED ILLEGALLY 18 - OPERATING DEFECTIVE EQUIPMENT 22 - NOT DISCERNABLE  
 3 - RAN RED LIGHT 9 - IMPROPER LANE CHANGING 15 - SWERVING TO AVOID 19 - LOAD SHIFTING/ FALLING/SPILLING 23 - OPENING DOOR INTO ROADWAY  
 4 - RAN STOP SIGN 10 - IMPROPER PASSING 16 - WRONG WAY 20 - IMPROPER CROSSING 99 - OTHER IMPROPER ACTION  
 5 - UNSAFE SPEED 11 - DROVE OFF ROAD 21 - IMPROPER BACKING  
 6 - IMPROPER TURN 12 - IMPROPER BACKING

**TRAFFIC**

**TRAFFICWAY FLOW** 2 1 - ONE-WAY 2 - TWO-WAY

**TRAFFIC CONTROL** 2 1 - ROUNDABOUT 4 - STOP SIGN 2 - SIGNAL 5 - YIELD SIGN 3 - FLASHER 6 - NO CONTROL

**# of THROUGH LANES ON ROAD** 4

**RAIL GRADE CROSSING** 1 - NOT INVOLVED 2 - INVOLVED - ACTIVE CROSSING 3 - INVOLVED - PASSIVE CROSSING

**SEQUENCE OF EVENTS**

**EVENTS**

1 2 0 1 - OVERTURN/ROLLOVER 6 - EQUIPMENT FAILURE 11 - CROSS CENTERLINE - OPPOSITE DIRECTION OF TRAVEL 16 - RAILWAY VEHICLE 22 - WORK ZONE MAINTENANCE EQUIPMENT  
 2 - FIRE/EXPLOSION 7 - SEPARATION OF UNITS 17 - ANIMAL - FARM 18 - ANIMAL - DEER 19 - ANIMAL - OTHER 20 - MOTOR VEHICLE IN TRANSPORT 21 - PARKED MOTOR VEHICLE 24 - OTHER MOVABLE  
 3 - IMMERSION 8 - RAN OFF ROAD RIGHT 9 - RAN OFF ROAD LEFT 10 - CROSS MEDIAN 12 - DOWNHILL RUNAWAY 13 - OTHER NON-COLLISION 14 - PEDESTRIAN 15 - PEDALCYCLE

**COLLISION with FIXED OBJECT - STRUCK**

25 - IMPACT ATTENUATOR / CRASH CUSHION 31 - GUARDRAIL END 37 - TRAFFIC SIGN POST 43 - CURB 50 - WORKZONE MAINTENANCE EQUIPMENT  
 26 - BRIDGE OVERHEAD STRUCTURE 32 - PORTABLE BARRIER 38 - OVERHEAD SIGN POST 44 - DITCH 51 - WALL  
 27 - BRIDGE PIER OR ABUTMENT 33 - MEDIAN CABLE BARRIER 39 - LIGHT/LUMINARIES SUPPORT 45 - EMBANKMENT 52 - BUILDING  
 28 - BRIDGE PARAPET 34 - MEDIAN GUARDRAIL BARRIER 40 - UTILITY POLE 46 - FENCE 53 - TUNNEL  
 29 - BRIDGE RAIL 35 - MEDIAN CONCRETE BARRIER 41 - OTHER POST, POLE OR SUPPORT 47 - MAILBOX 48 - TREE 54 - OTHER FIXED OBJECT  
 30 - GUARDRAIL FACE 36 - MEDIAN OTHER BARRIER 42 - CULVERT 49 - FIRE HYDRANT 99 - OTHER / UNKNOWN

**FIRST HARMFUL EVENT** 1 **MOST HARMFUL EVENT** 1

**UNIT / NON-MOTORIST DIRECTION**

FROM 2 TO 1

1 - NORTH 5 - NORTHEAST  
 2 - SOUTH 6 - NORTHWEST  
 3 - EAST 7 - SOUTHEAST  
 4 - WEST 8 - SOUTHWEST

**UNIT SPEED** 0 **DETECTED SPEED** 1 1 - STATED/ESTIMATED SPEED 2 - CALCULATED / EDR 3 - UNDETERMINED

**POSTED SPEED** 2 5

# MOTORIST / NON-MOTORIST

LOCAL REPORT NUMBER  
2 0 1 9 2 6 0 5

UNIT # 0 1	NAME: LAST, FIRST, MIDDLE WILLIAMS MICHELE		DATE OF BIRTH 0 8   3 0   1 9   5 6		AGE	GENDER F				
ADDRESS: STREET, CITY, STATE, ZIP 15312 MAPLE PARK DR MAPLE HTS OH 44137				CONTACT PHONE - INCLUDE AREA CODE						
INJURIES 5	INJURED TAKEN BY	EMS AGENCY (NAME)	INJURED TAKEN TO: MEDICAL FACILITY (NAME, CITY)	SAFETY EQUIPMENT USED 0 4	<input type="checkbox"/> DOT-COMPLIANT MC HELMET	SEATING POSITION 0 1	AIR BAG USAGE 1	EJECTION 1	TRAPPED 1	
OL STATE OH	OPERATOR LICENSE NUMBER RK964222	OFFENSE CHARGED	LOCAL CODE <input type="checkbox"/>	OFFENSE DESCRIPTION		CITATION NUMBER				
OL CLASS 4	ENDORSEMENT SELECT UP TO 2	RESTRICTION SELECT UP TO 3	DRIVER DISTRACTED BY 1	ALCOHOL / DRUG SUSPECTED <input type="checkbox"/> ALCOHOL <input type="checkbox"/> MARIJUANA <input type="checkbox"/> OTHER DRUG	CONDITION 1	STATUS 1	ALCOHOL TEST TYPE VALUE STATUS TYPE RESULT SELECT UP TO 4	DRUG TEST(S)		

UNIT # 0 2	NAME: LAST, FIRST, MIDDLE JOHNSON WILLIAM		DATE OF BIRTH 1 0   1 9   1 9   4 4		AGE 74	GENDER M				
ADDRESS: STREET, CITY, STATE, ZIP 4809 ROCKWOOD GARF HTS OH 44125				CONTACT PHONE - INCLUDE AREA CODE 2 1 6 6 4 1 0 8 7 1						
INJURIES 5	INJURED TAKEN BY	EMS AGENCY (NAME)	INJURED TAKEN TO: MEDICAL FACILITY (NAME, CITY)	SAFETY EQUIPMENT USED 0 4	<input type="checkbox"/> DOT-COMPLIANT MC HELMET	SEATING POSITION 0 1	AIR BAG USAGE 1	EJECTION 1	TRAPPED 1	
OL STATE OH	OPERATOR LICENSE NUMBER RP940941	OFFENSE CHARGED	LOCAL CODE <input type="checkbox"/>	OFFENSE DESCRIPTION		CITATION NUMBER				
OL CLASS	ENDORSEMENT SELECT UP TO 2	RESTRICTION SELECT UP TO 3	DRIVER DISTRACTED BY 1	ALCOHOL / DRUG SUSPECTED <input type="checkbox"/> ALCOHOL <input type="checkbox"/> MARIJUANA <input type="checkbox"/> OTHER DRUG	CONDITION 1	STATUS 1	ALCOHOL TEST TYPE VALUE STATUS TYPE RESULT SELECT UP TO 4	DRUG TEST(S)		

UNIT #	NAME: LAST, FIRST, MIDDLE		DATE OF BIRTH		AGE	GENDER				
ADDRESS: STREET, CITY, STATE, ZIP				CONTACT PHONE - INCLUDE AREA CODE						
INJURIES	INJURED TAKEN BY	EMS AGENCY (NAME)	INJURED TAKEN TO: MEDICAL FACILITY (NAME, CITY)	SAFETY EQUIPMENT USED	<input type="checkbox"/> DOT-COMPLIANT MC HELMET	SEATING POSITION	AIR BAG USAGE	EJECTION	TRAPPED	
OL STATE	OPERATOR LICENSE NUMBER	OFFENSE CHARGED	LOCAL CODE	OFFENSE DESCRIPTION		CITATION NUMBER				
OL CLASS	ENDORSEMENT SELECT UP TO 2	RESTRICTION SELECT UP TO 3	DRIVER DISTRACTED BY	ALCOHOL / DRUG SUSPECTED ALCOHOL MARIJUANA OTHER DRUG	CONDITION	STATUS	ALCOHOL TEST TYPE VALUE STATUS TYPE RESULT SELECT UP TO 4	DRUG TEST(S)		

INJURIES	SEATING POSITION	AIR BAG	OL CLASS	OL RESTRICTION(S)	DRIVER DISTRACTION	TEST STATUS
1 - FATAL	1 - FRONT - LEFT SIDE (MOTORCYCLE DRIVER)	1 - NOT DEPLOYED	1 - CLASS A	1 - ALCOHOL INTERLOCK DEVICE	1 - NOT DISTRACTED	1 - NONE GIVEN
2 - SUSPECTED SERIOUS INJURY	2 - FRONT - MIDDLE	2 - DEPLOYED FRONT	2 - CLASS B	2 - CDL INTRASTATE ONLY	2 - MANUALLY OPERATING AN ELECTRONIC COMMUNICATION DEVICE (TEXTING, TYPING, DIALING)	2 - TEST REFUSED
3 - SUSPECTED MINOR INJURY	3 - FRONT - RIGHT SIDE	3 - DEPLOYED SIDE	3 - CLASS C	3 - CORRECTIVE LENSES	3 - TALKING ON HANDS-FREE COMMUNICATION DEVICE	3 - TEST GIVEN, CONTAMINATED SAMPLE / UNUSABLE
4 - POSSIBLE INJURY	4 - SECOND - LEFT SIDE (MOTORCYCLE PASSENGER)	4 - DEPLOYED BOTH FRONT / SIDE	4 - REGULAR CLASS (OHIO = D)	4 - FARM WAIVER	4 - TALKING ON HAND-HELD COMMUNICATION DEVICE	4 - TEST GIVEN, RESULTS KNOWN
5 - NO APPARENT INJURY	5 - SECOND - MIDDLE	5 - NOT APPLICABLE	5 - M / C MOPED ONLY	5 - EXCEPT CLASS A BUS & CLASS B BUS	5 - OTHER ACTIVITY WITH AN ELECTRONIC DEVICE	5 - TEST GIVEN, RESULTS UNKNOWN
<b>INJURED TAKEN BY</b>		6 - SECOND - RIGHT SIDE	6 - NO VALID OL	6 - EXCEPT CLASS A & CLASS B BUS	6 - PASSENGER	<b>ALCOHOL TEST TYPE</b>
1 - NOT TRANSPORTED / TREATED AT SCENE	7 - THIRD - LEFT SIDE (MOTORCYCLE SIDE CAR)	9 - DEPLOYMENT UNKNOWN	<b>EJECTION</b>	7 - EXCEPT TRACTOR-TRAILER	7 - OTHER DISTRACTION INSIDE THE VEHICLE	1 - NONE
2 - EMS	8 - THIRD - MIDDLE	<b>EJECTION</b>	H - HAZMAT	8 - INTERMEDIATE LICENSE RESTRICTIONS	8 - OTHER DISTRACTIONS OUTSIDE THE VEHICLE	2 - BLOOD
3 - POLICE	9 - THIRD - RIGHT SIDE	1 - NOT EJECTED	M - MOTORCYCLE	9 - LEARNER'S PERMIT RESTRICTIONS	9 - OTHER / UNKNOWN	3 - URINE
9 - OTHER / UNKNOWN	10 - SLEEPER SECTION OF TRUCK CAB	2 - PARTIALLY EJECTED	P - PASSENGER	10 - LIMITED TO DAYLIGHT ONLY	<b>CONDITION</b>	4 - BREATH
<b>SAFETY EQUIPMENT</b>		3 - TOTALLY EJECTED	N - TANKER	11 - LIMITED TO EMPLOYMENT	1 - APPARENTLY NORMAL	<b>DRUG TEST TYPE</b>
1 - NONE USED	11 - PASSENGER IN OTHER ENCLOSED CARGO AREA (NON-TRAILING UNIT, BUS, PICK-UP WITH CAP)	4 - NOT APPLICABLE	Q - MOTOR SCOOTER	12 - LIMITED - OTHER	2 - PHYSICAL IMPAIRMENT	1 - NONE
2 - SHOULDER BELT ONLY USED	12 - PASSENGER IN UNENCLOSED CARGO AREA	<b>TRAPPED</b>	R - THREE-WHEEL MOTORCYCLE	13 - MECHANICAL DEVICES (SPECIAL BRAKES, HAND CONTROLS, OR OTHER ADAPTIVE DEVICES)	3 - EMOTIONAL (E.G. DEPRESSED, ANGRY, DISTURBED)	2 - BLOOD
3 - LAP BELT ONLY USED	13 - TRAILING UNIT	1 - NOT TRAPPED	S - SCHOOL BUS	14 - MILITARY VEHICLES ONLY	4 - ILLNESS	3 - URINE
4 - SHOULDER & LAP BELT USED	14 - RIDING ON VEHICLE EXTERIOR (NON-TRAILING UNIT)	2 - EXTRICATED BY MECHANICAL MEANS	T - DOUBLE & TRIPLE TRAILERS	15 - MOTOR VEHICLES WITHOUT AIR BRAKES	5 - FELL ASLEEP, FAINTED, FATIGUED, ETC.	4 - OTHER
5 - CHILD RESTRAINT SYSTEM - FORWARD FACING	15 - NON-MOTORIST	3 - FREED BY NON-MECHANICAL MEANS	X - TANKER / HAZMAT	16 - OUTSIDE MIRROR	6 - UNDER THE INFLUENCE OF MEDICATIONS / DRUGS / ALCOHOL	<b>DRUG TEST RESULT(S)</b>
6 - CHILD RESTRAINT SYSTEM - REAR FACING	99 - OTHER / UNKNOWN		<b>GENDER</b>	17 - PROSTHETIC AID	9 - OTHER / UNKNOWN	1 - AMPHETAMINES
7 - BOOSTER SEAT			F - FEMALE	18 - OTHER		2 - BARBITURATES
8 - HELMET USED			M - MALE			3 - BENZODIAZEPINES
9 - PROTECTIVE PADS USED (ELBOWS, KNEES, ETC.)			U - OTHER/UNKNOWN			4 - CANNABINOIDS
10 - REFLECTIVE CLOTHING						5 - COCAINE
11 - LIGHTING - PEDESTRIAN / BICYCLE ONLY						6 - OPIATES / OPIOIDS
99 - OTHER / UNKNOWN						7 - OTHER
						8 - NEGATIVE RESULTS