



Traffic Crash Report

Local Report Number *	Crash Severity	Hit/Skip
2 0 1 8 3 9 7 8	3 1 - Fatal 2 - Injury 3 - PDO	1 1 - Solved 2 - Unsolved

Local Information		Reporting Agency NCIC *	Reporting Agency Name *	Number of Units	Unit in error
<input type="checkbox"/> Photos Taken <input type="checkbox"/> OH-2 <input type="checkbox"/> OH-1P <input type="checkbox"/> OH-3 <input type="checkbox"/> Other	<input type="checkbox"/> PDO Under State Reportable Dollar Amount	<input type="checkbox"/> Private Property	0 1 8 2 0	GARFIELD HEIGHTS	0 2
County *		<input checked="" type="checkbox"/> City * <input type="checkbox"/> Village * <input type="checkbox"/> Township *	City, Village, Township *	Crash Date *	Time of Crash
1 8		<input checked="" type="checkbox"/> City * <input type="checkbox"/> Village * <input type="checkbox"/> Township *	GARFIELD HTS	1 0 2 8 2 0 1 8	0 8 4 3

Degrees / Minutes / Seconds Latitude	Longitude	Decimal Degrees Latitude	Longitude
° ' "	- ° ' "	.	- .
Roadway Division		Divided Lane Direction of Travel	Number of Thru Lanes
<input type="checkbox"/> Divided <input checked="" type="checkbox"/> Undivided		<input type="checkbox"/> N - Northbound <input type="checkbox"/> S - Southbound	0 2

Road Types or Milepost ²	Location Route Type ¹	Location Road name	Location Road Type ²
AL - Alley CR - Circle HE - Heights MP - Milepost PL - Place ST - Street WA - Way AV - Avenue CT - Court HW - Highway PK - Parkway RD - Road TE - Terrace BL - Boulevard DR - Drive LA - Lane PI - Pike SQ - Square TL - Trail	IR - Interstate Route (inc. turnpike) US - US Route SR - State Route	N.S. E,W BLYTHIN	RD

Distance From Reference	Dir From Ref	Reference Route Type ¹	Reference Route Number	Ref Prefix	Reference Name (Road, Milepost, House #)	Reference Road Type ²
<input type="checkbox"/> Miles <input type="checkbox"/> Feet <input type="checkbox"/> Yards	<input type="checkbox"/> N,S, <input type="checkbox"/> E,W			N.S, E,W	4649	

Reference Point Used	Crash Location	Reference Point Used	Location of First Harmful Event
3 1 - Intersection 2 - Mile Post 3 - House Number	0 1	01 - Not an intersection 02 - Four-way Intersection 03 - T-Intersection 04 - Y-Intersection 05 - Traffic Circle/Roundabout	1 1 - On Roadway 2 - On Shoulder 3 - In Median 4 - On Roadside

Road Contour	Road Conditions	Weather
2 1 - Straight Level 2 - Straight Grade 3 - Curve Level	0 2	9 1 - Clear 2 - Cloudy 3 - Fog, Smog, Smoke

Manner of Crash Collision/Impact	Weather
1 1 - Not Collision Between Two Motor Vehicles In Transport 2 - Rear-End 3 - Head-On 4 - Rear-to-Rear	9 1 - Clear 2 - Cloudy 3 - Fog, Smog, Smoke

Road Surface	Light conditions	School Bus Related
2 1 - Concrete 2 - Blacktop, Bituminous, Asphalt 3 - Brick/Block	9 Primary	<input type="checkbox"/> School Zone Related <input type="checkbox"/> Yes, School Bus Directly Involved <input type="checkbox"/> Yes, School Bus Indirectly Involved

Work Zone Related	Type of Work Zone	Location of Crash in Work Zone
<input type="checkbox"/> Workers Present <input type="checkbox"/> Law Enforcement Present (Officer/Vehicle) <input type="checkbox"/> Law Enforcement Present (Vehicle Only)	1 - Lane Closure 2 - Lane Shift/Crossover 3 - Work on Shoulder or Median	1 - Before the first Work Zone Warning Sign 2 - Advance Warning Area 3 - Transition Area

Narrative

UNIT 1 WAS PARKED ON N/B BLYTHIN IN FRONT OF 4649.

UNIT 2 APPEARED TO HAVE BACKED OUT OF THE DRIVE OF 4646 BLYTHIN. UNIT 2 FAILED TO OBSERVE UNIT 1 CAUSING UNIT 2 TO BACK INTO THE LEFT FRONT OF UNIT 1. UNIT 2 FAILED TO STOP AFTER THE IMPACT AND FLED THE SCENE.

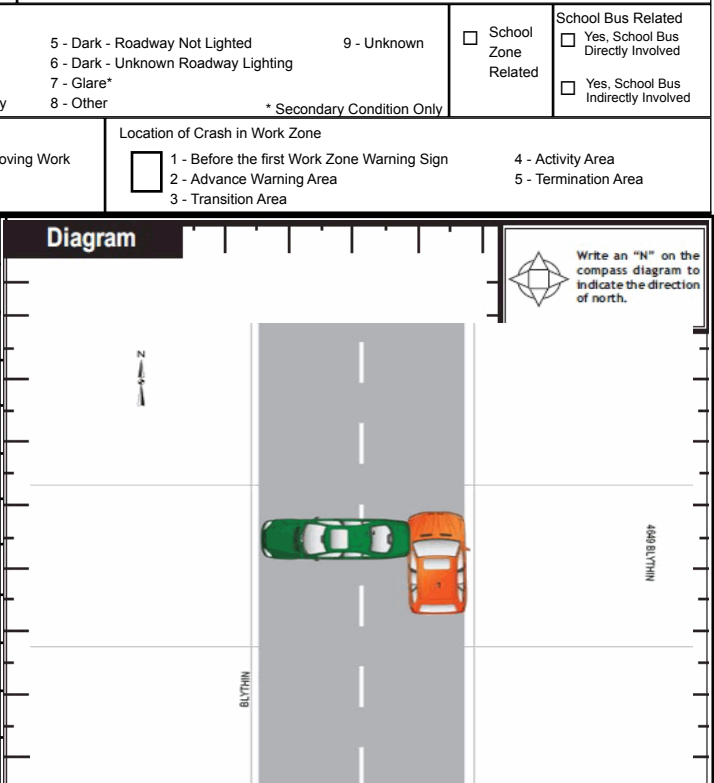

Report Taken By	Supplement (Correction or Addition to an Existing Report Sent to ODPS)	Date Crash Reported	Time Crash Reported	Dispatch Time	Arrival Time	Time Cleared	Other Investigation Time	Total Minutes
<input checked="" type="checkbox"/> Police Agency <input type="checkbox"/> Motorist	<input type="checkbox"/>	1 0 2 8 2 0 1 8	0 8 4 3	0 8 4 8	0 9 0 2	1 0 0 0	0	5 8
Officer's Name *	Officer's Badge Number	Checked By	Page					
T. Baon	040	L10 M. Kaye	of					



Unit

Local Report Number *

2 | 0 | 1 | 8 | 3 | 9 | 7 | 8 | | | | | |

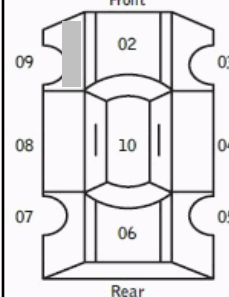
Unit Number 01		Owner Name: Last, First, Middle (<input type="checkbox"/> Same As Driver) STRADFORD KENTASIA ANITA SAMONE		Owner Phone Number - inc. area code (<input type="checkbox"/> Same As Driver) 216-319-5020		Damage Scale 4		Damaged Area 								
Owner Address, City, State, Zip (<input type="checkbox"/> Same As Driver) 4646 BLYTHIN GARFIELD HTS OH 44104																
LP State OH		License Plate Number HEV5412		Vehicle Identification Number JHLRE48519C004685				# Occupants 00								
Vehicle Year 2009		Vehicle Make HOND Honda		Vehicle Model CRV Cr-V		Vehicle Color BLK Black										
<input type="checkbox"/> Proof of Insurance Shown		Insurance Company GRANGE INS		Policy Number PPT 4195795		Towed By										
Carrier Name, Address, City, State, Zip								Carrier Phone - include area code								
US DOT		Vehicle Weight GVWR/GCWR <input type="checkbox"/> 1 - Less Than or Equal to 10k Lbs. <input type="checkbox"/> 2 - 10,001 to 26,000 Lbs. <input type="checkbox"/> 3 - More Than 26,000 Lbs.		Cargo Body Type 01 01 - No Cargo Body Type/Not Applicable 02 - Bus/Van(9-15 Seats, Inc.Driver) 03 - Bus(16+ Seats, Inc Driver) 04 - Vehicle Towing Another Vehicle 05 - Logging 06 - Intermodal Container Chassis 07 - Cargo Van/Enclosed Box 08 - Grain, Chips, Gravel		09 - Pole 10 - Cargo Tank 11 - Flat Bed 12 - Dump 13 - Concrete Mixer 14 - Auto Transporter 15 - Garbage/Refuse 99 - Other/Unknown		Trafficway Description 1 1 - Two-Way, Not Divided 2 - Two-Way, Not Divided, Continuous Left Turn Lane 3 - Two-Way, Divided, Unprotected (Painted or Grass>4 Ft.) Median 4 - Two-Way, Divided, Positive Median Barrier 5 - One-Way Trafficway <input type="checkbox"/> Hit / Skip Unit								
HM Placard ID No.		<input type="checkbox"/> Hazardous Material Released		HM Class Number		<input type="checkbox"/> Has HM Placard										
Non-Motorist Location Prior to Impact 01 - Intersection - Marked Crosswalk 02 - Intersection - No Crosswalk 03 - Intersection - Other 04 - Midblock - Marked Crosswalk 05 - Travel Lane - Other Location 06 - Bicycle Lane 07 - Shoulder/Roadside 08 - Sidewalk 09 - Median/Crossing Island 10 - Driveway Access 11 - Shared-Use Path or Trail 12 - Non-Trafficway Area 99 - Other/Unknown			Type of Use 1 1 - Personal 2 - Commercial 3 - Government <input type="checkbox"/> In Emergency Response		Unit Type 06 99 - Unknown or Hit/Skip		Passenger Vehicle (less than 9 passengers) 01 - Sub-Compact 02 - Compact 03 - Mid Size 04 - Full Size 05 - Minivan 06 - Sports Utility Vehicle 07 - Pickup 08 - Van 09 - Motorcycle 10 - Motorized Bicycle 11 - Snowmobile/ATV 12 - Other Passenger Vehicle		Med/Heavy Trucks or Combo Units>10k lbs 13 - Single Unit Truck or Van 2axle,6 tires 14 - Single Unit Truck 3+ axles 15 - Single Unit Truck/Trailer 16 - Truck/Tractor(Bobtail) 17 - Tractor/Semi-Trailer 18 - Tractor/Double 19 - Tractor/Triples 20 - Other Med/Heavy Vehicle		Bus/Van/Limo (9 or More Including Driver) 21 - Bus/Van (9-15 Seats, Inc Driver) 22 - BUS(16+ Seats, Inc Driver) Non-Motorist 23 - Animal with Rider 24 - Animal with Buggy, Wagon, Surrey 25 - Bicycle/Pedacyclist 26 - Pedestrian/Skater 27 - Other Non-Motorist					
Special Function 01 01 - None 02 - Taxi 03 - Rental Truck (Over 10K Lbs) 04 - Bus - School (Public or Private) 05 - Bus - Transit 06 - Bus - Charter 07 - Bus - Shuttle 08 - Bus - Other			09 - Ambulance 10 - Fire 11 - Highway/Maintenance 12 - Military 13 - Police 14 - Public Utility 15 - Other Government 16 - Construction Equip.		17 - Farm Vehicle 18 - Farm Equipment 19 - Motorhome 20 - Golf Cart 21 - Train 22 - Other (Explain in Narrative)		Most Damaged Area 09 01 - None 02 - Center Front 03 - Right Front 04 - Right Side 05 - Right Rear 06 - Rear Center 07 - Left Rear		08 - Left Side 09 - Left Front 10 - Top and Windows 11 - Undercarriage 12 - Load/Trailer 13 - Total (All Areas) 14 - Other		Action 4 1 - Non-Contact 2 - Non-Collision 3 - Striking 4 - Struck 5 - Striking/Struck 9 - Unknown					
Pre-Crash Actions 10 01 - Straight Ahead 02 - Backing 03 - Changing Lanes 99 - Unknown 04 - Overtaking/Passing 05 - Making Right Turn 06 - Making Left Turn			Motorist 07 - Making U-Turn 08 - Entering Traffic Lane 09 - Leaving Traffic Lane 10 - Parked 11 - Slowing or Stopped in Traffic 12 - Driverless		13 - Negotiating a Curve 14 - Other Motorist Action		Non-Motorist 15 - Entering or Crossing Specified Location 16 - Walking, Running, Jogging, Playing, Cycling 17 - Working 18 - Pushing Vehicle 19 - Approaching or Leaving Vehicle 20 - Standing			21 - Other Non-Motorist Action						
Contributing Circumstances Primary 01 01 - None 02 - Failure to Yield 03 - Ran Red Light 04 - Ran Stop Sign Secondary <input type="checkbox"/> 05 - Exceeded Speed Limit 06 - Unsafe Speed 07 - Improper Turn 08 - Left of Center 99 - Unknown 09 - Followed Too Closely/ACDA 10 - Improper Lane Change /Passing/Off Road			Motorist 11 - Improper Backing 12 - Improper Start From Parked Position 13 - Stopped or Parked Illegally 14 - Operating Vehicle in Negligent Manner 15 - Swerving to Avoid (Due to External Conditions) 16 - Wrong Side/Wrong Way 17 - Failure to Control 18 - Vision Obstruction 19 - Operating Defective Equipment 20 - Load Shifting/Falling/Spilling 21 - Other Improper Action		Non-Motorist 22 - None 23 - Improper Crossing 24 - Darting 25 - Lying and/or Illegally in Roadway 26 - Failure to Yield Right of Way 27 - Not Visible (Dark Clothing) 28 - Inattentive 29 - Failure to Obey Traffic Signs /Signals/Officer 30 - Wrong Side of the Road 31 - Other Non-Motorist Action			Vehicle Defects <input type="checkbox"/> 01 - Turn Signals 02 - Head Lamps 03 - Tail Lamps 04 - Brakes 05 - Steering 06 - Tire Blowout 07 - Worn or Slick tires 08 - Trailer Equipment Defective 09 - Motor Trouble 10 - Disabled From Prior Accident 11 - Other Defects								
Sequence of Events 1 20 2 <input type="checkbox"/> 3 <input type="checkbox"/> 4 <input type="checkbox"/> 5 <input type="checkbox"/> 6 <input type="checkbox"/> First Harmful Event 1 Most Harmful Event 1 99 - Unknown			Non-Collision Events 01 - Overturn/Rollover 02 - Fire/Explosion 03 - Immersion 04 - Jackknife 05 - Cargo/Equipment Loss or Shift			06 - Equipment Failure (Blown Tire, Brake Failure, etc) 07 - Separation of Units 08 - Ran Off Road Right 09 - Ran Off Road Left			10 - Cross Median 11 - Cross Center Line Opposite Direction of Travel 12 - Downhill Runaway 13 - Other Non-Collision							
Collision with Person, Vehicle or Object Not Fixed 14 - Pedestrian 15 - Pedalcycle 16 - Railway Vehicle (Train,Engine) 17 - Animal - Farm 18 - Animal - Deer 19 - Animal - Other 20 - Motor Vehicle in Transport			Collision With Fixed Object 21 - Parked Motor Vehicle 22 - Work Zone Maintenance Equipment 23 - Struck by Falling, Shifting Cargo or Anything Set in Motion by a Motor Vehicle 24 - Other Movable Object			25 - Impact Attenuator/Crash Cushion 26 - Bridge Overhead Structure 27 - Bridge Pier or Abutment 28 - Bridge Parapet 29 - Bridge Rail 30 - Guardrail Face 31 - Guardrail End 32 - Portable Barrier			33 - Median Cable Barrier 34 - Median Guardrail Barrier 35 - Median Concrete Barrier 36 - Median Other Barrier 37 - Traffic Sign Post 38 - Overhead Sign Post 39 - Light/Luminaries Support 40 - Utility Pole			41 - Other Post, Pole or Support 42 - Culvert 43 - Curb 44 - Ditch 45 - Embankment 46 - Fence 47 Mailbox			48 - Tree 49 - Fire Hydrant 50 - Work Zone Maintenance Equipment 51 - Wall, Building, Tunnel 52 - Other Fixed Object	
Unit Speed <input type="checkbox"/> Stated <input type="checkbox"/> Estimated		Posted Speed 25		Traffic Control 01 01 - No Controls 02 - Stop Sign 03 - Yield Sign 04 - Traffic Signal 05 - Traffic Flashers 06 - School Zone		07 - Railroad Crossbucks 08 - Railroad Flashers 09 - Railroad Gates 10 - Construction Barricade 11 - Person (Flagger, Officer) 12 - Pavement Markings		13 - Crosswalk Lines 14 - Walk/Don't Walk 15 - Other 16 - Not Reported		Unit Direction From 2 To 1 1 - North 2 - South 3 - East 4 - West			5 - Northeast 6 - Northwest 7 - Southeast 8 - Southwest 9 - Unknown			



Unit

Local Report Number *

2 0 1 8 3 9 7 8

Unit Number 02		Owner Name: Last, First, Middle (<input checked="" type="checkbox"/> Same As Driver) HILL ANTONIO		Owner Phone Number - inc. area code (<input type="checkbox"/> Same As Driver) 216-231-6557		Damage Scale 1		Damaged Area 			
Owner Address, City, State, Zip (<input type="checkbox"/> Same As Driver) 9525 SOPHIA AVE CLEVELAND OH 44104											
LP State OH		License Plate Number GML9703		Vehicle Identification Number WVWV D 6 3 B 4 2 E 3 9 5 8 2 0				# Occupants 01			
Vehicle Year 2002		Vehicle Make VOLK Volkswagen		Vehicle Model PAS Passat		Vehicle Color GRY Gray					
<input type="checkbox"/> Proof of Insurance Shown		Insurance Company GEICO INS.		Policy Number 4561-83-07-55		Towed By					
Carrier Name, Address, City, State, Zip								Carrier Phone - include area code			
US DOT		Vehicle Weight GVWR/GCWR <input type="checkbox"/> 1 - Less Than or Equal to 10k Lbs. <input type="checkbox"/> 2 - 10,001 to 26,000 Lbs. <input type="checkbox"/> 3 - More Than 26,000 Lbs.		Cargo Body Type 01 01 - No Cargo Body Type/Not Applicable 02 - Bus/Van(9-15 Seats, Inc.Driver) 03 - Bus(16+ Seats, Inc Driver) 04 - Vehicle Towing Another Vehicle 05 - Logging 06 - Intermodal Container Chassis 07 - Cargo Van/Enclosed Box 08 - Grain, Chips, Gravel		09 - Pole 10 - Cargo Tank 11 - Flat Bed 12 - Dump 13 - Concrete Mixer 14 - Auto Transporter 15 - Garbage/Refuse 99 - Other/Unknown		Trafficway Description 1 1 - Two-Way, Not Divided 2 - Two-Way, Not Divided, Continuous Left Turn Lane 3 - Two-Way, Divided, Unprotected (Painted or Grass>4 Ft.) Median 4 - Two-Way, Divided, Positive Median Barrier 5 - One-Way Trafficway <input checked="" type="checkbox"/> Hit / Skip Unit			
HM Placard ID No.		<input checked="" type="checkbox"/> Hazardous Material Released		HM Class Number		<input type="checkbox"/> Has HM Placard					
Non-Motorist Location Prior to Impact 01 - Intersection - Marked Crosswalk 02 - Intersection - No Crosswalk 03 - Intersection - Other 04 - Midblock - Marked Crosswalk 05 - Travel Lane - Other Location 06 - Bicycle Lane 07 - Shoulder/Roadside 08 - Sidewalk 09 - Median/Crossing Island 10 - Driveway Access 11 - Shared-Use Path or Trail 12 - Non-Trafficway Area 99 - Other/Unknown		Type of Use 1 1 - Personal 2 - Commercial 3 - Government <input type="checkbox"/> In Emergency Response		Unit Type 03 99 - Unknown or Hit/Skip		Passenger Vehicle (less than 9 passengers) 01 - Sub-Compact 02 - Compact 03 - Mid Size 04 - Full Size 05 - Minivan 06 - Sports Utility Vehicle 07 - Pickup 08 - Van 09 - Motorcycle 10 - Motorized Bicycle 11 - Snowmobile/ATV 12 - Other Passenger Vehicle		Med/Heavy Trucks or Combo Units>10k lbs 13 - Single Unit Truck or Van 2axle,6 tires 14 - Single Unit Truck 3+ axles 15 - Single Unit Truck/Trailer 16 - Truck/Tractor(Bobtail) 17 - Tractor/Semi-Trailer 18 - Tractor/Double 19 - Tractor/Triples 20 - Other Med/Heavy Vehicle		Bus/Van/Limo (9 or More Including Driver) 21 - Bus/Van (9-15 Seats, Inc Driver) 22 - BUS(16+ Seats, Inc Driver) Non-Motorist 23 - Animal with Rider 24 - Animal with Buggy, Wagon, Surrey 25 - Bicycle/Pedacyclist 26 - Pedestrian/Skater 27 - Other Non-Motorist	
Special Function 01 01 - None 02 - Taxi 03 - Rental Truck (Over 10K Lbs) 04 - Bus - School (Public or Private) 05 - Bus - Transit 06 - Bus - Charter 07 - Bus - Shuttle 08 - Bus - Other		09 - Ambulance 10 - Fire 11 - Highway/Maintenance 12 - Military 13 - Police 14 - Public Utility 15 - Other Government 16 - Construction Equip.		17 - Farm Vehicle 18 - Farm Equipment 19 - Motorhome 20 - Golf Cart 21 - Train 22 - Other (Explain in Narrative)		Most Damaged Area 05 01 - None 02 - Center Front 03 - Right Front 04 - Right Side 05 - Right Rear 06 - Rear Center 07 - Left Rear		08 - Left Side 09 - Left Front 10 - Top and Windows 11 - Undercarriage 12 - Load/Trailer 13 - Total (All Areas) 14 - Other		99 - Unknown Action 3 1 - Non-Contact 2 - Non-Collision 3 - Striking 4 - Struck 5 - Striking/Struck 9 - Unknown	
Pre-Crash Actions 02 01 - Straight Ahead 02 - Backing 03 - Changing Lanes 99 - Unknown 04 - Overtaking/Passing 05 - Making Right Turn 06 - Making Left Turn		Motorist 07 - Making U-Turn 08 - Entering Traffic Lane 09 - Leaving Traffic Lane 10 - Parked 11 - Slowing or Stopped in Traffic 12 - Driverless		13 - Negotiating a Curve 14 - Other Motorist Action		Non-Motorist 15 - Entering or Crossing Specified Location 16 - Walking, Running, Jogging, Playing, Cycling 17 - Working 18 - Pushing Vehicle 19 - Approaching or Leaving Vehicle 20 - Standing		21 - Other Non-Motorist Action			
Contributing Circumstances Primary 11 01 - None 02 - Failure to Yield 03 - Ran Red Light 04 - Ran Stop Sign Secondary 01 05 - Exceeded Speed Limit 06 - Unsafe Speed 07 - Improper Turn 08 - Left of Center 99 - Unknown 09 - Followed Too Closely/ACDA 10 - Improper Lane Change /Passing/Off Road		Motorist 11 - Improper Backing 12 - Improper Start From Parked Position 13 - Stopped or Parked Illegally 14 - Operating Vehicle in Negligent Manner 15 - Swerving to Avoid (Due to External Conditions) 16 - Wrong Side/Wrong Way 17 - Failure to Control 18 - Vision Obstruction 19 - Operating Defective Equipment 20 - Load Shifting/Falling/Spilling 21 - Other Improper Action		Non-Motorist 22 - None 23 - Improper Crossing 24 - Darting 25 - Lying and/or Illegally in Roadway 26 - Failure to Yield Right of Way 27 - Not Visible (Dark Clothing) 28 - Inattentive 29 - Failure to Obey Traffic Signs /Signals/Officer 30 - Wrong Side of the Road 31 - Other Non-Motorist Action		Vehicle Defects 01 01 - Turn Signals 02 - Head Lamps 03 - Tail Lamps 04 - Brakes 05 - Steering 06 - Tire Blowout 07 - Worn or Slick tires 08 - Trailer Equipment Defective 09 - Motor Trouble 10 - Disabled From Prior Accident 11 - Other Defects					
Sequence of Events 1 21 2 00 3 00 4 00 5 00 6 00 First Harmful Event 1 Most Harmful Event 1 99 - Unknown		Non-Collision Events 01 - Overturn/Rollover 02 - Fire/Explosion 03 - Immersion 04 - Jackknife 05 - Cargo/Equipment Loss or Shift		06 - Equipment Failure (Blown Tire, Brake Failure, etc) 07 - Separation of Units 08 - Ran Off Road Right 09 - Ran Off Road Left		10 - Cross Median 11 - Cross Center Line Opposite Direction of Travel 12 - Downhill Runaway 13 - Other Non-Collision					
Collision with Person, Vehicle or Object Not Fixed 14 - Pedestrian 15 - Pedalcycle 16 - Railway Vehicle (Train,Engine) 17 - Animal - Farm 18 - Animal - Deer 19 - Animal - Other 20 - Motor Vehicle in Transport		21 - Parked Motor Vehicle 22 - Work Zone Maintenance Equipment 23 - Struck by Falling, Shifting Cargo or Anything Set in Motion by a Motor Vehicle 24 - Other Movable Object		Collision With Fixed Object 25 - Impact Attenuator/Crash Cushion 26 - Bridge Overhead Structure 27 - Bridge Pier or Abutment 28 - Bridge Parapet 29 - Bridge Rail 30 - Guardrail Face 31 - Guardrail End 32 - Portable Barrier		33 - Median Cable Barrier 34 - Median Guardrail Barrier 35 - Median Concrete Barrier 36 - Median Other Barrier 37 - Traffic Sign Post 38 - Overhead Sign Post 39 - Light/Luminaries Support 40 - Utility Pole		41 - Other Post, Pole or Support 42 - Culvert 43 - Curb 44 - Ditch 45 - Embankment 46 - Fence 47 Mailbox		48 - Tree 49 - Fire Hydrant 50 - Work Zone Maintenance Equipment 51 - Wall, Building, Tunnel 52 - Other Fixed Object	
Unit Speed 5		Posted Speed 25		Traffic Control 01 01 - No Controls 02 - Stop Sign 03 - Yield Sign 04 - Traffic Signal 05 - Traffic Flashers 06 - School Zone		07 - Railroad Crossbucks 08 - Railroad Flashers 09 - Railroad Gates 10 - Construction Barricade 11 - Person (Flagger, Officer) 12 - Pavement Markings		13 - Crosswalk Lines 14 - Walk/Don't Walk 15 - Other 16 - Not Reported		Unit Direction From 4 To 3 1 - North 2 - South 3 - East 4 - West 5 - Northeast 6 - Northwest 7 - Southeast 8 - Southwest 9 - Unknown	



Motorist / Non-Motorist / Occupant

Local Report Number *

2 | 0 | 1 | 8 | 3 | 9 | 7 | 8 | | | | | | | |

Motorist/Non-Motorist

Motorist/Non-Motorist

Occupant

Occupant

Unit Number 0 2	Name: Last, First, Middle HILL ANTONIO	Date of Birth 0 7 0 9 1 9 5 7	Age 61	Gender M F - Female M - Male
----------------------	---	--	-----------	------------------------------------

Address, City, State, Zip 9525 SOPHIA AVE CLEVELAND OH 44104	Contact Phone - include area code 216-231-6557
---	---

Injuries 1	Injured Taken By	EMS Agency	Medical Facility Injured Taken To	Safety Equipment Used 0 4	DOT Compliant Motorcycle Helmet	Seating Position 0 1	Air Bag Usage 1	Ejection 1	Trapped 1
---------------	------------------	------------	-----------------------------------	--------------------------------	---------------------------------	---------------------------	--------------------	---------------	--------------

OL State OH	Operator License Number RP932680	OL Class 4	No Valid OL	M/C End	Condition 1	Alcohol/Drug Suspected 1	Alcohol Test Status 1	Alcohol Test Type 1	Alcohol Test Value	Drug Test Status 1	Drug Test Type 1
----------------	-------------------------------------	---------------	-------------	---------	----------------	-----------------------------	--------------------------	------------------------	--------------------	-----------------------	---------------------

Offense Charged (Local Code)	Offense Description	Citation Number	Hands-Free Device Used	Driver Distracted By 1
------------------------------	---------------------	-----------------	------------------------	---------------------------

Unit Number	Name: Last, First, Middle	Date of Birth	Age	Gender F - Female M - Male
-------------	---------------------------	---------------	-----	----------------------------------

Address, City, State, Zip	Contact Phone - include area code
---------------------------	-----------------------------------

Injuries	Injured Taken By	EMS Agency	Medical Facility Injured Taken To	Safety Equipment Used	DOT Compliant Motorcycle Helmet	Seating Position	Air Bag Usage	Ejection	Trapped
----------	------------------	------------	-----------------------------------	-----------------------	---------------------------------	------------------	---------------	----------	---------

OL State	Operator License Number	OL Class	No Valid OL	M/C End	Condition	Alcohol/Drug Suspected	Alcohol Test Status	Alcohol Test Type	Alcohol Test Value	Drug Test Status	Drug Test Type
----------	-------------------------	----------	-------------	---------	-----------	------------------------	---------------------	-------------------	--------------------	------------------	----------------

Offense Charged (Local Code)	Offense Description	Citation Number	Hands-Free Device Used	Driver Distracted By
------------------------------	---------------------	-----------------	------------------------	----------------------

Injuries 1 - No Injury/None Reported 2 - Possible 3 - Non-Incapacitating 4 - Incapacitating 5 - Fatal	Injured Taken By 1 - Not Transported / Treated at Scene 2 - EMS 3 - Police 4 - Other 9 - Unknown	Safety Equipment Used Motorist 01 - None Used - Vehicle Occupant 02 - Shoulder Belt Only Used 03 - Lap Belt Only Used 04 - Shoulder Belt and Lap Belt Used Non-Motorist 05 - Child Restraint System-Forward Facing 06 - Child Restraint System-Rear Facing 07 - Booster Seat 08 - Helmet Used 99 - Unknown Safety Equipment	Non-Motorist 09 - None Used 10 - Helmet Used 11 - Protective Pads Used (Elbows, Knees, Etc) 12 - Reflective Clothing 13 - Lighting 14 - Other
---	--	--	--

Seating Position 01 - Front - Left Side (Motorcycle Driver) 02 - Front - Middle 03 - Front - Right Side 04 - Second - Left Side (Motorcycle Passenger) 05 - Second - Middle 06 - Second - Right Side 07 - Third - Left Side (Motorcycle Side Car) 08 - Third - Middle 09 - Third - Right Side 10 - Sleeper Section of Cab (Truck) 11 - Passenger in Other Enclosed Cargo Area (Non-Trailing Unit Such as a Bus, Pick-up with Cab) 12 - Passenger in Unenclosed Cargo Area 13 - Trailing Unit 14 - Riding on Vehicle Exterior (Non-Trailing Unit) 15 - Non-Motorist 16 - Other 99 - Unknown	Air Bag Usage 1 - Not Deployed 2 - Deployed Front 3 - Deployed Side 4 - Deployed Both Front/Side 5 - Not Applicable 9 - Deployment Unknown
--	---

Ejection 1 - Not Ejected 2 - Totally Ejected 3 - Partially Ejected 4 - Not Applicable	Trapped 1 - Not Trapped 2 - Extricated by Mechanical Means 3 - Extricated by Non-Mechanical Means	Operator License Class 1 - Class A 2 - Class B 3 - Class C 4 - Regular Class (Ohio is "D") 5 - MC/Moped <u>Only</u>	Condition 1 - Apparently Normal 2 - Physical Impairment 3 - Emotional (Depressed, Angry, Disturbed) 4 - Illness 5 - Fell Asleep, Fainted, Fatigued 6 - Under The Influence of Medications, Drugs, Alcohol 7 - Other	Alcohol/Drug Suspected 1 - None 2 - Yes - Alcohol Suspected 3 - Yes - HBD Not Impaired 4 - Yes - Drugs Suspected 5 - Yes - Alcohol and Drugs Suspected
--	---	---	---	--

Alcohol Test Status 1 - None Given 2 - Test Refused 3 - Test Given, Contaminated Sample/Unusable 4 - Test Given, Results Known 5 - Test Given, Results Unknown	Alcohol Test Type 1 - None 2 - Blood 3 - Urine 4 - Breath 5 - Other	Drug Test Status 1 - None Given 2 - Test Refused 3 - Test Given, Contaminated Sample/Unusable 4 - Test Given, Results Known 5 - Test Given, Results Unknown	Drug Test Type 1 - None 2 - Blood 3 - Urine 4 - Other	Driver Distracted By 1 - No Distraction Reported 2 - Phone 3 - Texting/E-mailing 4 - Electronic Communication Device 5 - Other Electronic Device (Navigation Device, Radio, DVD) 6 - Other Inside the Vehicle 7 - External Distraction
--	---	---	--	--

Unit Number	Name: Last, First, Middle	Date of Birth	Age	Gender F - Female M - Male
-------------	---------------------------	---------------	-----	----------------------------------

Address, City, State, Zip	Contact Phone - include area code
---------------------------	-----------------------------------

Injuries	Injured Taken By	EMS Agency	Medical Facility Injured Taken To	Safety Equipment Used	DOT Compliant Motorcycle Helmet	Seating Position	Air Bag Usage	Ejection	Trapped
----------	------------------	------------	-----------------------------------	-----------------------	---------------------------------	------------------	---------------	----------	---------

Unit Number	Name: Last, First, Middle	Date of Birth	Age	Gender F - Female M - Male
-------------	---------------------------	---------------	-----	----------------------------------

Address, City, State, Zip	Contact Phone - include area code
---------------------------	-----------------------------------

Injuries	Injured Taken By	EMS Agency	Medical Facility Injured Taken To	Safety Equipment Used	DOT Compliant Motorcycle Helmet	Seating Position	Air Bag Usage	Ejection	Trapped
----------	------------------	------------	-----------------------------------	-----------------------	---------------------------------	------------------	---------------	----------	---------