

TRAFFIC CRASH REPORT

*DENOTES MANDATORY FIELD FOR SUPPLEMENT REPORT

LOCAL REPORT NUMBER *

2 | 0 | 1 | 9 | 2 | 7 | 5 | 2

PHOTOS TAKEN OH-2 OH-3
 SECONDARY CRASH OH-1P OTHER
 Private Property

LOCAL INFORMATION
 REPORTING AGENCY NAME *
GARFIELD HEIGHTS NCIC *
 0 | 1 | 8 | 2 | 0

HIT/SKIP
 1 - Solved NUMBER OF UNITS
 2 - Unsolved 0 | 2 UNIT IN ERROR
 98 - ANIMAL 0 | 2 99 - UNKNOWN

COUNTY *
 1 | 8 LOCALITY *
 1 1 - CITY *
 2 - VILLAGE *
 3 - TOWNSHIP *

LOCATION: CITY, VILLAGE, TOWNSHIP *
GARFIELD HTS

CRASH DATE/TIME *
 0 | 8 | 0 | 7 | 2 | 0 | 1 | 9 | 1 | 7 | 3 | 0

CRASH SEVERITY
 5 1 - FATAL
 2 - SERIOUS INJURY SUSPECTED
 3 - MINOR INJURY SUSPECTED
 4 - INJURY POSSIBLE
 5 - PROPERTY DAMAGE ONLY

ROUTE TYPE ROUTE NUMBER PREFIX
 1 - NORTH
 2 - SOUTH
 3 - EAST
 4 - WEST

LOCATION ROAD NAME
131ST
 ROAD TYPE
S | T

LATITUDE DECIMAL DEGREES
 4 | 1 | . | 4 | 3 | 6 | 7 | 0 | 1

ROUTE TYPE ROUTE NUMBER PREFIX
 1 - NORTH
 2 - SOUTH
 3 - EAST
 4 - WEST

REFERENCE ROAD NAME (ROAD, MILEPOST, HOUSE #)
4515
 ROAD TYPE

LONGITUDE DECIMAL DEGREES
 8 | 1 | . | 5 | 9 | 0 | 5 | 8 | 2

REFERENCE POINT
 1 - INTERSECTION
 2 - MILE POST
 3 - HOUSE #
3

DIRECTION
 1 - NORTH
 2 - SOUTH
 3 - EAST
 4 - WEST

INTERSECTION RELATED
 WITHIN INTERSECTION OR ON APPROACH
 WITHIN INTERCHANGE AREA NUMBER OF APPROACHES
 ROADWAY
 ROADWAY DIVIDED

LOCATION OF FIRST HARMFUL EVENT
 0 | 1 1 - ON ROADWAY
 2 - ON SHOULDER
 3 - IN MEDIAN
 4 - ON ROADSIDE
 5 - ON GORE
 6 - OUTSIDE TRAFFICWAY
 7 - ON RAMP
 8 - OFF RAMP

MANNER OF CRASH COLLISION/IMPACT
7 1 - NOT COLLISION BETWEEN TWO MOTOR VEHICLES IN TRANSPORT
 2 - REAR-END
 3 - HEAD-ON
 4 - REAR-TO-REAR
 5 - BACKING
 6 - ANGLE
 7 - SIDESWIPE, SAME DIRECTION
 8 - SIDESWIPE, OPPOSITE DIRECTION
 9 - OTHER / UNKNOWN

DIRECTION OF TRAVEL
 1 - NORTH
 2 - SOUTH
 3 - EAST
 4 - WEST

MEDIAN TYPE
 1 - DIVIDED FLUSH MEDIAN (<4 FEET)
 2 - DIVIDED FLUSH MEDIAN (≥4 FEET)
 3 - DIVIDED, DEPRESSIONED MEDIAN (ANY TYPE)
 4 - DIVIDED, RAISED MEDIAN (ANY TYPE)
 9 - OTHER / UNKNOWN

WORK ZONE RELATED
 WORKERS PRESENT
 LAW ENFORCEMENT PRESENT
 ACTIVE SCHOOL ZONE

WORK ZONE TYPE
 1 - LANE CLOSURE
 2 - LANE SHIFT/CROSSOVER
 3 - WORK ON SHOULDER OR MEDIAN
 4 - INTERMITTENT OR MOVING WORK
 5 - OTHER

LOCATION OF CRASH IN WORK ZONE
 1 - BEFORE THE 1ST WORK ZONE WARNING SIGN
 2 - ADVANCE WARNING AREA
 3 - TRANSITION AREA
 4 - ACTIVITY AREA
 5 - TERMINATION AREA

CONTOUR
1
 1 - STRAIGHT LEVEL
 2 - STRAIGHT GRADE
 3 - CURVE LEVEL
 4 - CURVE GRADE
 9 - OTHER / UNKNOWN

CONDITIONS
1
 1 - DRY
 2 - WET
 3 - SNOW
 4 - ICE
 5 - SAND, MUD, DIRT, OIL, GRAVEL
 6 - WATER (STANDING, MOVING)
 7 - SLUSH
 9 - OTHER/UNKNOWN

SURFACE
2
 1 - CONCRETE
 2 - BLACKTOP, BITUMINOUS, ASPHALT
 3 - BRICK/BLOCK
 4 - SLAG, GRAVEL, STONE
 5 - DIRT
 9 - OTHER / UNKNOWN

LIGHT CONDITION
1
 1 - DAYLIGHT
 2 - DAWN/DUSK
 3 - DARK - LIGHTED ROADWAY
 4 - DARK - ROADWAY NOT LIGHTED
 5 - DARK - UNKNOWN ROADWAY LIGHTING
 9 - OTHER / UNKNOWN

WEATHER
1
 1 - CLEAR
 2 - CLOUDY
 3 - FOG, SMOG, SMOKE
 4 - RAIN
 5 - SLEET, HAIL
 6 - SNOW
 7 - SEVERE CROSSWINDS
 8 - BLOWING SAND, SOIL, DIRT, SNOW
 9 - FREEZING RAIN OR FREEZING DRIZZLE
 99 - OTHER / UNKNOWN

INDICATE THE NORTH DIRECTION WITH AN "N" ON THE COMPASS DIAGRAM.

NARRATIVE
 UNIT #1 WAS STOPPED IN FRONT OF 4515 E. 131ST.
 UNIT #2 WAS TRAVELING NORTH ON E. 131ST, WHEN
 UNIT #2 STRUCK UNIT #1.

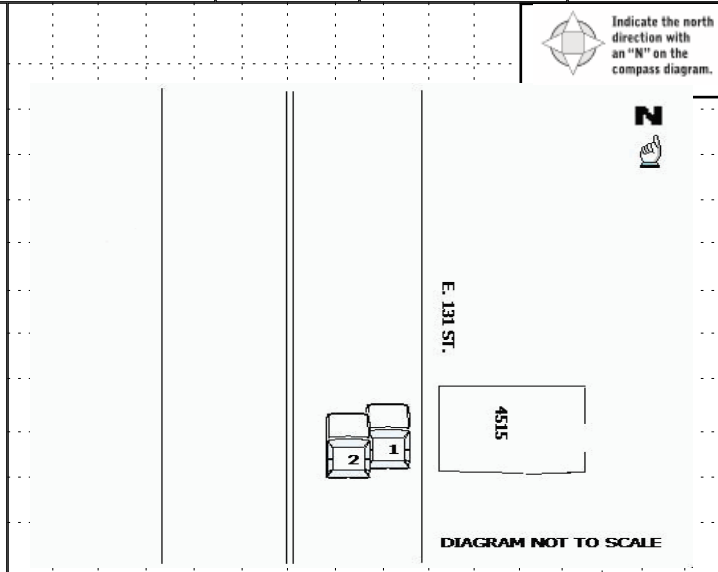

CRASH REPORTED DATE/TIME
 0 | 8 | 0 | 7 | 2 | 0 | 1 | 9 | 1 | 7 | 3 | 0

DISPATCH DATE/TIME
 0 | 8 | 0 | 7 | 2 | 0 | 1 | 9 | 1 | 7 | 3 | 1

ARRIVAL DATE/TIME
 0 | 8 | 0 | 7 | 2 | 0 | 1 | 9 | 1 | 7 | 3 | 3

SCENE CLEARED DATE/TIME
 0 | 8 | 0 | 7 | 2 | 0 | 1 | 9 | 1 | 7 | 5 | 5

REPORT TAKEN BY
 POLICE AGENCY
 MOTORIST

TOTAL TIME ROADWAY CLOSED
 0

OTHER INVESTIGATION TIME
 2 | 0

TOTAL MINUTES
 4 | 2

OFFICER'S NAME *
E. Cornell
 OFFICER'S BADGE NUMBER *
 0 | 2 | 4

CHECKED BY OFFICER'S NAME *
M. Kaye
 CHECKED BY OFFICER'S BADGE NUMBER *
 L | 1 | 0

SUPPLEMENT
 (CORRECTION IN ADDITION TO ORIGINAL REPORT)

2 0 1 9 2 7 5 2

UNIT # 0 1 **OWNER NAME: LAST, FIRST, MIDDLE** CAMPBELL VICKIE R (Same As Driver) **OWNER PHONE: INCLUDE AREA CODE** 2 1 6 5 1 3 3 1 5 1 (Same As Driver)

OWNER ADDRESS: STREET, CITY, STATE, ZIP 13217 COATH AVE CLEVELAND OH 44120 4623 (Same As Driver)

COMMERCIAL CARRIER: NAME, ADDRESS, CITY, STATE, ZIP **COMMERCIAL CARRIER PHONE: INCLUDE AREA CODE**

DAMAGE

DAMAGE SCALE

2 1 - NONE
2 - MINOR DAMAGE
3 - FUNCTIONAL DAMAGE
4 - DISABLING DAMAGE
9 - UNKNOWN

LP STATE OH **LICENSE PLATE #** J422768 **VEHICLE IDENTIFICATION #** 1GYFK61380181R164021 **VEHICLE YEAR** 2008 **VEHICLE MAKE** Cadillac

INSURANCE VERIFIED **INSURANCE COMPANY** AMERICAN SELECT **INSURANCE POLICY #** WNP002351V **VEHICLE COLOR** TAN **VEHICLE MODEL** Escalade

TYPE OF USE COMMERCIAL GOVERNMENT IN EMERGENCY RESPONSE **US DOT #** **TOWED BY: COMPANY NAME**

INTERLOCK DEVICE EQUIPPED HIT/SKIP UNIT **# OCCUPANTS** 0 1 **VEHICLE WEIGHT GVWR/GCWR** 1 - ≤10K LBS. 2 - 10,001 - 26K LBS. 3 - >26K LBS. **HAZARDOUS MATERIAL** MATERIAL RELEASED PLACARD **CLASS #** **PLACARD ID #**

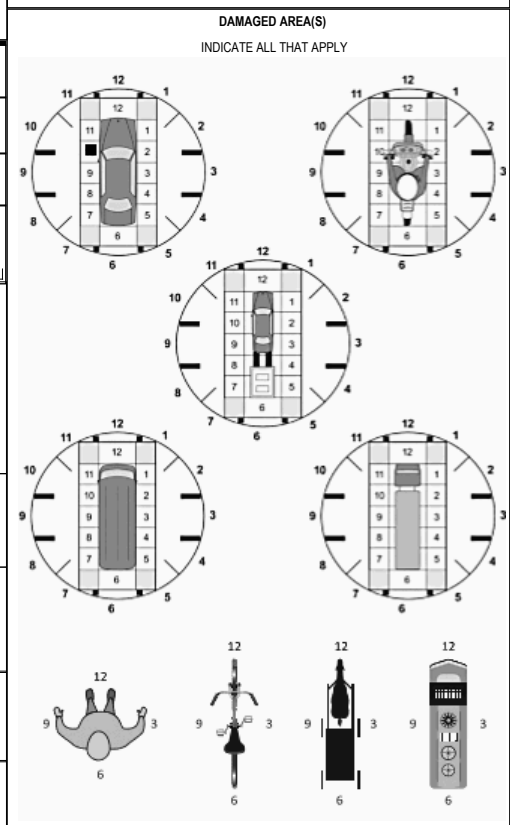

UNIT TYPE 0 3

1 - PASSENGER CAR 7 - MOTORCYCLE 2-WHEELED 12 - GOLF CART 18 - LIMO (LIVERY VEHICLE) 23 - PEDESTRIAN/SKATER
2 - PASSENGER VAN (MINIVAN) 8 - MOTORCYCLE 3-WHEELED 13 - SNOWMOBILE 19 - BUS (16+ PASSENGERS) 24 - WHEELCHAIR (ANY TYPE)
3 - SPORT UTILITY VEHICLE 9 - AUTOCYCLE 14 - SINGLE UNIT TRUCK 20 - OTHER VEHICLE 25 - OTHER NON-MOTORIST
4 - PICK UP 10 - MOPED OR MOTORIZED BICYCLE 15 - SEMI-TRACTOR 21 - HEAVY EQUIPMENT 26 - BICYCLE
5 - CARGO VAN 11 - ALL TERRAIN VEHICLE (ATV / UTV) 16 - FARM EQUIPMENT 22 - ANIMAL WITH RIDER OR ANIMAL-DRAWN VEHICLE 27 - TRAIN
6 - VAN (9-15 SEATS) 17 - MOTORHOME

of TRAILING UNITS

WAS VEHICLE OPERATING IN AUTONOMOUS MODE WHEN CRASH OCCURRED? 2 1 - YES 2 - NO 9 - OTHER / UNKNOWN **AUTONOMOUS MODE LEVEL** 0 0 - NO AUTOMATION 1 - DRIVER ASSISTANCE 2 - PARTIAL AUTOMATION 3 - CONDITIONAL AUTOMATION 4 - HIGH AUTOMATION 5 - FULL AUTOMATION 9 - UNKNOWN

SPECIAL FUNCTION 0 1

1 - NONE 6 - BUS - CHARTER/TOUR 11 - FIRE 16 - FARM 21 - MAIL CARRIER
2 - TAXI 7 - BUS - INTERCITY 12 - MILITARY 17 - MOWING 22 - OTHER / UNKNOWN
3 - ELECTRONIC RIDE SHARING 8 - BUS - SHUTTLE 13 - POLICE 18 - SNOW REMOVAL
4 - SCHOOL TRANSPORT 9 - BUS - OTHER 14 - PUBLIC UTILITY 19 - TOWING
5 - BUS-TRANSIT/COMMUTER 10 - AMBULANCE 15 - CONSTRUCTION EQUIPMENT 20 - SAFETY SERVICE PATROL

CARGO BODY TYPE 0 1

1 - NO CARGO BODY TYPE / NOT APPLICABLE 3 - VEHICLE TOWING ANOTHER MOTOR VEHICLE 5 - INTERMODAL CONTAINER CHASSIS 8 - POLE 12 - CONCRETE MIXER
2 - BUS 4 - LOGGING 6 - CARGO VAN/ENCLOSED BOX 9 - CARGO TANK 13 - AUTO TRANSPORTER
7 - GRAIN/CHIPS/GRAVEL 11 - DUMP 14 - GARBAGE/REFUSE 19 - TOWING 99 - OTHER / UNKNOWN

VEHICLE DEFECTS

1 - TURN SIGNALS 4 - BRAKES 7 - WORN OR SLICK TIRES 9 - MOTOR TROUBLE 99 - OTHER / UNKNOWN
2 - HEAD LAMPS 5 - STEERING 8 - TRAILER EQUIPMENT DEFECTIVE 10 - DISABLED FROM PRIOR ACCIDENT
3 - TAIL LAMPS 6 - TIRE BLOWOUT

NON-MOTORIST LOCATION AT IMPACT

1 - INTERSECTION - MARKED CROSSWALK 3 - INTERSECTION - OTHER 6 - BICYCLE LANE 9 - MEDIAN/CROSSING ISLAND 12 - FIRST RESPONDER OR LEAVING VEHICLE AT INCIDENT SCENE
2 - INTERSECTION - UNMARKED 4 - MIDLICK - MARKED CROSSWALK 7 - SHOULDER/ROADSIDE 10 - DRIVEWAY ACCESS 14 - GARBAGE/REFUSE 19 - OTHER / UNKNOWN
5 - TRAVEL LANE-OTHER LOCATION 8 - SIDEWALK 11 - SHARED USE PATHS OR TRAILS 99 - OTHER / UNKNOWN

ACTION 4 **PRE-CRASH ACTION** 1 1

1 - NON-CONTACT 1 - STRAIGHT AHEAD 7 - MAKING U-TURN 13 - NEGOTIATING A CURVE 18 - APPROACHING OR LEAVING VEHICLE OR LEAVING VEHICLE AT INCIDENT SCENE
2 - NON-COLLISION 2 - BACKING 8 - ENTERING TRAFFIC LANE 14 - ENTERING OR CROSSING SPECIFIED LOCATION 19 - STANDING
3 - STRIKING 3 - CHANGING LANES 9 - LEAVING TRAFFIC LANE 15 - WALKING, RUNNING, JOGGING, PLAYING 20 - OTHER NON-MOTORIST
4 - STRUCK 4 - OVERTAKING/PASSING 10 - PARKED 16 - WORKING 21 - STANDING OUTSIDE DISABLED VEHICLE
5 - BOTH STRIKING & STRUCK 5 - MAKING RIGHT TURN 11 - SLOWING OR STOPPED IN TRAFFIC 17 - PUSHING VEHICLE 99 - OTHER / UNKNOWN
9 - OTHER / UNKNOWN 6 - MAKING LEFT TURN 12 - DRIVERLESS

INITIAL POINT OF CONTACT

1 0 0 - NO DAMAGE 14 - UNDERCARRIAGE
1-12 - REFER TO UNIT DIAGRAM 15 - VEHICLE NOT AT SCENE 99 - UNKNOWN

CONTRIBUTING CIRCUMSTANCES 0 1

1 - NONE 7 - LEFT OF CENTER 13 - IMPROPER START FROM A PARKED POSITION 17 - VISION OBSTRUCTION 21 - LYING IN ROADWAY
2 - FAILURE TO YIELD 8 - FOLLOWING TOO CLOSE/ACDA 14 - STOPPED OR PARKED ILLEGALLY 18 - OPERATING DEFECTIVE EQUIPMENT 22 - NOT DISCERNABLE
3 - RAN RED LIGHT 9 - IMPROPER LANE CHANGING 15 - SWERVING TO AVOID 19 - LOAD SHIFTING/ FALLING/SPILLING 23 - OPENING DOOR INTO ROADWAY
4 - RAN STOP SIGN 10 - IMPROPER PASSING 16 - WRONG WAY 20 - IMPROPER CROSSING 99 - OTHER IMPROPER ACTION
5 - UNSAFE SPEED 11 - DROVE OFF ROAD
6 - IMPROPER TURN 12 - IMPROPER BACKING

TRAFFIC

TRAFFICWAY FLOW 2 1 - ONE-WAY 2 - TWO-WAY

TRAFFIC CONTROL 6 1 - ROUNDABOUT 4 - STOP SIGN 2 - SIGNAL 5 - YIELD SIGN 3 - FLASHER 6 - NO CONTROL

SEQUENCE OF EVENTS

EVENTS

1 2 0 1 - OVERTURN/ROLLOVER 6 - EQUIPMENT FAILURE 11 - CROSS CENTERLINE - OPPOSITE DIRECTION OF TRAVEL 16 - RAILWAY VEHICLE 22 - WORK ZONE MAINTENANCE EQUIPMENT
2 - FIRE/EXPLOSION 7 - SEPARATION OF UNITS 17 - ANIMAL - FARM 18 - ANIMAL - DEER 23 - STRUCK BY FALLING, SHIFTING CARGO OR ANYTHING SET IN MOTION BY A MOTOR VEHICLE
3 - IMMERSION 8 - RAN OFF ROAD RIGHT 12 - DOWNHILL RUNAWAY 19 - ANIMAL - OTHER 24 - OTHER MOVABLE
4 - JACKKNIFE 9 - RAN OFF ROAD LEFT 13 - OTHER NON-COLLISION 20 - MOTOR VEHICLE IN TRANSPORT
5 - CARGO / EQUIPMENT LOSS OR SHIFT 10 - CROSS MEDIAN 14 - PEDESTRIAN 21 - PARKED MOTOR VEHICLE

OF THROUGH LANES ON ROAD 2

RAIL GRADE CROSSING 1 1 - NOT INVOLVED 2 - INVOLVED - ACTIVE CROSSING 3 - INVOLVED - PASSIVE CROSSING

COLLISION WITH FIXED OBJECT - STRUCK

25 - IMPACT ATTENUATOR / CRASH CUSHION 31 - GUARDRAIL END 37 - TRAFFIC SIGN POST 43 - CURB 50 - WORKZONE MAINTENANCE EQUIPMENT
26 - BRIDGE OVERHEAD STRUCTURE 32 - PORTABLE BARRIER 38 - OVERHEAD SIGN POST 44 - DITCH 51 - WALL
27 - BRIDGE PIER OR ABUTMENT 33 - MEDIAN CABLE BARRIER 39 - LIGHT/LUMINARIES SUPPORT 45 - EMBANKMENT 52 - BUILDING
28 - BRIDGE PARAPET 34 - MEDIAN GUARDRAIL BARRIER 40 - UTILITY POLE 46 - FENCE 53 - TUNNEL
29 - BRIDGE RAIL 35 - MEDIAN CONCRETE BARRIER 41 - OTHER POST, POLE OR SUPPORT 47 - MAILBOX 54 - OTHER FIXED OBJECT
30 - GUARDRAIL FACE 36 - MEDIAN OTHER BARRIER 42 - CULVERT 48 - TREE 55 - OTHER / UNKNOWN 99 - OTHER / UNKNOWN

UNIT / NON-MOTORIST DIRECTION

FROM 2 TO 1 1 - NORTH 5 - NORTHEAST 2 - SOUTH 6 - NORTHWEST 3 - EAST 7 - SOUTHEAST 4 - WEST 8 - SOUTHWEST

UNIT SPEED 0 **DETECTED SPEED** 1 1 - STATED/ESTIMATED SPEED 2 - CALCULATED / EDR 3 - UNDETERMINED

POSTED SPEED 2 5

2 0 1 9 2 7 5 2

UNIT # 0 2	OWNER NAME: LAST, FIRST, MIDDLE BROWN DANNIE (Same As Driver)	OWNER PHONE: INCLUDE AREA CODE 2 1 6 2 2 5 5 9 0 4 (Same As Driver)
OWNER ADDRESS: STREET, CITY, STATE, ZIP 20740 APPLGATE RD MAPLE HTS OH 44137 (Same As Driver)		
COMMERCIAL CARRIER: NAME, ADDRESS, CITY, STATE, ZIP		COMMERCIAL CARRIER PHONE: INCLUDE AREA CODE

DAMAGE

DAMAGE SCALE

2 1 - NONE
2 - MINOR DAMAGE
3 - FUNCTIONAL DAMAGE
4 - DISABLING DAMAGE
9 - UNKNOWN

LP STATE OH	LICENSE PLATE # HEV8422	VEHICLE IDENTIFICATION # 1 F T F W 1 E F 0 1 E K G 3 3 6 8 5	VEHICLE YEAR 2 0 1 4	VEHICLE MAKE Ford
INSURANCE VERIFIED	INSURANCE COMPANY STATE FARM	INSURANCE POLICY # 9473043-E20-35	VEHICLE COLOR DBL	VEHICLE MODEL F-150
<input type="checkbox"/> COMMERCIAL	<input type="checkbox"/> GOVERNMENT	<input type="checkbox"/> IN EMERGENCY RESPONSE	US DOT #	
<input type="checkbox"/> INTERLOCK DEVICE EQUIPPED	<input type="checkbox"/> HIT/SKIP UNIT	# OCCUPANTS 0 1	VEHICLE WEIGHT GVWR/GCWR 1 - ≤10K LBS. 2 - 10,001 - 26K LBS. 3 - >26K LBS.	
TYPE OF USE		TOWED BY: COMPANY NAME		
<input type="checkbox"/> HAZARDOUS MATERIAL		HAZARDOUS MATERIAL <input type="checkbox"/> MATERIAL RELEASED CLASS # PLACARD ID # <input type="checkbox"/> PLACARD		

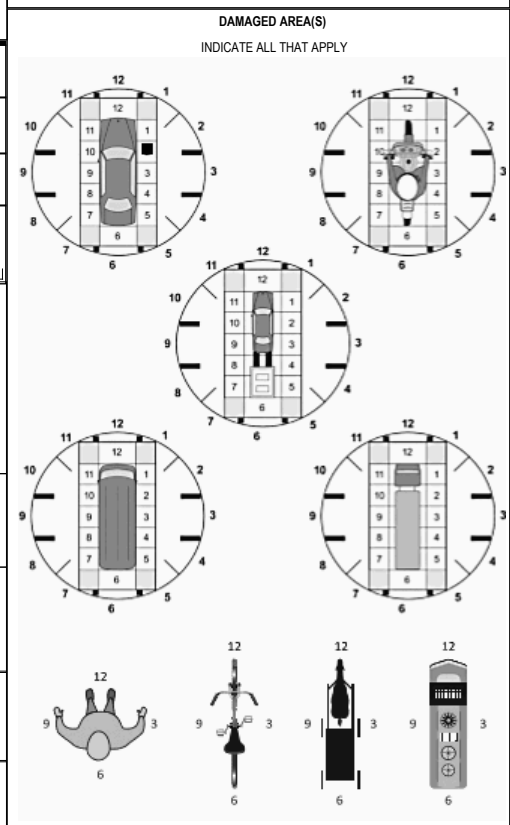

UNIT TYPE
0 4

1 - PASSENGER CAR	7 - MOTORCYCLE 2-WHEELED	12 - GOLF CART	18 - LIMO (LIVERY VEHICLE)	23 - PEDESTRIAN/SKATER
2 - PASSENGER VAN (MINIVAN)	8 - MOTORCYCLE 3-WHEELED	13 - SNOWMOBILE	19 - BUS (16+ PASSENGERS)	24 - WHEELCHAIR (ANY TYPE)
3 - SPORT UTILITY VEHICLE	9 - AUTOCYCLE	14 - SINGLE UNIT TRUCK	20 - OTHER VEHICLE	25 - OTHER NON-MOTORIST
4 - PICK UP	10 - MOPED OR MOTORIZED BICYCLE	15 - SEMI-TRACTOR	21 - HEAVY EQUIPMENT	26 - BICYCLE
5 - CARGO VAN	11 - ALL TERRAIN VEHICLE (ATV / UTV)	16 - FARM EQUIPMENT	22 - ANIMAL WITH RIDER OR ANIMAL-DRAWN VEHICLE	27 - TRAIN
6 - VAN (9-15 SEATS)		17 - MOTORHOME		99 - UNKNOWN OR HIT/SKIP

of TRAILING UNITS

WAS VEHICLE OPERATING IN AUTONOMOUS MODE WHEN CRASH OCCURRED?
2 1 - YES 2 - NO 9 - OTHER / UNKNOWN

AUTONOMOUS MODE LEVEL
0 0 - NO AUTOMATION
1 - DRIVER ASSISTANCE
2 - PARTIAL AUTOMATION
3 - CONDITIONAL AUTOMATION
4 - HIGH AUTOMATION
5 - FULL AUTOMATION
9 - UNKNOWN

SPECIAL FUNCTION
0 1

1 - NONE	6 - BUS - CHARTER/TOUR	11 - FIRE	16 - FARM	21 - MAIL CARRIER
2 - TAXI	7 - BUS - INTERCITY	12 - MILITARY	17 - MOWING	99 - OTHER / UNKNOWN
3 - ELECTRONIC RIDE SHARING	8 - BUS - SHUTTLE	13 - POLICE	18 - SNOW REMOVAL	
4 - SCHOOL TRANSPORT	9 - BUS - OTHER	14 - PUBLIC UTILITY	19 - TOWING	
5 - BUS-TRANSIT/COMMUTER	10 - AMBULANCE	15 - CONSTRUCTION EQUIPMENT	20 - SAFETY SERVICE PATROL	

CARGO BODY TYPE
0 1

1 - NO CARGO BODY TYPE / NOT APPLICABLE	3 - VEHICLE TOWING ANOTHER MOTOR VEHICLE	5 - INTERMODAL CONTAINER CHASSIS	8 - POLE	12 - CONCRETE MIXER
2 - BUS	4 - LOGGING	6 - CARGO VAN/ENCLOSED BOX	9 - CARGO TANK	13 - AUTO TRANSPORTER
		7 - GRAIN/CHIPS/GRAVEL	10 - FLAT BED	14 - GARBAGE/REFUSE
			11 - DUMP	99 - OTHER / UNKNOWN

VEHICLE DEFECTS

1 - TURN SIGNALS	4 - BRAKES	7 - WORN OR SLICK TIRES	9 - MOTOR TROUBLE	99 - OTHER / UNKNOWN
2 - HEAD LAMPS	5 - STEERING	8 - TRAILER EQUIPMENT DEFECTIVE	10 - DISABLED FROM PRIOR ACCIDENT	
3 - TAIL LAMPS	6 - TIRE BLOWOUT			

NON-MOTORIST LOCATION AT IMPACT

1 - INTERSECTION - MARKED CROSSWALK	3 - INTERSECTION - OTHER	6 - BICYCLE LANE	9 - MEDIAN/CROSSING ISLAND	12 - FIRST RESPONDER AT INCIDENT SCENE
2 - INTERSECTION - UNMARKED	4 - MIDLICK - MARKED CROSSWALK	7 - SHOULDER/ROADSIDE	10 - DRIVEWAY ACCESS	99 - OTHER / UNKNOWN
	5 - TRAVEL LANE-OTHER LOCATION	8 - SIDEWALK	11 - SHARED USE PATHS OR TRAILS	

ACTION
0 1

1 - NON-CONTACT	1 - STRAIGHT AHEAD	7 - MAKING U-TURN	13 - NEGOTIATING A CURVE	18 - APPROACHING OR LEAVING VEHICLE
2 - NON-COLLISION	2 - BACKING	8 - ENTERING TRAFFIC LANE	14 - ENTERING OR CROSSING SPECIFIED LOCATION	19 - STANDING
3 - STRIKING	3 - CHANGING LANES	9 - LEAVING TRAFFIC LANE	15 - WALKING, RUNNING, JOGGING, PLAYING	20 - OTHER NON-MOTORIST
4 - STRUCK	4 - OVERTAKING/PASSING	10 - PARKED	16 - WORKING	21 - STANDING OUTSIDE DISABLED VEHICLE
5 - BOTH STRIKING & STRUCK	5 - MAKING RIGHT TURN	11 - SLOWING OR STOPPED IN TRAFFIC	17 - PUSHING VEHICLE	99 - OTHER / UNKNOWN
9 - OTHER / UNKNOWN	6 - MAKING LEFT TURN	12 - DRIVERLESS		

INITIAL POINT OF CONTACT

0 2 0 - NO DAMAGE
1-12 - REFER TO UNIT DIAGRAM
14 - UNDERCARRIAGE
15 - VEHICLE NOT AT SCENE
99 - UNKNOWN

CONTRIBUTING CIRCUMSTANCES
1 0

1 - NONE	7 - LEFT OF CENTER	13 - IMPROPER START FROM A PARKED POSITION	17 - VISION OBSTRUCTION	21 - LYING IN ROADWAY
2 - FAILURE TO YIELD	8 - FOLLOWING TOO CLOSE/ACDA	14 - STOPPED OR PARKED ILLEGALLY	18 - OPERATING DEFECTIVE EQUIPMENT	22 - NOT DISCERNABLE
3 - RAN RED LIGHT	9 - IMPROPER LANE CHANGING	15 - SWERVING TO AVOID	19 - LOAD SHIFTING/ FALLING/SPILLING	23 - OPENING DOOR INTO ROADWAY
4 - RAN STOP SIGN	10 - IMPROPER PASSING	16 - WRONG WAY	20 - IMPROPER CROSSING	99 - OTHER IMPROPER ACTION
5 - UNSAFE SPEED	11 - DROVE OFF ROAD			
6 - IMPROPER TURN	12 - IMPROPER BACKING			

TRAFFIC

TRAFFICWAY FLOW 2 1 - ONE-WAY 2 - TWO-WAY	TRAFFIC CONTROL 6 1 - ROUNDABOUT 4 - STOP SIGN 2 - SIGNAL 5 - YIELD SIGN 3 - FLASHER 6 - NO CONTROL
--	---

SEQUENCE OF EVENTS

EVENTS

1 2 0 1 - OVERTURN/ROLLOVER	6 - EQUIPMENT FAILURE	11 - CROSS CENTERLINE - OPPOSITE DIRECTION OF TRAVEL	16 - RAILWAY VEHICLE	22 - WORK ZONE MAINTENANCE EQUIPMENT
2 - FIRE/EXPLOSION	7 - SEPARATION OF UNITS	12 - DOWNHILL RUNAWAY	17 - ANIMAL - FARM	23 - STRUCK BY FALLING, SHIFTING CARGO OR ANYTHING SET IN MOTION BY A MOTOR VEHICLE
3 - IMMERSION	8 - RAN OFF ROAD RIGHT	13 - OTHER NON-COLLISION	18 - ANIMAL - DEER	24 - OTHER MOVABLE
4 - JACKKNIFE	9 - RAN OFF ROAD LEFT	14 - PEDESTRIAN	19 - ANIMAL - OTHER	
5 - CARGO / EQUIPMENT LOSS OR SHIFT	10 - CROSS MEDIAN	15 - PEDALCYCLE	20 - MOTOR VEHICLE IN TRANSPORT	

OF THROUGH LANES ON ROAD
2

RAIL GRADE CROSSING
1 1 - NOT INVOLVED
2 - INVOLVED - ACTIVE CROSSING
3 - INVOLVED - PASSIVE CROSSING

COLLISION WITH FIXED OBJECT - STRUCK

25 - IMPACT ATTENUATOR / CRASH CUSHION	31 - GUARDRAIL END	37 - TRAFFIC SIGN POST	43 - CURB	50 - WORKZONE MAINTENANCE EQUIPMENT
26 - BRIDGE OVERHEAD STRUCTURE	32 - PORTABLE BARRIER	38 - OVERHEAD SIGN POST	44 - DITCH	51 - WALL
27 - BRIDGE PIER OR ABUTMENT	33 - MEDIAN CABLE BARRIER	39 - LIGHT/LUMINARIES SUPPORT	45 - EMBANKMENT	52 - BUILDING
28 - BRIDGE PARAPET	34 - MEDIAN GUARDRAIL BARRIER	40 - UTILITY POLE	46 - FENCE	53 - TUNNEL
29 - BRIDGE RAIL	35 - MEDIAN CONCRETE BARRIER	41 - OTHER POST, POLE OR SUPPORT	47 - MAILBOX	54 - OTHER FIXED OBJECT
30 - GUARDRAIL FACE	36 - MEDIAN OTHER BARRIER	42 - CULVERT	48 - TREE	99 - OTHER / UNKNOWN
			49 - FIRE HYDRANT	

UNIT / NON-MOTORIST DIRECTION

FROM 2 TO 1

1 - NORTH 5 - NORTHEAST
2 - SOUTH 6 - NORTHWEST
3 - EAST 7 - SOUTHEAST
4 - WEST 8 - SOUTHWEST

UNIT SPEED
3 0

DETECTED SPEED
1 1 - STATED/ESTIMATED SPEED
2 - CALCULATED / EDR
3 - UNDETERMINED

POSTED SPEED
2 5

FIRST HARMFUL EVENT 1 **MOST HARMFUL EVENT** 1

MOTORIST / NON-MOTORIST

LOCAL REPORT NUMBER
2 0 1 9 2 7 5 2

UNIT # 0 1	NAME: LAST, FIRST, MIDDLE CAMPBELL VICKIE R		DATE OF BIRTH 0 6 0 2 1 9 6 7		AGE 5 2	GENDER F			
ADDRESS: STREET, CITY, STATE, ZIP 13217 COATH AVE CLEVELAND OH 44120 4623				CONTACT PHONE - INCLUDE AREA CODE 2 1 6 5 1 3 3 1 5 1					
INJURIES 5	INJURED TAKEN BY	EMS AGENCY (NAME)	INJURED TAKEN TO: MEDICAL FACILITY (NAME, CITY)	SAFETY EQUIPMENT USED 0 4	<input type="checkbox"/> DOT-COMPLIANT MC HELMET	SEATING POSITION 0 1	AIR BAG USAGE 1	EJECTION 1	TRAPPED 1
OL STATE OH	OPERATOR LICENSE NUMBER RS885100	OFFENSE CHARGED	LOCAL CODE <input type="checkbox"/>	OFFENSE DESCRIPTION		CITATION NUMBER			
OL CLASS 4	ENDORSEMENT SELECT UP TO 2	RESTRICTION SELECT UP TO 3	DRIVER DISTRACTED BY 1	ALCOHOL / DRUG SUSPECTED <input type="checkbox"/> ALCOHOL <input type="checkbox"/> MARIJUANA <input type="checkbox"/> OTHER DRUG		CONDITION 1	STATUS 1	ALCOHOL TEST TYPE VALUE STATUS TYPE RESULT SELECT UP TO 4	

UNIT # 0 2	NAME: LAST, FIRST, MIDDLE BROWN DANNIE		DATE OF BIRTH 0 3 1 3 1 9 5 5		AGE 6 4	GENDER M			
ADDRESS: STREET, CITY, STATE, ZIP 20740 APPLGATE RD MAPLE HTS OH 44137				CONTACT PHONE - INCLUDE AREA CODE 2 1 6 2 2 5 5 9 0 4					
INJURIES 5	INJURED TAKEN BY	EMS AGENCY (NAME)	INJURED TAKEN TO: MEDICAL FACILITY (NAME, CITY)	SAFETY EQUIPMENT USED 0 4	<input type="checkbox"/> DOT-COMPLIANT MC HELMET	SEATING POSITION 0 1	AIR BAG USAGE 1	EJECTION 1	TRAPPED 1
OL STATE OH	OPERATOR LICENSE NUMBER RP955384	OFFENSE CHARGED	LOCAL CODE <input type="checkbox"/>	OFFENSE DESCRIPTION		CITATION NUMBER			
OL CLASS 4	ENDORSEMENT SELECT UP TO 2	RESTRICTION SELECT UP TO 3	DRIVER DISTRACTED BY 1	ALCOHOL / DRUG SUSPECTED <input type="checkbox"/> ALCOHOL <input type="checkbox"/> MARIJUANA <input type="checkbox"/> OTHER DRUG		CONDITION 1	STATUS 1	ALCOHOL TEST TYPE VALUE STATUS TYPE RESULT SELECT UP TO 4	

UNIT #	NAME: LAST, FIRST, MIDDLE		DATE OF BIRTH		AGE	GENDER			
ADDRESS: STREET, CITY, STATE, ZIP				CONTACT PHONE - INCLUDE AREA CODE					
INJURIES	INJURED TAKEN BY	EMS AGENCY (NAME)	INJURED TAKEN TO: MEDICAL FACILITY (NAME, CITY)	SAFETY EQUIPMENT USED	<input type="checkbox"/> DOT-COMPLIANT MC HELMET	SEATING POSITION	AIR BAG USAGE	EJECTION	TRAPPED
OL STATE	OPERATOR LICENSE NUMBER	OFFENSE CHARGED	LOCAL CODE	OFFENSE DESCRIPTION		CITATION NUMBER			
OL CLASS	ENDORSEMENT SELECT UP TO 2	RESTRICTION SELECT UP TO 3	DRIVER DISTRACTED BY	ALCOHOL / DRUG SUSPECTED ALCOHOL MARIJUANA OTHER DRUG		CONDITION	STATUS	ALCOHOL TEST TYPE VALUE STATUS TYPE RESULT SELECT UP TO 4	

INJURIES	SEATING POSITION	AIR BAG	OL CLASS	OL RESTRICTION(S)	DRIVER DISTRACTION	TEST STATUS
1 - FATAL	1 - FRONT - LEFT SIDE (MOTORCYCLE DRIVER)	1 - NOT DEPLOYED	1 - CLASS A	1 - ALCOHOL INTERLOCK DEVICE	1 - NOT DISTRACTED	1 - NONE GIVEN
2 - SUSPECTED SERIOUS INJURY	2 - FRONT - MIDDLE	2 - DEPLOYED FRONT	2 - CLASS B	2 - CDL INTRASTATE ONLY	2 - MANUALLY OPERATING AN ELECTRONIC COMMUNICATION DEVICE (TEXTING, TYPING, DIALING)	2 - TEST REFUSED
3 - SUSPECTED MINOR INJURY	3 - FRONT - RIGHT SIDE	3 - DEPLOYED SIDE	3 - CLASS C	3 - CORRECTIVE LENSES	3 - TALKING ON HANDS-FREE COMMUNICATION DEVICE	3 - TEST GIVEN, CONTAMINATED SAMPLE / UNUSABLE
4 - POSSIBLE INJURY	4 - SECOND - LEFT SIDE (MOTORCYCLE PASSENGER)	4 - DEPLOYED BOTH FRONT / SIDE	4 - REGULAR CLASS (OHIO = D)	4 - FARM WAIVER	4 - TALKING ON HAND-HELD COMMUNICATION DEVICE	4 - TEST GIVEN, RESULTS KNOWN
5 - NO APPARENT INJURY	5 - SECOND - MIDDLE	5 - NOT APPLICABLE	5 - M / C MOPED ONLY	5 - EXCEPT CLASS A BUS & CLASS B BUS	5 - OTHER ACTIVITY WITH AN ELECTRONIC DEVICE	5 - TEST GIVEN, RESULTS UNKNOWN
INJURED TAKEN BY	6 - SECOND - RIGHT SIDE	9 - DEPLOYMENT UNKNOWN	6 - NO VALID OL	6 - EXCEPT CLASS A & CLASS B BUS	6 - PASSENGER	ALCOHOL TEST TYPE
1 - NOT TRANSPORTED / TREATED AT SCENE	7 - THIRD - LEFT SIDE (MOTORCYCLE SIDE CAR)	EJECTION	OL ENDORSEMENT	7 - EXCEPT TRACTOR-TRAILER	7 - OTHER DISTRACTION INSIDE THE VEHICLE	1 - NONE
2 - EMS	8 - THIRD - MIDDLE	1 - NOT EJECTED	H - HAZMAT	8 - INTERMEDIATE LICENSE RESTRICTIONS	8 - OTHER DISTRACTIONS OUTSIDE THE VEHICLE	2 - BLOOD
3 - POLICE	9 - THIRD - RIGHT SIDE	2 - PARTIALLY EJECTED	M - MOTORCYCLE	9 - LEARNER'S PERMIT RESTRICTIONS	9 - OTHER / UNKNOWN	3 - URINE
9 - OTHER / UNKNOWN	10 - SLEEPER SECTION OF TRUCK CAB	3 - TOTALLY EJECTED	P - PASSENGER	10 - LIMITED TO DAYLIGHT ONLY	CONDITION	4 - BREATH
SAFETY EQUIPMENT	11 - PASSENGER IN OTHER ENCLOSED CARGO AREA (NON-TRAILING UNIT, BUS, PICK-UP WITH CAP)	4 - NOT APPLICABLE	N - TANKER	11 - LIMITED TO EMPLOYMENT	1 - APPARENTLY NORMAL	DRUG TEST TYPE
1 - NONE USED	12 - PASSENGER IN UNENCLOSED CARGO AREA	TRAPPED	Q - MOTOR SCOOTER	12 - LIMITED - OTHER	2 - PHYSICAL IMPAIRMENT	1 - NONE
2 - SHOULDER BELT ONLY USED	13 - TRAILING UNIT	1 - NOT TRAPPED	R - THREE-WHEEL MOTORCYCLE	13 - MECHANICAL DEVICES (SPECIAL BRAKES, HAND CONTROLS, OR OTHER ADAPTIVE DEVICES)	3 - EMOTIONAL (E.G. DEPRESSED, ANGRY, DISTURBED)	2 - BLOOD
3 - LAP BELT ONLY USED	14 - RIDING ON VEHICLE EXTERIOR (NON-TRAILING UNIT)	2 - EXTRICATED BY MECHANICAL MEANS	S - SCHOOL BUS	14 - MILITARY VEHICLES ONLY	4 - ILLNESS	3 - URINE
4 - SHOULDER & LAP BELT USED	15 - NON-MOTORIST	3 - FREED BY NON-MECHANICAL MEANS	T - DOUBLE & TRIPLE TRAILERS	15 - MOTOR VEHICLES WITHOUT AIR BRAKES	5 - FELL ASLEEP, FAINTED, FATIGUED, ETC.	4 - OTHER
5 - CHILD RESTRAINT SYSTEM - FORWARD FACING	99 - OTHER / UNKNOWN		X - TANKER / HAZMAT	16 - OUTSIDE MIRROR	6 - UNDER THE INFLUENCE OF MEDICATIONS / DRUGS / ALCOHOL	DRUG TEST RESULT(S)
6 - CHILD RESTRAINT SYSTEM - REAR FACING			GENDER	17 - PROSTHETIC AID	9 - OTHER / UNKNOWN	1 - AMPHETAMINES
7 - BOOSTER SEAT			F - FEMALE	18 - OTHER		2 - BARBITURATES
8 - HELMET USED			M - MALE			3 - BENZODIAZEPINES
9 - PROTECTIVE PADS USED (ELBOWS, KNEES, ETC.)			U - OTHER/UNKNOWN			4 - CANNABINOIDS
10 - REFLECTIVE CLOTHING						5 - COCAINE
11 - LIGHTING - PEDESTRIAN / BICYCLE ONLY						6 - OPIATES / OPIOIDS
99 - OTHER / UNKNOWN						7 - OTHER
						8 - NEGATIVE RESULTS