

# TRAFFIC CRASH REPORT

\*DENOTES MANDATORY FIELD FOR SUPPLEMENT REPORT

LOCAL REPORT NUMBER \*

2 | 0 | 1 | 9 | 3 | 5 | 5 | 5

PHOTOS TAKEN     OH-2     OH-3  
 SECONDARY CRASH     OH-1P     OTHER  
 Private Property

LOCAL INFORMATION  
 REPORTING AGENCY NAME \*  
**GARFIELD HEIGHTS**    NCIC \*  
 0 | 1 | 8 | 2 | 0

HIT/SKIP  
 1 - Solved    NUMBER OF UNITS  
 2 - Unsolved    0 | 2    UNIT IN ERROR  
 98 - ANIMAL    0 | 2    99 - UNKNOWN

COUNTY \*    LOCALITY \*  
 1 | 8    1    1 - CITY \*  
 2 - VILLAGE \*  
 3 - TOWNSHIP \*

LOCATION: CITY, VILLAGE, TOWNSHIP \*  
**GARFIELD HTS**

CRASH DATE/TIME \*  
 1 | 0 | 1 | 1 | 2 | 0 | 1 | 9 | 1 | 7 | 0 | 3

CRASH SEVERITY  
 5    1 - FATAL  
 2 - SERIOUS INJURY SUSPECTED  
 3 - MINOR INJURY SUSPECTED  
 4 - INJURY POSSIBLE  
 5 - PROPERTY DAMAGE ONLY

ROUTE TYPE    ROUTE NUMBER  
 PREFIX 1 - NORTH  
 2 - SOUTH  
 3 - EAST  
 4 - WEST

LOCATION ROAD NAME    ROAD TYPE  
**134**    S | T

LATITUDE DECIMAL DEGREES  
 4 | 1 | . | 4 | 1 | 6 | 3 | 7 | 4

ROUTE TYPE    ROUTE NUMBER  
 PREFIX 1 - NORTH  
 2 - SOUTH  
 3 - EAST  
 4 - WEST

REFERENCE ROAD NAME (ROAD, MILEPOST, HOUSE #)  
**5352**

LONGITUDE DECIMAL DEGREES  
 8 | 1 | . | 5 | 9 | 0 | 5 | 0 | 8

REFERENCE POINT  
 1 - INTERSECTION  
 2 - MILE POST  
 3 - HOUSE #  
**3**

ROUTE TYPE    ROAD TYPE  
 IR - INTERSTATE ROUTE (TP)  
 US - FEDERAL US ROUTE  
 SR - STATE ROUTE  
 CR - NUMBERED COUNTY ROUTE  
 TR - NUMBERED TOWNSHIP ROUTE  
 AL - ALLEY    HW - HIGHWAY    RD - ROAD  
 AV - AVENUE    LA - LANE    SQ - SQUARE  
 BL - BOULEVARD    MP - MILEPOST    ST - STREET  
 CR - CIRCLE    OV - OVAL    TE - TERRACE  
 CT - COURT    PK - PARKWAY    TL - TRAIL  
 DR - DRIVE    PI - PIKE    WA - WAY  
 HE - HEIGHTS    PL - PLACE

INTERSECTION RELATED  
 WITHIN INTERSECTION OR ON APPROACH  
 WITHIN INTERCHANGE AREA    NUMBER OF APPROACHES

DISTANCE FROM REFERENCE    DISTANCE UNIT OF MEASURE  
 1 - Miles  
 2 - Feet  
 3 - Yards

ROADWAY  
 ROADWAY DIVIDED

LOCATION OF FIRST HARMFUL EVENT  
 0 | 1    1 - ON ROADWAY    9 - CROSSOVER  
 2 - ON SHOULDER    10 - DRIVEWAY / ALLEY  
 3 - IN MEDIAN    ACCESS  
 4 - ON ROADSIDE    11 - RAILWAY GRADE  
 5 - ON GORE    CROSSING  
 6 - OUTSIDE TRAFFICWAY  
 7 - ON RAMP    12 - SHARED USE PATHS  
 8 - OFF RAMP    OR TRAILS  
 13 - BIKE LANE  
 14 - TOLL BOOTH  
 99 - OTHER / UNKNOWN

MANNER OF CRASH COLLISION/IMPACT  
 1    1 - NOT COLLISION BETWEEN TWO MOTOR VEHICLES IN TRANSPORT  
 2 - REAR-END  
 3 - HEAD-ON  
 4 - REAR-TO-REAR  
 5 - BACKING  
 6 - ANGLE  
 7 - SIDESWIPE, SAME DIRECTION  
 8 - SIDESWIPE, OPPOSITE DIRECTION  
 9 - OTHER / UNKNOWN

DIRECTION OF TRAVEL  
 1 - NORTH  
 2 - SOUTH  
 3 - EAST  
 4 - WEST

MEDIAN TYPE  
 1 - DIVIDED FLUSH MEDIAN (<4 FEET)  
 2 - DIVIDED FLUSH MEDIAN (≥4 FEET)  
 3 - DIVIDED, DEPRESSIONED MEDIAN (ANY TYPE)  
 4 - DIVIDED, RAISED MEDIAN (ANY TYPE)  
 9 - OTHER / UNKNOWN

WORK ZONE RELATED  
 WORKERS PRESENT  
 LAW ENFORCEMENT PRESENT  
 ACTIVE SCHOOL ZONE

WORK ZONE TYPE  
 1 - LANE CLOSURE  
 2 - LANE SHIFT/CROSSOVER  
 3 - WORK ON SHOULDER OR MEDIAN  
 4 - INTERMITTENT OR MOVING WORK  
 5 - OTHER

LOCATION OF CRASH IN WORK ZONE  
 1 - BEFORE THE 1ST WORK ZONE WARNING SIGN  
 2 - ADVANCE WARNING AREA  
 3 - TRANSITION AREA  
 4 - ACTIVITY AREA  
 5 - TERMINATION AREA

CONTOUR  
 1    1 - STRAIGHT LEVEL  
 2 - STRAIGHT GRADE  
 3 - CURVE LEVEL  
 4 - CURVE GRADE  
 9 - OTHER / UNKNOWN

CONDITIONS  
 1    1 - DRY  
 2 - WET  
 3 - SNOW  
 4 - ICE  
 5 - SAND, MUD, DIRT, OIL, GRAVEL  
 6 - WATER (STANDING, MOVING)  
 7 - SLUSH  
 9 - OTHER/UNKNOWN

SURFACE  
 1    1 - CONCRETE  
 2 - BLACKTOP, BITUMINOUS, ASPHALT  
 3 - BRICK/BLOCK  
 4 - SLAG, GRAVEL, STONE  
 5 - DIRT  
 9 - OTHER / UNKNOWN

LIGHT CONDITION  
 2    1 - DAYLIGHT  
 2 - DAWN/DUSK  
 3 - DARK - LIGHTED ROADWAY  
 4 - DARK - ROADWAY NOT LIGHTED  
 5 - DARK - UNKNOWN ROADWAY LIGHTING  
 9 - OTHER / UNKNOWN

WEATHER  
 1    1 - CLEAR  
 2 - CLOUDY  
 3 - FOG, SMOG, SMOKE  
 4 - RAIN  
 5 - SLEET, HAIL  
 6 - SNOW  
 7 - SEVERE CROSSWINDS  
 8 - BLOWING SAND, SOIL, DIRT, SNOW  
 9 - FREEZING RAIN OR FREEZING DRIZZLE  
 99 - OTHER / UNKNOWN

NARRATIVE  
 UNIT #1 WAS PARKED IN FRONT OF 5352 E. 134 IN THE STREET. UNIT #2 BACKED OUT OF THE DRIVE WAY AND STRUCK UNIT #1.

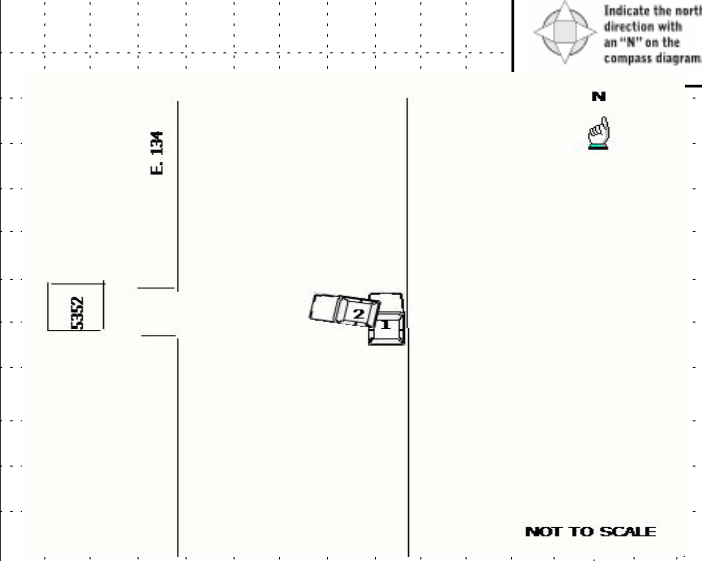

CRASH REPORTED DATE/TIME  
 1 | 0 | 1 | 1 | 2 | 0 | 1 | 9 | 1 | 7 | 0 | 3

DISPATCH DATE/TIME  
 1 | 0 | 1 | 1 | 2 | 0 | 1 | 9 | 1 | 7 | 0 | 4

ARRIVAL DATE/TIME  
 1 | 0 | 1 | 1 | 2 | 0 | 1 | 9 | 1 | 7 | 1 | 2

SCENE CLEARED DATE/TIME  
 1 | 0 | 1 | 1 | 2 | 0 | 1 | 9 | 1 | 7 | 4 | 0

REPORT TAKEN BY  
 POLICE AGENCY  
 MOTORIST

TOTAL TIME ROADWAY CLOSED  
 0

OTHER INVESTIGATION TIME  
 3 | 0

TOTAL MINUTES  
 5 | 8

OFFICER'S NAME \*  
**C. Bruno**  
 OFFICER'S BADGE NUMBER \*  
 0 | 2 | 1

CHECKED BY OFFICER'S NAME \*  
**T. Murphy**  
 CHECKED BY OFFICER'S BADGE NUMBER \*  
 L | 0 | 9

SUPPLEMENT (CORRECTION - ADDITION)

2 0 1 9 3 5 5 5

**OWNER**

UNIT # 01 OWNER NAME: LAST, FIRST, MIDDLE ( ) Same As Driver  
**CANCELLIERE NICK S**

OWNER PHONE: INCLUDE AREA CODE ( ) Same As Driver  
**2 1 6 2 6 2 6 6 0 1**

OWNER ADDRESS: STREET, CITY, STATE, ZIP ( ) Same As Driver  
**4189 DIANA DR BROADVIEW HTS OH 44147**

COMMERCIAL CARRIER: NAME, ADDRESS, CITY, STATE, ZIP  
 COMMERCIAL CARRIER PHONE: INCLUDE AREA CODE

**DAMAGE**

**DAMAGE SCALE**

3 1 - NONE 3 - FUNCTIONAL DAMAGE  
 2 - MINOR DAMAGE 4 - DISABLING DAMAGE  
 9 - UNKNOWN

**VEHICLE**

LP STATE OH LICENSE PLATE # **HKE9111** VEHICLE IDENTIFICATION # 4S3BNA1C631J130321893 VEHICLE YEAR 2018 VEHICLE MAKE **Subaru**

INSURANCE VERIFIED  INSURANCE COMPANY **STATE FARM** INSURANCE POLICY # **2560360E0235F** VEHICLE COLOR **BLK** VEHICLE MODEL **Legacy**

TYPE OF USE:  COMMERCIAL  GOVERNMENT  IN EMERGENCY RESPONSE

INTERLOCK DEVICE EQUIPPED  HIT/SKIP UNIT  # OCCUPANTS 00 US DOT # \_\_\_\_\_ TOWED BY: COMPANY NAME \_\_\_\_\_

HAZARDOUS MATERIAL:  MATERIAL RELEASED CLASS # \_\_\_\_\_ PLACARD ID # \_\_\_\_\_  
 PLACARD



UNIT TYPE 01

1 - PASSENGER CAR 7 - MOTORCYCLE 2-WHEELED 12 - GOLF CART 18 - LIMO (LIVERY VEHICLE) 23 - PEDESTRIAN/SKATER  
 2 - PASSENGER VAN (MINIVAN) 8 - MOTORCYCLE 3-WHEELED 13 - SNOWMOBILE 19 - BUS (16+ PASSENGERS) 24 - WHEELCHAIR (ANY TYPE)  
 3 - SPORT UTILITY VEHICLE 9 - AUTOCYCLE 14 - SINGLE UNIT TRUCK 20 - OTHER VEHICLE 25 - OTHER NON-MOTORIST  
 4 - PICK UP 10 - MOPED OR MOTORIZED BICYCLE 15 - SEMI-TRACTOR 21 - HEAVY EQUIPMENT 26 - BICYCLE  
 5 - CARGO VAN 11 - ALL TERRAIN VEHICLE (ATV / UTV) 16 - FARM EQUIPMENT 22 - ANIMAL WITH RIDER OR ANIMAL-DRAWN VEHICLE 27 - TRAIN  
 6 - VAN (9-15 SEATS) 17 - MOTORHOME

# of TRAILING UNITS \_\_\_\_\_

WAS VEHICLE OPERATING IN AUTONOMOUS MODE WHEN CRASH OCCURRED? 2

1 - YES 2 - NO 9 - OTHER / UNKNOWN

AUTONOMOUS MODE LEVEL: 0 - NO AUTOMATION 1 - DRIVER ASSISTANCE 2 - PARTIAL AUTOMATION 3 - CONDITIONAL AUTOMATION 4 - HIGH AUTOMATION 5 - FULL AUTOMATION 9 - UNKNOWN

SPECIAL FUNCTION 01

1 - NONE 6 - BUS - CHARTER/TOUR 11 - FIRE 16 - FARM 21 - MAIL CARRIER  
 2 - TAXI 7 - BUS - INTERCITY 12 - MILITARY 17 - MOWING 22 - OTHER / UNKNOWN  
 3 - ELECTRONIC RIDE SHARING 8 - BUS - SHUTTLE 13 - POLICE 18 - SNOW REMOVAL N  
 4 - SCHOOL TRANSPORT 9 - BUS - OTHER 14 - PUBLIC UTILITY 19 - TOWING  
 5 - BUS-TRANSIT/COMMUTER 10 - AMBULANCE 15 - CONSTRUCTION EQUIPMENT 20 - SAFETY SERVICE PATROL

CARGO BODY TYPE 01

1 - NO CARGO BODY TYPE / NOT APPLICABLE 3 - VEHICLE TOWING ANOTHER MOTOR VEHICLE 5 - INTERMODAL CONTAINER CHASSIS 8 - POLE 12 - CONCRETE MIXER  
 2 - BUS 4 - LOGGING 6 - CARGO VAN/ENCLOSED BOX 7 - GRAIN/CHIPS/GRAVEL 9 - CARGO TANK 10 - FLAT BED 11 - DUMP 13 - AUTO TRANSPORTER  
 14 - GARBAGE/REFUSE 15 - TOWING 16 - FARM 17 - MOWING 18 - SNOW REMOVAL 19 - TOWING 20 - SAFETY SERVICE PATROL 21 - MAIL CARRIER 22 - OTHER / UNKNOWN

VEHICLE DEFECTS

1 - TURN SIGNALS 4 - BRAKES 7 - WORN OR SLICK TIRES 9 - MOTOR TROUBLE 99 - OTHER / UNKNOWN  
 2 - HEAD LAMPS 5 - STEERING 8 - TRAILER EQUIPMENT DEFECTIVE 10 - DISABLED FROM PRIOR ACCIDENT  
 3 - TAIL LAMPS 6 - TIRE BLOWOUT

NON-MOTORIST LOCATION AT IMPACT

1 - INTERSECTION - MARKED CROSSWALK 3 - INTERSECTION - OTHER 6 - BICYCLE LANE 9 - MEDIAN/CROSSING ISLAND 12 - FIRST RESPONDER AT INCIDENT SCENE  
 2 - INTERSECTION - UNMARKED 4 - MIDLICK - MARKED CROSSWALK 7 - SHOULDER/ROADSIDE 8 - SIDEWALK 10 - DRIVEWAY ACCESS 11 - SHARED USE PATHS OR TRAILS 14 - GARBAGE/REFUSE 15 - TOWING 16 - FARM 17 - MOWING 18 - SNOW REMOVAL 19 - TOWING 20 - SAFETY SERVICE PATROL 21 - MAIL CARRIER 22 - OTHER / UNKNOWN

ACTION 4 PRE-CRASH ACTION 10

1 - NON-CONTACT 2 - NON-COLLISION 3 - STRIKING 4 - STRUCK 5 - BOTH STRIKING & STRUCK 9 - OTHER / UNKNOWN  
 1 - STRAIGHT AHEAD 2 - BACKING 3 - CHANGING LANES 4 - OVERTAKING/PASSING 5 - MAKING RIGHT TURN 6 - MAKING LEFT TURN  
 7 - MAKING U-TURN 8 - ENTERING TRAFFIC LANE 9 - LEAVING TRAFFIC LANE 10 - PARKED 11 - SLOWING OR STOPPED IN TRAFFIC 12 - DRIVERLESS  
 13 - NEGOTIATING A CURVE 14 - ENTERING OR CROSSING SPECIFIED LOCATION 15 - WALKING, RUNNING, JOGGING, PLAYING 16 - WORKING 17 - PUSHING VEHICLE  
 18 - APPROACHING OR LEAVING VEHICLE 19 - STANDING 20 - OTHER NON-MOTORIST 21 - STANDING OUTSIDE DISABLED VEHICLE 24 - OTHER MOVABLE

INITIAL POINT OF CONTACT

11 0 - NO DAMAGE 14 - UNDERCARRIAGE  
 1-12 - REFER TO UNIT DIAGRAM 15 - VEHICLE NOT AT SCENE 99 - UNKNOWN

CONTRIBUTING CIRCUMSTANCES 01

1 - NONE 7 - LEFT OF CENTER 13 - IMPROPER START FROM A PARKED POSITION 17 - VISION OBSTRUCTION 21 - LYING IN ROADWAY  
 2 - FAILURE TO YIELD 8 - FOLLOWING TOO CLOSE/ACDA 14 - STOPPED OR PARKED ILLEGALLY 18 - OPERATING DEFECTIVE EQUIPMENT 22 - NOT DISCERNABLE  
 3 - RAN RED LIGHT 9 - IMPROPER LANE CHANGING 15 - SWERVING TO AVOID 19 - LOAD SHIFTING/ FALLING/SPILLING 23 - OPENING DOOR INTO ROADWAY  
 4 - RAN STOP SIGN 5 - UNSAFE SPEED 6 - IMPROPER TURN 10 - IMPROPER PASSING 11 - DROVE OFF ROAD 12 - IMPROPER BACKING 16 - WRONG WAY 20 - IMPROPER CROSSING 99 - OTHER IMPROPER ACTION

TRAFFIC

TRAFFICWAY FLOW 2 1 - ONE-WAY 2 - TWO-WAY

TRAFFIC CONTROL 6 1 - ROUNDABOUT 4 - STOP SIGN 2 - SIGNAL 5 - YIELD SIGN 3 - FLASHER 6 - NO CONTROL

SEQUENCE OF EVENTS

EVENTS

1 20 1 - OVERTURN/ROLLOVER 6 - EQUIPMENT FAILURE 11 - CROSS CENTERLINE - OPPOSITE DIRECTION OF TRAVEL 16 - RAILWAY VEHICLE 22 - WORK ZONE MAINTENANCE EQUIPMENT  
 2 - FIRE/EXPLOSION 7 - SEPARATION OF UNITS 12 - DOWNHILL RUNAWAY 17 - ANIMAL - FARM 18 - ANIMAL - DEER 19 - ANIMAL - OTHER 20 - MOTOR VEHICLE IN TRANSPORT 21 - PARKED MOTOR VEHICLE 24 - OTHER MOVABLE  
 3 - IMMERSION 8 - RAN OFF ROAD RIGHT 9 - RAN OFF ROAD LEFT 10 - CROSS MEDIAN 13 - OTHER NON-COLLISION 14 - PEDESTRIAN 15 - PEDALCYCLE

# OF THROUGH LANES ON ROAD 2

RAIL GRADE CROSSING 1 1 - NOT INVOLVED 2 - INVOLVED - ACTIVE CROSSING 3 - INVOLVED - PASSIVE CROSSING

COLLISION WITH FIXED OBJECT - STRUCK

25 - IMPACT ATTENUATOR / CRASH CUSHION 31 - GUARDRAIL END 37 - TRAFFIC SIGN POST 43 - CURB 50 - WORKZONE MAINTENANCE EQUIPMENT  
 26 - BRIDGE OVERHEAD STRUCTURE 32 - PORTABLE BARRIER 38 - OVERHEAD SIGN POST 44 - DITCH 51 - WALL 52 - BUILDING 53 - TUNNEL  
 27 - BRIDGE PIER OR ABUTMENT 33 - MEDIAN CABLE BARRIER 39 - LIGHT/LUMINARIES SUPPORT 45 - EMBANKMENT 46 - FENCE 47 - MAILBOX 48 - TREE 49 - FIRE HYDRANT  
 28 - BRIDGE PARAPET 34 - MEDIAN GUARDRAIL BARRIER 40 - UTILITY POLE 41 - OTHER POST, POLE OR SUPPORT 54 - OTHER FIXED OBJECT 99 - OTHER / UNKNOWN  
 29 - BRIDGE RAIL 35 - MEDIAN CONCRETE BARRIER 42 - CULVERT  
 30 - GUARDRAIL FACE 36 - MEDIAN OTHER BARRIER

FIRST HARMFUL EVENT 1 MOST HARMFUL EVENT 1

UNIT / NON-MOTORIST DIRECTION

FROM 2 TO 1

1 - NORTH 5 - NORTHEAST 2 - SOUTH 6 - NORTHWEST 3 - EAST 7 - SOUTHEAST 4 - WEST 8 - SOUTHWEST

UNIT SPEED 0

POSTED SPEED 0

DETECTED SPEED  
 1 - STATED/ESTIMATED SPEED  
 2 - CALCULATED / EDR  
 3 - UNDETERMINED

2 0 1 9 3 5 5 5

**UNIT #** 0 2 **OWNER NAME: LAST, FIRST, MIDDLE** ( ) Same As Driver  
**PHILSTEAD MEGAN NICOLE**  
**OWNER PHONE: INCLUDE AREA CODE** ( ) Same As Driver  
**2 1 6 9 5 2 5 1 4 5**  
**OWNER ADDRESS: STREET, CITY, STATE, ZIP** ( ) Same As Driver  
**7460 BRECKSVILLE RD INDEPENDENCE OH 44131**  
**COMMERCIAL CARRIER: NAME, ADDRESS, CITY, STATE, ZIP**  
**COMMERCIAL CARRIER PHONE: INCLUDE AREA CODE**

**DAMAGE**  
**DAMAGE SCALE**  
 3 1 - NONE 3 - FUNCTIONAL DAMAGE  
 2 - MINOR DAMAGE 4 - DISABLING DAMAGE  
 9 - UNKNOWN

**LP STATE** OH **LICENSE PLATE #** RNITOV **VEHICLE IDENTIFICATION #** 1C4BJW1F6G0D1519941 **VEHICLE YEAR** 2013 **VEHICLE MAKE** Jeep  
**INSURANCE VERIFIED** **INSURANCE COMPANY** STATE FARM **INSURANCE POLICY #** 9364560A2635B **VEHICLE COLOR** BLK **VEHICLE MODEL** Wagoneer  
 COMMERCIAL  GOVERNMENT  IN EMERGENCY RESPONSE **US DOT #** **TOWED BY: COMPANY NAME**  
 INTERLOCK DEVICE EQUIPPED  HIT/SKIP UNIT **# OCCUPANTS** 0 3 **VEHICLE WEIGHT GVWR/GCWR**  
 1 - ≤10K LBS. 2 - 10,001 - 26K LBS. 3 - >26K LBS.  HAZARDOUS MATERIAL  MATERIAL RELEASED  PLACARD **CLASS #** **PLACARD ID #**

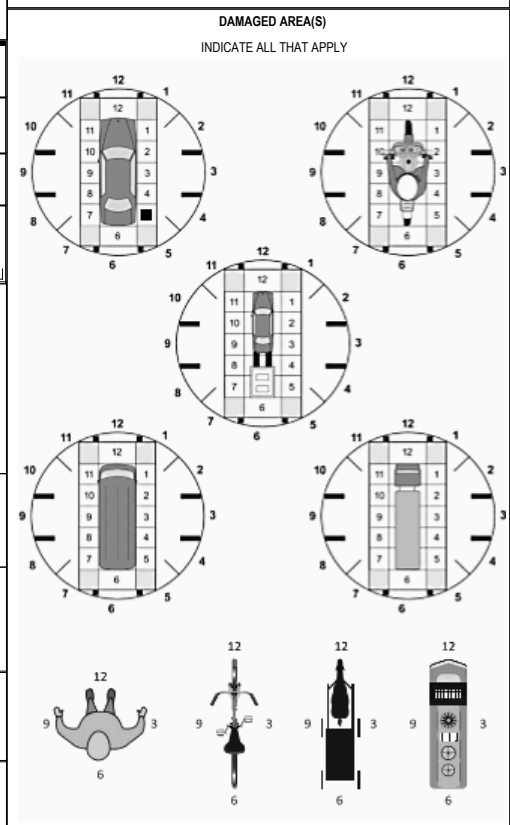

**UNIT TYPE** 0 3  
 1 - PASSENGER CAR 7 - MOTORCYCLE 2-WHEELED 12 - GOLF CART 18 - LIMO (LIVERY VEHICLE) 23 - PEDESTRIAN/SKATER  
 2 - PASSENGER VAN (MINIVAN) 8 - MOTORCYCLE 3-WHEELED 13 - SNOWMOBILE 19 - BUS (16+ PASSENGERS) 24 - WHEELCHAIR (ANY TYPE)  
 3 - SPORT UTILITY VEHICLE 9 - AUTOCYCLE 14 - SINGLE UNIT TRUCK 20 - OTHER VEHICLE 25 - OTHER NON-MOTORIST  
 4 - PICK UP 10 - MOPED OR MOTORIZED BICYCLE 15 - SEMI-TRACTOR 21 - HEAVY EQUIPMENT 26 - BICYCLE  
 5 - CARGO VAN 11 - ALL TERRAIN VEHICLE (ATV / UTV) 16 - FARM EQUIPMENT 22 - ANIMAL WITH RIDER OR ANIMAL-DRAWN VEHICLE 27 - TRAIN  
 6 - VAN (9-15 SEATS) 17 - MOTORHOME 99 - UNKNOWN OR HIT/SKIP  
**# of TRAILING UNITS**

**WAS VEHICLE OPERATING IN AUTONOMOUS MODE WHEN CRASH OCCURRED?** 2 0 - NO AUTOMATION 1 - DRIVER ASSISTANCE 3 - CONDITIONAL AUTOMATION 9 - UNKNOWN  
 1 - YES 2 - NO 9 - OTHER / UNKNOWN 2 - PARTIAL AUTOMATION 4 - HIGH AUTOMATION 5 - FULL AUTOMATION  
**AUTONOMOUS MODE LEVEL**

**SPECIAL FUNCTION** 0 1  
 1 - NONE 6 - BUS - CHARTER/TOUR 11 - FIRE 16 - FARM 21 - MAIL CARRIER  
 2 - TAXI 7 - BUS - INTERCITY 12 - MILITARY 17 - MOWING 22 - OTHER / UNKNOWN  
 3 - ELECTRONIC RIDE SHARING 8 - BUS - SHUTTLE 13 - POLICE 18 - SNOW REMOVAL N  
 4 - SCHOOL TRANSPORT 9 - BUS - OTHER 14 - PUBLIC UTILITY 19 - TOWING  
 5 - BUS-TRANSIT/COMMUTER 10 - AMBULANCE 15 - CONSTRUCTION EQUIPMENT 20 - SAFETY SERVICE PATROL

**CARGO BODY TYPE** 0 1  
 1 - NO CARGO BODY TYPE / NOT APPLICABLE 3 - VEHICLE TOWING ANOTHER MOTOR VEHICLE 5 - INTERMODAL CONTAINER CHASSIS 8 - POLE 12 - CONCRETE MIXER  
 2 - BUS 4 - LOGGING 6 - CARGO VAN/ENCLOSED BOX 9 - CARGO TANK 13 - AUTO TRANSPORTER  
 7 - GRAIN/CHIPS/GRAVEL 11 - DUMP 14 - GARBAGE/REFUSE 19 - TOWING 99 - OTHER / UNKNOWN

**VEHICLE DEFECTS**  
 1 - TURN SIGNALS 4 - BRAKES 7 - WORN OR SLICK TIRES 9 - MOTOR TROUBLE 99 - OTHER / UNKNOWN  
 2 - HEAD LAMPS 5 - STEERING 8 - TRAILER EQUIPMENT DEFECTIVE 10 - DISABLED FROM PRIOR ACCIDENT  
 3 - TAIL LAMPS 6 - TIRE BLOWOUT

**NON-MOTORIST LOCATION AT IMPACT**  
 1 - INTERSECTION - MARKED CROSSWALK 3 - INTERSECTION - OTHER 6 - BICYCLE LANE 9 - MEDIAN/CROSSING ISLAND 12 - FIRST RESPONDER OR LEAVING VEHICLE AT INCIDENT SCENE  
 2 - INTERSECTION - UNMARKED 4 - MIDBLOCK - MARKED CROSSWALK 7 - SHOULDER/ROADSIDE 10 - DRIVEWAY ACCESS 14 - GARBAGE/REFUSE 99 - OTHER / UNKNOWN  
 5 - TRAVEL LANE-OTHER LOCATION 8 - SIDEWALK 11 - SHARED USE PATHS OR TRAILS

**ACTION** 3 **PRE-CRASH ACTION** 0 2  
 1 - NON-CONTACT 1 - STRAIGHT AHEAD 7 - MAKING U-TURN 13 - NEGOTIATING A CURVE 18 - APPROACHING OR LEAVING VEHICLE  
 2 - NON-COLLISION 2 - BACKING 8 - ENTERING TRAFFIC LANE 14 - ENTERING OR CROSSING SPECIFIED LOCATION 19 - STANDING  
 3 - STRIKING 3 - CHANGING LANES 9 - LEAVING TRAFFIC LANE 15 - WALKING, RUNNING, JOGGING, PLAYING 20 - OTHER NON-MOTORIST  
 4 - STRUCK 4 - OVERTAKING/PASSING 10 - PARKED 16 - WORKING 21 - STANDING OUTSIDE DISABLED VEHICLE  
 5 - BOTH STRIKING & STRUCK 5 - MAKING RIGHT TURN 11 - SLOWING OR STOPPED IN TRAFFIC 99 - OTHER / UNKNOWN  
 9 - OTHER / UNKNOWN 6 - MAKING LEFT TURN 12 - DRIVERLESS 17 - PUSHING VEHICLE

**CONTRIBUTING CIRCUMSTANCES** 1 2  
 1 - NONE 7 - LEFT OF CENTER 13 - IMPROPER START FROM A PARKED POSITION 17 - VISION OBSTRUCTION 21 - LYING IN ROADWAY  
 2 - FAILURE TO YIELD 8 - FOLLOWING TOO CLOSE/ACDA 14 - OPERATING DEFECTIVE EQUIPMENT 22 - NOT DISCERNABLE  
 3 - RAN RED LIGHT 9 - IMPROPER LANE CHANGING 15 - SWERVING TO AVOID 19 - LOAD SHIFTING/ FALLING/SPILLING 99 - OTHER IMPROPER ACTION  
 4 - RAN STOP SIGN 5 - UNSAFE SPEED 10 - IMPROPER PASSING 11 - DROVE OFF ROAD 16 - WRONG WAY 20 - IMPROPER CROSSING  
 6 - IMPROPER TURN 12 - IMPROPER BACKING

- NO DAMAGE [0]  - UNDERCARRIAGE [14]  
 - TOP [13]  - ALL AREAS [15]  
 - UNIT NOT AT SCENE [16]

**INITIAL POINT OF CONTACT**  
 0 4 0 - NO DAMAGE 14 - UNDERCARRIAGE  
 1-12 - REFER TO UNIT DIAGRAM 15 - VEHICLE NOT AT SCENE 99 - UNKNOWN

**SEQUENCE OF EVENTS**  
**EVENTS**  
 1 2 1 1 - OVERTURN/ROLLOVER 6 - EQUIPMENT FAILURE 11 - CROSS CENTERLINE - OPPOSITE DIRECTION OF TRAVEL 16 - RAILWAY VEHICLE 22 - WORK ZONE MAINTENANCE EQUIPMENT  
 2 - FIRE/EXPLOSION 7 - SEPARATION OF UNITS 17 - ANIMAL - FARM 18 - ANIMAL - DEER  
 3 - IMMERSION 8 - RAN OFF ROAD RIGHT 19 - ANIMAL - OTHER 23 - STRUCK BY FALLING, SHIFTING CARGO OR ANYTHING SET IN MOTION BY A MOTOR VEHICLE  
 4 - JACKKNIFE 9 - RAN OFF ROAD LEFT 20 - MOTOR VEHICLE IN TRANSPORT 24 - OTHER MOVABLE  
 5 - CARGO / EQUIPMENT LOSS OR SHIFT 10 - CROSS MEDIAN 21 - PARKED MOTOR VEHICLE

**TRAFFIC**  
**TRAFFICWAY FLOW** 2 1 - ONE-WAY 2 - TWO-WAY  
**TRAFFIC CONTROL** 6 1 - ROUNDABOUT 4 - STOP SIGN  
 2 - SIGNAL 5 - YIELD SIGN  
 3 - FLASHER 6 - NO CONTROL

**COLLISION WITH FIXED OBJECT - STRUCK**  
 25 - IMPACT ATTENUATOR / CRASH CUSHION 31 - GUARDRAIL END 37 - TRAFFIC SIGN POST 43 - CURB 50 - WORKZONE MAINTENANCE EQUIPMENT  
 26 - BRIDGE OVERHEAD STRUCTURE 32 - PORTABLE BARRIER 38 - OVERHEAD SIGN POST 44 - DITCH 51 - WALL  
 27 - BRIDGE PIER OR ABUTMENT 33 - MEDIAN CABLE BARRIER 39 - LIGHT/LUMINARIES SUPPORT 45 - EMBANKMENT 52 - BUILDING  
 28 - BRIDGE PARAPET 34 - MEDIAN GUARDRAIL BARRIER 40 - UTILITY POLE 46 - FENCE 53 - TUNNEL  
 29 - BRIDGE RAIL 35 - MEDIAN CONCRETE BARRIER 41 - OTHER POST, POLE OR SUPPORT 47 - MAILBOX 54 - OTHER FIXED OBJECT  
 30 - GUARDRAIL FACE 36 - MEDIAN OTHER BARRIER 42 - CULVERT 48 - TREE 55 - OTHER / UNKNOWN  
 49 - FIRE HYDRANT  
**FIRST HARMFUL EVENT** 1 **MOST HARMFUL EVENT** 1

**# OF THROUGH LANES ON ROAD** 2  
**RAIL GRADE CROSSING** 1 1 - NOT INVOLVED  
 2 - INVOLVED - ACTIVE CROSSING  
 3 - INVOLVED - PASSIVE CROSSING

**UNIT / NON-MOTORIST DIRECTION**  
 FROM 4 TO 3  
 1 - NORTH 5 - NORTHEAST  
 2 - SOUTH 6 - NORTHWEST  
 3 - EAST 7 - SOUTHEAST  
 4 - WEST 8 - SOUTHWEST

**UNIT SPEED** 3  
**POSTED SPEED** 2 5  
**DETECTED SPEED** 1 1 - STATED/ESTIMATED SPEED  
 2 - CALCULATED / EDR  
 3 - UNDETERMINED

# MOTORIST / NON-MOTORIST

LOCAL REPORT NUMBER  
2 0 1 9 3 5 5 5

UNIT # 0 2	NAME: LAST, FIRST, MIDDLE PHILSTEAD MITCHELL L		DATE OF BIRTH 0 4 1 2 1 9 8 4		AGE 3 5	GENDER M			
ADDRESS: STREET, CITY, STATE, ZIP 4106 E 71ST ST CLEVELAND OH 44105				CONTACT PHONE - INCLUDE AREA CODE 2 1 6 8 2 0 1 3 8 0					
INJURIES 5	INJURED TAKEN BY	EMS AGENCY (NAME)	INJURED TAKEN TO: MEDICAL FACILITY (NAME, CITY)	SAFETY EQUIPMENT USED 0 4	<input type="checkbox"/> DOT-COMPLIANT MC HELMET	SEATING POSITION 0 1	AIR BAG USAGE 1	EJECTION 1	TRAPPED 1
OL STATE OH	OPERATOR LICENSE NUMBER	OFFENSE CHARGED 331.13	LOCAL CODE ■	OFFENSE DESCRIPTION STARTING AND BACKING			CITATION NUMBER G20193863		
OL CLASS 1	ENDORSEMENT SELECT UP TO 2	RESTRICTION SELECT UP TO 3	DRIVER DISTRACTED BY 1	ALCOHOL / DRUG SUSPECTED <input type="checkbox"/> ALCOHOL <input type="checkbox"/> MARIJUANA <input type="checkbox"/> OTHER DRUG		CONDITION 1	STATUS 1	ALCOHOL TEST TYPE VALUE STATUS TYPE RESULT SELECT UP TO 4	

UNIT #	NAME: LAST, FIRST, MIDDLE		DATE OF BIRTH		AGE	GENDER			
ADDRESS: STREET, CITY, STATE, ZIP				CONTACT PHONE - INCLUDE AREA CODE					
INJURIES	INJURED TAKEN BY	EMS AGENCY (NAME)	INJURED TAKEN TO: MEDICAL FACILITY (NAME, CITY)	SAFETY EQUIPMENT USED	<input type="checkbox"/> DOT-COMPLIANT MC HELMET	SEATING POSITION	AIR BAG USAGE	EJECTION	TRAPPED
OL STATE	OPERATOR LICENSE NUMBER	OFFENSE CHARGED	LOCAL CODE	OFFENSE DESCRIPTION			CITATION NUMBER		
OL CLASS	ENDORSEMENT SELECT UP TO 2	RESTRICTION SELECT UP TO 3	DRIVER DISTRACTED BY	ALCOHOL / DRUG SUSPECTED ALCOHOL MARIJUANA OTHER DRUG		CONDITION	STATUS	ALCOHOL TEST TYPE VALUE STATUS TYPE RESULT SELECT UP TO 4	

UNIT #	NAME: LAST, FIRST, MIDDLE		DATE OF BIRTH		AGE	GENDER			
ADDRESS: STREET, CITY, STATE, ZIP				CONTACT PHONE - INCLUDE AREA CODE					
INJURIES	INJURED TAKEN BY	EMS AGENCY (NAME)	INJURED TAKEN TO: MEDICAL FACILITY (NAME, CITY)	SAFETY EQUIPMENT USED	<input type="checkbox"/> DOT-COMPLIANT MC HELMET	SEATING POSITION	AIR BAG USAGE	EJECTION	TRAPPED
OL STATE	OPERATOR LICENSE NUMBER	OFFENSE CHARGED	LOCAL CODE	OFFENSE DESCRIPTION			CITATION NUMBER		
OL CLASS	ENDORSEMENT SELECT UP TO 2	RESTRICTION SELECT UP TO 3	DRIVER DISTRACTED BY	ALCOHOL / DRUG SUSPECTED ALCOHOL MARIJUANA OTHER DRUG		CONDITION	STATUS	ALCOHOL TEST TYPE VALUE STATUS TYPE RESULT SELECT UP TO 4	

INJURIES	SEATING POSITION	AIR BAG	OL CLASS	OL RESTRICTION(S)	DRIVER DISTRACTION	TEST STATUS
1 - FATAL	1 - FRONT - LEFT SIDE (MOTORCYCLE DRIVER)	1 - NOT DEPLOYED	1 - CLASS A	1 - ALCOHOL INTERLOCK DEVICE	1 - NOT DISTRACTED	1 - NONE GIVEN
2 - SUSPECTED SERIOUS INJURY	2 - FRONT - MIDDLE	2 - DEPLOYED FRONT	2 - CLASS B	2 - CDL INTRASTATE ONLY	2 - MANUALLY OPERATING AN ELECTRONIC COMMUNICATION DEVICE (TEXTING, TYPING, DIALING)	2 - TEST REFUSED
3 - SUSPECTED MINOR INJURY	3 - FRONT - RIGHT SIDE	3 - DEPLOYED SIDE	3 - CLASS C	3 - CORRECTIVE LENSES	3 - TALKING ON HANDS-FREE COMMUNICATION DEVICE	3 - TEST GIVEN, CONTAMINATED SAMPLE / UNUSABLE
4 - POSSIBLE INJURY	4 - SECOND - LEFT SIDE (MOTORCYCLE PASSENGER)	4 - DEPLOYED BOTH FRONT / SIDE	4 - REGULAR CLASS (OHIO = D)	4 - FARM WAIVER	4 - TALKING ON HAND-HELD COMMUNICATION DEVICE	4 - TEST GIVEN, RESULTS KNOWN
5 - NO APPARENT INJURY	5 - SECOND - MIDDLE	5 - NOT APPLICABLE	5 - M / C MOPED ONLY	5 - EXCEPT CLASS A BUS & CLASS B BUS	5 - OTHER ACTIVITY WITH AN ELECTRONIC DEVICE	5 - TEST GIVEN, RESULTS UNKNOWN
<b>INJURED TAKEN BY</b>		6 - SECOND - RIGHT SIDE	6 - NO VALID OL	6 - EXCEPT CLASS A & CLASS B BUS	6 - PASSENGER	<b>ALCOHOL TEST TYPE</b>
1 - NOT TRANSPORTED / TREATED AT SCENE	7 - THIRD - LEFT SIDE (MOTORCYCLE SIDE CAR)	9 - DEPLOYMENT UNKNOWN	<b>EJECTION</b>	7 - EXCEPT TRACTOR-TRAILER	7 - OTHER DISTRACTION INSIDE THE VEHICLE	1 - NONE
2 - EMS	8 - THIRD - MIDDLE	<b>EJECTION</b>	H - HAZMAT	8 - INTERMEDIATE LICENSE RESTRICTIONS	8 - OTHER DISTRACTIONS OUTSIDE THE VEHICLE	2 - BLOOD
3 - POLICE	9 - THIRD - RIGHT SIDE	1 - NOT EJECTED	M - MOTORCYCLE	9 - LEARNER'S PERMIT RESTRICTIONS	9 - OTHER / UNKNOWN	3 - URINE
9 - OTHER / UNKNOWN	10 - SLEEPER SECTION OF TRUCK CAB	2 - PARTIALLY EJECTED	P - PASSENGER	10 - LIMITED TO DAYLIGHT ONLY	<b>CONDITION</b>	4 - BREATH
<b>SAFETY EQUIPMENT</b>		3 - TOTALLY EJECTED	N - TANKER	11 - LIMITED TO EMPLOYMENT	1 - APPARENTLY NORMAL	<b>DRUG TEST TYPE</b>
1 - NONE USED	11 - PASSENGER IN OTHER ENCLOSED CARGO AREA (NON-TRAILING UNIT, BUS, PICK-UP WITH CAP)	4 - NOT APPLICABLE	Q - MOTOR SCOOTER	12 - LIMITED - OTHER	2 - PHYSICAL IMPAIRMENT	1 - NONE
2 - SHOULDER BELT ONLY USED	12 - PASSENGER IN UNENCLOSED CARGO AREA	<b>TRAPPED</b>	R - THREE-WHEEL MOTORCYCLE	13 - MECHANICAL DEVICES (SPECIAL BRAKES, HAND CONTROLS, OR OTHER ADAPTIVE DEVICES)	3 - EMOTIONAL (E.G. DEPRESSED, ANGRY, DISTURBED)	2 - BLOOD
3 - LAP BELT ONLY USED	13 - TRAILING UNIT	1 - NOT TRAPPED	S - SCHOOL BUS	14 - MILITARY VEHICLES ONLY	4 - ILLNESS	3 - URINE
4 - SHOULDER & LAP BELT USED	14 - RIDING ON VEHICLE EXTERIOR (NON-TRAILING UNIT)	2 - EXTRICATED BY MECHANICAL MEANS	T - DOUBLE & TRIPLE TRAILERS	15 - MOTOR VEHICLES WITHOUT AIR BRAKES	5 - FELL ASLEEP, FAINTED, FATIGUED, ETC.	4 - OTHER
5 - CHILD RESTRAINT SYSTEM - FORWARD FACING	15 - NON-MOTORIST	3 - FREED BY NON-MECHANICAL MEANS	X - TANKER / HAZMAT	16 - OUTSIDE MIRROR	6 - UNDER THE INFLUENCE OF MEDICATIONS / DRUGS / ALCOHOL	<b>DRUG TEST RESULT(S)</b>
6 - CHILD RESTRAINT SYSTEM - REAR FACING	99 - OTHER / UNKNOWN		<b>GENDER</b>	17 - PROSTHETIC AID	9 - OTHER / UNKNOWN	1 - AMPHETAMINES
7 - BOOSTER SEAT			F - FEMALE	18 - OTHER		2 - BARBITURATES
8 - HELMET USED			M - MALE			3 - BENZODIAZEPINES
9 - PROTECTIVE PADS USED (ELBOWS, KNEES, ETC.)			U - OTHER/UNKNOWN			4 - CANNABINOIDS
10 - REFLECTIVE CLOTHING						5 - COCAINE
11 - LIGHTING - PEDESTRIAN / BICYCLE ONLY						6 - OPIATES / OPIOIDS
99 - OTHER / UNKNOWN						7 - OTHER
						8 - NEGATIVE RESULTS

# OCCUPANT / WITNESS ADDENDUM

LOCAL REPORT NUMBER
2   0   1   9   3   5   5   5

OCCUPANT	UNIT # 2	NAME: LAST, FIRST, MIDDLE PHILSTEAD MEGAN NICOLE	DATE OF BIRTH 1   0   3   1   1   9   8   7	AGE 3   1	GENDER F
	ADDRESS: STREET, CITY, STATE, ZIP 7460 BRECKSVILLE RD INDEPENDENCE OH 44131		CONTACT PHONE - INCLUDE AREA CODE 2   1   6   9   5   2   5   1   4   5		
	INJURIES 5	INJURED TAKEN BY	EMS AGENCY (NAME)	INJURED TAKEN TO: MEDICAL FACILITY (NAME, CITY)	SAFETY EQUIPMENT USED 0   4

OCCUPANT	UNIT # 2	NAME: LAST, FIRST, MIDDLE PHILSTEAD SAVANNAH	DATE OF BIRTH 1   1   1   6   2   0   1   6	AGE 2	GENDER F
	ADDRESS: STREET, CITY, STATE, ZIP 4106 E. 71 CLEVELAND OH 44124		CONTACT PHONE - INCLUDE AREA CODE		
	INJURIES 5	INJURED TAKEN BY	EMS AGENCY (NAME)	INJURED TAKEN TO: MEDICAL FACILITY (NAME, CITY)	SAFETY EQUIPMENT USED 0   5

OCCUPANT	UNIT #	NAME: LAST, FIRST, MIDDLE	DATE OF BIRTH	AGE	GENDER
	ADDRESS: STREET, CITY, STATE, ZIP		CONTACT PHONE - INCLUDE AREA CODE		
	INJURIES	INJURED TAKEN BY	EMS AGENCY (NAME)	INJURED TAKEN TO: MEDICAL FACILITY (NAME, CITY)	SAFETY EQUIPMENT USED

OCCUPANT	UNIT #	NAME: LAST, FIRST, MIDDLE	DATE OF BIRTH	AGE	GENDER
	ADDRESS: STREET, CITY, STATE, ZIP		CONTACT PHONE - INCLUDE AREA CODE		
	INJURIES	INJURED TAKEN BY	EMS AGENCY (NAME)	INJURED TAKEN TO: MEDICAL FACILITY (NAME, CITY)	SAFETY EQUIPMENT USED

INJURIES	SAFETY EQUIPMENT USED	SEATING POSITION	AIR BAG USAGE
1 - FATAL 2 - SUSPECTED SERIOUS INJURY 3 - SUSPECTED MINOR INJURY 4 - POSSIBLE INJURY 5 - NO APPARENT INJURY	1 - NONE USED - VEHICLE OCCUPANT 2 - SHOULDER BELT ONLY USED 3 - LAP BELT ONLY USED 4 - SHOULDER & LAP BELT USED 5 - CHILD RESTRAINT SYSTEM - FORWARD FACING 6 - CHILD RESTRAINT SYSTEM - REAR FACING 7 - BOOSTER SEAT 8 - HELMET USED 9 - PROTECTIVE PADS USED (ELBOWS, KNEES, ETC.) 10 - REFLECTIVE CLOTHING 11 - LIGHTING - PEDESTRIAN / BICYCLE ONLY 99 - OTHER / UNKNOWN	1 - FRONT - LEFT SIDE (MOTORCYCLE DRIVER) 2 - FRONT - MIDDLE 3 - FRONT - RIGHT SIDE 4 - SECOND - LEFT SIDE (MOTORCYCLE PASSENGER) 5 - SECOND - MIDDLE 6 - SECOND - RIGHT SIDE 7 - THIRD - LEFT SIDE (MOTORCYCLE SIDE CAR) 8 - THIRD - MIDDLE 9 - THIRD - RIGHT SIDE 10 - SLEEPER SECTION OF TRUCK CAB 11 - PASSENGER IN OTHER ENCLOSED CARGO AREA (NON-TRAILING UNIT, BUS, PICK-UP WITH CAP) 12 - PASSENGER IN UNENCLOSED CARGO AREA 13 - TRAILING UNIT 14 - RIDING ON VEHICLE EXTERIOR (NON-TRAILING UNIT) 15 - NON-MOTORIST 99 - OTHER / UNKNOWN	1 - NOT DEPLOYED 2 - DEPLOYED FRONT 3 - DEPLOYED SIDE 4 - DEPLOYED BOTH FRONT/SIDE 5 - NOT APPLICABLE 9 - DEPLOYMENT UNKNOWN
INJURED TAKEN BY		EJECTION	
1 - NOT TRANSPORTED / TREATED AT SCENE 2 - EMS 3 - POLICE 9 - OTHER / UNKNOWN		1 - NOT EJECTED 2 - PARTIALLY EJECTED 3 - TOTALLY EJECTED 4 - NOT APPLICABLE	
GENDER		TRAPPED	
F - FEMALE M - MALE U - OTHER/UNKNOWN		1 - NOT TRAPPED 2 - EXTRICATED BY MECHANICAL MEANS 3 - FREED BY NON-MECHANICAL MEANS	

WITNESS	NAME: LAST, FIRST, MIDDLE	DATE OF BIRTH	AGE	GENDER
	ADDRESS: STREET, CITY, STATE, ZIP	CONTACT PHONE - INCLUDE AREA CODE		

WITNESS	NAME: LAST, FIRST, MIDDLE	DATE OF BIRTH	AGE	GENDER
	ADDRESS: STREET, CITY, STATE, ZIP	CONTACT PHONE - INCLUDE AREA CODE		

WITNESS	NAME: LAST, FIRST, MIDDLE	DATE OF BIRTH	AGE	GENDER
	ADDRESS: STREET, CITY, STATE, ZIP	CONTACT PHONE - INCLUDE AREA CODE		