

# TRAFFIC CRASH REPORT

\*DENOTES MANDATORY FIELD FOR SUPPLEMENT REPORT

LOCAL REPORT NUMBER \*

2 | 0 | 1 | 9 | 4 | 3 | 4 | 5 |

PHOTOS TAKEN     OH-2     OH-3  
 SECONDARY CRASH     OH-1P     OTHER  
 Private Property

LOCAL INFORMATION  
 REPORTING AGENCY NAME \*  
**GARFIELD HEIGHTS**    NCIC \*  
 0 | 1 | 8 | 2 | 0

HIT/SKIP  
 1 - Solved    NUMBER OF UNITS  
 2 - Unsolved    0 | 2  
 UNIT IN ERROR  
 98 - ANIMAL    0 | 2  
 99 - UNKNOWN

COUNTY \*  
 1 | 8  
 LOCALITY \*  
 1

LOCATION: CITY, VILLAGE, TOWNSHIP \*  
**GARFIELD HTS**

CRASH DATE/TIME \*  
 1 | 2 | 2 | 6 | 2 | 0 | 1 | 9 | 1 | 6 | 5 | 3 |

CRASH SEVERITY  
 5  
 1 - FATAL  
 2 - SERIOUS INJURY SUSPECTED  
 3 - MINOR INJURY SUSPECTED  
 4 - INJURY POSSIBLE  
 5 - PROPERTY DAMAGE ONLY

ROUTE TYPE    ROUTE NUMBER    PREFIX  
 1 - NORTH  
 2 - SOUTH  
 3 - EAST  
 4 - WEST

LOCATION ROAD NAME  
**VALLEY RANCH**    ROAD TYPE  
 D | R

LATITUDE DECIMAL DEGREES  
 4 | 1 | . | 3 | 8 | 9 | 7 | 8 | 0 |

ROUTE TYPE    ROUTE NUMBER    PREFIX  
 1 - NORTH  
 2 - SOUTH  
 3 - EAST  
 4 - WEST

REFERENCE ROAD NAME (ROAD, MILEPOST, HOUSE #)  
**6421**    ROAD TYPE

LONGITUDE DECIMAL DEGREES  
 8 | 1 | . | 5 | 8 | 6 | 6 | 3 | 0 |

REFERENCE POINT  
 1 - INTERSECTION  
 2 - MILE POST  
 3 - HOUSE #  
 3

ROUTE TYPE    ROUTE TYPE    ROAD TYPE  
 IR - INTERSTATE ROUTE (TP)  
 US - FEDERAL US ROUTE  
 SR - STATE ROUTE  
 CR - NUMBERED COUNTY ROUTE  
 TR - NUMBERED TOWNSHIP ROUTE  
 AL - ALLEY    HW - HIGHWAY    RD - ROAD  
 AV - AVENUE    LA - LANE    SQ - SQUARE  
 BL - BOULEVARD    MP - MILEPOST    ST - STREET  
 CR - CIRCLE    OV - OVAL    TE - TERRACE  
 CT - COURT    PK - PARKWAY    TL - TRAIL  
 DR - DRIVE    PI - PIKE    WA - WAY  
 HE - HEIGHTS    PL - PLACE

INTERSECTION RELATED  
 WITHIN INTERSECTION OR ON APPROACH  
 WITHIN INTERCHANGE AREA    NUMBER OF APPROACHES

DISTANCE FROM REFERENCE  
 DISTANCE UNIT OF MEASURE  
 1 - Miles  
 2 - Feet  
 3 - Yards

ROADWAY  
 ROADWAY DIVIDED

LOCATION OF FIRST HARMFUL EVENT  
 0 | 1  
 1 - ON ROADWAY  
 2 - ON SHOULDER  
 3 - IN MEDIAN  
 4 - ON ROADSIDE  
 5 - ON GORE  
 6 - OUTSIDE TRAFFICWAY  
 7 - ON RAMP  
 8 - OFF RAMP  
 9 - CROSSOVER  
 10 - DRIVEWAY / ALLEY ACCESS  
 11 - RAILWAY GRADE CROSSING  
 12 - SHARED USE PATHS OR TRAILS  
 13 - BIKE LANE  
 14 - TOLL BOOTH  
 99 - OTHER / UNKNOWN

MANNER OF CRASH COLLISION/IMPACT  
 1  
 1 - NOT COLLISION BETWEEN TWO MOTOR VEHICLES IN TRANSPORT  
 2 - REAR-END  
 3 - HEAD-ON  
 4 - REAR-TO-REAR  
 5 - BACKING  
 6 - ANGLE  
 7 - SIDESWIPE, SAME DIRECTION  
 8 - SIDESWIPE, OPPOSITE DIRECTION  
 9 - OTHER / UNKNOWN

DIRECTION OF TRAVEL  
 1 - NORTH  
 2 - SOUTH  
 3 - EAST  
 4 - WEST

MEDIAN TYPE  
 1 - DIVIDED FLUSH MEDIAN (<4 FEET)  
 2 - DIVIDED FLUSH MEDIAN (≥4 FEET)  
 3 - DIVIDED, DEPRESSION MEDIAN (ANY TYPE)  
 4 - DIVIDED, RAISED MEDIAN (ANY TYPE)  
 9 - OTHER / UNKNOWN

WORK ZONE RELATED  
 WORKERS PRESENT  
 LAW ENFORCEMENT PRESENT  
 ACTIVE SCHOOL ZONE

WORK ZONE TYPE  
 1 - LANE CLOSURE  
 2 - LANE SHIFT/CROSSOVER  
 3 - WORK ON SHOULDER OR MEDIAN  
 4 - INTERMITTENT OR MOVING WORK  
 5 - OTHER

LOCATION OF CRASH IN WORK ZONE  
 1 - BEFORE THE 1ST WORK ZONE WARNING SIGN  
 2 - ADVANCE WARNING AREA  
 3 - TRANSITION AREA  
 4 - ACTIVITY AREA  
 5 - TERMINATION AREA

CONTOUR  
 1  
 1 - STRAIGHT LEVEL  
 2 - STRAIGHT GRADE  
 3 - CURVE LEVEL  
 4 - CURVE GRADE  
 9 - OTHER / UNKNOWN

CONDITIONS  
 1  
 1 - DRY  
 2 - WET  
 3 - SNOW  
 4 - ICE  
 5 - SAND, MUD, DIRT, OIL, GRAVEL  
 6 - WATER (STANDING, MOVING)  
 7 - SLUSH  
 9 - OTHER/UNKNOWN

SURFACE  
 2  
 1 - CONCRETE  
 2 - BLACKTOP, BITUMINOUS, ASPHALT  
 3 - BRICK/BLOCK  
 4 - SLAG, GRAVEL, STONE  
 5 - DIRT  
 9 - OTHER / UNKNOWN

LIGHT CONDITION  
 3  
 1 - DAYLIGHT  
 2 - DAWN/DUSK  
 3 - DARK - LIGHTED ROADWAY  
 4 - DARK - ROADWAY NOT LIGHTED  
 5 - DARK - UNKNOWN ROADWAY LIGHTING  
 9 - OTHER / UNKNOWN

WEATHER  
 1  
 1 - CLEAR  
 2 - CLOUDY  
 3 - FOG, SMOG, SMOKE  
 4 - RAIN  
 5 - SLEET, HAIL  
 6 - SNOW  
 7 - SEVERE CROSSWINDS  
 8 - BLOWING SAND, SOIL, DIRT, SNOW  
 9 - FREEZING RAIN OR FREEZING DRIZZLE  
 99 - OTHER / UNKNOWN

INDICATE THE NORTH DIRECTION WITH AN "N" ON THE COMPASS DIAGRAM.

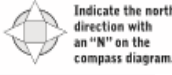

NARRATIVE  
 UNIT #2 WAS BACKING OUT OF THE DRIVEWAY AT 6421 VALLEY RANCH. UNIT #2 THEN STRUCK UNIT #1 THAT WAS PARKED ON THE STREET.

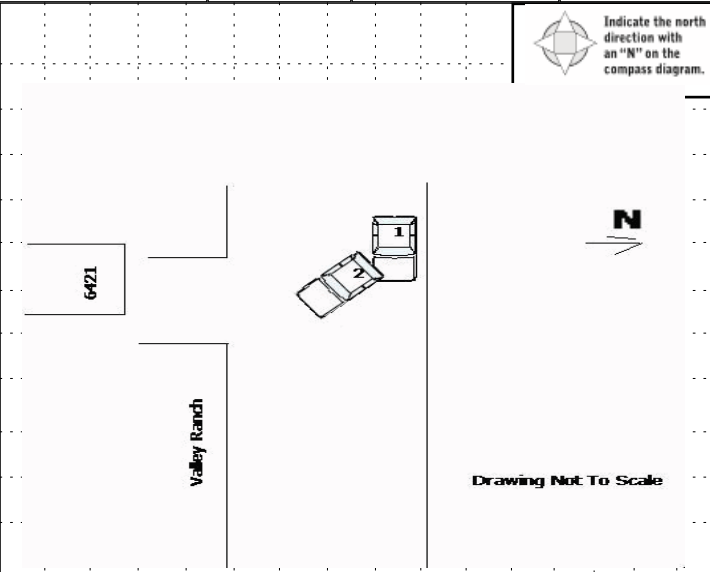

CRASH REPORTED DATE/TIME  
 1 | 2 | 2 | 6 | 2 | 0 | 1 | 9 | 1 | 6 | 5 | 3 |

DISPATCH DATE/TIME  
 1 | 2 | 2 | 6 | 2 | 0 | 1 | 9 | 1 | 6 | 5 | 5 |

ARRIVAL DATE/TIME  
 1 | 2 | 2 | 6 | 2 | 0 | 1 | 9 | 1 | 7 | 0 | 1 |

SCENE CLEARED DATE/TIME  
 1 | 2 | 2 | 6 | 2 | 0 | 1 | 9 | 1 | 7 | 1 | 3 |

REPORT TAKEN BY  
 POLICE AGENCY  
 MOTORIST

TOTAL TIME ROADWAY CLOSED  
 0

OTHER INVESTIGATION TIME  
 2 | 0

TOTAL MINUTES  
 3 | 2

OFFICER'S NAME \*  
**E. Cornell**  
 OFFICER'S BADGE NUMBER\*  
 0 | 2 | 4

CHECKED BY OFFICER'S NAME\*  
**M. Kaye**  
 CHECKED BY OFFICER'S BADGE NUMBER\*  
 D | C | 1

SUPPLEMENT (CORRECTION IN ADDITION)

2 0 1 9 4 3 4 5

**UNIT #** 0 1 **OWNER NAME: LAST, FIRST, MIDDLE** ( ) Same As Driver  
**MELENDEZ SENAIDA**  
**OWNER PHONE: INCLUDE AREA CODE** ( ) Same As Driver

**OWNER ADDRESS: STREET, CITY, STATE, ZIP** ( ) Same As Driver  
**9920 ALEXANDER GARFIELD HTS OH 44125**  
**COMMERCIAL CARRIER: NAME, ADDRESS, CITY, STATE, ZIP**  
**COMMERCIAL CARRIER PHONE: INCLUDE AREA CODE**

**DAMAGE**

**DAMAGE SCALE**

1 - NONE  
 2 - MINOR DAMAGE  
 3 - FUNCTIONAL DAMAGE  
 4 - DISABLING DAMAGE  
 9 - UNKNOWN

2

**LP STATE** OH **LICENSE PLATE #** HXH6961 **VEHICLE IDENTIFICATION #** 2HGEJ616761WH5815862 **VEHICLE YEAR** 1998 **VEHICLE MAKE** Honda

**INSURANCE VERIFIED** **INSURANCE COMPANY** STATE FARM **INSURANCE POLICY #** C375437-E01-55 **VEHICLE COLOR** GRY **VEHICLE MODEL** Civic

**TYPE OF USE**  
 COMMERCIAL  GOVERNMENT  IN EMERGENCY RESPONSE

**US DOT #** **TOWED BY: COMPANY NAME**

**INTERLOCK DEVICE EQUIPPED**  **HIT/SKIP UNIT**  **# OCCUPANTS** **VEHICLE WEIGHT GVWR/GCWR**  
 1 - ≤10K LBS.  
 2 - 10,001 - 26K LBS.  
 3 - >26K LBS.

**HAZARDOUS MATERIAL**  
 MATERIAL RELEASED **CLASS #** **PLACARD ID #**  
 PLACARD

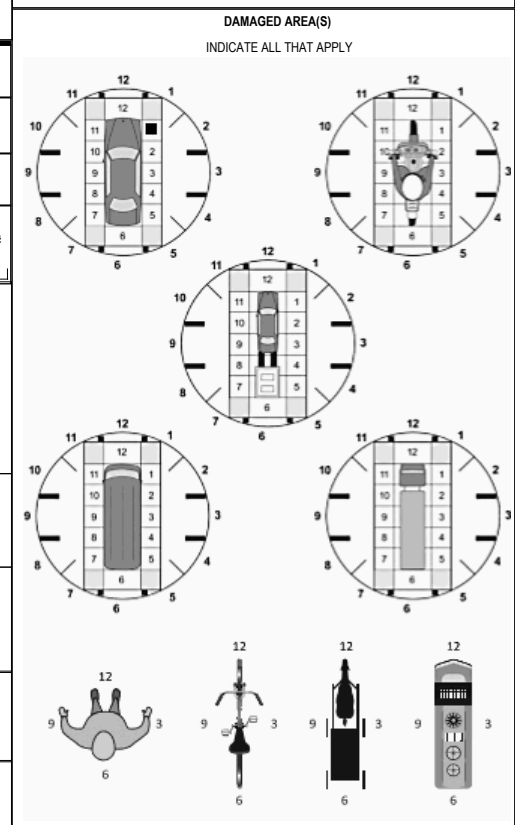

**UNIT TYPE** 0 1

1 - PASSENGER CAR 7 - MOTORCYCLE 2-WHEELED 12 - GOLF CART 18 - LIMO (LIVERY VEHICLE) 23 - PEDESTRIAN/SKATER  
 2 - PASSENGER VAN (MINIVAN) 8 - MOTORCYCLE 3-WHEELED 13 - SNOWMOBILE 19 - BUS (16+ PASSENGERS) 24 - WHEELCHAIR (ANY TYPE)  
 3 - SPORT UTILITY VEHICLE 9 - AUTOCYCLE 14 - SINGLE UNIT TRUCK 20 - OTHER VEHICLE 25 - OTHER NON-MOTORIST  
 4 - PICK UP 10 - MOPED OR MOTORIZED BICYCLE 15 - SEMI-TRACTOR 21 - HEAVY EQUIPMENT 26 - BICYCLE  
 5 - CARGO VAN 11 - ALL TERRAIN VEHICLE (ATV / UTV) 16 - FARM EQUIPMENT 22 - ANIMAL WITH RIDER OR ANIMAL-DRAWN VEHICLE 27 - TRAIN  
 6 - VAN (9-15 SEATS) 17 - MOTORHOME

**# of TRAILING UNITS**

**WAS VEHICLE OPERATING IN AUTONOMOUS MODE WHEN CRASH OCCURRED?** 2  
 1 - YES 2 - NO 9 - OTHER / UNKNOWN

**AUTONOMOUS MODE LEVEL** 0  
 0 - NO AUTOMATION 1 - DRIVER ASSISTANCE 2 - PARTIAL AUTOMATION 3 - CONDITIONAL AUTOMATION 4 - HIGH AUTOMATION 5 - FULL AUTOMATION 9 - UNKNOWN

**SPECIAL FUNCTION** 0 1

1 - NONE 6 - BUS - CHARTER/TOUR 11 - FIRE 16 - FARM 21 - MAIL CARRIER  
 2 - TAXI 7 - BUS - INTERCITY 12 - MILITARY 17 - MOWING 22 - OTHER / UNKNOWN  
 3 - ELECTRONIC RIDE SHARING 8 - BUS - SHUTTLE 13 - POLICE 18 - SNOW REMOVAL N  
 4 - SCHOOL TRANSPORT 9 - BUS - OTHER 14 - PUBLIC UTILITY 19 - TOWING  
 5 - BUS-TRANSIT/COMMUTER 10 - AMBULANCE 15 - CONSTRUCTION EQUIPMENT 20 - SAFETY SERVICE PATROL

**CARGO BODY TYPE** 0 1

1 - NO CARGO BODY TYPE / NOT APPLICABLE 3 - VEHICLE TOWING ANOTHER MOTOR VEHICLE 5 - INTERMODAL CONTAINER CHASSIS 8 - POLE 12 - CONCRETE MIXER  
 2 - BUS 4 - LOGGING 6 - CARGO VAN/ENCLOSED BOX 9 - CARGO TANK 13 - AUTO TRANSPORTER  
 7 - GRAIN/CHIPS/GRAVEL 11 - DUMP 14 - GARBAGE/REFUSE 19 - TOWING 99 - OTHER / UNKNOWN

**VEHICLE DEFECTS**

1 - TURN SIGNALS 4 - BRAKES 7 - WORN OR SLICK TIRES 9 - MOTOR TROUBLE 99 - OTHER / UNKNOWN  
 2 - HEAD LAMPS 5 - STEERING 8 - TRAILER EQUIPMENT DEFECTIVE 10 - DISABLED FROM PRIOR ACCIDENT  
 3 - TAIL LAMPS 6 - TIRE BLOWOUT

**NON-MOTORIST LOCATION AT IMPACT**

1 - INTERSECTION - MARKED CROSSWALK 3 - INTERSECTION - OTHER 6 - BICYCLE LANE 9 - MEDIAN/CROSSING ISLAND 12 - FIRST RESPONDER OR LEAVING VEHICLE AT INCIDENT SCENE  
 2 - INTERSECTION - UNMARKED 4 - MIDLICK - MARKED CROSSWALK 7 - SHOULDER/ROADSIDE 10 - DRIVEWAY ACCESS 14 - GARBAGE/REFUSE 99 - OTHER / UNKNOWN  
 5 - TRAVEL LANE-OTHER LOCATION 8 - SIDEWALK 11 - SHARED USE PATHS OR TRAILS 19 - TOWING 99 - OTHER / UNKNOWN

**ACTION** 4 **PRE-CRASH ACTION** 1 0

1 - NON-CONTACT 1 - STRAIGHT AHEAD 7 - MAKING U-TURN 13 - NEGOTIATING A CURVE 18 - APPROACHING OR LEAVING VEHICLE OR LEAVING VEHICLE OR LEAVING VEHICLE  
 2 - NON-COLLISION 2 - BACKING 8 - ENTERING TRAFFIC LANE 14 - ENTERING OR CROSSING SPECIFIED LOCATION 19 - STANDING  
 3 - STRIKING 3 - CHANGING LANES 9 - LEAVING TRAFFIC LANE 15 - WALKING, RUNNING, JOGGING, PLAYING 20 - OTHER NON-MOTORIST  
 4 - STRUCK 4 - OVERTAKING/PASSING 10 - PARKED 16 - WORKING 21 - STANDING OUTSIDE DISABLED VEHICLE  
 5 - BOTH STRIKING & STRUCK 5 - MAKING RIGHT TURN 11 - SLOWING OR STOPPED IN TRAFFIC 17 - PUSHING VEHICLE 99 - OTHER / UNKNOWN  
 9 - OTHER / UNKNOWN 6 - MAKING LEFT TURN 12 - DRIVERLESS

**INITIAL POINT OF CONTACT**

0 1  
 0 - NO DAMAGE 14 - UNDERCARRIAGE  
 1-12 - REFER TO UNIT DIAGRAM 15 - VEHICLE NOT AT SCENE 99 - UNKNOWN

**CONTRIBUTING CIRCUMSTANCES** 0 1

1 - NONE 7 - LEFT OF CENTER 13 - IMPROPER START FROM A PARKED POSITION 17 - VISION OBSTRUCTION 21 - LYING IN ROADWAY  
 2 - FAILURE TO YIELD 8 - FOLLOWING TOO CLOSE/ACDA 14 - STOPPED OR PARKED ILLEGALLY 18 - OPERATING DEFECTIVE EQUIPMENT 22 - NOT DISCRERNABLE  
 3 - RAN RED LIGHT 9 - IMPROPER LANE CHANGING 15 - SWERVING TO AVOID 19 - LOAD SHIFTING/ FALLING/SPILLING 23 - OPENING DOOR INTO ROADWAY  
 4 - RAN STOP SIGN 10 - IMPROPER PASSING 16 - WRONG WAY 20 - IMPROPER CROSSING 99 - OTHER IMPROPER ACTION  
 5 - UNSAFE SPEED 11 - DROVE OFF ROAD 12 - IMPROPER BACKING  
 6 - IMPROPER TURN

**TRAFFIC**

**TRAFFICWAY FLOW** 2  
 1 - ONE-WAY  
 2 - TWO-WAY

**TRAFFIC CONTROL** 6  
 1 - ROUNDABOUT 4 - STOP SIGN  
 2 - SIGNAL 5 - YIELD SIGN  
 3 - FLASHER 6 - NO CONTROL

**SEQUENCE OF EVENTS**

**EVENTS**

1 2 0  
 1 - OVERTURN/ROLLOVER 6 - EQUIPMENT FAILURE 11 - CROSS CENTERLINE - OPPOSITE DIRECTION OF TRAVEL 16 - RAILWAY VEHICLE 22 - WORK ZONE MAINTENANCE EQUIPMENT  
 2 - FIRE/EXPLOSION 7 - SEPARATION OF UNITS 17 - ANIMAL - FARM 18 - ANIMAL - DEER 19 - ANIMAL - OTHER 20 - MOTOR VEHICLE IN TRANSPORT 21 - PARKED MOTOR VEHICLE 24 - OTHER MOVABLE  
 3 - IMMERSION 8 - RAN OFF ROAD RIGHT 9 - RAN OFF ROAD LEFT 10 - CROSS MEDIAN 12 - DOWNHILL RUNAWAY 13 - OTHER NON-COLLISION 14 - PEDESTRIAN 15 - PEDALCYCLE

**COLLISION WITH FIXED OBJECT - STRUCK**

25 - IMPACT ATTENUATOR / CRASH CUSHION 31 - GUARDRAIL END 37 - TRAFFIC SIGN POST 43 - CURB 50 - WORKZONE MAINTENANCE EQUIPMENT  
 26 - BRIDGE OVERHEAD STRUCTURE 32 - PORTABLE BARRIER 38 - OVERHEAD SIGN POST 44 - DITCH 51 - WALL  
 27 - BRIDGE PIER OR ABUTMENT 33 - MEDIAN CABLE BARRIER 39 - LIGHT/LUMINARIES SUPPORT 45 - EMBANKMENT 52 - BUILDING  
 28 - BRIDGE PARAPET 34 - MEDIAN GUARDRAIL BARRIER 40 - UTILITY POLE 46 - FENCE 53 - TUNNEL  
 29 - BRIDGE RAIL 35 - MEDIAN CONCRETE BARRIER 41 - OTHER POST, POLE OR SUPPORT 47 - MAILBOX 48 - TREE 54 - OTHER FIXED OBJECT  
 30 - GUARDRAIL FACE 36 - MEDIAN OTHER BARRIER 42 - CULVERT 49 - FIRE HYDRANT 99 - OTHER / UNKNOWN

1 **FIRST HARMFUL EVENT** 1 **MOST HARMFUL EVENT**

**# OF THROUGH LANES ON ROAD** 2

**RAIL GRADE CROSSING** 1  
 1 - NOT INVOLVED  
 2 - INVOLVED - ACTIVE CROSSING  
 3 - INVOLVED - PASSIVE CROSSING

**UNIT / NON-MOTORIST DIRECTION**

FROM 4 TO 3

1 - NORTH 5 - NORTHEAST  
 2 - SOUTH 6 - NORTHWEST  
 3 - EAST 7 - SOUTHEAST  
 4 - WEST 8 - SOUTHWEST

**UNIT SPEED** 0

**POSTED SPEED** 2 5

**DETECTED SPEED** 1  
 1 - STATED/ESTIMATED SPEED  
 2 - CALCULATED / EDR  
 3 - UNDETERMINED

<b>UNIT #</b> 0 2	<b>OWNER NAME: LAST, FIRST, MIDDLE</b> BATES AILEEN K ( Same As Driver)	<b>OWNER PHONE: INCLUDE AREA CODE</b> ( Same As Driver)
<b>OWNER ADDRESS: STREET, CITY, STATE, ZIP</b> 26065 CAMBRIDGE LN CLEVELAND OH 44128 ( Same As Driver)		
<b>COMMERCIAL CARRIER: NAME, ADDRESS, CITY, STATE, ZIP</b>		<b>COMMERCIAL CARRIER PHONE: INCLUDE AREA CODE</b>

<b>LP STATE</b> OH	<b>LICENSE PLATE #</b> HWM1793	<b>VEHICLE IDENTIFICATION #</b> 1GNK1VJ1E1D1B1J20164301	<b>VEHICLE YEAR</b> 2011	<b>VEHICLE MAKE</b> Chevrolet
<input type="checkbox"/> <b>INSURANCE VERIFIED</b>	<b>INSURANCE COMPANY</b>	<b>INSURANCE POLICY #</b>	<b>VEHICLE COLOR</b> CRM	<b>VEHICLE MODEL</b> Trailblazer
<input type="checkbox"/> <b>COMMERCIAL</b>	<input type="checkbox"/> <b>GOVERNMENT</b>	<input type="checkbox"/> <b>IN EMERGENCY RESPONSE</b>	<b>US DOT #</b>	
<input type="checkbox"/> <b>INTERLOCK DEVICE EQUIPPED</b>	<input type="checkbox"/> <b>HIT/SKIP UNIT</b>	<b># OCCUPANTS</b> 0 1	<b>VEHICLE WEIGHT GVWR/GCWR</b> 1 - ≤10K LBS. 2 - 10,001 - 26K LBS. 3 - >26K LBS.	
<b>TYPE OF USE</b>		<b>HAZARDOUS MATERIAL</b>		
<input type="checkbox"/> <b>COMMERCIAL</b> <input type="checkbox"/> <b>GOVERNMENT</b> <input type="checkbox"/> <b>IN EMERGENCY RESPONSE</b>		<input type="checkbox"/> <b>MATERIAL RELEASED</b> <b>CLASS #</b> <b>PLACARD ID #</b>		
<input type="checkbox"/> <b>INTERLOCK DEVICE EQUIPPED</b> <input type="checkbox"/> <b>HIT/SKIP UNIT</b>		<input type="checkbox"/> <b>PLACARD</b>		

<b>UNIT TYPE</b> 0 3	1 - PASSENGER CAR 2 - PASSENGER VAN (MINIVAN) 3 - SPORT UTILITY VEHICLE 4 - PICK UP 5 - CARGO VAN 6 - VAN (9-15 SEATS)	7 - MOTORCYCLE 2-WHEELED 8 - MOTORCYCLE 3-WHEELED 9 - AUTOCYCLE 10 - MOPED OR MOTORIZED BICYCLE 11 - ALL TERRAIN VEHICLE (ATV / UTV)	12 - GOLF CART 13 - SNOWMOBILE 14 - SINGLE UNIT TRUCK 15 - SEMI-TRACTOR 16 - FARM EQUIPMENT 17 - MOTORHOME	18 - LIMO (LIVERY VEHICLE) 19 - BUS (16+ PASSENGERS) 20 - OTHER VEHICLE 21 - HEAVY EQUIPMENT 22 - ANIMAL WITH RIDER OR ANIMAL-DRAWN VEHICLE	23 - PEDESTRIAN/SKATER 24 - WHEELCHAIR (ANY TYPE) 25 - OTHER NON-MOTORIST 26 - BICYCLE 27 - TRAIN 28 - UNKNOWN OR HIT/SKIP
<b># of TRAILING UNITS</b>					

<b>WAS VEHICLE OPERATING IN AUTONOMOUS MODE WHEN CRASH OCCURRED?</b> 2	1 - YES 2 - NO 9 - OTHER / UNKNOWN	<b>AUTONOMOUS MODE LEVEL</b> 0	0 - NO AUTOMATION 1 - DRIVER ASSISTANCE 2 - PARTIAL AUTOMATION 3 - CONDITIONAL AUTOMATION 4 - HIGH AUTOMATION 5 - FULL AUTOMATION	9 - UNKNOWN
---	------------------------------------	-----------------------------------	--	-------------

<b>SPECIAL FUNCTION</b> 0 1	1 - NONE 2 - TAXI 3 - ELECTRONIC RIDE SHARING 4 - SCHOOL TRANSPORT 5 - BUS-TRANSIT/COMMUTER	6 - BUS - CHARTER/TOUR 7 - BUS - INTERCITY 8 - BUS - SHUTTLE 9 - BUS - OTHER 10 - AMBULANCE	11 - FIRE 12 - MILITARY 13 - POLICE 14 - PUBLIC UTILITY 15 - CONSTRUCTION EQUIPMENT	16 - FARM 17 - MOWING 18 - SNOW REMOVAL 19 - TOWING 20 - SAFETY SERVICE PATROL	21 - MAIL CARRIER 22 - OTHER /UNKNOWN N
--------------------------------	---	---	---	--	---

<b>CARGO BODY TYPE</b> 0 1	1 - NO CARGO BODY TYPE / NOT APPLICABLE 2 - BUS	3 - VEHICLE TOWING ANOTHER MOTOR VEHICLE 4 - LOGGING	5 - INTERMODAL CONTAINER CHASSIS 6 - CARGO VAN/ENCLOSED BOX 7 - GRAIN/CHIPS/GRAVEL	8 - POLE 9 - CARGO TANK 10 - FLAT BED 11 - DUMP	12 - CONCRETE MIXER 13 - AUTO TRANSPORTER 14 - GARBAGE/REFUSE 15 - OTHER / UNKNOWN
-------------------------------	--	---	--	--	---

<b>VEHICLE DEFECTS</b>	1 - TURN SIGNALS 2 - HEAD LAMPS 3 - TAIL LAMPS	4 - BRAKES 5 - STEERING 6 - TIRE BLOWOUT	7 - WORN OR SLICK TIRES 8 - TRAILER EQUIPMENT DEFECTIVE	9 - MOTOR TROUBLE 10 - DISABLED FROM PRIOR ACCIDENT	99 - OTHER / UNKNOWN
------------------------	--	--	--	--	----------------------

<b>NON-MOTORIST LOCATION AT IMPACT</b> 0 1	1 - INTERSECTION - MARKED CROSSWALK 2 - INTERSECTION - UNMARKED	3 - INTERSECTION - OTHER 4 - MIDBLOCK - MARKED CROSSWALK 5 - TRAVEL LANE-OTHER LOCATION	6 - BICYCLE LANE 7 - SHOULDER/ROADSIDE 8 - SIDEWALK	9 - MEDIAN/CROSSING ISLAND 10 - DRIVEWAY ACCESS 11 - SHARED USE PATHS OR TRAILS	12 - FIRST RESPONDER AT INCIDENT SCENE 99 - OTHER / UNKNOWN
---	--	---	---	---	--

<b>ACTION</b> 0 2	1 - NON-CONTACT 2 - NON-COLLISION 3 - STRIKING 4 - STRUCK 5 - BOTH STRIKING & STRUCK 9 - OTHER / UNKNOWN	<b>PRE-CRASH ACTION</b> 0 2	1 - STRAIGHT AHEAD 2 - BACKING 3 - CHANGING LANES 4 - OVERTAKING/PASSING 5 - MAKING RIGHT TURN 6 - MAKING LEFT TURN	7 - MAKING U-TURN 8 - ENTERING TRAFFIC LANE 9 - LEAVING TRAFFIC LANE 10 - PARKED 11 - SLOWING OR STOPPED IN TRAFFIC 12 - DRIVERLESS	13 - NEGOTIATING A CURVE 14 - ENTERING OR CROSSING SPECIFIED LOCATION 15 - WALKING, RUNNING, JOGGING, PLAYING 16 - WORKING 17 - PUSHING VEHICLE	18 - APPROACHING OR LEAVING VEHICLE 19 - STANDING 20 - OTHER NON-MOTORIST 21 - STANDING OUTSIDE DISABLED VEHICLE 99 - OTHER / UNKNOWN
----------------------	---	--------------------------------	--	--	---	---

<b>CONTRIBUTING CIRCUMSTANCES</b> 1 2	1 - NONE 2 - FAILURE TO YIELD 3 - RAN RED LIGHT 4 - RAN STOP SIGN 5 - UNSAFE SPEED 6 - IMPROPER TURN	7 - LEFT OF CENTER 8 - FOLLOWING TOO CLOSE/ACDA 9 - IMPROPER LANE CHANGING 10 - IMPROPER PASSING 11 - DROVE OFF ROAD 12 - IMPROPER BACKING	13 - IMPROPER START FROM A PARKED POSITION 14 - STOPPED OR PARKED ILLEGALLY 15 - SWERVING TO AVOID 16 - WRONG WAY	17 - VISION OBSTRUCTION 18 - OPERATING DEFECTIVE EQUIPMENT 19 - LOAD SHIFTING/ FALLING/SPILLING 20 - IMPROPER CROSSING	21 - LYING IN ROADWAY 22 - NOT DISCERNABLE 23 - OPENING DOOR INTO ROADWAY 99 - OTHER IMPROPER ACTION
--	---	---	--	---	---

<b>SEQUENCE OF EVENTS</b>	<b>EVENTS</b>
1 2 1	1 - OVERTURN/ROLLOVER 2 - FIRE/EXPLOSION 3 - IMMERSION 4 - JACKKNIFE 5 - CARGO / EQUIPMENT LOSS OR SHIFT
2	6 - EQUIPMENT FAILURE 7 - SEPARATION OF UNITS 8 - RAN OFF ROAD RIGHT 9 - RAN OFF ROAD LEFT 10 - CROSS MEDIAN
3	11 - CROSS CENTERLINE - OPPOSITE DIRECTION OF TRAVEL 12 - DOWNHILL RUNAWAY 13 - OTHER NON-COLLISION 14 - PEDESTRIAN 15 - PEDALCYCLE
4	16 - RAILWAY VEHICLE 17 - ANIMAL - FARM 18 - ANIMAL - DEER 19 - ANIMAL - OTHER 20 - MOTOR VEHICLE IN TRANSPORT 21 - PARKED MOTOR VEHICLE
5	22 - WORK ZONE MAINTENANCE EQUIPMENT 23 - STRUCK BY FALLING, SHIFTING CARGO OR ANYTHING SET IN MOTION BY A MOTOR VEHICLE 24 - OTHER MOVABLE

<b>COLLISION WITH FIXED OBJECT - STRUCK</b>					
25 - IMPACT ATTENUATOR / CRASH CUSHION	31 - GUARDRAIL END	37 - TRAFFIC SIGN POST	43 - CURB	50 - WORKZONE MAINTENANCE EQUIPMENT	
26 - BRIDGE OVERHEAD STRUCTURE	32 - PORTABLE BARRIER	38 - OVERHEAD SIGN POST	44 - DITCH	51 - WALL	
27 - BRIDGE PIER OR ABUTMENT	33 - MEDIAN CABLE BARRIER	39 - LIGHT/LUMINARIES SUPPORT	45 - EMBANKMENT	52 - BUILDING	
28 - BRIDGE PARAPET	34 - MEDIAN GUARDRAIL BARRIER	40 - UTILITY POLE	46 - FENCE	53 - TUNNEL	
29 - BRIDGE RAIL	35 - MEDIAN CONCRETE BARRIER	41 - OTHER POST, POLE OR SUPPORT	47 - MAILBOX	54 - OTHER FIXED OBJECT	
30 - GUARDRAIL FACE	36 - MEDIAN OTHER BARRIER	42 - CULVERT	48 - TREE	99 - OTHER / UNKNOWN	
49 - FIRE HYDRANT					
<b>FIRST HARMFUL EVENT</b> 1	<b>MOST HARMFUL EVENT</b> 1				

LOCAL REPORT NUMBER  
2 0 1 9 4 3 4 5

<b>DAMAGE</b>
<b>DAMAGE SCALE</b>
2
1 - NONE 2 - MINOR DAMAGE 3 - FUNCTIONAL DAMAGE 4 - DISABLING DAMAGE 9 - UNKNOWN

<b>DAMAGED AREA(S)</b> INDICATE ALL THAT APPLY
<input type="checkbox"/> - NO DAMAGE [0] <input type="checkbox"/> - UNDERCARRIAGE [14] <input type="checkbox"/> - TOP [13] <input type="checkbox"/> - ALL AREAS [15] <input type="checkbox"/> - UNIT NOT AT SCENE [16]

<b>INITIAL POINT OF CONTACT</b>
0 7
0 - NO DAMAGE 1-12 - REFER TO UNIT DIAGRAM 14 - UNDERCARRIAGE 15 - VEHICLE NOT AT SCENE 99 - UNKNOWN

<b>TRAFFIC</b>	
<b>TRAFFICWAY FLOW</b>	<b>TRAFFIC CONTROL</b>
2	6
1 - ONE-WAY 2 - TWO-WAY	1 - ROUNDABOUT 4 - STOP SIGN 2 - SIGNAL 5 - YIELD SIGN 3 - FLASHER 6 - NO CONTROL

<b># of THROUGH LANES ON ROAD</b>	<b>RAIL GRADE CROSSING</b>
2	1
	1 - NOT INVOLVED 2 - INVOLVED - ACTIVE CROSSING 3 - INVOLVED - PASSIVE CROSSING

<b>UNIT / NON-MOTORIST DIRECTION</b>
FROM 2 TO 1
1 - NORTH 5 - NORTHEAST 2 - SOUTH 6 - NORTHWEST 3 - EAST 7 - SOUTHEAST 4 - WEST 8 - SOUTHWEST

<b>UNIT SPEED</b>	<b>DETECTED SPEED</b>
1 0	1
	1 - STATED/ESTIMATED SPEED 2 - CALCULATED / EDR 3 - UNDETERMINED

<b>POSTED SPEED</b>
2 5

# MOTORIST / NON-MOTORIST

LOCAL REPORT NUMBER  
2 0 1 9 4 3 4 5

UNIT # 0 2	NAME: LAST, FIRST, MIDDLE BATES AILEEN K		DATE OF BIRTH 0 4 1 2 1 9 6 3		AGE 5 6	GENDER F				
ADDRESS: STREET, CITY, STATE, ZIP 26065 CAMBRIDGE LN CLEVELAND OH 44128					CONTACT PHONE - INCLUDE AREA CODE					
INJURIES 5	INJURED TAKEN BY	EMS AGENCY (NAME)	INJURED TAKEN TO: MEDICAL FACILITY (NAME, CITY)	SAFETY EQUIPMENT USED 0 4	DOT-COMPLIANT MC HELMET	SEATING POSITION 0 1	AIR BAG USAGE 1	EJECTION 1	TRAPPED 1	
OL STATE OH	OPERATOR LICENSE NUMBER	OFFENSE CHARGED	LOCAL CODE	OFFENSE DESCRIPTION	CITATION NUMBER					
OL CLASS 4	ENDORSEMENT SELECT UP TO 2	RESTRICTION SELECT UP TO 3	DRIVER DISTRACTED BY 1	ALCOHOL / DRUG SUSPECTED <input type="checkbox"/> ALCOHOL <input type="checkbox"/> MARIJUANA <input type="checkbox"/> OTHER DRUG	CONDITION 1	STATUS 1	ALCOHOL TEST TYPE VALUE STATUS TYPE RESULT SELECT UP TO 4	DRUG TEST(S)		

UNIT #	NAME: LAST, FIRST, MIDDLE		DATE OF BIRTH		AGE	GENDER				
ADDRESS: STREET, CITY, STATE, ZIP					CONTACT PHONE - INCLUDE AREA CODE					
INJURIES	INJURED TAKEN BY	EMS AGENCY (NAME)	INJURED TAKEN TO: MEDICAL FACILITY (NAME, CITY)	SAFETY EQUIPMENT USED	DOT-COMPLIANT MC HELMET	SEATING POSITION	AIR BAG USAGE	EJECTION	TRAPPED	
OL STATE	OPERATOR LICENSE NUMBER	OFFENSE CHARGED	LOCAL CODE	OFFENSE DESCRIPTION	CITATION NUMBER					
OL CLASS	ENDORSEMENT SELECT UP TO 2	RESTRICTION SELECT UP TO 3	DRIVER DISTRACTED BY	ALCOHOL / DRUG SUSPECTED ALCOHOL MARIJUANA OTHER DRUG	CONDITION	STATUS	ALCOHOL TEST TYPE VALUE STATUS TYPE RESULT SELECT UP TO 4	DRUG TEST(S)		

UNIT #	NAME: LAST, FIRST, MIDDLE		DATE OF BIRTH		AGE	GENDER				
ADDRESS: STREET, CITY, STATE, ZIP					CONTACT PHONE - INCLUDE AREA CODE					
INJURIES	INJURED TAKEN BY	EMS AGENCY (NAME)	INJURED TAKEN TO: MEDICAL FACILITY (NAME, CITY)	SAFETY EQUIPMENT USED	DOT-COMPLIANT MC HELMET	SEATING POSITION	AIR BAG USAGE	EJECTION	TRAPPED	
OL STATE	OPERATOR LICENSE NUMBER	OFFENSE CHARGED	LOCAL CODE	OFFENSE DESCRIPTION	CITATION NUMBER					
OL CLASS	ENDORSEMENT SELECT UP TO 2	RESTRICTION SELECT UP TO 3	DRIVER DISTRACTED BY	ALCOHOL / DRUG SUSPECTED ALCOHOL MARIJUANA OTHER DRUG	CONDITION	STATUS	ALCOHOL TEST TYPE VALUE STATUS TYPE RESULT SELECT UP TO 4	DRUG TEST(S)		

INJURIES	SEATING POSITION	AIR BAG	OL CLASS	OL RESTRICTION(S)	DRIVER DISTRACTION	TEST STATUS
1 - FATAL	1 - FRONT - LEFT SIDE (MOTORCYCLE DRIVER)	1 - NOT DEPLOYED	1 - CLASS A	1 - ALCOHOL INTERLOCK DEVICE	1 - NOT DISTRACTED	1 - NONE GIVEN
2 - SUSPECTED SERIOUS INJURY	2 - FRONT - MIDDLE	2 - DEPLOYED FRONT	2 - CLASS B	2 - CDL INTRASTATE ONLY	2 - MANUALLY OPERATING AN ELECTRONIC COMMUNICATION DEVICE (TEXTING, TYPING, DIALING)	2 - TEST REFUSED
3 - SUSPECTED MINOR INJURY	3 - FRONT - RIGHT SIDE	3 - DEPLOYED SIDE	3 - CLASS C	3 - CORRECTIVE LENSES	3 - TALKING ON HANDS-FREE COMMUNICATION DEVICE	3 - TEST GIVEN, CONTAMINATED SAMPLE / UNUSABLE
4 - POSSIBLE INJURY	4 - SECOND - LEFT SIDE (MOTORCYCLE PASSENGER)	4 - DEPLOYED BOTH FRONT / SIDE	4 - REGULAR CLASS (OHIO = D)	4 - FARM WAIVER	4 - TALKING ON HAND-HELD COMMUNICATION DEVICE	4 - TEST GIVEN, RESULTS KNOWN
5 - NO APPARENT INJURY	5 - SECOND - MIDDLE	5 - NOT APPLICABLE	5 - M / C MOPED ONLY	5 - EXCEPT CLASS A BUS & CLASS B BUS	5 - OTHER ACTIVITY WITH AN ELECTRONIC DEVICE	5 - TEST GIVEN, RESULTS UNKNOWN
<b>INJURED TAKEN BY</b>		6 - SECOND - RIGHT SIDE	6 - NO VALID OL	6 - EXCEPT CLASS A & CLASS B BUS	6 - PASSENGER	<b>ALCOHOL TEST TYPE</b>
1 - NOT TRANSPORTED / TREATED AT SCENE	7 - THIRD - LEFT SIDE (MOTORCYCLE SIDE CAR)	9 - DEPLOYMENT UNKNOWN	<b>EJECTION</b>	7 - EXCEPT TRACTOR-TRAILER	7 - OTHER DISTRACTION INSIDE THE VEHICLE	1 - NONE
2 - EMS	8 - THIRD - MIDDLE	<b>EJECTION</b>	1 - NOT EJECTED	8 - INTERMEDIATE LICENSE RESTRICTIONS	8 - OTHER DISTRACTIONS OUTSIDE THE VEHICLE	2 - BLOOD
3 - POLICE	9 - THIRD - RIGHT SIDE	2 - PARTIALLY EJECTED	H - HAZMAT	9 - LEARNER'S PERMIT RESTRICTIONS	9 - OTHER / UNKNOWN	3 - URINE
9 - OTHER / UNKNOWN	10 - SLEEPER SECTION OF TRUCK CAB	3 - TOTALLY EJECTED	M - MOTORCYCLE	10 - LIMITED TO DAYLIGHT ONLY	<b>CONDITION</b>	4 - BREATH
<b>SAFETY EQUIPMENT</b>		4 - NOT APPLICABLE	P - PASSENGER	11 - LIMITED TO EMPLOYMENT	1 - APPARENTLY NORMAL	<b>DRUG TEST TYPE</b>
1 - NONE USED	11 - PASSENGER IN OTHER ENCLOSED CARGO AREA (NON-TRAILING UNIT, BUS, PICK-UP WITH CAP)	4 - NOT APPLICABLE	N - TANKER	12 - LIMITED - OTHER	2 - PHYSICAL IMPAIRMENT	1 - NONE
2 - SHOULDER BELT ONLY USED	12 - PASSENGER IN UNENCLOSED CARGO AREA	<b>TRAPPED</b>	Q - MOTOR SCOOTER	13 - MECHANICAL DEVICES (SPECIAL BRAKES, HAND CONTROLS, OR OTHER ADAPTIVE DEVICES)	3 - EMOTIONAL (E.G. DEPRESSED, ANGRY, DISTURBED)	2 - BLOOD
3 - LAP BELT ONLY USED	13 - TRAILING UNIT	1 - NOT TRAPPED	R - THREE-WHEEL MOTORCYCLE	14 - MILITARY VEHICLES ONLY	4 - ILLNESS	3 - URINE
4 - SHOULDER & LAP BELT USED	14 - RIDING ON VEHICLE EXTERIOR (NON-TRAILING UNIT)	2 - EXTRICATED BY MECHANICAL MEANS	S - SCHOOL BUS	15 - MOTOR VEHICLES WITHOUT AIR BRAKES	5 - FELL ASLEEP, FAINTED, FATIGUED, ETC.	4 - OTHER
5 - CHILD RESTRAINT SYSTEM - FORWARD FACING	15 - NON-MOTORIST	3 - FREED BY NON-MECHANICAL MEANS	T - DOUBLE & TRIPLE TRAILERS	16 - OUTSIDE MIRROR	6 - UNDER THE INFLUENCE OF MEDICATIONS / DRUGS / ALCOHOL	<b>DRUG TEST RESULT(S)</b>
6 - CHILD RESTRAINT SYSTEM - REAR FACING	99 - OTHER / UNKNOWN		X - TANKER / HAZMAT	17 - PROSTHETIC AID	9 - OTHER / UNKNOWN	1 - AMPHETAMINES
7 - BOOSTER SEAT			<b>GENDER</b>	18 - OTHER		2 - BARBITURATES
8 - HELMET USED			F - FEMALE			3 - BENZODIAZEPINES
9 - PROTECTIVE PADS USED (ELBOWS, KNEES, ETC.)			M - MALE			4 - CANNABINOIDS
10 - REFLECTIVE CLOTHING			U - OTHER/UNKNOWN			5 - COCAINE
11 - LIGHTING - PEDESTRIAN / BICYCLE ONLY						6 - OPIATES / OPIOIDS
99 - OTHER / UNKNOWN						7 - OTHER
						8 - NEGATIVE RESULTS