

TRAFFIC CRASH REPORT

*DENOTES MANDATORY FIELD FOR SUPPLEMENT REPORT

LOCAL REPORT NUMBER *

2 | 0 | 2 | 0 | 2 | 8 | 0 | 0

PHOTOS TAKEN OH-2 OH-3
 SECONDARY CRASH OH-1P OTHER
 Private Property

LOCAL INFORMATION
NARS
REPORTING AGENCY NAME *
GARFIELD HEIGHTS NCIC *
0 | 1 | 8 | 2 | 0

HIT/SKIP
1 - Solved 2 - Unsolved
2 | 0 | 1 |
UNIT IN ERROR
98 - ANIMAL 99 - UNKNOWN
0 | 1 |

COUNTY *
1 | 8 |
LOCALITY *
1 |

LOCATION: CITY, VILLAGE, TOWNSHIP *
GARFIELD HTS

CRASH DATE/TIME *
0 | 9 | 1 | 8 | 2 | 0 | 2 | 0 | 0 | 1 | 0 | 6 |

CRASH SEVERITY
5 |
1 - FATAL
2 - SERIOUS INJURY SUSPECTED
3 - MINOR INJURY SUSPECTED
4 - INJURY POSSIBLE
5 - PROPERTY DAMAGE ONLY

ROUTE TYPE ROUTE NUMBER PREFIX
| | |

LOCATION ROAD NAME ROAD TYPE
OSBORN R | D |

LATITUDE DECIMAL DEGREES
4 | 1 | . 4 | 2 | 8 | 7 |

ROUTE TYPE ROUTE NUMBER PREFIX
| | |

REFERENCE ROAD NAME (ROAD, MILEPOST, HOUSE #)
4875

LONGITUDE DECIMAL DEGREES
8 | 1 | . 5 | 8 | 1 | 5 |

REFERENCE POINT
3 |
1 - INTERSECTION
2 - MILE POST
3 - HOUSE #

ROUTE TYPE ROAD TYPE
IR - INTERSTATE ROUTE (TP) AL - ALLEY HW - HIGHWAY RD - ROAD
US - FEDERAL US ROUTE AV - AVENUE LA - LANE SQ - SQUARE
SR - STATE ROUTE BL - BOULEVARD MP - MILEPOST ST - STREET
CR - CIRCLE CR - CIRCLE OV - OVAL TE - TERRACE
CT - COURT DR - DRIVE PI - PIKE TL - TRAIL
TR - NUMBERED TOWNSHIP ROUTE HE - HEIGHTS PL - PLACE WA - WAY

INTERSECTION RELATED
 WITHIN INTERSECTION OR ON APPROACH
 WITHIN INTERCHANGE AREA NUMBER OF APPROACHES

DISTANCE FROM REFERENCE DISTANCE UNIT OF MEASURE
5 | 0 | 2 |
1 - Miles
2 - Feet
3 - Yards

LOCATION OF FIRST HARMFUL EVENT
0 | 6 |
1 - ON ROADWAY 9 - CROSSOVER
2 - ON SHOULDER 10 - DRIVEWAY / ALLEY ACCESS
3 - IN MEDIAN 11 - RAILWAY GRADE CROSSING
4 - ON ROADSIDE 12 - SHARED USE PATHS OR TRAILS
5 - ON GORE 13 - BIKE LANE
6 - OUTSIDE TRAFFICWAY 14 - TOLL BOOTH
7 - ON RAMP 99 - OTHER / UNKNOWN
8 - OFF RAMP

ROADWAY
 ROADWAY DIVIDED

MANNER OF CRASH COLLISION/IMPACT
1 |
1 - NOT COLLISION BETWEEN TWO MOTOR VEHICLES IN TRANSPORT
2 - REAR-END
3 - HEAD-ON
4 - REAR-TO-REAR
5 - BACKING
6 - ANGLE
7 - SIDESWIPE, SAME DIRECTION
8 - SIDESWIPE, OPPOSITE DIRECTION
9 - OTHER / UNKNOWN

DIRECTION OF TRAVEL
| 1 - NORTH
| 2 - SOUTH
| 3 - EAST
| 4 - WEST

MEDIAN TYPE
| 1 - DIVIDED FLUSH MEDIAN (<4 FEET)
| 2 - DIVIDED FLUSH MEDIAN (≥4 FEET)
| 3 - DIVIDED, DEPRESSION MEDIAN (ANY TYPE)
| 4 - DIVIDED, RAISED MEDIAN (ANY TYPE)
| 9 - OTHER / UNKNOWN

WORK ZONE RELATED
 WORKERS PRESENT
 LAW ENFORCEMENT PRESENT
 ACTIVE SCHOOL ZONE

WORK ZONE TYPE
1 - LANE CLOSURE
2 - LANE SHIFT/CROSSOVER
3 - WORK ON SHOULDER OR MEDIAN
4 - INTERMITTENT OR MOVING WORK
5 - OTHER

LOCATION OF CRASH IN WORK ZONE
| 1 - BEFORE THE 1ST WORK ZONE WARNING SIGN
| 2 - ADVANCE WARNING AREA
| 3 - TRANSITION AREA
| 4 - ACTIVITY AREA
| 5 - TERMINATION AREA

CONTOUR
2 |
1 - STRAIGHT LEVEL
2 - STRAIGHT GRADE
3 - CURVE LEVEL
4 - CURVE GRADE
9 - OTHER / UNKNOWN

CONDITIONS
1 |
1 - DRY
2 - WET
3 - SNOW
4 - ICE
5 - SAND, MUD, DIRT, OIL, GRAVEL
6 - WATER (STANDING, MOVING)
7 - SLUSH
9 - OTHER/UNKNOWN

SURFACE
2 |
1 - CONCRETE
2 - BLACKTOP, BITUMINOUS, ASPHALT
3 - BRICK/BLOCK
4 - SLAG, GRAVEL, STONE
5 - DIRT
9 - OTHER / UNKNOWN

LIGHT CONDITION
3 |
1 - DAYLIGHT
2 - DAWN/DUSK
3 - DARK - LIGHTED ROADWAY
4 - DARK - ROADWAY NOT LIGHTED
5 - DARK - UNKNOWN ROADWAY LIGHTING
9 - OTHER / UNKNOWN

WEATHER
1 |
1 - CLEAR
2 - CLOUDY
3 - FOG, SMOG, SMOKE
4 - RAIN
5 - SLEET, HAIL
6 - SNOW
7 - SEVERE CROSSWINDS
8 - BLOWING SAND, SOIL, DIRT, SNOW
9 - FREEZING RAIN OR FREEZING DRIZZLE
99 - OTHER / UNKNOWN

NARRATIVE
ON SEPTEMBER 18, 2020 AT ABOUT 0100 HOURS
UNIT #1 WAS TRAVELING SOUTH ON OSBORN RD.
NEAR 4875 WHEN IT RAN OFF THE ROAD AT THE DEAD END IN SAID AREA. UNIT #1 THEN BACKED UP AND STRUCK THE BUILDING (4875 OSBORN RD.).
UNIT #1 THEN FLED THE SCENE TRAVELING NORTH ON OSBORN RD.

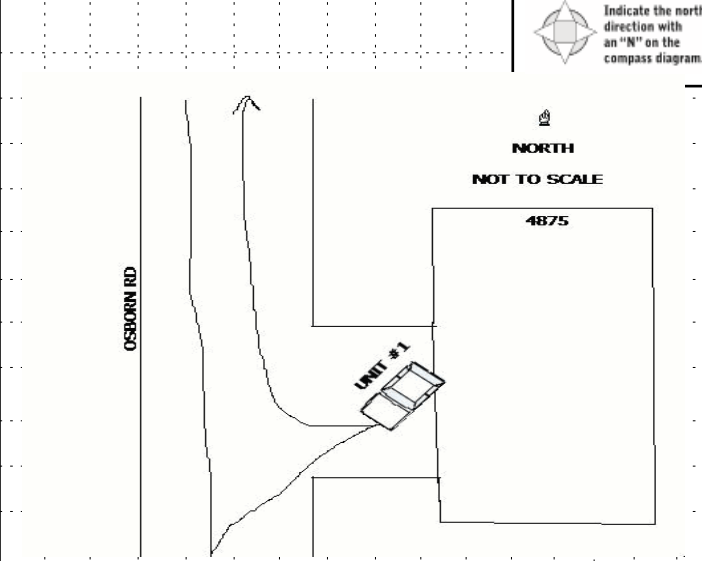

CRASH REPORTED DATE/TIME
0 | 9 | 1 | 8 | 2 | 0 | 2 | 0 | 0 | 1 | 0 | 6 |

DISPATCH DATE/TIME
0 | 9 | 1 | 8 | 2 | 0 | 2 | 0 | 0 | 1 | 0 | 6 |

ARRIVAL DATE/TIME
0 | 9 | 1 | 8 | 2 | 0 | 2 | 0 | 0 | 1 | 1 | 2 | 3 |

SCENE CLEARED DATE/TIME
0 | 9 | 1 | 8 | 2 | 0 | 2 | 0 | 0 | 2 | 3 | 0 |

REPORT TAKEN BY
 POLICE AGENCY
 MOTORIST

TOTAL TIME ROADWAY CLOSED
3 | 0 |

OTHER INVESTIGATION TIME
3 | 0 |

TOTAL MINUTES
9 | 7 |

OFFICER'S NAME *
M. Malak
OFFICER'S BADGE NUMBER *
0 | 3 | 3 |

CHECKED BY OFFICER'S NAME *
W. Gall
CHECKED BY OFFICER'S BADGE NUMBER *
S | 1 | 5 |

SUPPLEMENT (CORRECTION - ADDITION)

UNIT # 0 1	OWNER NAME: LAST, FIRST, MIDDLE JACKSON DEVONSHAE ABDULA <input type="checkbox"/> Same As Driver	OWNER PHONE: INCLUDE AREA CODE <input type="checkbox"/> Same As Driver
OWNER ADDRESS: STREET, CITY, STATE, ZIP 4264 E 131ST ST CLEVELAND OH 44105 <input type="checkbox"/> Same As Driver		
COMMERCIAL CARRIER: NAME, ADDRESS, CITY, STATE, ZIP		COMMERCIAL CARRIER PHONE: INCLUDE AREA CODE

DAMAGE

DAMAGE SCALE

4 1 - NONE
2 - MINOR DAMAGE
3 - FUNCTIONAL DAMAGE
4 - DISABLING DAMAGE
9 - UNKNOWN

LP STATE OH	LICENSE PLATE # K408791	VEHICLE IDENTIFICATION # 4S2DM58Y744303499	VEHICLE YEAR 2004	VEHICLE MAKE Isuzu
<input type="checkbox"/> INSURANCE VERIFIED	INSURANCE COMPANY	INSURANCE POLICY #	VEHICLE COLOR BRO	VEHICLE MODEL Other/Unknow
<input type="checkbox"/> COMMERCIAL	<input type="checkbox"/> GOVERNMENT	<input type="checkbox"/> IN EMERGENCY RESPONSE	US DOT #	
<input type="checkbox"/> INTERLOCK DEVICE EQUIPPED	<input type="checkbox"/> HIT/SKIP UNIT	# OCCUPANTS 0 1	VEHICLE WEIGHT GVWR/GCWR 1 - ≤10K LBS. 2 - 10,001 - 26K LBS. 3 - >26K LBS.	
TYPE OF USE		HAZARDOUS MATERIAL		
<input type="checkbox"/> COMMERCIAL <input type="checkbox"/> GOVERNMENT <input type="checkbox"/> IN EMERGENCY RESPONSE		<input type="checkbox"/> MATERIAL RELEASED CLASS # PLACARD ID #		
<input type="checkbox"/> INTERLOCK DEVICE EQUIPPED		<input type="checkbox"/> PLACARD		

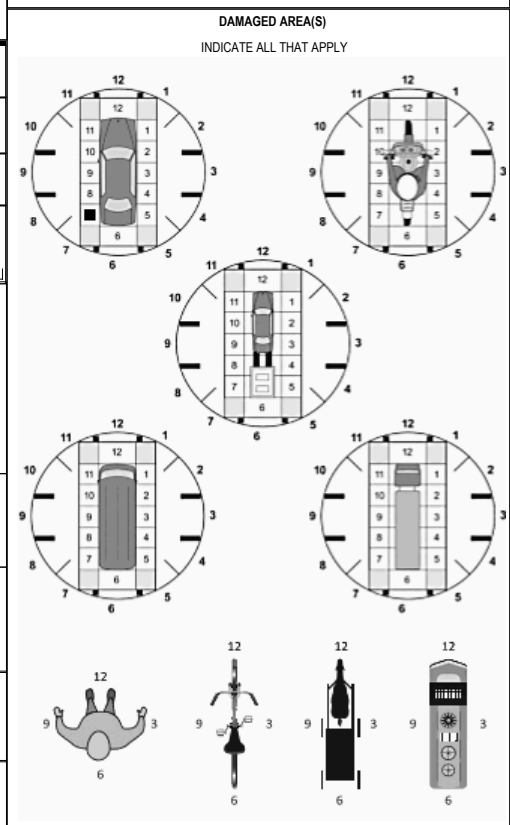

UNIT TYPE
0 3

1 - PASSENGER CAR	7 - MOTORCYCLE 2-WHEELED	12 - GOLF CART	18 - LIMO (LIVERY VEHICLE)	23 - PEDESTRIAN/SKATER
2 - PASSENGER VAN (MINIVAN)	8 - MOTORCYCLE 3-WHEELED	13 - SNOWMOBILE	19 - BUS (16+ PASSENGERS)	24 - WHEELCHAIR (ANY TYPE)
3 - SPORT UTILITY VEHICLE	9 - AUTOCYCLE	14 - SINGLE UNIT TRUCK	20 - OTHER VEHICLE	25 - OTHER NON-MOTORIST
4 - PICK UP	10 - MOPED OR MOTORIZED BICYCLE	15 - SEMI-TRACTOR	21 - HEAVY EQUIPMENT	26 - BICYCLE
5 - CARGO VAN	11 - ALL TERRAIN VEHICLE (ATV / UTV)	16 - FARM EQUIPMENT	22 - ANIMAL WITH RIDER OR ANIMAL-DRAWN VEHICLE	27 - TRAIN
6 - VAN (9-15 SEATS)		17 - MOTORHOME		99 - UNKNOWN OR HIT/SKIP

of TRAILING UNITS

WAS VEHICLE OPERATING IN AUTONOMOUS MODE WHEN CRASH OCCURRED?
2 1 - YES 2 - NO 9 - OTHER / UNKNOWN

AUTONOMOUS MODE LEVEL
0 - NO AUTOMATION
1 - DRIVER ASSISTANCE
2 - PARTIAL AUTOMATION
3 - CONDITIONAL AUTOMATION
4 - HIGH AUTOMATION
5 - FULL AUTOMATION
9 - UNKNOWN

SPECIAL FUNCTION
0 1

1 - NONE	6 - BUS - CHARTER/TOUR	11 - FIRE	16 - FARM	21 - MAIL CARRIER
2 - TAXI	7 - BUS - INTERCITY	12 - MILITARY	17 - MOWING	99 - OTHER / UNKNOWN
3 - ELECTRONIC RIDE SHARING	8 - BUS - SHUTTLE	13 - POLICE	18 - SNOW REMOVAL	
4 - SCHOOL TRANSPORT	9 - BUS - OTHER	14 - PUBLIC UTILITY	19 - TOWING	
5 - BUS-TRANSIT/COMMUTER	10 - AMBULANCE	15 - CONSTRUCTION EQUIPMENT	20 - SAFETY SERVICE PATROL	

CARGO BODY TYPE
0 1

1 - NO CARGO BODY TYPE / NOT APPLICABLE	3 - VEHICLE TOWING ANOTHER MOTOR VEHICLE	5 - INTERMODAL CONTAINER CHASSIS	8 - POLE	12 - CONCRETE MIXER
2 - BUS	4 - LOGGING	6 - CARGO VAN/ENCLOSED BOX	9 - CARGO TANK	13 - AUTO TRANSPORTER
		7 - GRAIN/CHIPS/GRAVEL	10 - FLAT BED	14 - GARBAGE/REFUSE
			11 - DUMP	99 - OTHER / UNKNOWN

VEHICLE DEFECTS

1 - TURN SIGNALS	4 - BRAKES	7 - WORN OR SLICK TIRES	9 - MOTOR TROUBLE	99 - OTHER / UNKNOWN
2 - HEAD LAMPS	5 - STEERING	8 - TRAILER EQUIPMENT DEFECTIVE	10 - DISABLED FROM PRIOR ACCIDENT	
3 - TAIL LAMPS	6 - TIRE BLOWOUT			

NON-MOTORIST LOCATION AT IMPACT
0 1

1 - INTERSECTION - MARKED CROSSWALK	3 - INTERSECTION - OTHER	6 - BICYCLE LANE	9 - MEDIAN/CROSSING ISLAND	12 - FIRST RESPONDER AT INCIDENT SCENE
2 - INTERSECTION - UNMARKED	4 - MIDBLOCK - MARKED CROSSWALK	7 - SHOULDER/ROADSIDE	10 - DRIVEWAY ACCESS	99 - OTHER / UNKNOWN
	5 - TRAVEL LANE-OTHER LOCATION	8 - SIDEWALK	11 - SHARED USE PATHS OR TRAILS	

ACTION
0 2

1 - NON-CONTACT	1 - STRAIGHT AHEAD	7 - MAKING U-TURN	13 - NEGOTIATING A CURVE	18 - APPROACHING OR LEAVING VEHICLE
2 - NON-COLLISION	2 - BACKING	8 - ENTERING TRAFFIC LANE	14 - ENTERING OR CROSSING SPECIFIED LOCATION	19 - STANDING
3 - STRIKING	3 - CHANGING LANES	9 - LEAVING TRAFFIC LANE	15 - WALKING, RUNNING, JOGGING, PLAYING	20 - OTHER NON-MOTORIST
4 - STRUCK	4 - OVERTAKING/PASSING	10 - PARKED	16 - WORKING	21 - STANDING OUTSIDE DISABLED VEHICLE
5 - BOTH STRIKING & STRUCK	5 - MAKING RIGHT TURN	11 - SLOWING OR STOPPED IN TRAFFIC	17 - PUSHING VEHICLE	99 - OTHER / UNKNOWN
9 - OTHER / UNKNOWN	6 - MAKING LEFT TURN	12 - DRIVERLESS		

INITIAL POINT OF CONTACT

0 7 0 - NO DAMAGE
1-12 - REFER TO UNIT DIAGRAM
14 - UNDERCARRIAGE
15 - VEHICLE NOT AT SCENE
99 - UNKNOWN

CONTRIBUTING CIRCUMSTANCES
1 2

1 - NONE	7 - LEFT OF CENTER	13 - IMPROPER START FROM A PARKED POSITION	17 - VISION OBSTRUCTION	21 - LYING IN ROADWAY
2 - FAILURE TO YIELD	8 - FOLLOWING TOO CLOSE/ACDA	14 - STOPPED OR PARKED ILLEGALLY	18 - OPERATING DEFECTIVE EQUIPMENT	22 - NOT DISCERNABLE
3 - RAN RED LIGHT	9 - IMPROPER LANE CHANGING	15 - SWERVING TO AVOID	19 - LOAD SHIFTING/ FALLING/SPILLING	23 - OPENING DOOR INTO ROADWAY
4 - RAN STOP SIGN	10 - IMPROPER PASSING	16 - WRONG WAY	20 - IMPROPER CROSSING	99 - OTHER IMPROPER ACTION
5 - UNSAFE SPEED	11 - DROVE OFF ROAD			
6 - IMPROPER TURN	12 - IMPROPER BACKING			

TRAFFIC

TRAFFICWAY FLOW
2 1 - ONE-WAY
2 - TWO-WAY

TRAFFIC CONTROL
6 1 - ROUNDABOUT 4 - STOP SIGN
2 - SIGNAL 5 - YIELD SIGN
3 - FLASHER 6 - NO CONTROL

SEQUENCE OF EVENTS

EVENTS

1 0 9

1 - OVERTURN/ROLLOVER	6 - EQUIPMENT FAILURE	11 - CROSS CENTERLINE - OPPOSITE DIRECTION OF TRAVEL	16 - RAILWAY VEHICLE	22 - WORK ZONE MAINTENANCE EQUIPMENT
2 - FIRE/EXPLOSION	7 - SEPARATION OF UNITS	12 - DOWNHILL RUNAWAY	17 - ANIMAL - FARM	
3 - IMMERSION	8 - RAN OFF ROAD RIGHT	13 - OTHER NON-COLLISION	18 - ANIMAL - DEER	
4 - JACKKNIFE	9 - RAN OFF ROAD LEFT	14 - PEDESTRIAN	19 - ANIMAL - OTHER	23 - STRUCK BY FALLING, SHIFTING CARGO OR ANYTHING SET IN MOTION BY A MOTOR VEHICLE
5 - CARGO / EQUIPMENT LOSS OR SHIFT	10 - CROSS MEDIAN	15 - PEDALCYCLE	20 - MOTOR VEHICLE IN TRANSPORT	24 - OTHER MOVABLE
			21 - PARKED MOTOR VEHICLE	

of THROUGH LANES ON ROAD
2

RAIL GRADE CROSSING
1 - NOT INVOLVED
2 - INVOLVED - ACTIVE CROSSING
3 - INVOLVED - PASSIVE CROSSING

COLLISION WITH FIXED OBJECT - STRUCK

25 - IMPACT ATTENUATOR / CRASH CUSHION	31 - GUARDRAIL END	37 - TRAFFIC SIGN POST	43 - CURB	50 - WORKZONE MAINTENANCE EQUIPMENT
26 - BRIDGE OVERHEAD STRUCTURE	32 - PORTABLE BARRIER	38 - OVERHEAD SIGN POST	44 - DITCH	51 - WALL
27 - BRIDGE PIER OR ABUTMENT	33 - MEDIAN CABLE BARRIER	39 - LIGHT/LUMINARIES SUPPORT	45 - EMBANKMENT	52 - BUILDING
28 - BRIDGE PARAPET	34 - MEDIAN GUARDRAIL BARRIER	40 - UTILITY POLE	46 - FENCE	53 - TUNNEL
29 - BRIDGE RAIL	35 - MEDIAN CONCRETE BARRIER	41 - OTHER POST, POLE OR SUPPORT	47 - MAILBOX	54 - OTHER FIXED OBJECT
30 - GUARDRAIL FACE	36 - MEDIAN OTHER BARRIER	42 - CULVERT	48 - TREE	99 - OTHER / UNKNOWN
			49 - FIRE HYDRANT	

UNIT / NON-MOTORIST DIRECTION

FROM 8 TO 5

1 - NORTH 5 - NORTHEAST
2 - SOUTH 6 - NORTHWEST
3 - EAST 7 - SOUTHEAST
4 - WEST 8 - SOUTHWEST

UNIT SPEED
2 0

DETECTED SPEED
1 1 - STATED/ESTIMATED SPEED
2 - CALCULATED / EDR
3 - UNDETERMINED

POSTED SPEED
3 5

MOTORIST / NON-MOTORIST

LOCAL REPORT NUMBER
2 0 2 0 2 8 0 0

UNIT # 0 1	NAME: LAST, FIRST, MIDDLE UNKNOWN	DATE OF BIRTH	AGE	GENDER
ADDRESS: STREET, CITY, STATE, ZIP OH		CONTACT PHONE - INCLUDE AREA CODE		
INJURIES 5	INJURED TAKEN BY	EMS AGENCY (NAME)	INJURED TAKEN TO: MEDICAL FACILITY (NAME, CITY)	SAFETY EQUIPMENT USED 9 9
OL STATE	OPERATOR LICENSE NUMBER	OFFENSE CHARGED	LOCAL CODE	OFFENSE DESCRIPTION
OL CLASS	ENDORSEMENT SELECT UP TO 2	RESTRICTION SELECT UP TO 3	DRIVER DISTRACTED BY	ALCOHOL / DRUG SUSPECTED <input checked="" type="checkbox"/> ALCOHOL <input type="checkbox"/> MARIJUANA <input type="checkbox"/> OTHER DRUG
		ALCOHOL TEST		DRUG TEST(S)
		STATUS	TYPE	VALUE
		STATUS	TYPE	RESULT SELECT UP TO 4

INJURIES	SEATING POSITION	AIR BAG	OL CLASS	OL RESTRICTION(S)	DRIVER DISTRACTION	TEST STATUS	
1 - FATAL	1 - FRONT - LEFT SIDE (MOTORCYCLE DRIVER)	1 - NOT DEPLOYED	1 - CLASS A	1 - ALCOHOL INTERLOCK DEVICE	1 - NOT DISTRACTED	1 - NONE GIVEN	
2 - SUSPECTED SERIOUS INJURY	2 - FRONT - MIDDLE	2 - DEPLOYED FRONT	2 - CLASS B	2 - CDL INTRASTATE ONLY	2 - MANUALLY OPERATING AN ELECTRONIC COMMUNICATION DEVICE (TEXTING, TYPING, DIALING)	2 - TEST REFUSED	
3 - SUSPECTED MINOR INJURY	3 - FRONT - RIGHT SIDE	3 - DEPLOYED SIDE	3 - CLASS C	3 - CORRECTIVE LENSES	3 - TALKING ON HANDS-FREE COMMUNICATION DEVICE	3 - TEST GIVEN, CONTAMINATED SAMPLE / UNUSABLE	
4 - POSSIBLE INJURY	4 - SECOND - LEFT SIDE (MOTORCYCLE PASSENGER)	4 - DEPLOYED BOTH FRONT / SIDE	4 - REGULAR CLASS (OHIO = D)	4 - FARM WAIVER	4 - TALKING ON HAND-HELD COMMUNICATION DEVICE	4 - TEST GIVEN, RESULTS KNOWN	
5 - NO APPARENT INJURY	5 - SECOND - MIDDLE	5 - NOT APPLICABLE	5 - M / C MOPED ONLY	5 - EXCEPT CLASS A BUS & CLASS B BUS	5 - OTHER ACTIVITY WITH AN ELECTRONIC DEVICE	5 - TEST GIVEN, RESULTS UNKNOWN	
INJURED TAKEN BY		EJECTION		CONDITION		ALCOHOL TEST TYPE	
1 - NOT TRANSPORTED / TREATED AT SCENE	7 - THIRD - LEFT SIDE (MOTORCYCLE SIDE CAR)	1 - NOT EJECTED	H - HAZMAT	8 - INTERMEDIATE LICENSE RESTRICTIONS	6 - PASSENGER	1 - NONE	
2 - EMS	8 - THIRD - MIDDLE	2 - PARTIALLY EJECTED	M - MOTORCYCLE	9 - LEARNER'S PERMIT RESTRICTIONS	7 - OTHER DISTRACTION INSIDE THE VEHICLE	2 - BLOOD	
3 - POLICE	9 - THIRD - RIGHT SIDE	3 - TOTALLY EJECTED	P - PASSENGER	10 - LIMITED TO DAYLIGHT ONLY	8 - OTHER DISTRACTIONS OUTSIDE THE VEHICLE	3 - URINE	
SAFETY EQUIPMENT		4 - NOT APPLICABLE	N - TANKER	11 - LIMITED TO EMPLOYMENT	9 - OTHER / UNKNOWN	4 - BREATH	
1 - NONE USED	11 - PASSENGER IN OTHER ENCLOSED CARGO AREA (NON-TRAILING UNIT, BUS, PICK-UP WITH CAP)	4 - NOT APPLICABLE	Q - MOTOR SCOOTER	12 - LIMITED - OTHER	DRUG TEST TYPE		
2 - SHOULDER BELT ONLY USED	12 - PASSENGER IN UNENCLOSED CARGO AREA	TRAPPED		13 - MECHANICAL DEVICES (SPECIAL BRAKES, HAND CONTROLS, OR OTHER ADAPTIVE DEVICES)	1 - APPARENTLY NORMAL	1 - NONE	
3 - LAP BELT ONLY USED	13 - TRAILING UNIT	1 - NOT TRAPPED	R - THREE-WHEEL MOTORCYCLE	14 - MILITARY VEHICLES ONLY	2 - PHYSICAL IMPAIRMENT	2 - BLOOD	
4 - SHOULDER & LAP BELT USED	14 - RIDING ON VEHICLE EXTERIOR (NON-TRAILING UNIT)	2 - EXTRICATED BY MECHANICAL MEANS	S - SCHOOL BUS	15 - MOTOR VEHICLES WITHOUT AIR BRAKES	3 - EMOTIONAL (E.G. DEPRESSED, ANGRY, DISTURBED)	3 - URINE	
5 - CHILD RESTRAINT SYSTEM - FORWARD FACING	15 - NON-MOTORIST	3 - FREED BY NON-MECHANICAL MEANS	T - DOUBLE & TRIPLE TRAILERS	16 - OUTSIDE MIRROR	4 - ILLNESS	4 - OTHER	
6 - CHILD RESTRAINT SYSTEM - REAR FACING	99 - OTHER / UNKNOWN		X - TANKER / HAZMAT	17 - PROSTHETIC AID	5 - FELL ASLEEP, FAINTED, FATIGUED, ETC.	DRUG TEST RESULT(S)	
7 - BOOSTER SEAT			GENDER		6 - UNDER THE INFLUENCE OF MEDICATIONS / DRUGS / ALCOHOL	1 - AMPHETAMINES	
8 - HELMET USED			F - FEMALE	18 - OTHER	9 - OTHER / UNKNOWN	2 - BARBITURATES	
9 - PROTECTIVE PADS USED (ELBOWS, KNEES, ETC.)			M - MALE			3 - BENZODIAZEPINES	
10 - REFLECTIVE CLOTHING			U - OTHER/UNKNOWN			4 - CANNABINOIDS	
11 - LIGHTING - PEDESTRIAN / BICYCLE ONLY						5 - COCAINE	
99 - OTHER / UNKNOWN						6 - OPIATES / OPIOIDS	
						7 - OTHER	
						8 - NEGATIVE RESULTS	

OHIO TRAFFIC CRASH REPORT

DIAGRAM / NARRATIVE CONTINUATION

LOCAL REPORT NUMBER 20202800	REPORTING AGENCY GARFIELD HEIGHTS	DATE OF CRASH M 09 D 18 Y 2020
IN COUNTY OF 18	CRASH LOCATION OSBORN RD NARS	
<p>On September 18, 2020 at about 0100 hours Unit #1 was traveling South on Osborn Rd. near 4875 when it ran off the road at the dead end in said area. Unit #1 then backed up and struck the building (4875 Osborn Rd.). Unit #1 then fled the scene traveling North on Osborn Rd. Officers followed a trail of vehicle fluids which went from 4875 Osborn Rd. North on Osborn Rd, East on Ohio Ave., North on E. 153rd St., East on Seville Rd. and then collided with another vehicle in the intersection of Seville Rd. and Lee Rd. (Cleveland Police Dept accident report #29-5031). According to CPD, the driver of the hit skip vehicle exited the vehicle after the MVA at Lee Rd. and Seville Rd. then got picked up by a white Mercury Mountaineer which fled the area. The driver of the hit skip vehicle has not been identified.</p>		
OFFICER'S SIGNATURE X		BADGE NUMBER 033